

Type
Project
Catalog No.
Lamp/Wattage

**NHMIC-685**  
**6" LED Marquise New Const. IC Housing**

Source: 850L, 120/277V

**PRODUCT DESCRIPTION**

Dedicated remodel housing for use in insulated ceilings can be in direct contact with thermal insulation. Air-tight construction provides energy savings by reducing the flow of air through the ceiling. Each LED Diamond Series Housing requires a Nora Lighting LED Diamond Series Trim Module.

**CONSTRUCTION**

**Plaster Frame**

High quality 0.040 steel die cut one piece frame

**Housing**

0.040 steel housing adjusts to maximum ceiling thickness of 1-3/4" (45mm). Spring brackets accept torsion wing trim springs.

**Clearance**

"IC" Insulated Ceiling housings are direct contact rated; no minimum clearance is required.

**Mounting**

Two bar hangers are included adjustable to 24-1/2". Bar hangers are parallel to junction box, but can be repositioned 90° perpendicular to junction box if desired. Insulation may be blown directly onto the surface of the fixture.

**Air Flow Restriction**

Meets ASTM E283 Air-Tight Requirements.

**ELECTRICAL**

**Junction Box**

Plaster frame integrated 15 cubic inch 0.064" thick galvanized steel, with seven 1/2" NPT knockouts, four Romex® pryouts, and snap on covers. Electrical connections are made through junction box wrap. Electrical grounding automatic when feeding with grounded steel EMT pipe or flex. Green wire provided installs with ground wire fed through PVC pipe conduit.

**Dimming**

- 850 Lumen Triac dimming standard
- Comfort Dim requires ELV dimmer
- Consult factory for optional 850LM 0-10V

**Thermal Protector**

External thermal device is located on the junction box.

**EMERGENCY**

90-minute battery back up must be ordered separately and installed apart from the housing in an accessible location.

**Lamp**

Compatible with NRM-61 Series.

**DRIVER**

- CREE LMD125 for 120V 850/1250 Lumen. ERP ELM03W-0440-34 for 277V 850/1250Lumen

**Wiring**

Standard flex whip carries wire lead from junction box into housing. Wire leads extend from housing and thermal device to the luminary disconnect.

**6" LED Marquise New Const. IC Housing**

Catalog No.	Description	Driver	Voltage	Emergency
NHMIC-685	6" 850lm New Const	(Blank)=Standard C=Comfort Dim	LE1=120V LE2=277V	EM=Emergency

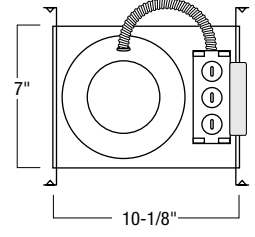
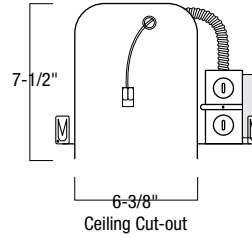

Cut-out: 6-3/8"  
 ID: 6"  
 OD: 7-1/8"

Housing Length: 10-1/8"  
 Housing Width: 7"  
 Housing Height: 7-1/2"



**Bodine Emergency Lighting Equipment: BSL17-C2/BSL17C-C2 (850/1250lm)**

- Up to 7.0W max emergency illumination with LEDs.
- Illumination Time: 90min
- Dual Input Voltage: 120/277 VAC, 60Hz
- Output Voltage: 15.0-50.0 VDC
- AC Input Current: 45 mA
- Output Current: 470mA max
- Dimension: 12" x 2.4" x 1.5"

**Labels and Listings**

cULus Listed for Damp Location w/ Feed Through  
 cULus Wet Listed (Only with designated trims)  
 Meets or exceeds ASTM-283 Air-Tight Requirements  
 Title 24  
 Energy Star

# NHMIC-685

## 6" LED Marquise New Const. IC Housing

Source: 850L, 120/277V

Type \_\_\_\_\_

Project \_\_\_\_\_

Catalog No. \_\_\_\_\_

Lamp/Wattage \_\_\_\_\_

### 120-VAC Dimmer Compatibility

Manufacturer	Model/Series	Part Number	Type	Compatible with 1 LMH2	Compatible with 2 LMH2s
Cooper	Rotary	6020	IND	✓	✓
	Aspire	9530	IND	✓	✓
	Aspire	9534WS-K-L	IND/MLV		✓
	Aspire	9540WS	IND/MLV	✓	✓
	Devine	DI106P-V	IND	✓	✓
	Devine	DI10P	IND	✓	✓
	React	RI061-V	IND	✓	✓
	React	RI06P-LA	IND	✓	✓
	Skye	SI06P	IND/MLV	✓	✓
	Skye	SI061-V	IND	✓	✓
	Skye	SI10P	IND/MLV	✓	✓
	Trace	T1061-W	IND	✓	✓
	Leviton	Trimitron	6602	IND	✓
Acenti		AT106-1LW	IND	✓	✓
Illumatech		IPI06	IND	✓	✓
Vizia		RP106	IND	✓	✓
Lutron	Ariadni	AY-600P	IND	✓	✓
	Ceana	CN-600P	IND	✓	✓
	Ceana	CNLV-V-600P	MLV	✓	✓
	Centurion	C-600	IND	✓	✓
	Decora	VPI06-1LW	IND	✓	✓
	Dial Dimmer	D-600	IND	✓	✓
	Diva	DV-600P	IND	✓	✓
	Diva	DV-10P	IND	✓	✓
	Diva	DVELV-300P	ELV	✓	✓
	Diva	DVF-103P	FLR	✓	✓
	Diva	DVLV-600P	MLV	✓	✓
	Diva	DVWCL-153DH	CFL/LED	✓	✓
	Glyder	GL-600H	IND/MLV	✓	✓
	Lumea	LG-603PG	IND	✓	✓
	Lyneo	LX-600PL	IND	✓	✓
	Maestro	MA-1000	IND	✓	✓
	Maestro	MALV-1000	MLV	✓	✓
	Maestro	MAW-600	IND	✓	✓
	Maestro	MRF-600M	IND		✓
	Nova	N-600	IND	✓	✓
	Nova	NLV-1503P	MLV	✓	✓
	Nova T	NTB-600	IND	✓	✓
	Nova T	NT-603P	IND	✓	✓
	Nova T	NTELV-600	ELV	✓	✓
	Skylark	S-600	IND	✓	✓
	Skylark	S-600P	IND	✓	✓
	Skylark	SELV-300P	ELV	✓	✓
Skylark	SLV-600P	MLV	✓	✓	
Sureslide	6673-P	CFL	✓	✓	
Toggler	TG-600PH	IND	✓	✓	
Pass and Seymour	Decorator	LS600	IND	✓	✓
Wattstopper	Miro	MCD267-W	UNI	✓	✓