

#262190 INSTRUCTIONS

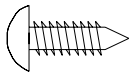

#1 - (8) #3 x 12mm PLATE SCREWS
4553

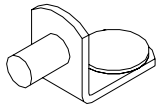

#2 - (4) - SHELF SUPPORT
4545

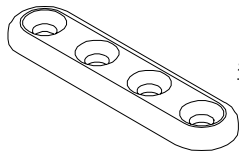

#3 - (2) PLATES
1536

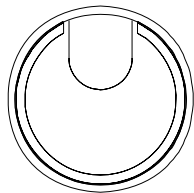

#4 - (1) - WIRE PLUG
4126

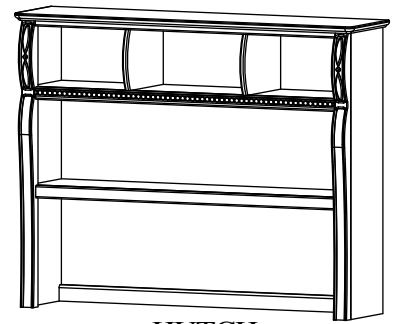

HUTCH
SHOWN WITH
REMOVABLE SHELF
INSTALLED

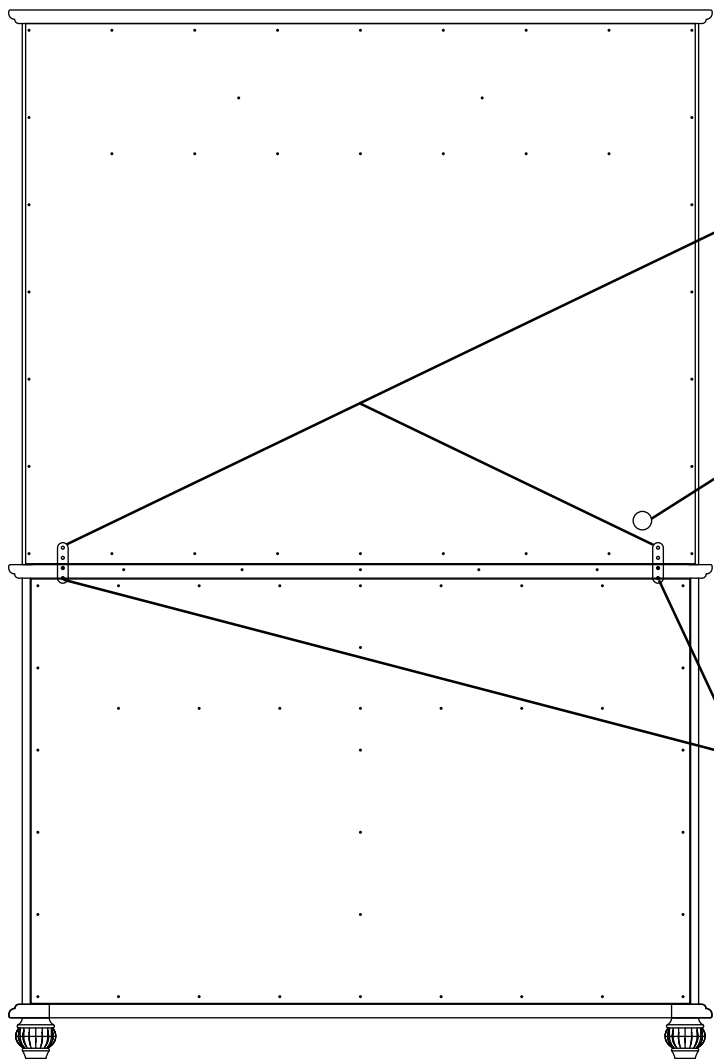

PART #3

PART #4

PART #1

STEPS:

1. INSTALL PLATES (PART #3) TO BACK OF THE HUTCH USING 4 SCREWS (PART #1) INTO THE PRE-DRILLED HOLES.
2. INSTALL 4 SCREWS (PART #1) THROUGH THE PLATE (PART #3) INTO THE BACK OF THE COMBO UNIT INTO THE PRE-DRILLED HOLES.
3. A WIRE PLUG HOLE HAS BEEN PROVIDED IN THE BOTTOM LEFT CORNER. IF USING AN ELECTRONIC DEVICE, PLACE END OF CORD THRU THE HOLE AND USE THE WIRE PLUG CAP PROVIDED (PART #4). PUSH WIRE PLUG CAP INTO HOLE FROM FRONT SIDE OF HUTCH.
4. YOUR HUTCH HAS BEEN PROVIDED WITH A REMOVABLE SHLEF. DO NOT INSTALL THE SHELF WHILE USING THE DRESSER AS A CHANGING SURFACE. TO INSTALL THE REMOVABLE SHELF INSERT THE SHELF SUPPORTS (PART #2) INTO THE PRE-DRILLED HOLES IN THE SIDE OF THE HUTCH AND PLACE SHELF ON THE SUPPORTS.



SIMMONS JUVENILE FURNITURE
A DIVISION OF DELTA ENTERPRISE CORP.
114 WEST 26TH STREET
NEW YORK, NY 10001
PHONE: 1-800-218-2741
FAX: (920) 882-7069

Trademark is a registered trademark of Dreamwell, LTD., a subsidiary of Simmons Bedding Company, Atlanta, GA
Manufactured by Delta Enterprise Corp under license from the trademark owner, Dreamwell, LTD., a subsidiary of Simmons Bedding Company, Atlanta, GA

FEBRUARY 18,2008
5012