

# 302 CASES INSTRUCTION SHEET

Parts below combine to make part # 23261  
 Pièces ci-dessous se combinent pour faire pièce# 23261

Partes inferiores se combinan para hacer parte # 23261

**NOTE: FASTENERS ARE SHOWN FULL SIZE**  
**REMARQUE: LES DISPOSITIFS DE FIXATION SONT MONTRÉS EN TAILLE RÉELLE**  
**NOTA: LOS PERNOS SE MUESTRAN EN TAMAÑO REAL**



#1 - #7 - 32 X 38mm Screw  
 Vis  
 Tornillo

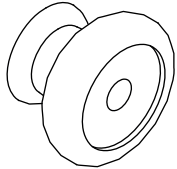

#2 - Knob Shell  
 extérieur de bouton  
 exterior de Tirador



#3 - Knob Core  
 l'intérieur de bouton  
 interior de Tirador

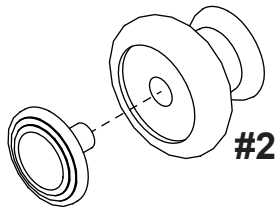

#3

INSERT THE METAL PORTION (PART #3)  
 INTO THE WOODKNOB(PART#2)

Insérez la partie METAL (PARTIE # 3)  
 DANS LE Bouton en bois (PARTIE # 2)

Inserte el metálica (parte # 3)  
 EN tirador de madera(PARTE # 2)

©2012 Simmons Juvenile Furniture,  
 A Division Of Children's Products LLC.



Night Stand  
 Table de nuit  
 Mesa de noche  
 302020

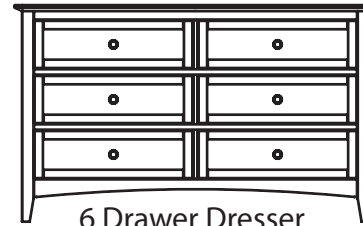

6 Drawer Dresser  
 Commode de 6 tiroir  
 Cómoda de 6 cajones  
 302030

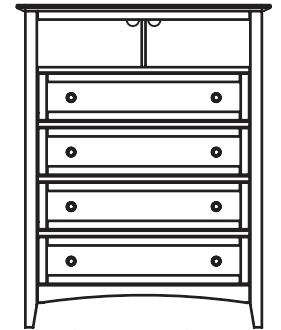

4 drawer chest  
 Commode de 4 tiroir  
 Cómoda de 4 cajones  
 302050

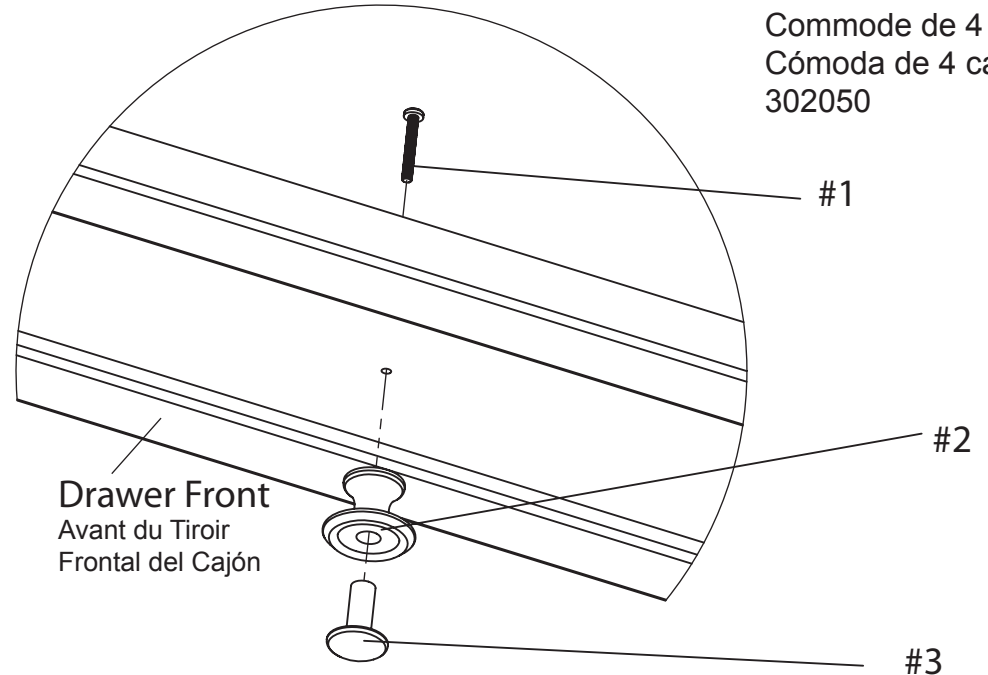

Drawer Front  
 Avant du Tiroir  
 Frontal del Cajón

#1

#2

#3

Manufactured for USA by  
 Simmons Juvenile Furniture  
 A Division Of Children's Products, LLC  
 114 West 26th Street  
 New York, NY 10001  
 1-800-218-2741

Manufactured for Canada by  
 Fabriqués pour le Canada près  
 Little Folks  
 Care of/Soins de:  
 501 Franklin Boulevard  
 Cambridge, Ontario N1R8G9

23259 - R0  
 May 6, 2013

# How To Operate The Drawer Glide

## Comment faire fonctionner le tiroir Glide

### Como la función de deslizamiento del cajón

**Right Side Push Lever Down**  
**Droit levier pousoir Side Down**  
**Presione lado de la palanca derecha hacia abajo**

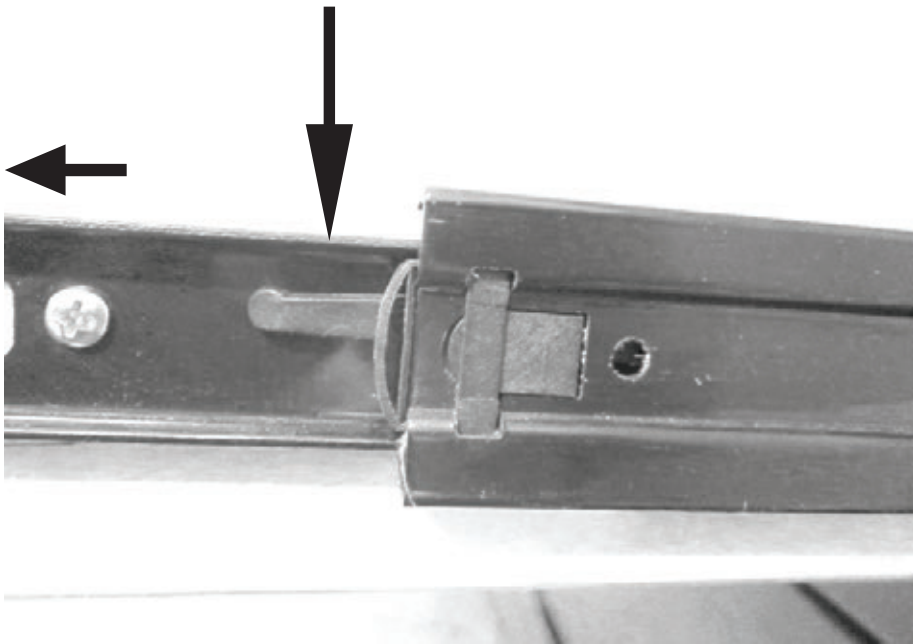

**Left Side Push Lever Up**  
**Côté gauche Up Pousser le levier**  
**empuje la palanca izquierda hacia arriba**

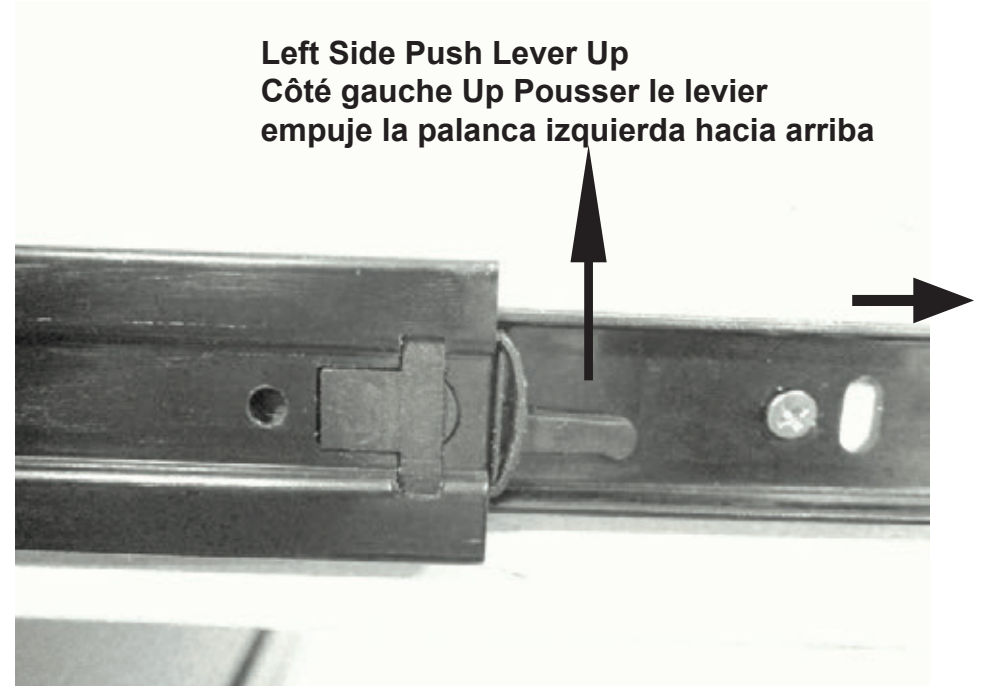

The silver portion of the glide must be pulled to the front of the glide when assembling the drawer into the case.

La partie argentée du glissement de doit être tirée vers l'avant de la glisse lors du montage du tiroir dans le boîtier.

La parte plateada de la guía de la gaveta debe estar al frente de la guía cuando se está armando la cómoda.

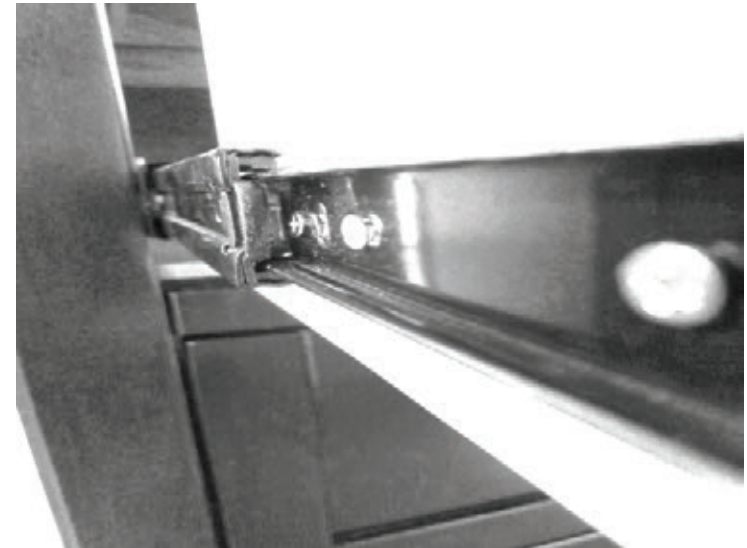
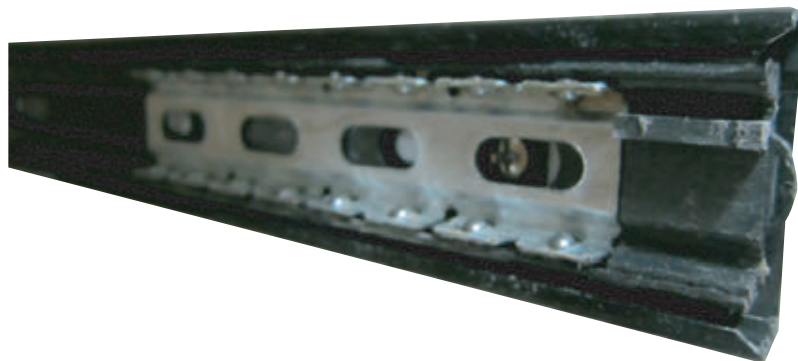
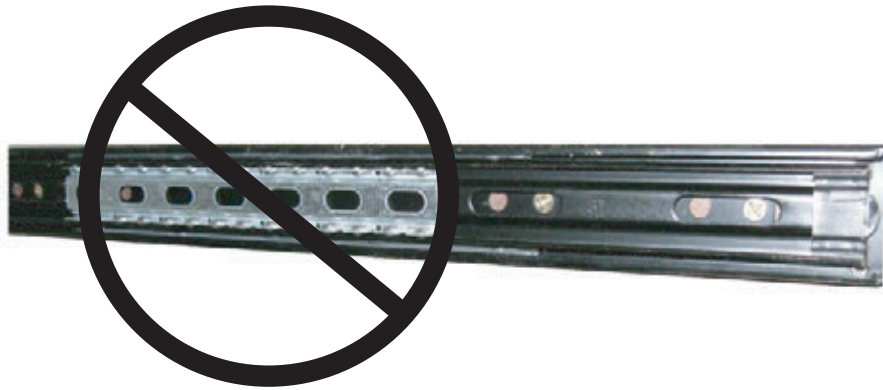

To insert drawer align male runner on drawer to female runner on case and push all the way in

Pour insérer tiroir aligner runner homme sur le tiroir pour runner femme sur l'affaire et poussez jusqu'à ce qu'il repose

Para insertar cajón alinear runner mujer en el cajón para de hombre runner case y empuje hasta el fondo