

**READ ALL INSTRUCTIONS BEFORE  
ASSEMBLY AND USE.  
KEEP INSTRUCTIONS FOR FUTURE USE.**  
⚠ **ADULT ASSEMBLY REQUIRED**  
DUE TO THE PRESENCE OF SMALL PARTS DURING  
ASSEMBLY, KEEP OUT OF REACH OF CHILDREN UNTIL  
ASSEMBLY IS COMPLETE.

Required Tools

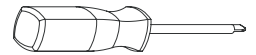

Flat Head  
Screwdriver  
(not supplied)

**Delta**<sup>TM</sup>  
Children's Products

Customer Service:

Web Site: [www.deltachildrenproducts.com](http://www.deltachildrenproducts.com)

Delta Children's Products

114 West 26th Street

New York, NY 10001

Tele.212-645-9033



**THIS PRODUCT IS NOT INTENDED FOR INSTITUTIONAL OR COMMERCIAL USE.**

If you have any questions or missing parts, contact us. **DO NOT** return product parts to the store from where it was purchased before contacting Delta Children's Products Customer Service. Make sure that all pre-assembled parts are tight. The appearance of your product may be different from that pictured in this booklet.

To register your product for important safety alerts and updates to your product please visit <http://deltaenterprise.com/register.asp>

# TODDLER BED

## **WARNING ENTRAPMENT/STRANGULATION HAZARD**

\*INFANTS HAVE DIED IN **TODDLER BEDS** FROM ENTRAPMENT AND STRANGULATION. Failure to follow these warnings and the assembly instructions could result in serious injury or death.

\***Never** use bed with children under 15 months.

\***Never** place bed near windows where cords from blinds or drapes may strangle a child.

\***Do not** place items with a string, cord, or ribbon around a child's neck, such as hood strings or pacifier cords.

\***Do not** suspend strings over a toddler bed for any reason.

\*The users maximum weight shall not be greater than 50 lb (22.7kg).

\*The mattress intended for use on the bed shall be a full-size crib mattress having minimum dimensions of 51 5/8 in. (1310 mm) in length, 27 1/4 in. (690 mm) in width and 4 in. (100 mm) in thickness.

\*Guardrails provided must be used to avoid the formation of a gap between the mattress and the bed that could cause an entrapment.

### **NOTES ON ASSEMBLY:**

-During the assembly process whenever using screws or bolts, check each by placing the screw/bolt on the diagram of the item which is drawn actual size and design. Be sure to use the proper size and shape specified in the instructions.

-To assemble this unit you may be required to place the unit on it's side and face. It is strongly recommended that assembly is done on a soft, non-abrasive surface to avoid damaging the finish.

### **NOTES ON USE:**

Keep children and others safe by following these simple rules:

- **Do not** allow any child to play on furniture
- **Do not** allow climbing on any piece of furniture.
- **Do not** allow hanging from any piece of furniture.
- Always monitor your child's activity when in the nursery.

### **NOTES ON CARE AND MAINTENANCE:**

- **Do not** scratch or chip the finish.
- Inspect the product periodically, contact delta children's products for replacement parts or questions.
- **Do not** store the product or any parts in extreme temperatures and conditions such as a hot attic or a damp, cold basement. These extremes can cause a loss of structural integrity.
- To preserve the luster of the high quality finish on your product, it is recommended to place a doily or felt pad under any items you place on the finish.
- Clean with a damp cloth, then a dry cloth to preserve the original luster and beauty of this fine finish.
- Do not** use abrasive chemicals.
- Do not** spray cleaners directly onto furniture.
- Lift slightly when moving on carpeting to prevent leg breakage.
- Use of a vaporizer near furniture will cause wood to swell and finish to peel.

# PARTS: MAKE SURE THAT ALL PRE-ASSEMBLED PARTS ARE TIGHT.

A. HEADBOARD  
TOP RAIL(1)

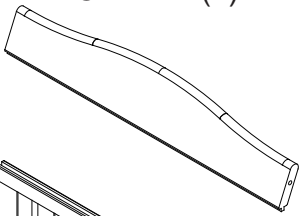

C. LEFT HEADBOARD LEG(1)

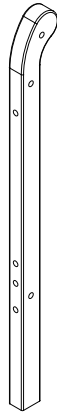

E. FOOTBOARD  
TOP RAIL(1)

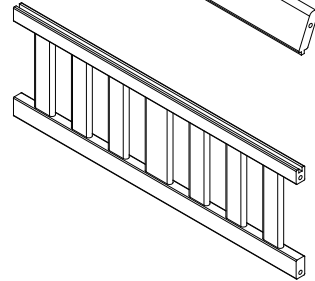
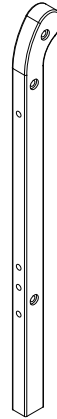
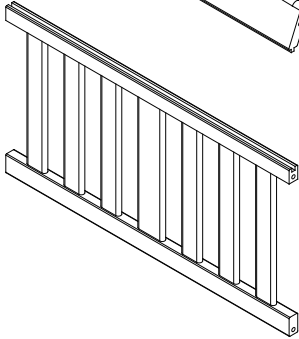
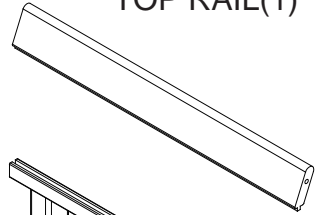

B. HEADBOARD(1)

D. RIGHT HEADBOARD LEG(1)

F. FOOTBOARD(1)

K. RIGHT BACK  
SIDE RAIL (1)

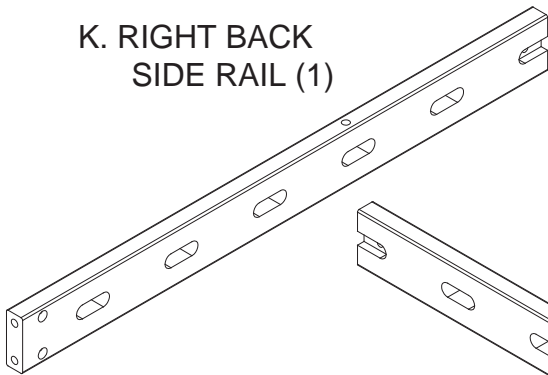

G. LEFT FOOTBOARD LEG(1)



J. LEFT BACK  
SIDE RAIL (1)

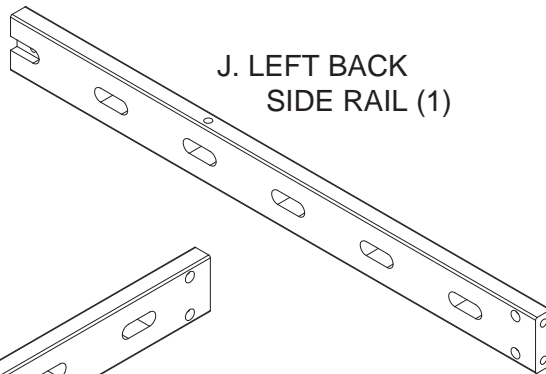

H. RIGHT FOOTBOARD LEG(1)

L. FRONT SIDE RAIL(2)

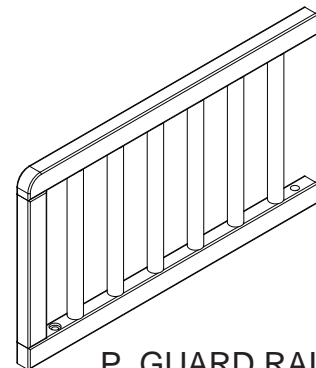
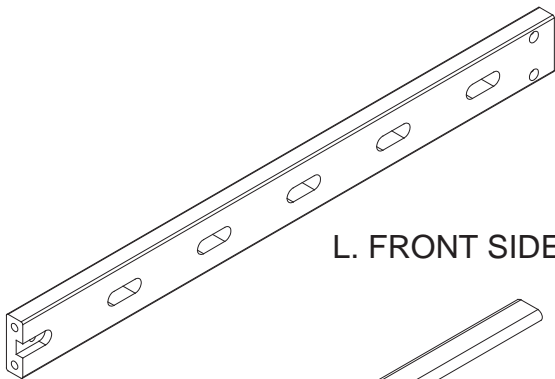

P. GUARD RAIL(2)

M. CROSS SLAT(10)

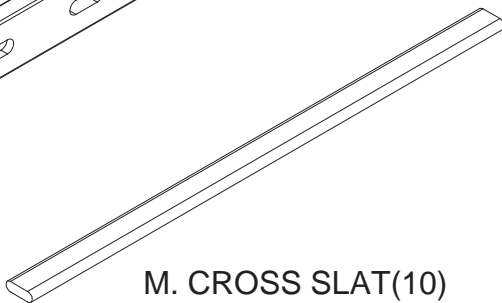

N. CENTER CROSS SLAT(1)

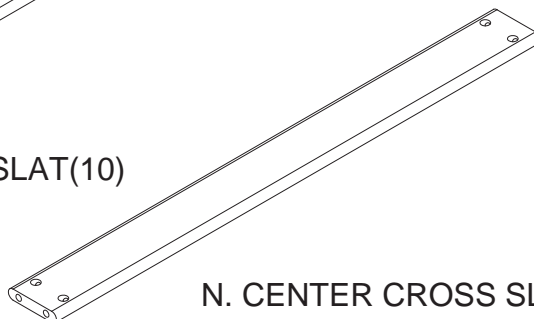

R. CENTER LEG(2)

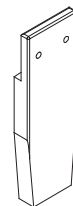

**PARTS:** MAKE SURE THAT ALL PRE-ASSEMBLED PARTS ARE TIGHT.



S. M6x90 mm BOLT x 4

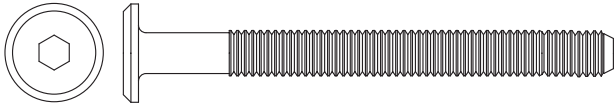

T. M6x63 mm BOLT x 24

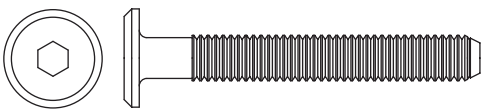

U. M6x45 mm BOLT x 2

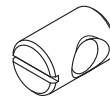

V. BARREL NUT x 28



W.  $\Phi$ 8x40 mm WOOD DOWEL x 4

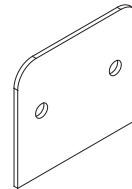

X. PLATE x 2

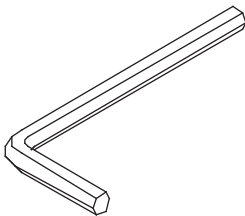

M4 ALLEN WRENCH SUPPLIED

# STEP 1

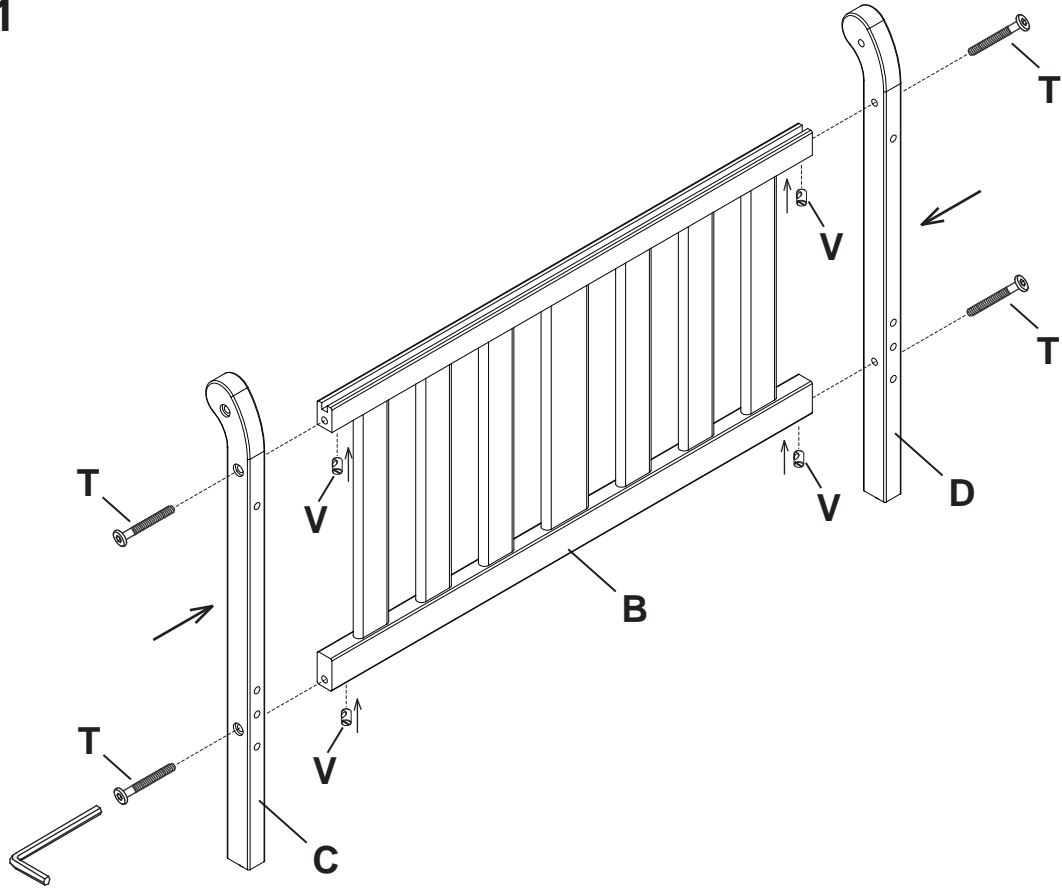

# STEP 2

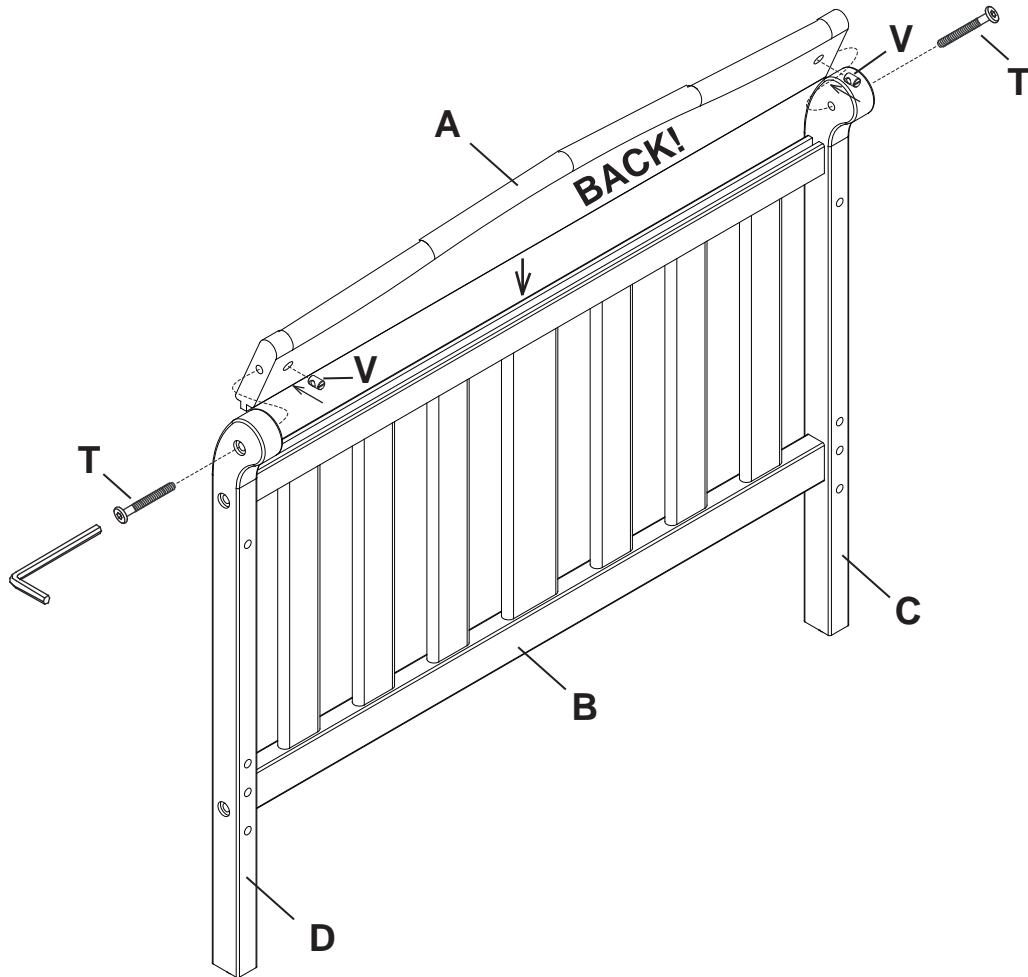

**STEP 3**

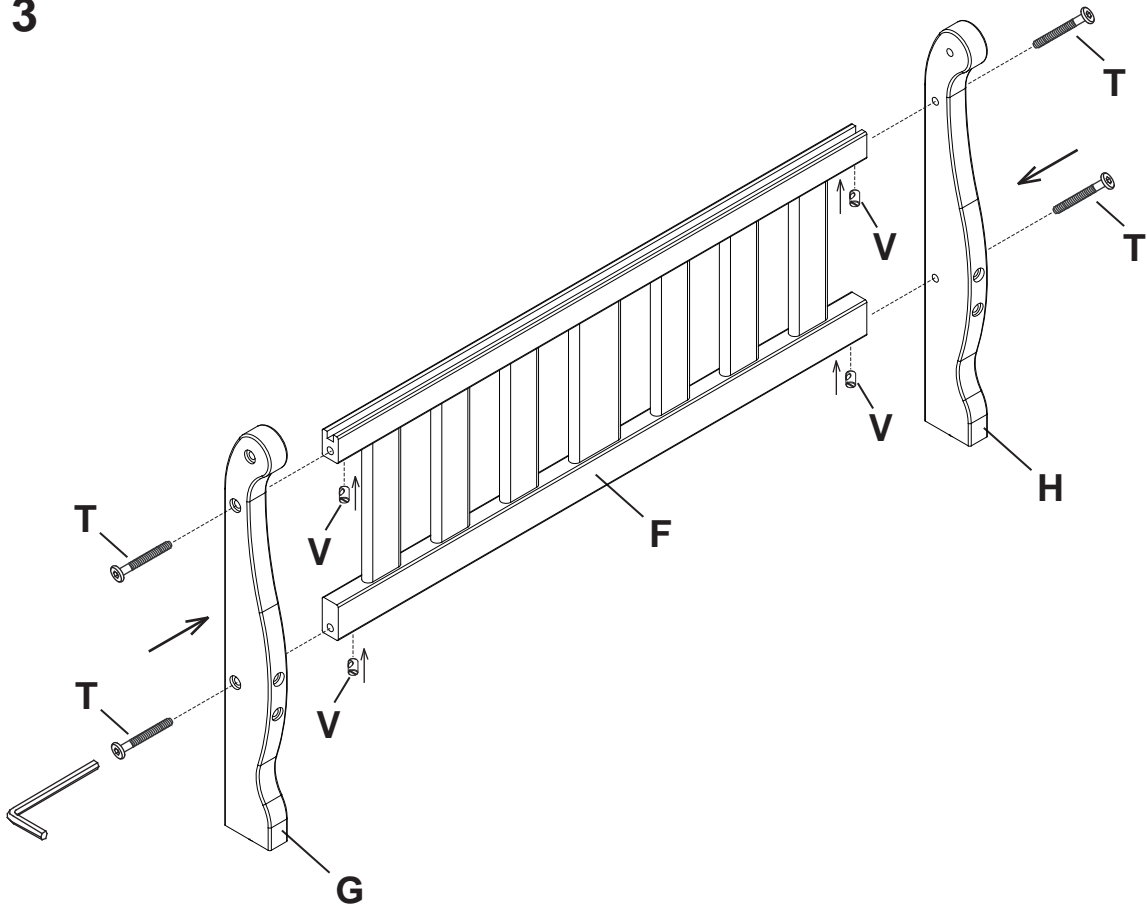

**STEP 4**

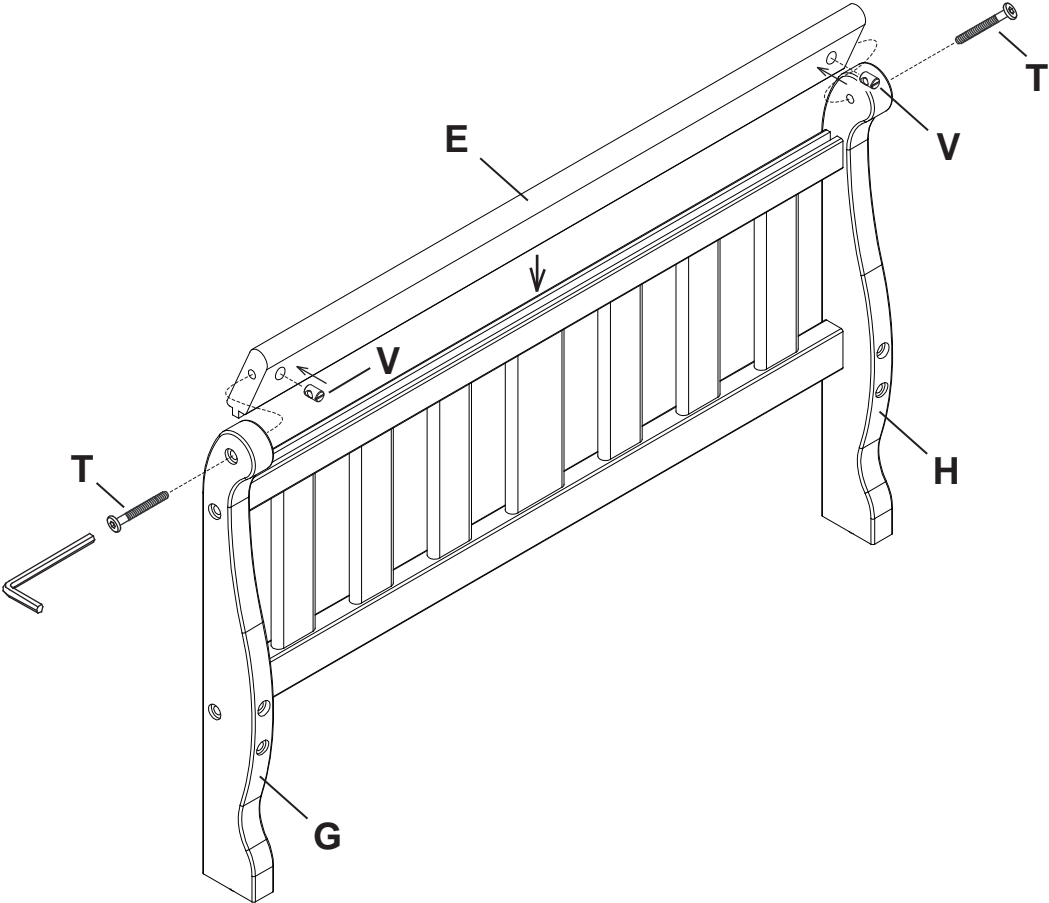

**STEP 5**

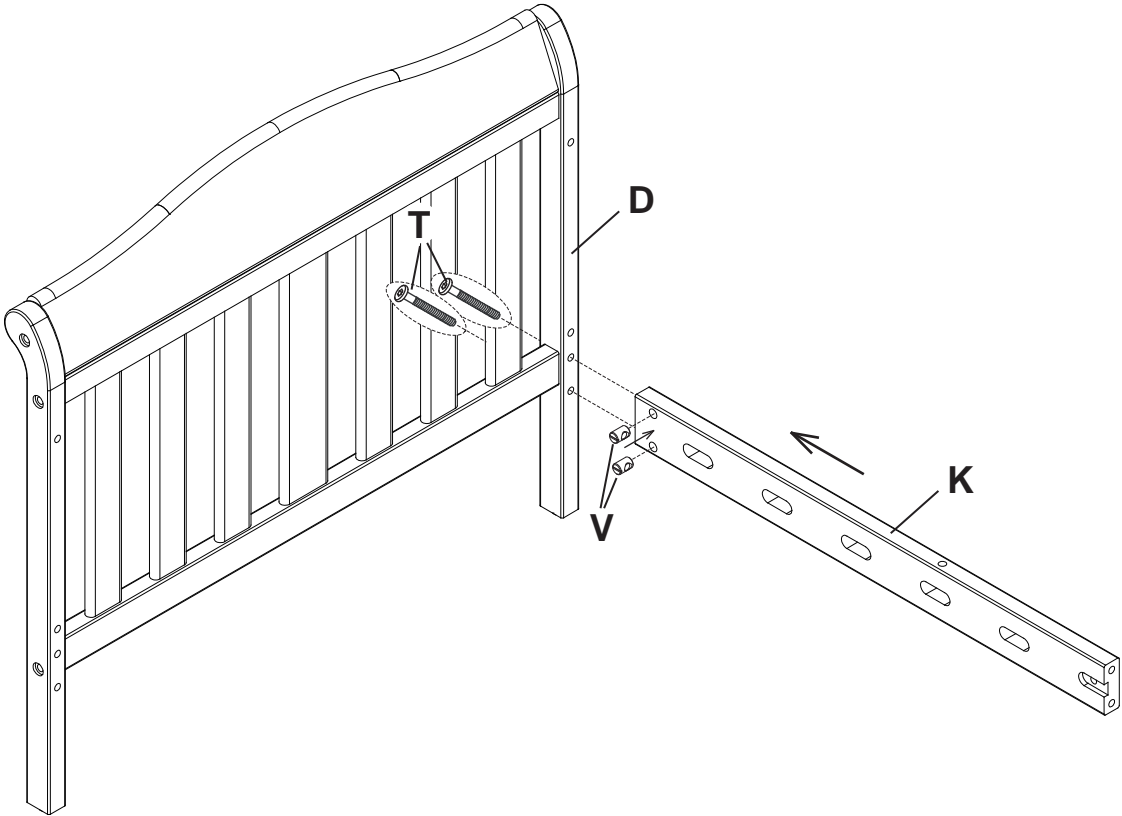

**STEP 6**

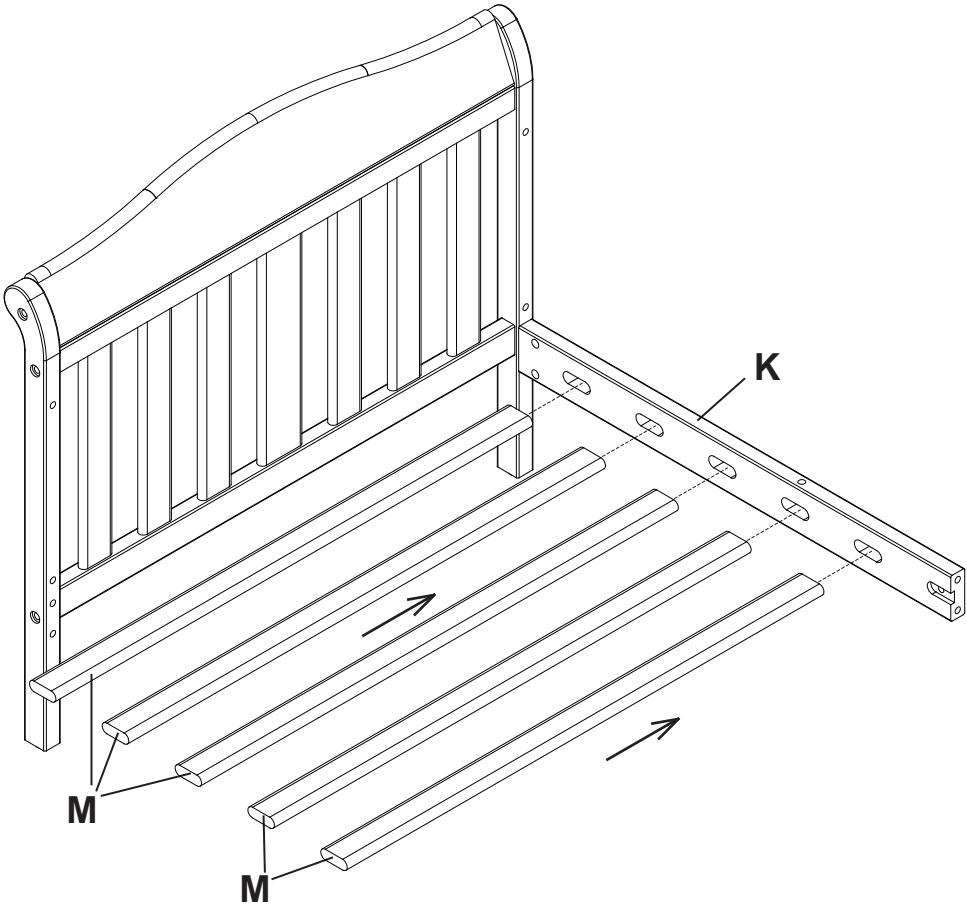

**STEP 7**

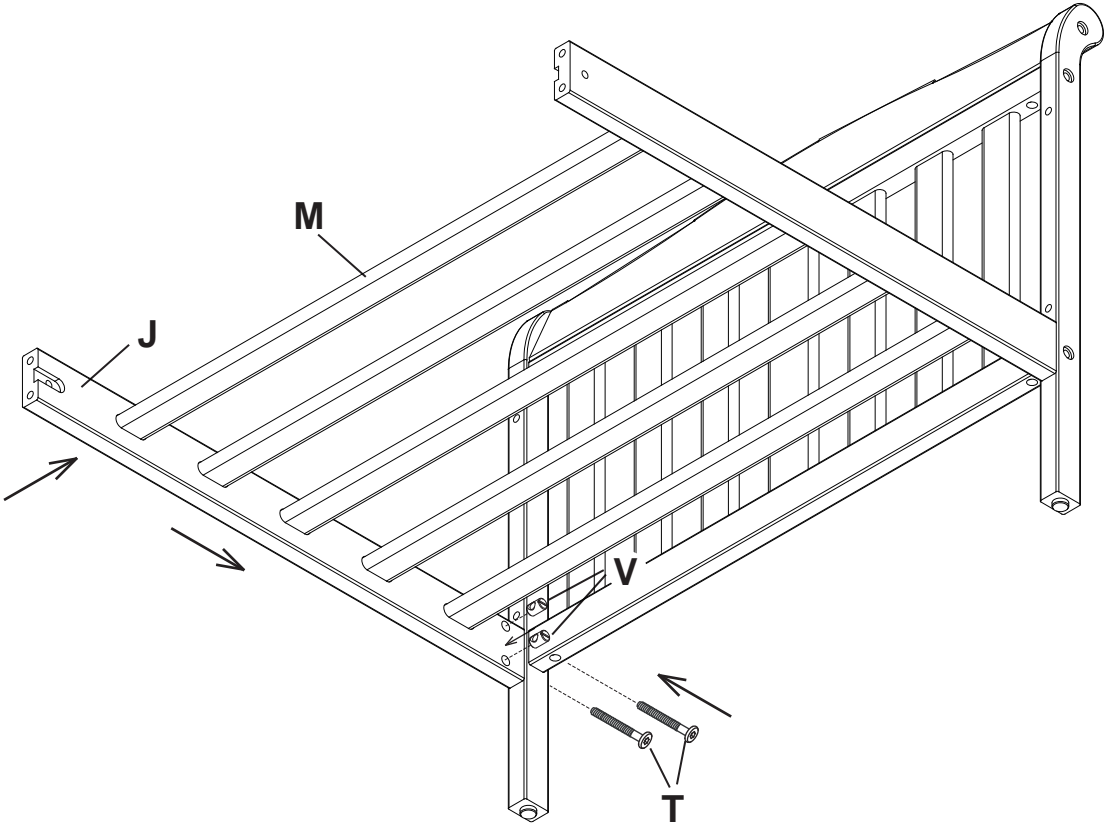

**STEP 8**

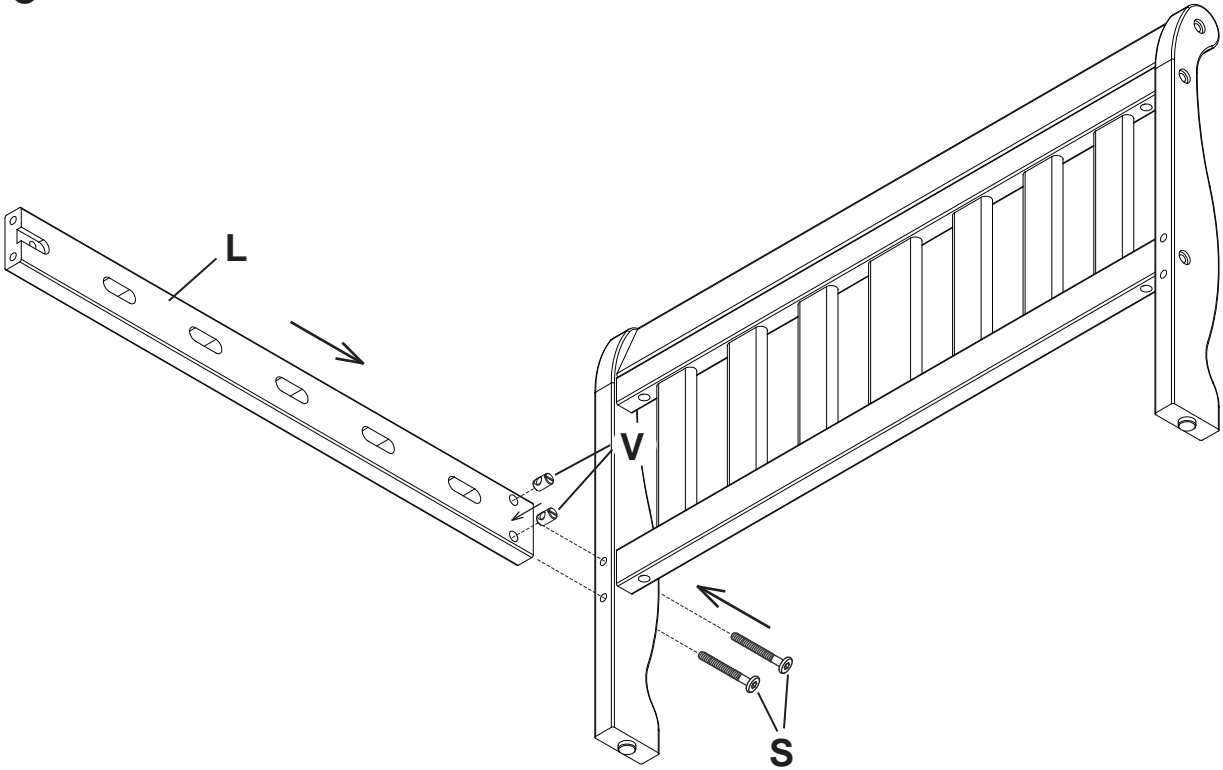



**STEP 9**

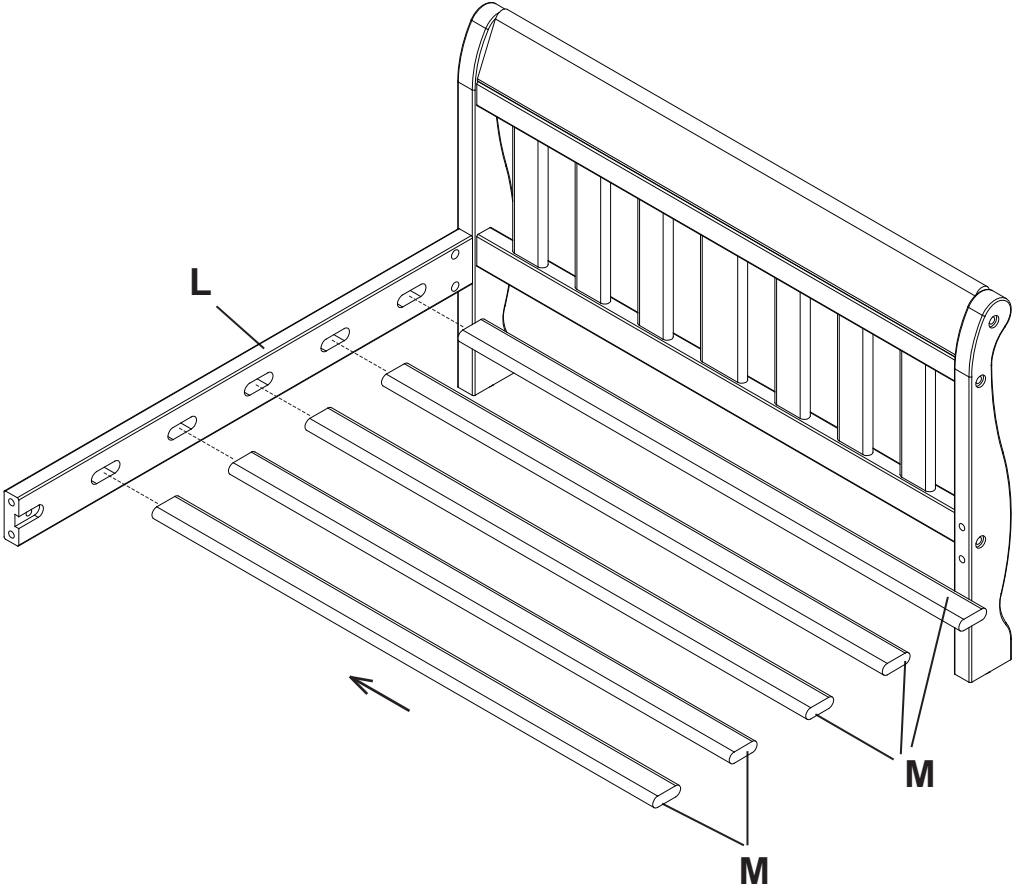

**STEP 10**

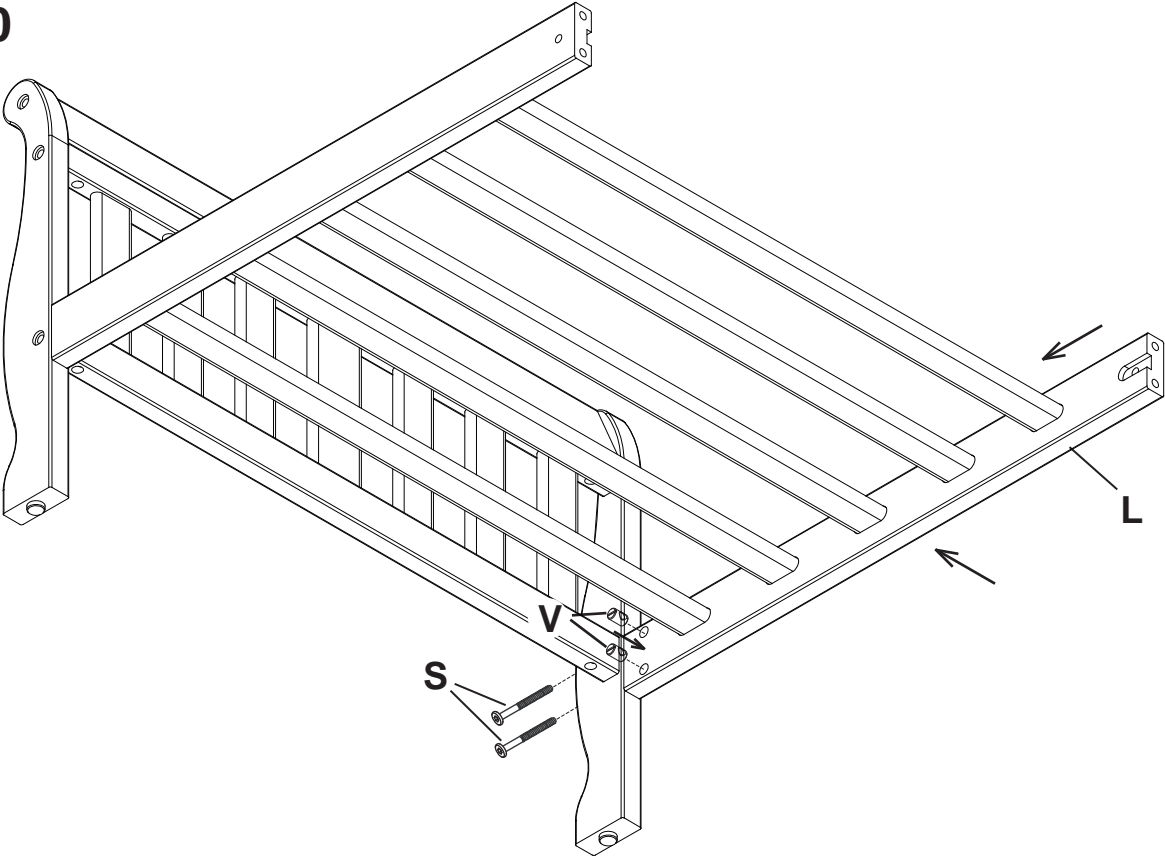

# STEP 11

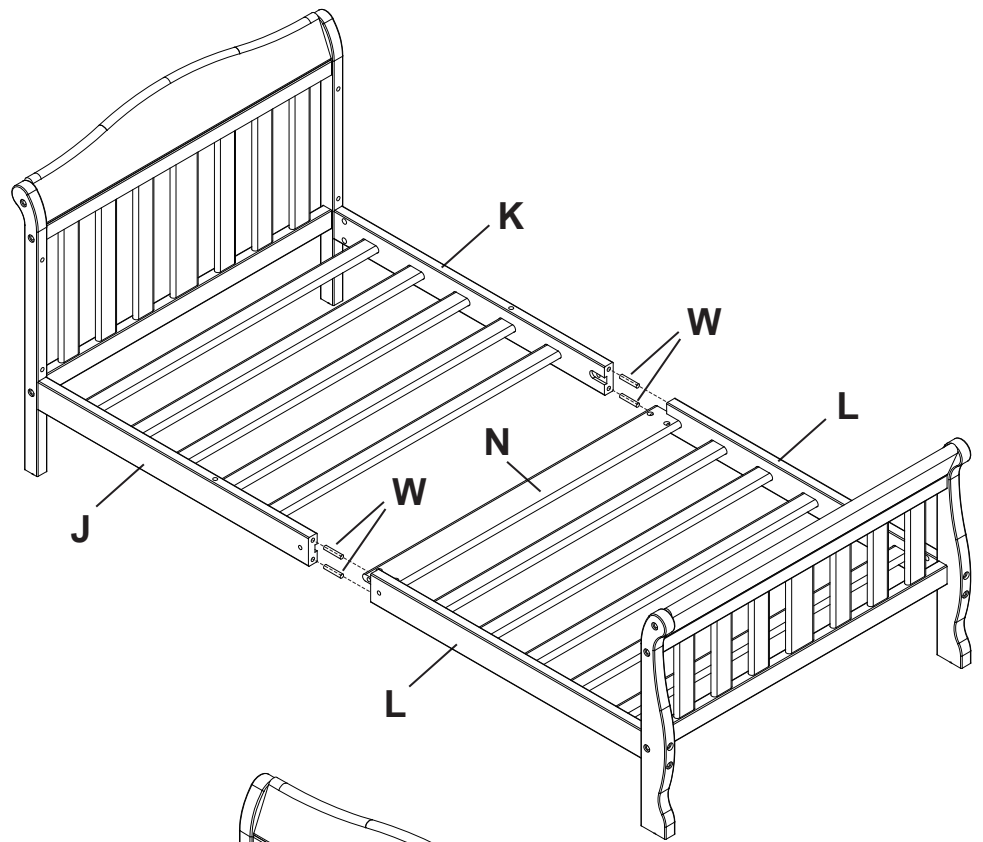

# STEP 12

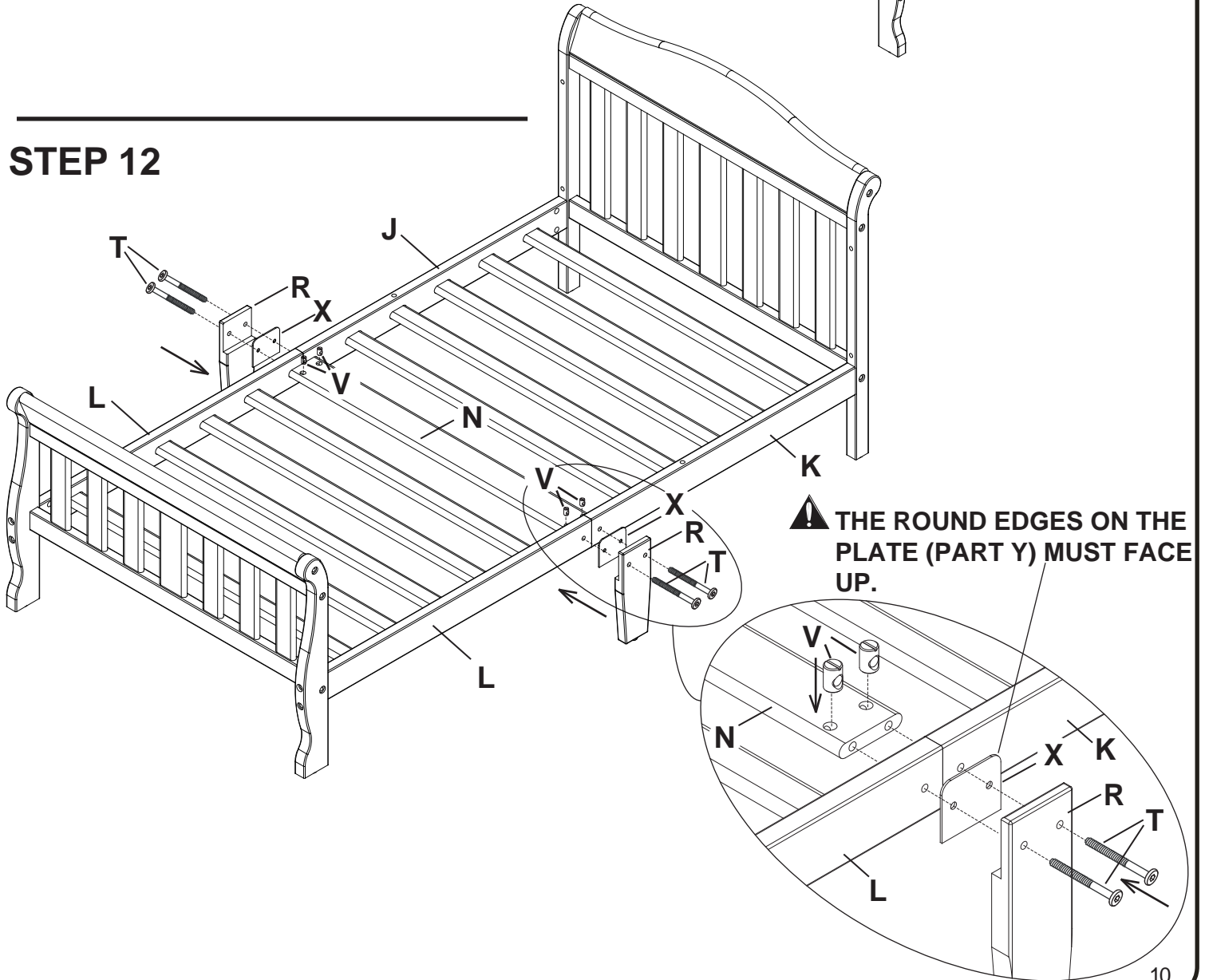

**STEP 13**

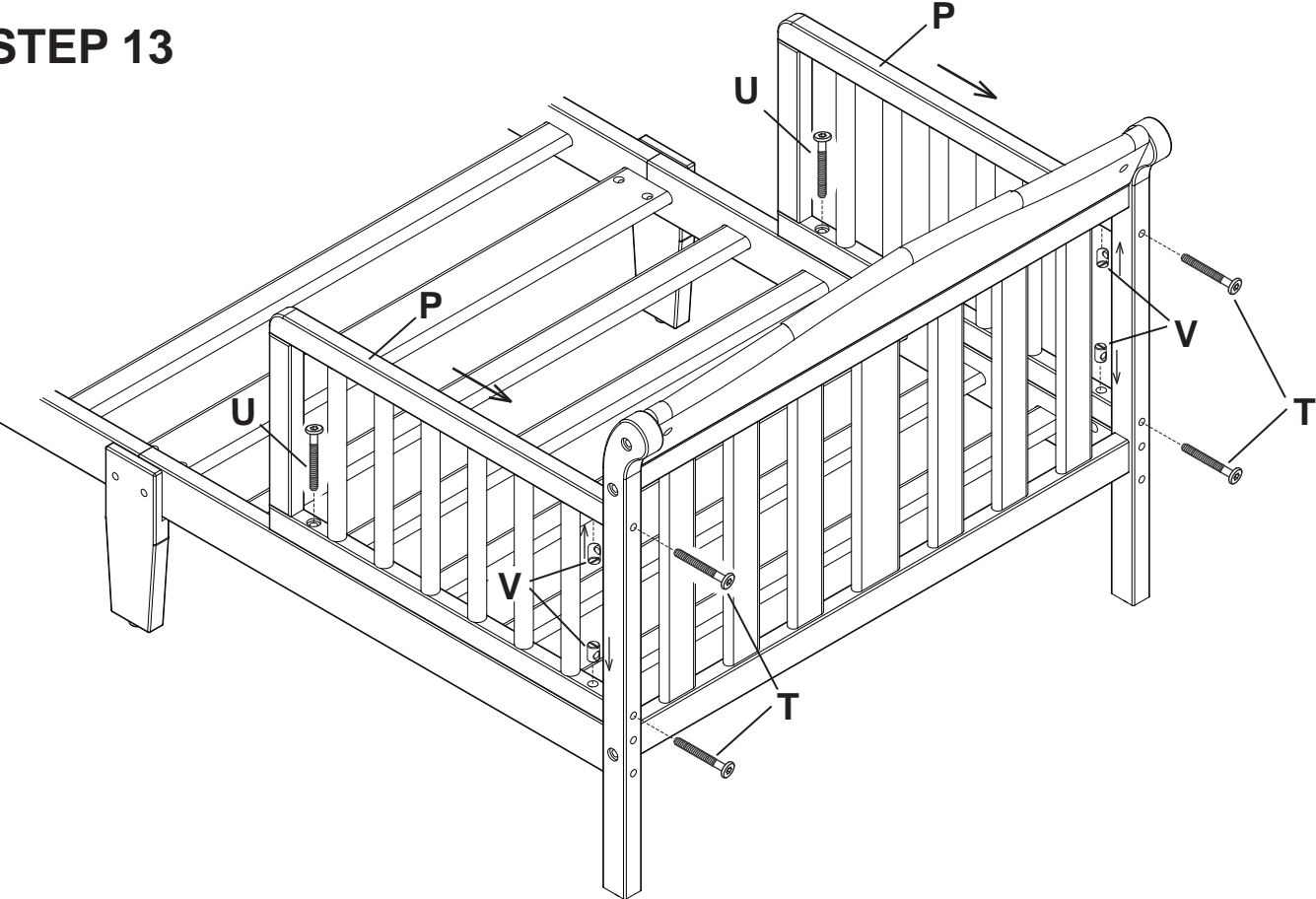

**FINAL**

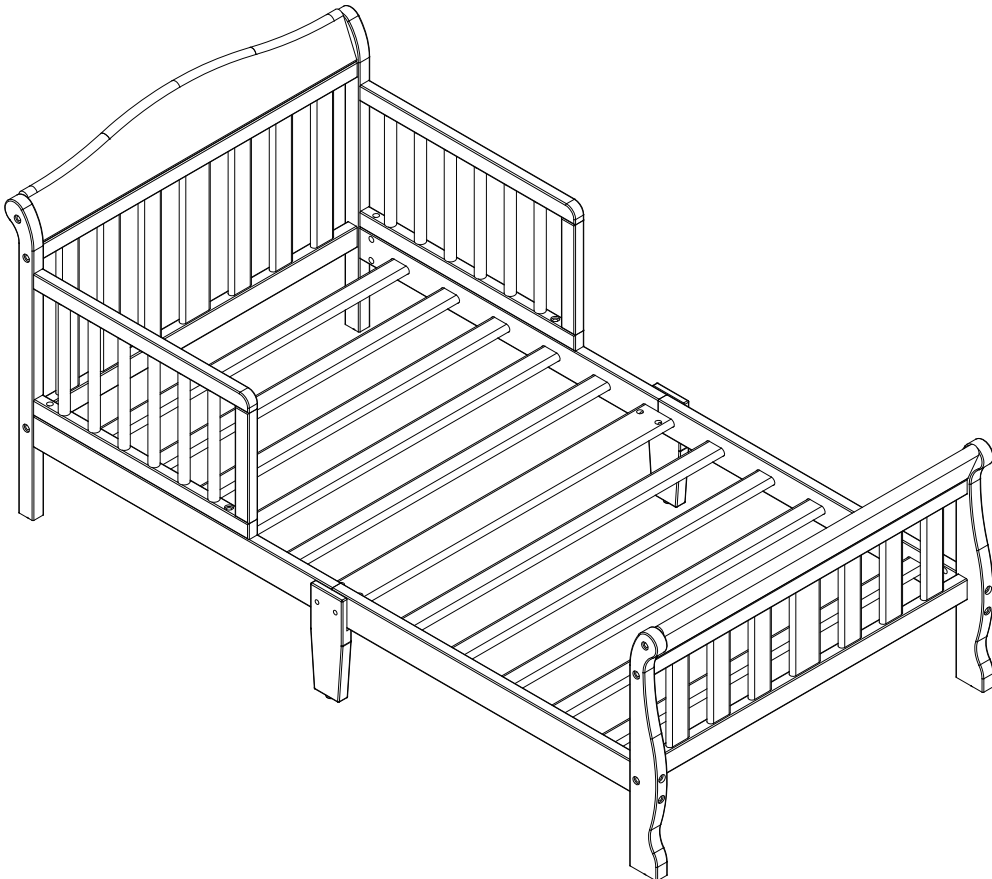



## Children's Products

Customer Service:

Web Site: [www.deltachildrenproducts.com](http://www.deltachildrenproducts.com)

Delta Children's Products

114 West 26th Street

New York, NY 10001

Tele.212-645-9033

**Warranty:** This Delta product is warranted to be free from defects for a period of 90 days from the date of purchase under normal use. This warranty extends only to the original retail purchaser and is valid only when supplied with proof of purchase, or if received as a gift, when the registration is on file with Delta.

To register your product for important safety alerts and updates to your product please visit <http://deltaenterprise.com/register.asp>

Please do not return this item to the store before contacting us about missing parts or with any questions.

To report a problem, please log on to [www.deltachildrenproducts.com](http://www.deltachildrenproducts.com) and click the Customer Service Tab, log on to [www.deltaenterprise.com/customer\\_service.asp](http://www.deltaenterprise.com/customer_service.asp), or contact us by phone at (212) 645-9033.

In the event that you need to contact our customer service department please have the Style Number and Lot Number available. Use the space below to make note of those numbers. They can be found on the label on Headboard bottom rail.

Style No.: \_\_\_\_\_

Lot No. : \_\_\_\_\_

Pack Date: \_\_\_\_\_

Date of Purchase: \_\_\_\_\_ (you should also keep your receipt)