

COMMERCIAL GRADE PORTABLE HUMIDIFIER



ULTRASONIC HUMIDIFIER SERIES



USER MANUAL

PLEASE READ THE ENTIRE MANUAL AND SAVE THESE INSTRUCTIONS

READ AND SAVE THESE INSTRUCTIONS

Thank you for choosing this AIRGREAN humidifier. We at AIRGREAN ENTERPRISE truly appreciate your business. This manual is intended to be a source of information on how to operate, maintain and troubleshoot your new humidifier.

Please take the time to read through this manual thoroughly.

Contents

I、 Product description·····	P2
II、 Filter installation·····	P3
III、 Pipe installation·····	P4
IV、 Control panel·····	P5
V、 System function operation·····	P6
VI、 Technical parameters·····	P6
VII、 Error codes·····	P6
VIII、 Troubleshooting guide·····	P7
IX、 Care and maintenance·····	P8
X、 Limited warranty·····	P9

I、 Product description

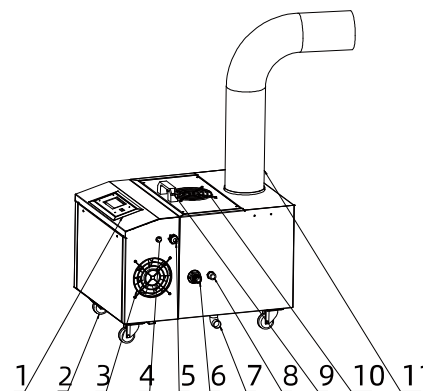

【Figure 1】 【AG-H150】

1. Control panel
2. Universal wheel
3. Radiator fan
4. Humidity sensor connector
5. Power supply (10a grounding plug)
6. Water inlet (1/2) external thread
7. Water outlet (1/2) internal thread
8. Overflow (1/2) external thread
9. Handle
10. Fog blowing fan
11. Mist outlet

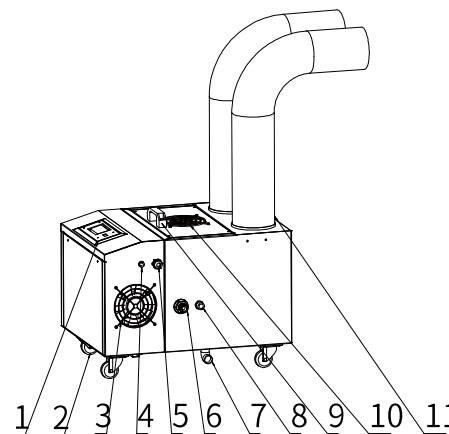

【Figure 2】 【AG-H300】

1. Control panel
2. Universal wheel
3. Radiator fan
4. Humidity sensor connector
5. Power supply (10a grounding plug)
6. Water inlet (1/2) external thread
7. Water outlet (1/2) internal thread
8. Overflow (1/2) external thread
9. Handle
10. Fog blowing fan
11. Mist outlet

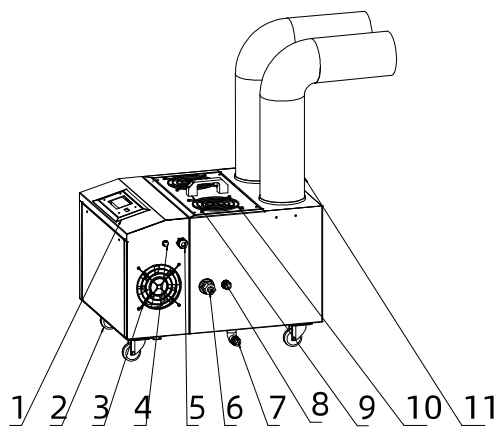

1. Control panel
2. Universal wheel
3. Radiator fan
4. Humidity sensor connector
5. Power supply (10a grounding plug)
6. Water inlet (1/2) external thread
7. Water outlet (1/2) internal thread
8. Overflow (1/2) external thread
9. Handle
10. Fog blowing fan
11. Mist outlet

【Figure 3】【AG-H600】

II、Filter installation

1. Filter bracket

Using the supplied screws, attached the filter underneath the bracket (See Fig. 4)

Attach bracket to the pre-drilled holes located on the backside of the unit (See Fig. 5)

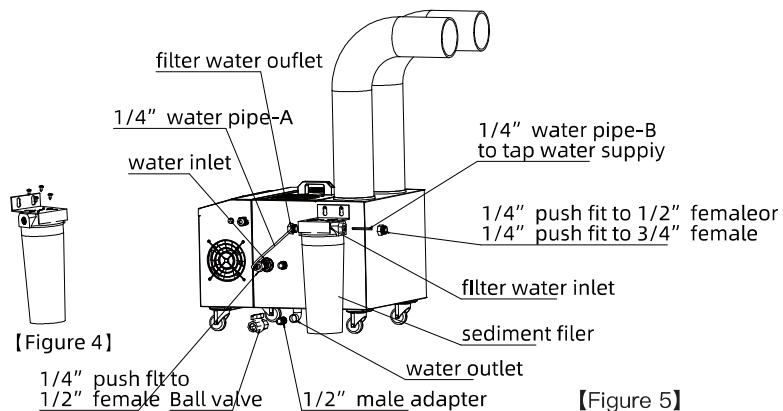

【Figure 4】

【Figure 5】

2. Filter connections

Attach hose connectors onto the end of each hose.

PIPE-A: Connect one end to the filter 1/4" hose and the other end to the water inlet port on the unit. (See Fig. 5)

PIPE-B: Connect one end to the filter 1/4" hose and the other end to the fresh water supply.

III、Pipe installation

In order to avoid dripping on the ground, the fog outlet noles must be pointing upwards at a minimum of 30 degrees.

Height at the end of the pipe needs to be higher than the humidifying section, 1/8" + rise per foot. (See Fig. 6).

DO NOT connect the water pipe with a "trap". (See Fig. 7).

To have the best result, outlet pipe connections should be no shorter than 18" before an elbow connection. (See Fig. 8)

Note: The direction of the fog outlet can not be towards the top of the fan.

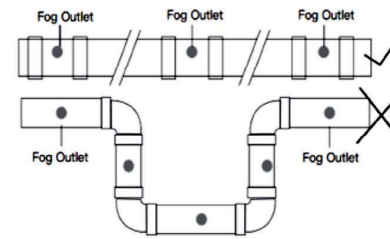

【Figure 6&7】

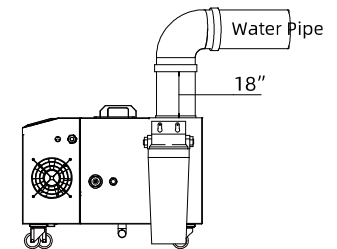

【Figure 8】

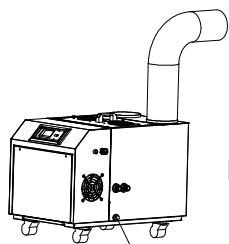

【Figure 9】

Water outlet

Note: When in use, the water level of the sewer drain should be lower than the position of the machine drain(See Fig. 9).

Before using, remove the plug and install the ball valve (spare parts are free)

IV、Control panel



【Figure 10】

@Button description(Fig. 10)

- 1、 Power switch: press the “POWER” button to start or stop unit.
- 2、 Connect the power supply, connect the humidity sensor, the display shows the current environmental humidity.
- 3、 When the “Humidity” flashes in the running state, it indicates that the current ambient humidity is higher than the set point, and it is in the standby state;
When the ambient humidity is lower than the set point, the device will automatically restart .

@Timer

Timer to start: Press “SET” button enter the timing setting,when “time start up” flashes, press “+” or “-” buttons to set timer range between 1 to 24 hours.

Timer to stop : Press “SETTING” two times, enter timing shutdown setting. The “timed startup” flashes, press “+”or “-”to set timer stop working .

@Humidity

Press “+” or “-” buttons to adjust humidity between 10–90% range.

V、System function operation

Automatic control: When the ambient humidity reaches the set point , it will automatically stop running, the fan will delay 30s.
When the current ambient humidity is lower than the set point , automatically restart , the set humidity range is adjustable from 10–95%.

Low water level warning: When the system detects the water level is lower than the warning level, the unit will stop automatically.

Special note:Water level should be 3mm–12mm higher than the atomizer. Too low water level will affect the fogging situation. (Note: In order to prevent the float shift during shipping, suggest open water tank to check whether the float position is correct).

VI、Technical Parameters

Model	Power Supply	Power Watts	Spray Capacity pint/hour	Way to control	Outlet diameter (Inches)	Dimensions (Inches)	N.W. (lbs)
AG-H150	110V-60Hz	235	6.2	Automatic	4.33 single outlet	20.04’’*15.16’’*12.05’’	38.1
AG-H300	110V-60Hz	330	12.5	Automatic	4.33 double outlet	20.04’’*15.16’’*12.05’’	40.5
AG-H600	110V-60Hz	665	25	Automatic	4.33 double outlet	20.04’’*15.16’’*12.05’’	50.7

VII、Error codes

Code	Meaning	Processing method
E2	The humidity sensor is faulty or not connected	Replace the humidity sensor or connect the sensor
E3	The temperature sensor is faulty or not connected	Replace the temperature sensor or connect the sensor

VIII、 Troubleshooting guide

Problem	Possible causes	Solution
Device is not running	A. No power supply B. The fuse is blown C. Power switch is off D. Humidity has reached the set requirement	A. Check power supply and restore power supply B. Replace the fuse of the same specification C. Turn on the power switch
The supply tank is not filling with water	A. No water from the pipe B. The water inlet float is blocked	A. Check the water supply pipeline B. Cleaning the magazine of the float hole position
Equipment does not stop water	A. The floating ball is displaced B. The float has foreign matter C. Damage to the float	A. Adjust the correct position B. Remove foreign objects C. Replace the float
The fog lamp does not light up	A. The floating ball is displaced B. The float has foreign matter C. Damage to the float	A. Adjust the correct position B. Remove foreign objects C. Replace the float
Water overflows from the cabinet	A. Leaking water tank B. The fog is poured back and the blower outlet overflows	A. Repair or replace the water tank B. Check the fan port
Reduced or no spray	A. Too much scale inside the water tank B. Atomized presbyopia C. Voltage reduction D. The water level of the water tank is too high or too low E. There are oily substances in water	A. Cleaning the water tank and atomizing chip B. Replace the atomizing chip C. Maintain normal voltage D. Adjust the water level E. Clean the water tank and pipeline
The mist has an odor	A. There are other substances in the pipeline or water tank	A. Clean the unit

IX、 Care and maintenance

Clean the filter:

The filter should be cleaned regularly, at least once a month.

1. Unscrew the cover of the filter with the wrench included. (See Fig.11)
2. Clear the dirt on the filter element.
3. Re-install the cover.
4. The filter should be replaced every 3-6 months.

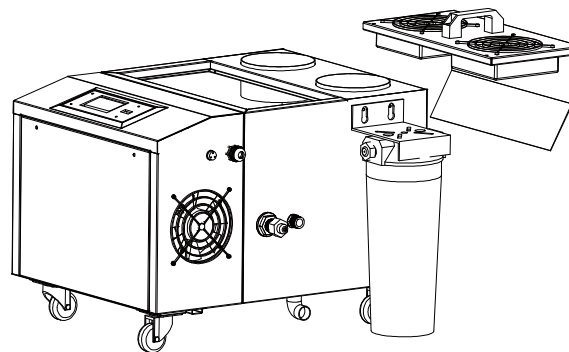

【Figure 11】

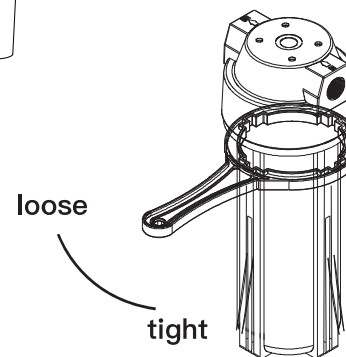

【Figure 12】

X、 Limited warranty

- The warranty period is one year for the general machine. This warranty applies to repair or replacement of product found to be defective in materials or workmanship. This warranty does not apply to damage resulting from unusual wear, abusive, unreasonable use or supplemental damage. This warranty does not cover damage from unauthorized repairs or from any use not in accordance with the instruction manual. Defects that are the result of normal wear and tear will not be considered manufacturing defects under this warranty.
- Filter and filter element are consumable material and is not covered by the warranty.

www.airgrean.com