



# 570 FREE/COMBINED CHLORINE TEST PROCEDURE

The Free/Combined Chlorine test procedure utilizes the **STANDARD STRIP METHOD** using the eXact iDip® 570 Smart Photometer System®. For tips on achieving best accuracy, and additional information regarding features of the eXact iDip® 570 photometer and the eXact iDip® app, please refer to the eXact iDip® Smart Guide. You can download a copy on our website at exactidip.com. **Test procedures can vary from test to test. Read full instructions and watch instructional video within the app.**

## YOU WILL NEED

- eXact iDip® 570 photometer
- Your smartphone/tablet with the eXact iDip® app installed
- (1) eXact® Strip Micro Free Chlorine (DPD-1) (Part No. 486637)
- (1) eXact® Strip Micro Combined Chlorine (DPD-3) (Part No. 486638)
- Water sample for rinsing and testing

## 1 SELECT CUSTOMER

- Select 'Customers' from the Home screen.
- Choose customer from list
  - OR** Tap 'Add customer from contacts' and choose customer from your contacts list
  - OR** Tap '+' to create a new customer
- Android users: If no address is found, tap "No addresses found"
- Verify customer has been selected

*Note: To take full advantage of the GPS and Data Storage features, each test result must be linked to a contact. Individual users may select their contact listing.*

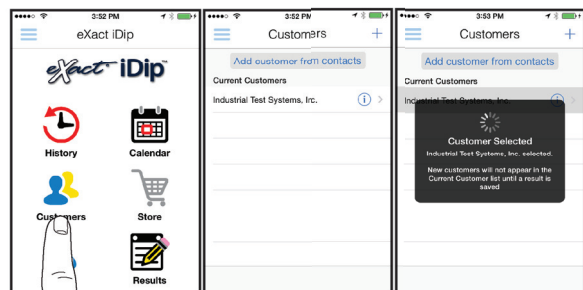

a b c

## ACT IDIP® 570



Turn the eXact iDip® 570 photometer on.

## TOOTH TEST

Tap the menu icon and select 'Bluetooth Test' from the

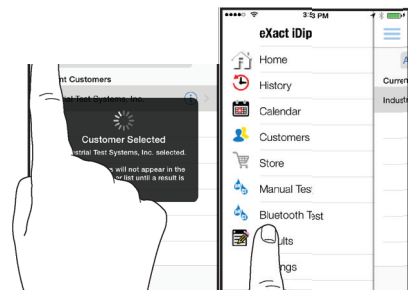

## 4 CONNECT EXACT IDIP® 570

The eXact iDip® app will automatically connect to the most recently used eXact iDip® 570 photometer. If not, select your eXact iDip® 570 from the bottom of the screen.

*Note: Always connect your eXact iDip® photometer via the Bluetooth® connection within the app. If you experience an issue connecting your device, check that your smartphone/tablet's Bluetooth® is turned on and your device is compatible.*

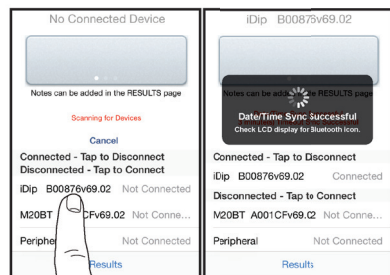

## 5 SELECT TEST

Tap **SELECT** Test' at the top and select **570 Chlorine, Free/ Combined/Total CL**. The eXact iDip® photometer and eXact iDip® app will both display the test selection for Free Chlorine.

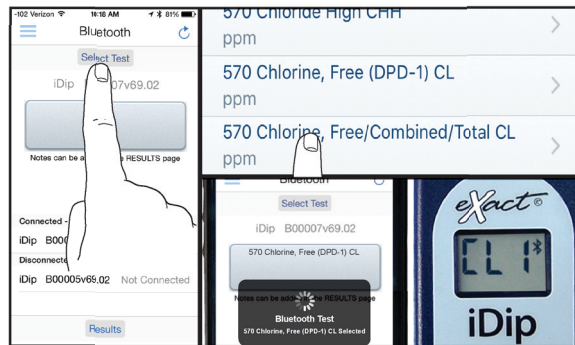

## 6 FILL CELL

Before testing, rinse CELL and clean with brush thoroughly. Finally, rinse the cell 3 times with the water sample to be tested, then **FILL** cell to capacity to begin test (refer to video in app).



## 7 CAP CELL

Place the cap on the cell and the eXact iDip® photometer ready for testing.



## 8 REMOVE STRIP

Remove one eXact® Strip Micro Free Chlorine (DPD-1) (Part No. 486637) and set in a dry, convenient place. Replace cap on bottle.



# 9 REMOVE STRIP

Remove one eXact® Strip Micro Combined Chlorine (486638) and set in a dry, convenient place. Re



**READ**

...countdown and simultaneously ...st strip in the sample, gently touching the bottom of the cell. Use a gentle constant back and forth motion (2 strokes per second) until the timer displays "1". Remove and discard the strip.

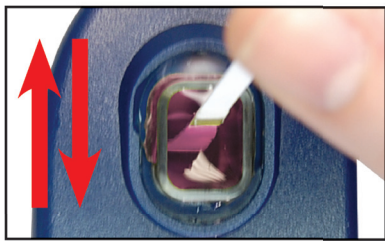

# 11 CAP CELL AND READ RESULT

Place the Cell Cover onto the CELL and **READ** result displayed as Free Chlorine.

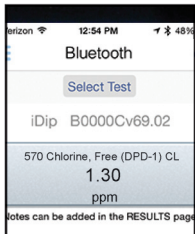

# 12 TAP OK

App will show 'Chlorine, Combined (DPD-3) CL Second Command Sent'. Tap **OK**. The eXact iDip® photometer and eXact iDip® app will both display the test for Combined Chlorine.

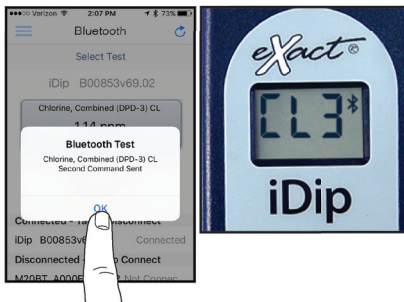

**ZERO/ON**

...e test (step 11) still in the cell, photometer display reads 0PPM ...ntinue testing.

**READ**

...a 20 second countdown and simultaneously ...st strip in the sample, gently touching the bottom of the cell. Use a gentle constant back and forth motion (2 strokes per second) until the timer displays "1". Remove and discard the strip.

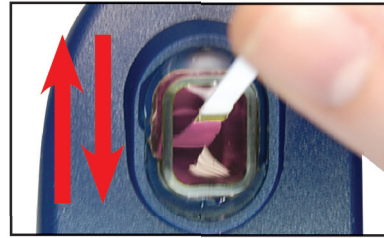

# 15 CAP CELL AND READ RESULTS

Place the Cell Cover onto the CELL and **READ** result displayed as Combined Chlorine.

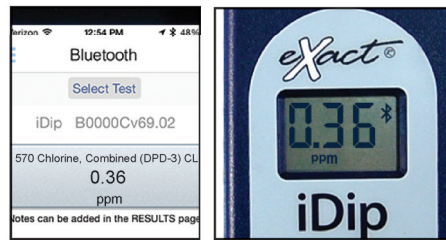

# 16 CLEAN CELL WITH BRUSH

After testing, rinse CELL immediately and clean with brush to remove reagents which coat the CELL wall.



## TIPS

t

## MANAGE YOUR RESULTS

Save, send, and share results instantly using the eXact iDip® app. For step-by-step instructions, refer to the eXact iDip® Smart Guide. You can download a pdf copy on-line at exactdip.com.

