

Make: Subaru

Model: 2021+ Crosstrek XV

Applications: Light Conversion

PACKAGE CONTENTS				TOOLS	
QTY		QTY			
2	Light Conversion Bracket	2	1/4-20 x 3/4" Hex Bolt	Phillips Screwdriver	
1	Wire Harness Adapter Kit (Optional)	2	1/4" Internal Lock Washer	Short Flat Head Screwdriver	
		2	1/4-20 Locking Hex Nut	Socket Wrench	
				7/16 & 10mm Socket or Wrench	
				Wire Stripper	
				Wire Crimp	
				Panel Removal Tool	

INSTALLATION INSTRUCTIONS

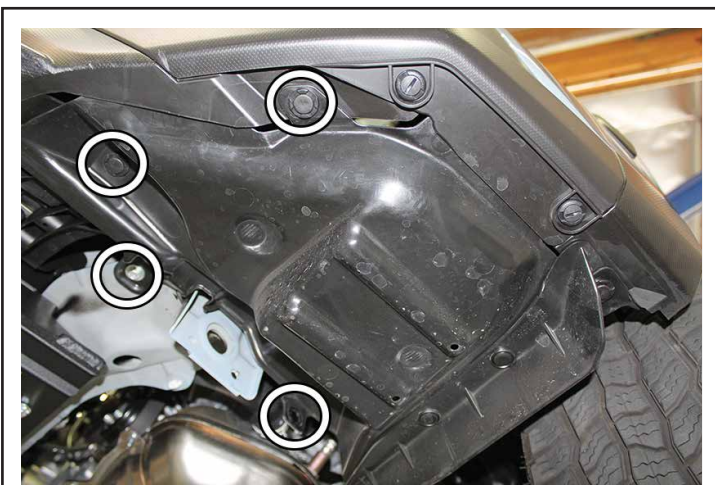

Remove splash guard underneath foglight on driver and passenger sides to gain access to foglight area. (Save factory hardware and clips for later).

1

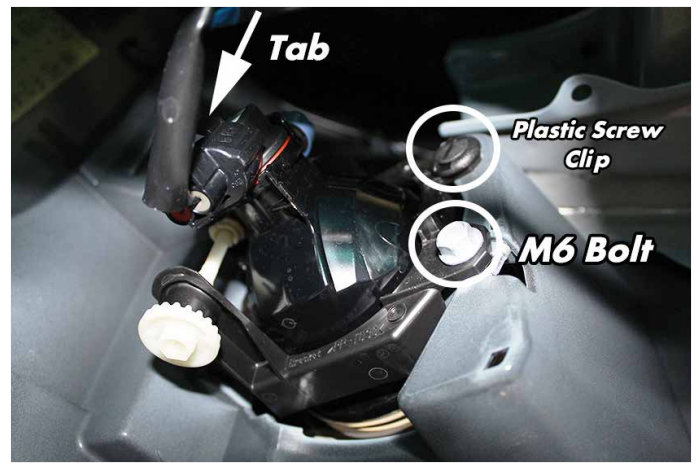

View behind bumper

Remove the factory foglight by removing the M6 flange-head bolt and the plastic screw clip (driver side pictured). Retain factory M6 flange-head bolt for reuse. Unplug the light by depressing the tab on the connector and pulling away from the light.

2



Attach the new foglight in the Light Conversion Bracket like shown above. Repeat on the passenger side.

3

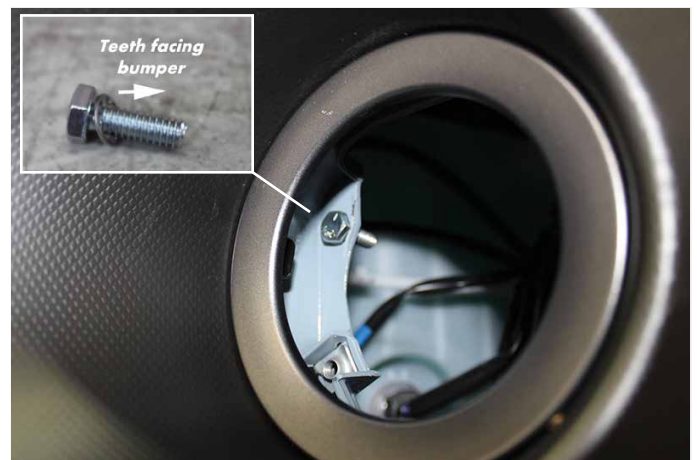

Insert the 1/4" hex bolt and internal lock washer into the top mounting hole in the bumper, as shown above.

Note: Face the internal lock washer with the teeth biting into the bumper.

4

DISCLAIMER FOR RALLY INNOVATIONS PRODUCTS: Buyers assume all risk and liability whatsoever for the installation and the use of Rally Innovations products. Rally Innovations products are sold as decorative accessories and should not be relied upon as protection for the vehicle or occupants in the event of a collision or roll over. Vehicles equipped with a supplemental restraint system (air bag) deployed by impact should not be modified by any aftermarket Light Bar or Skid Guard without first consulting the vehicle manufacturer. Rally Innovations, a subsidiary of Pentech Automotive assumes no liability for injury, loss, incidental or consequential damages in the event of a collision or roll over.



Insert the new foglight assembly into the front bumper in the reverse order of removal of the factory foglight. Slide the left tabs into the mounting slots and slide the top right hole onto the 1/4" bolt. Tip: Support the back of the top bolt with your finger as you fasten the locking nut onto the assembly.

5



Fasten locking nut onto top bolt and insert factory M6 flange-head bolt into bottom right hole and fasten down. Tighten hardware.

6

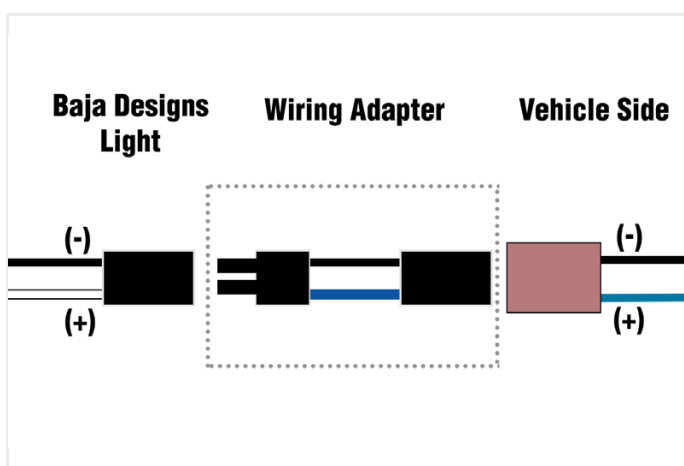

Installing Pigtail Adapter (Optional): Note the orientation of the optional pigtail adapter.

7

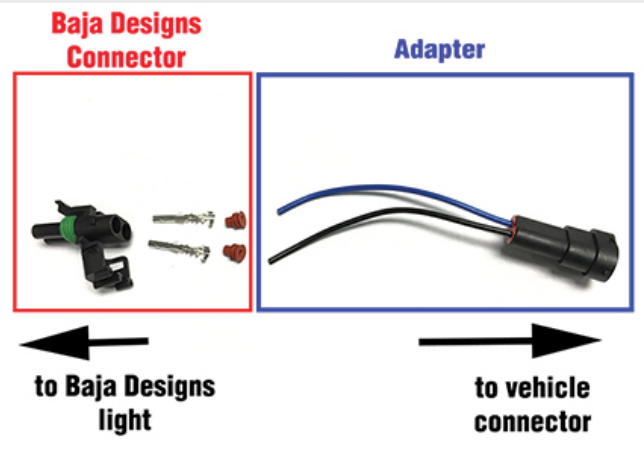

Assemble the Baja Designs light connector onto the optional pigtail adapter in the order shown above. Remember to note the polarity shown in the previous step before proceeding, you only get one shot installing the connector.

8



Return the factory fasteners back into the factory splash guard and reinstall splash guard as seen in step 1.

Completed assembly shown above.

9