

Make: Subaru  
 Model: 2010-2012 Outback  
 Product: Light Conversion

PACKAGE CONTENTS				TOOLS	
QTY		QTY			
2	Light Conversion Bracket	2	1/4" SAE Flat Washer	Flat Head or Phillips Screwdriver Socket Wrench 10mm Socket or Wrench Wire Stripper Wire Crimp	
1	Wire Harness Adapter Kit (Optional)				

## INSTALLATION INSTRUCTIONS

Remove the plastic rivets from the driverside splash guard to access the foglight area (keep for later). Repeat on the passenger side.

**1**

Unplug and remove the OEM foglight. Repeat on passenger side.  
 Note: Foglight is attached by (1) M6 bolt; use 10mm socket to remove.

**2**

Attach new foglight to Light Conversion Bracket like shown above. Repeat on passenger side.

**3**

Add (1) 1/4" SAE Flat Washer to factory M6 bolt, like shown above.

**4**

DISCLAIMER FOR RALLY INNOVATIONS PRODUCTS: Buyers assume all risk and liability whatsoever for the installation and the use of Rally Innovations products. Rally Innovations products are sold as decorative accessories and should not be relied upon as protection for the vehicle or occupants in the event of a collision or roll over. Vehicles equipped with a supplemental restraint system (air bag) deployed by impact should not be modified by any aftermarket Light Bar or Skid Guard without first consulting the vehicle manufacturer. Rally Innovations, a subsidiary of Pentech Automotive, assumes no liability for injury, loss, or incidental or consequential damages in the event of a collision or roll over.



Install the new foglight assembly onto the bumper using M6 bolt and washer from previous step.

5

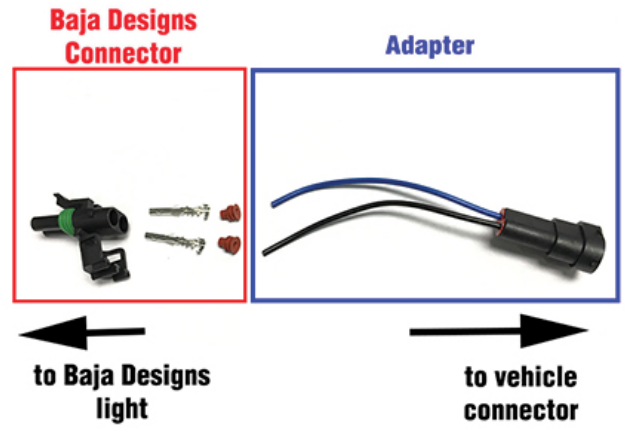

**Wiring Adapter (optional):** Refer to diagram above for orientation of connector pieces when attaching Baja Designs male plug end to Wire Harness Adapter.

6

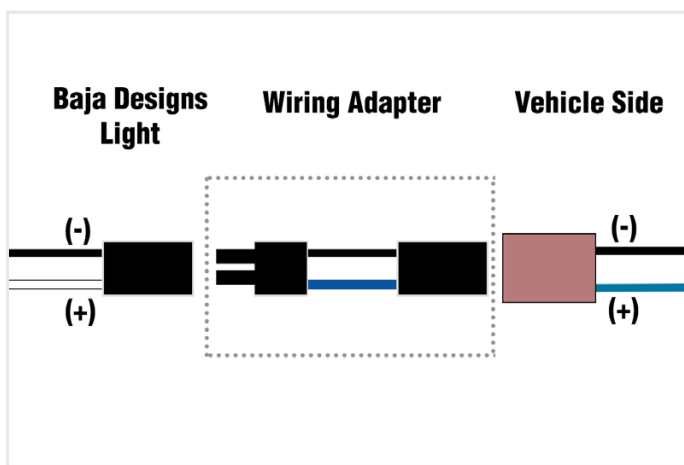

**Wiring Diagram:** Ensure polarity (-/+ ) on the Baja Designs light matches the polarity on the vehicle side.

Note: Vehicle side wires may be different color, black wire does not always indicate (-) negative polarity so please double check before installing.

7



Repeat all steps on the passenger side.

Completed assembly shown above.

8