

# LE TOY VAN®

## BARBAROSSA PIRATE SHIP

Assembly instructions

TV246

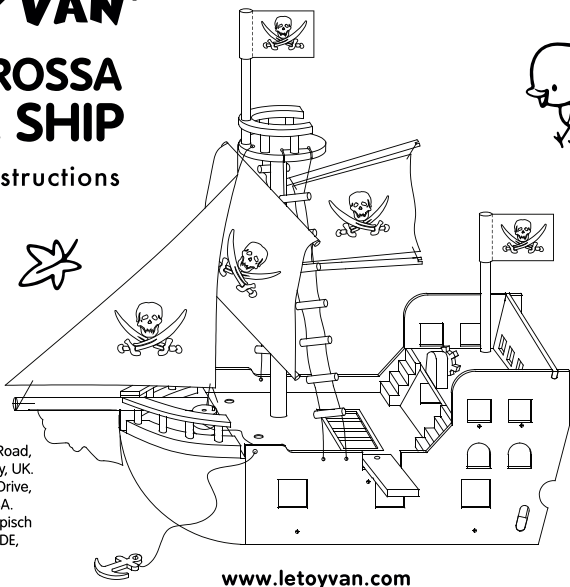

www.letoyvan.com

Le Toy Van Ltd, 160c Walton Road,  
KT8 0HP East Molesey, Surrey, UK.  
Le Toy Van Inc. 1 Corporate Drive,  
Grantsville, MD 21536, USA.  
Le Toy Van B.V. 24-28 Olympisch  
Stadion, Amsterdam 1076 DE,  
The Netherlands

Country of origin: China

### Tools required for assembly

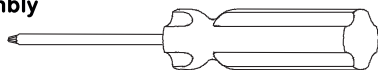

Tools not included . Hand tools only . Please do not use electric equipment

Instructions for proper assembly and maintenance:

### IMPORTANT: RETAIN THESE INSTRUCTIONS FOR FUTURE REFERENCE.

Care instruction: Clean surfaces with a dry or damp cloth. Do not use abrasive cleaners. Regularly check all fastenings to ensure that they properly tightened.

Assembly to be carried out by a competent adult only. During assembly children should be kept away from the product due to possible risk of injury. Ensure you have all the screws, hinges and that the grooves on the panels all align.

Do not use this item if any components are missing or damaged. Please follow the assembly instructions closely. Improper assembly can result in personal or property damage.

**WARNING! Not suitable for children under 36 months. Small Parts. Small ball. Choking Hazard. Only the balls supplied with this toy should be used as projectiles. WARNING! Projectile toy, hazards of aiming at the eyes or the face.**

To be used under adult supervision



<p>A</p> <p>X1</p>	<p>B1</p> <p>X1</p>
<p>C</p> <p>X1</p>	<p>D</p> <p>X1</p>
<p>B2</p> <p>X1</p>	<p>E</p> <p>X1</p>
<p>F</p> <p>X1</p>	<p>G</p> <p>X1</p>
<p>H</p> <p>X2</p>	<p>I</p> <p>X1</p>
<p>J</p> <p>X1</p> <p>X2</p>	<p>K</p> <p>GH-19F X3</p>
<p>L</p> <p>GH-26F X4</p>	

1

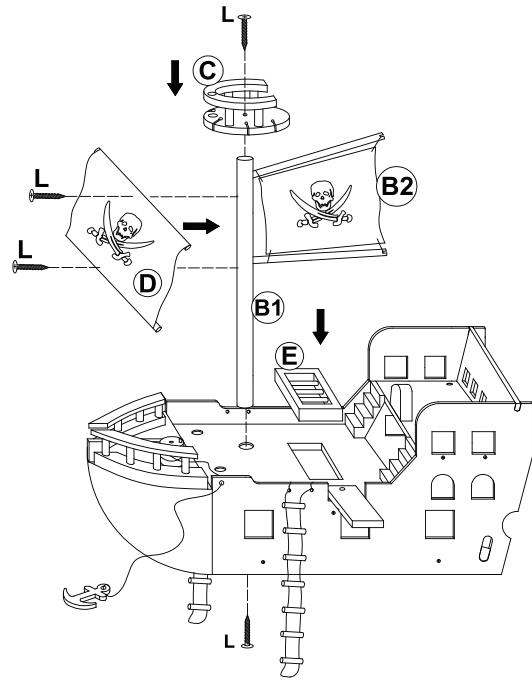

2

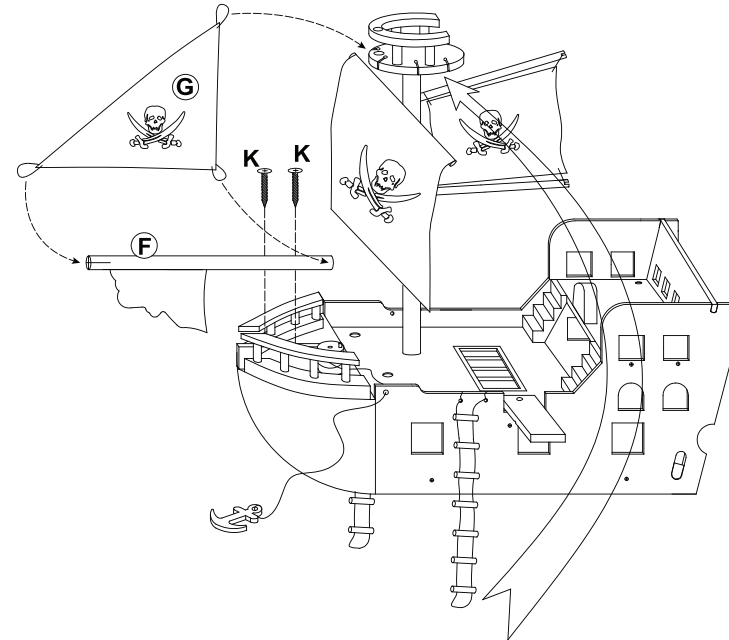

3

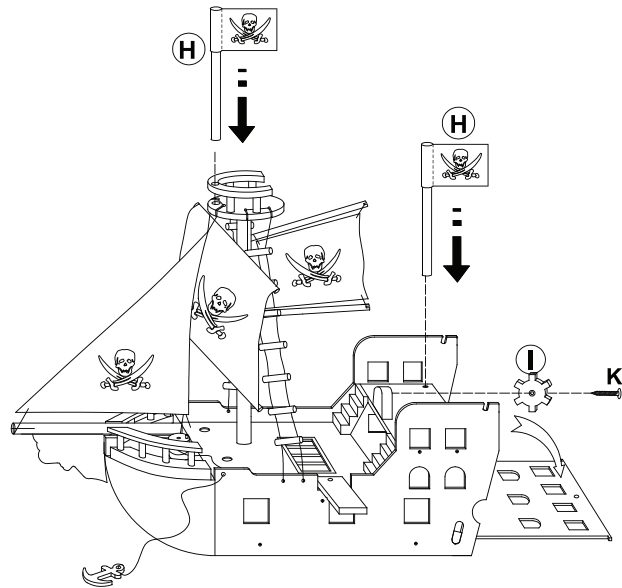

4

