

ASSEMBLY INSTRUCTIONS

IMPORTANT SAFETY INFORMATION:

Please take time to read instructions before assembling the unit. Be sure you fully understand all steps needed. Two-person assembly required.

PARTS LIST

- A. Bottom Panel (with pre-drilled holes)
- B. Top Panel (No pre-drilled hole)
- C. Side Panel (One with power adapter attached)
- D. Foot Plate
- E. Middle Supporting Tube
- F. Flat Bar Connector
- G. Corner Connector
- I. Flat Head Screw
- J. Washer

- L. Hex Nut
- M. Hex Key
- N. Gloves
- O. Powercord

Tools needed (not included):



Phillips Screw Driver

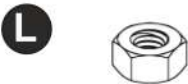
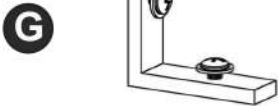
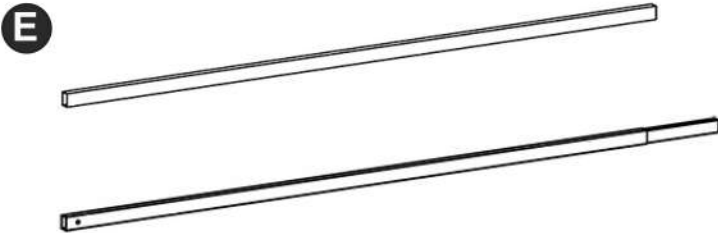
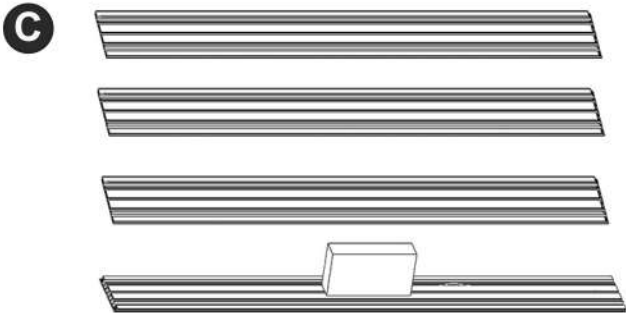
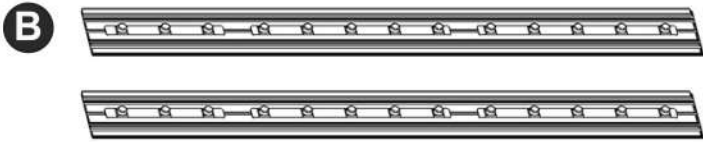
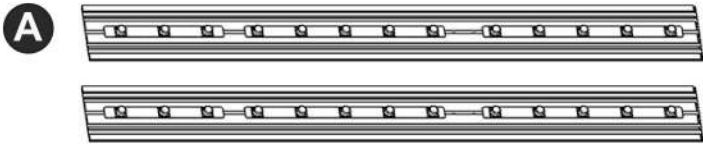

ASSEMBLY INSTRUCTIONS

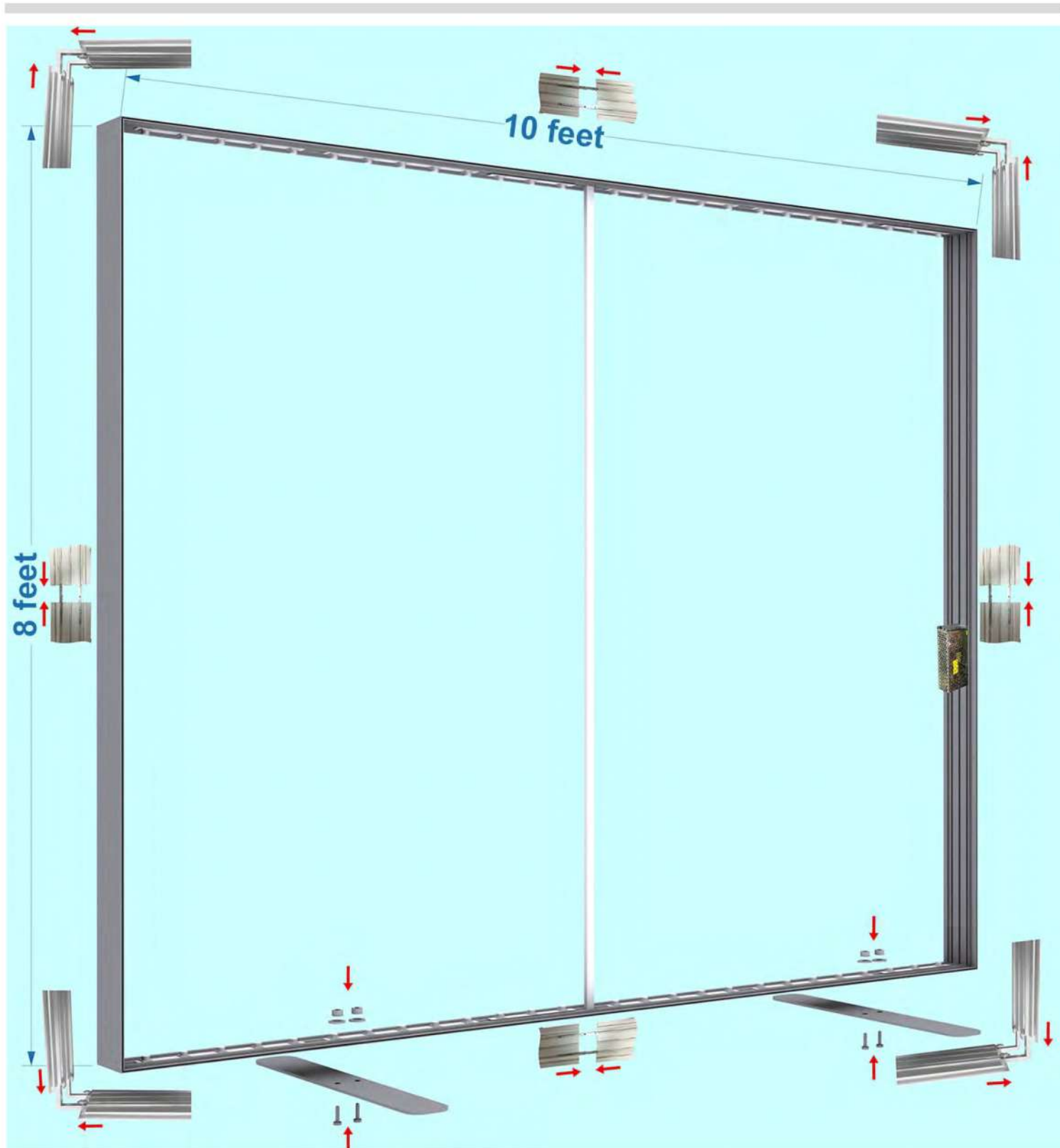

NOTE:

- (1). SEG frame is 8' tall and 10' wide. The assembling space must be large enough to house the entire frame.
- (2). For easy assembling, please do not lift the frame up until Step 8 is completed.
- (3). For your safety, DO NOT use a ladder when assembling the SEG light wall.

ASSEMBLY INSTRUCTIONS

1. Lay out all extrusion panels on a clean and non-abrasive surface. Identify each part by ARROW and NUMBER marks before you begin assembly.

PART A.
2 Bottom Panels (5') with LED lights attached.
Holes pre-drilled.

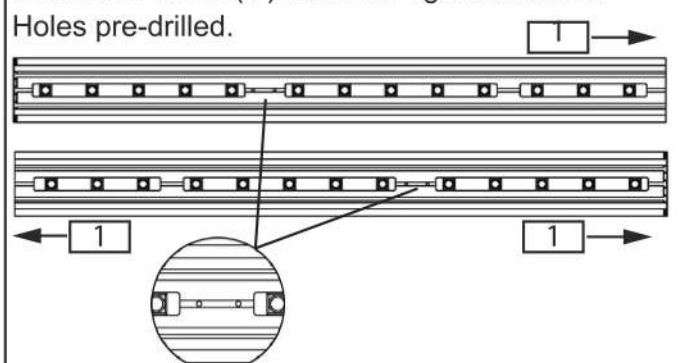

PART B.
2 Top Panels (5') with LED lights attached.

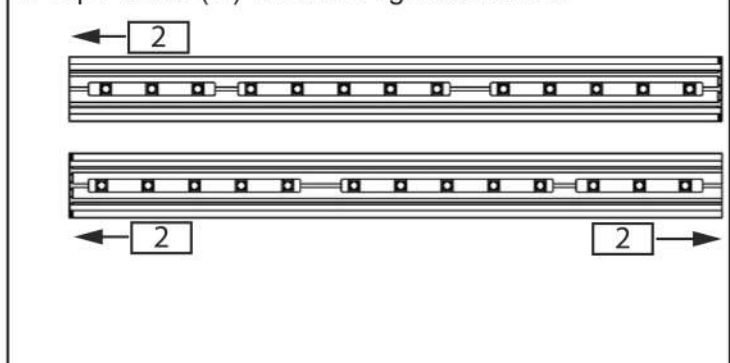

PART C.
4 Side Panels (4'). 1 with Power Supply attached.

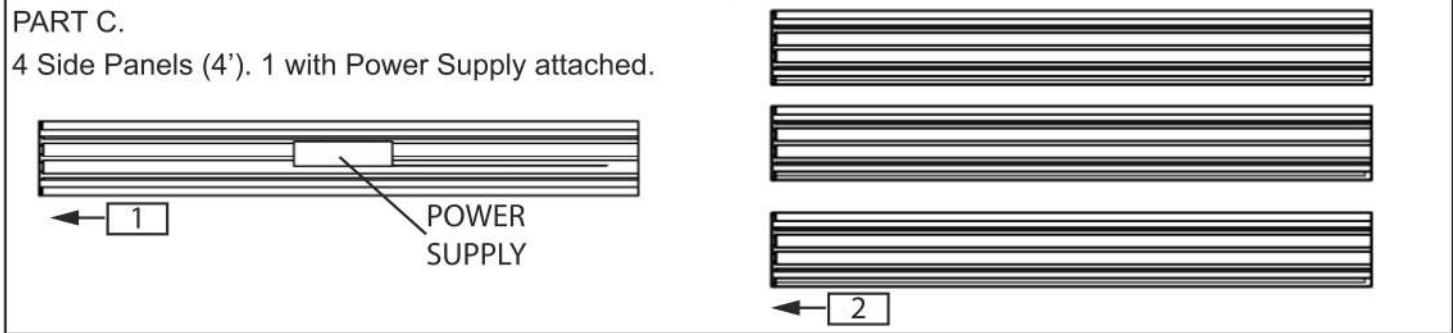

2. Connect the Bottom Panels (Part A) with (2) Flat Bar Connectors (Part F). Find the straight cut end on each panel, and insert Flat Bars Connectors into T-slots. Be sure edges of (2) panels are lined up, then tighten all set screws with the Hex Key (Part M) provided.

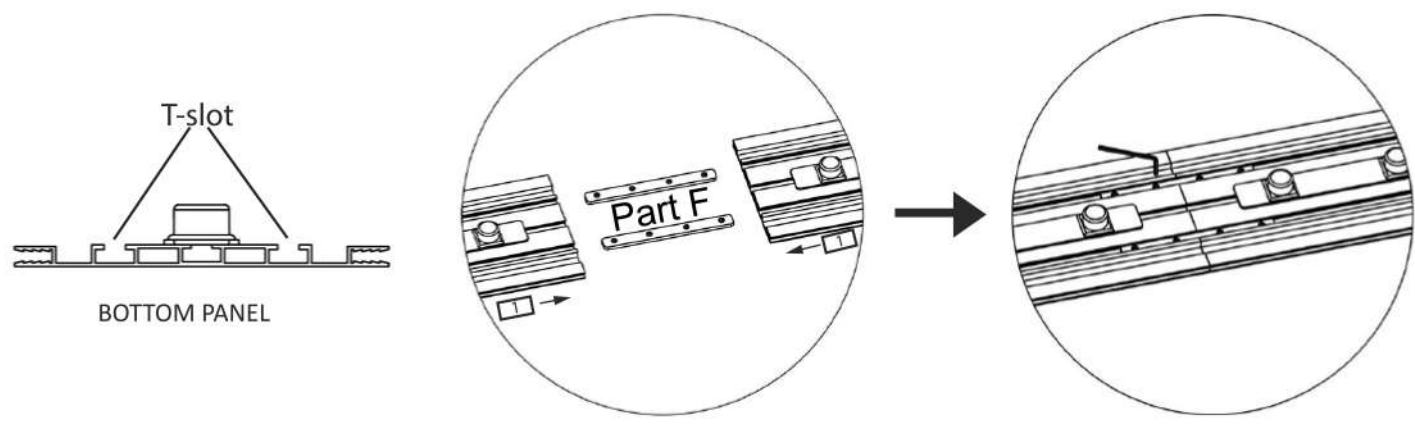

Connect the Top Panels (Part B) in the same way with (2) Flat Bar Connectors.

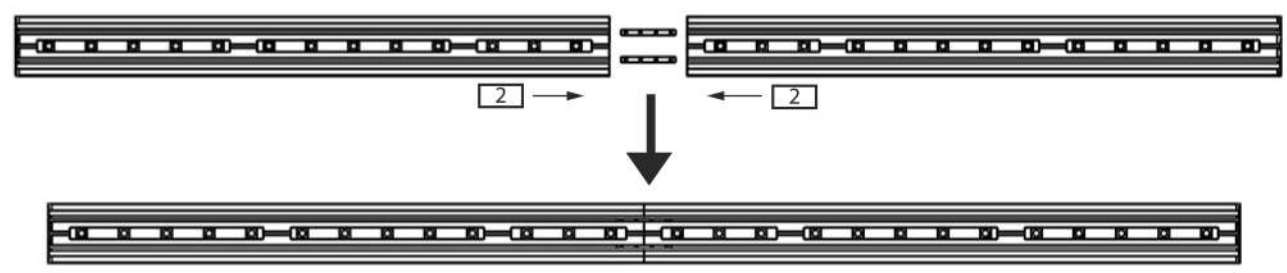

ASSEMBLY INSTRUCTIONS

3. Assemble side panels (Part C) with Bar Connectors the same way as in Step 2.

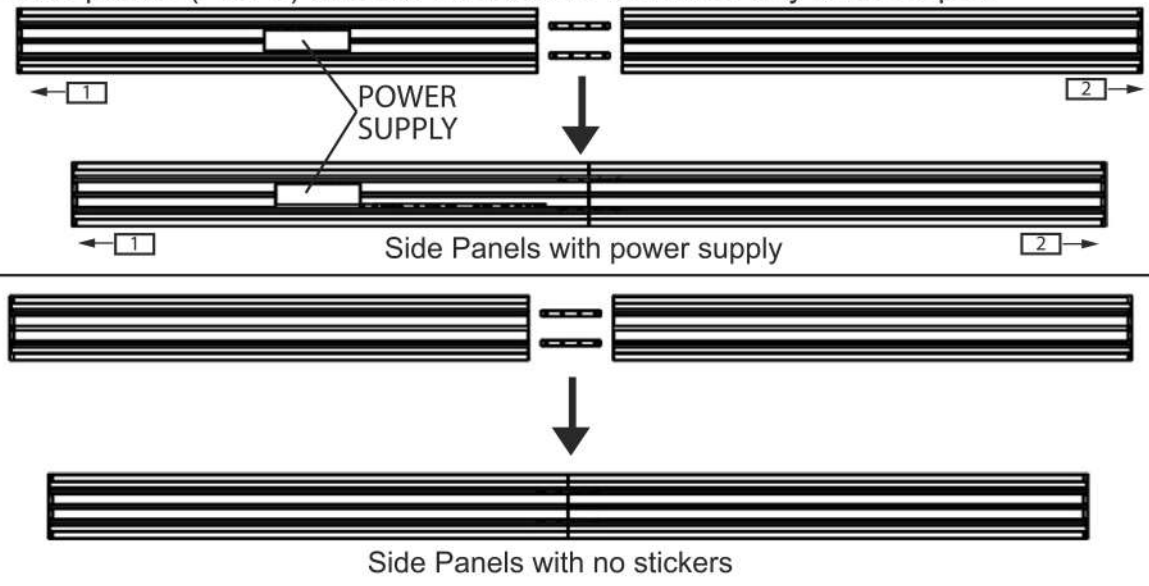

4. Connect all assembled panels with "L" shaped Corner Connectors (Part G). Connect the marked end [1] with [1], [2] with [2] first, then connect corners with no mark. Line up the miter cuts at each corner, and tighten all screws in the bracket with Screwdriver.

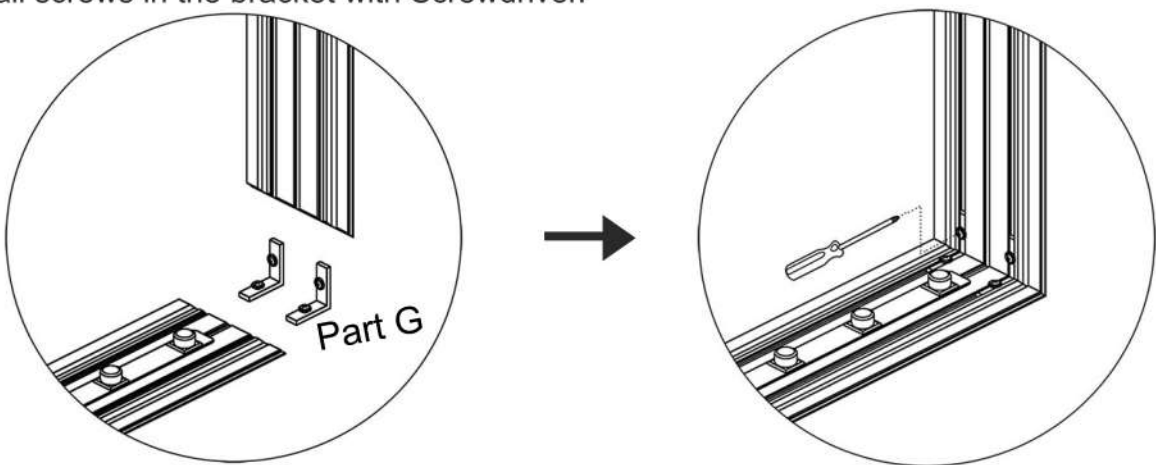

5. Assemble (2) Middle Supporters (Part E). Place both metal tube on the floor and twist and lock 2 parts together.

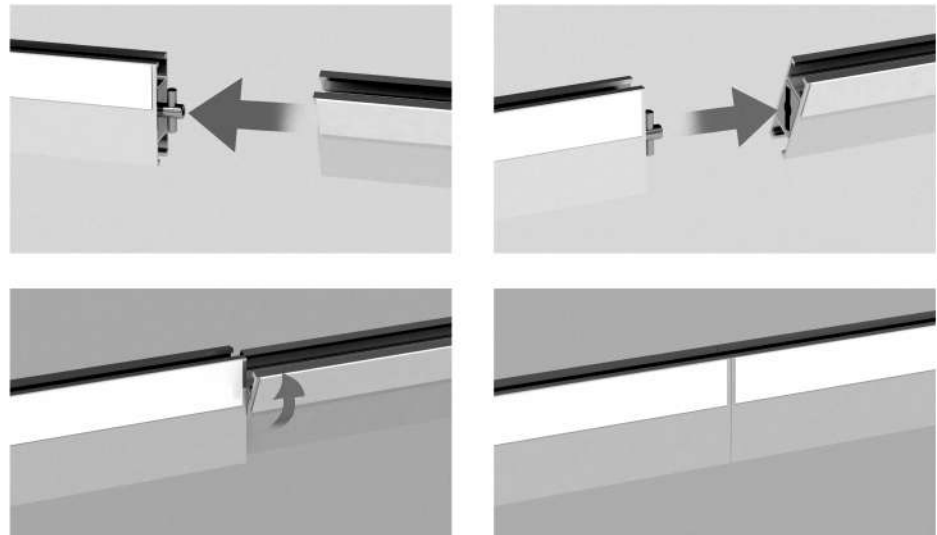

ASSEMBLY INSTRUCTIONS

6. Align the assembled Middle Supporting tube with center “T” slots on the top and bottom panels. Tighten hex nuts inside the tube at both ends with hex key provided.

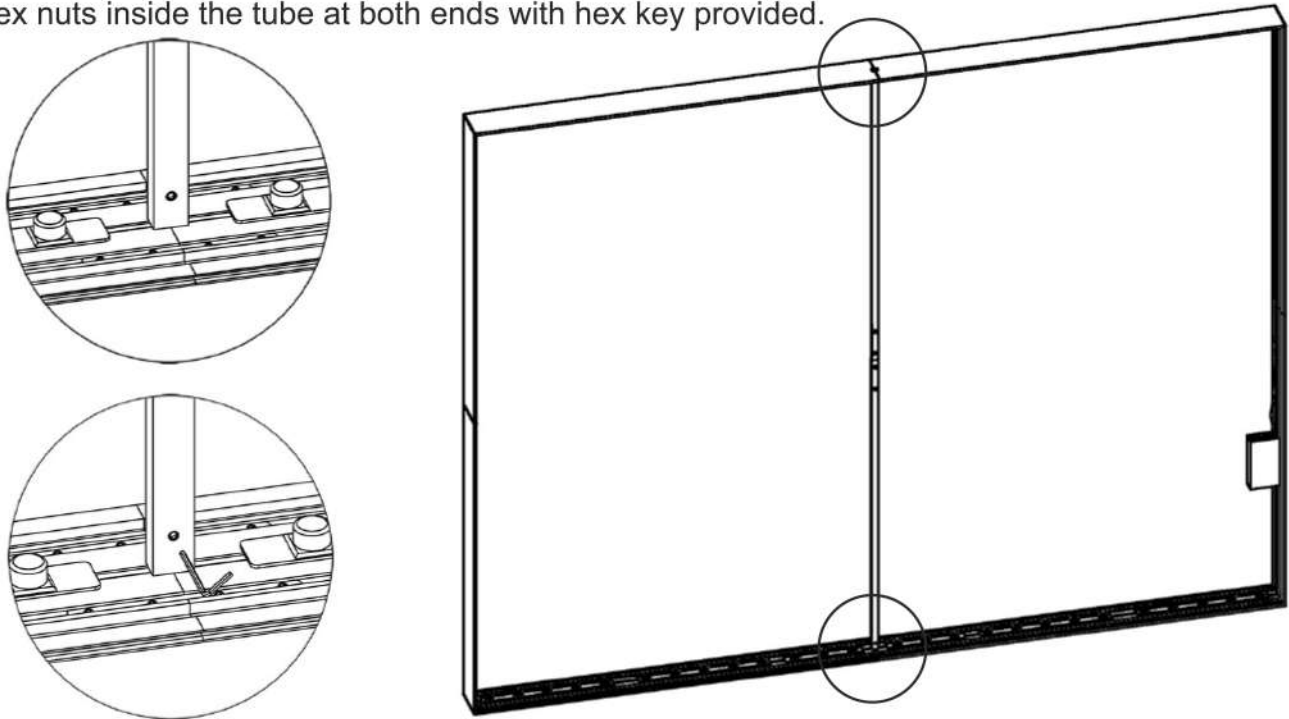

7. Assemble (1) Foot Plate (Part D) at the bottom of the frame by using Flat Head Screws (Part I), Washers (Part J) and Hex Nuts (Part L). Assemble the other Foot Plate the same way.

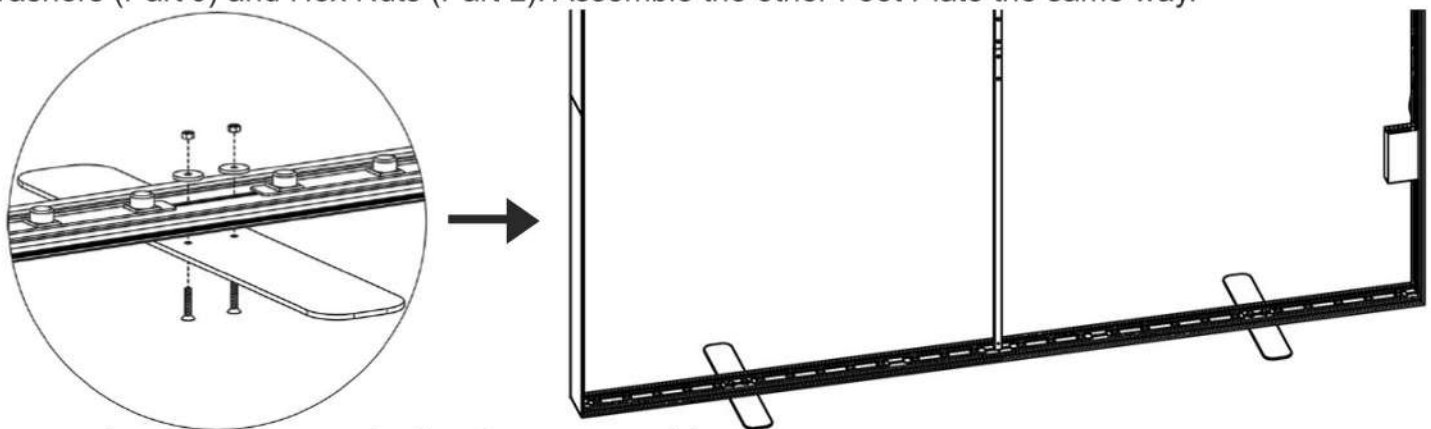

Tip: Lay the entire frame on the floor for easy assembling.

8. Connect all wires and power cord. Put on the SEG graphics on both sides of the assembled frame. Insert the silicon edge into the corresponding groove - be sure the graphics are fully stretched.



9. Carefully lift the frame up to its standing position. Plug the power cord into the outlet to light up the LED panel. The SEG light wall is ready for display!