



WATERSHOT[®] PRO for iPhone[®] 7

DESIGNED AND BUILT FOR THE EXTREME DEMANDS OF WATER SPORTS



Watershot Inc.
11211 Sorrento Valley Road, Suite O
San Diego, CA 92121

858.678.8552
support@watershot.com
www.watershot.com

1

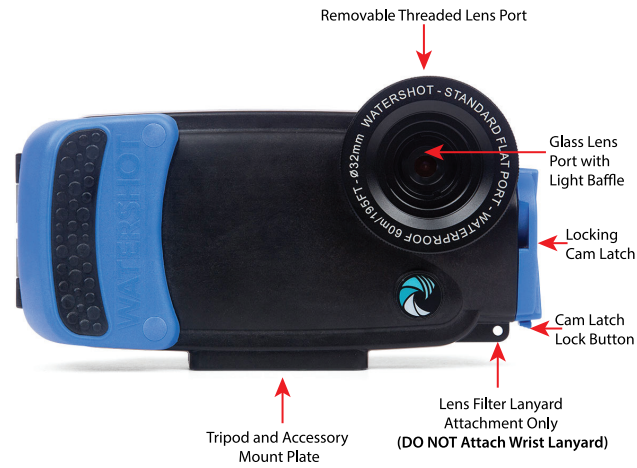

2

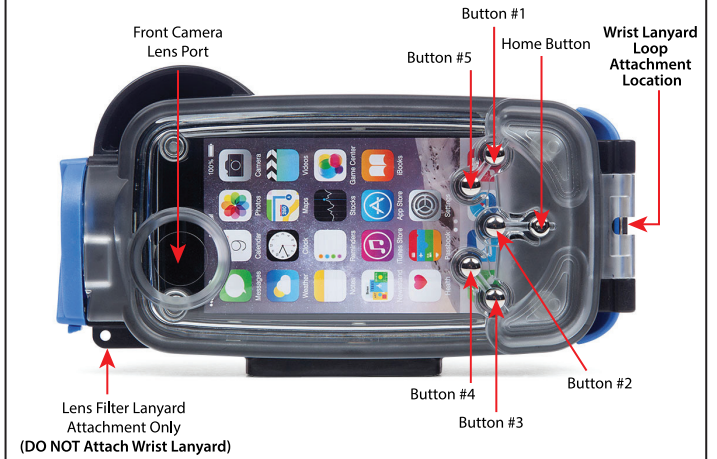

3

Introduction

Watershot[®] Incorporated continues the company's water imaging legacy with the 5th purpose-built Camera Housing for the Apple iPhone[®], Watershot[®] PRO for iPhone 7[®]. For those who have traded their digital cameras, for the simplicity of using their smart phone, the Watershot[®] PRO for iPhone 7[®] is a multi-feature waterproof Housing specifically made to optimize the iPhone 7's extraordinary photo and video imaging capabilities. New with the Watershot PRO iP7 Housing, is the option of selecting between and using either the **Apple Camera App**, standard on your iPhone 7[®], or using the free **Watershot[®] App** available for download at the App Store.

The Watershot[®] PRO for iPhone 7[®] is complete with a multi-element Glass Lens Port, light baffle, wrist lanyard, and a smart yet robust & simple mounting system. Able to withstand 60 meters of depth (195 feet), the iPhone 7[®] is fully suspended within the Housing, ensuring that it is effectively shielded from abrasion, shock and pressure.

Go to www.watershot.com for more information, FAQ, instruction videos, tips & tricks, product accessories, etc.

4

Initial Waterproof Confidence Test Instructions

Perform this confidence test prior to the 1st operational use of the Housing

1. Inspect the Watershot PRO for iPhone Housing and ensure it is contaminant free and appears in new condition.
2. Confirm the Lens Port is snug to the Housing by grabbing the Diamond Knurl on the Lens Port and rotating Counterclockwise (CCW) and loosen ¼ turn (90 degrees of rotation) then Clockwise (CW) to tighten so it is snug. DO NOT OVERTIGHTEN.
3. Test Touch Screen Buttons. All buttons should return to original position after being depressed.
4. Open the Housing by sliding the Cam Latch Lock Button with your thumb and simultaneously rotating the Cam Latch 180 degrees, Counter Clockwise CCW to the OPEN position.
5. Place a tissue or piece of paper inside the Housing.
6. Close the Housing, ensuring that the Cam Latch is 'locked' to the CLOSED Position and that the Cam Latch Lock Button 'clicks' and 'pops' into the fully extended position.
7. Submerge the Housing in water for 5-10 minutes.
8. Remove the Housing, dry it, and then open it.
9. Check to ensure the tissue or paper is dry.
10. Do not use if water is found inside the Housing. Contact Watershot support.

It is the user's responsibility properly test, use, care for, and store the product.

5

Watershot APP Installation Instructions

1. Download the "Watershot for iPhone" App from the App Store or iTunes.
2. Install the App onto your iPhone.
3. Drag the Watershot for iPhone App onto the "Menu Bar" located at the bottom of your "Home Screen". Make sure that you place the **Watershot App** in either the bottom right hand corner or bottom left hand corner, and then place the **Apple Camera App** in the opposite corner of the "Menu Bar". This action will allow you to select between and use either the **Apple Camera App** or the **Watershot App**.

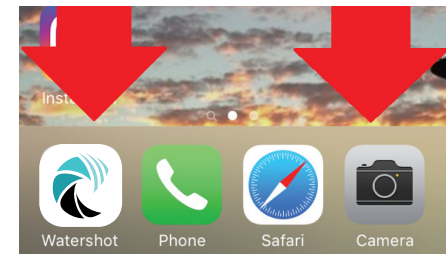

For more details on installing and using the App, go to www.watershot.com for additional instructions and online tutorials

6

iPhone 7[®] Settings Setup

1. Please open your phone and go into your **iPhone Settings > Display & Brightness > Please check "DISPLAY ZOOM"** and make sure your phone is set to Standard, not Zoomed.
2. Go into your **iPhone Settings** and click on **Privacy**, now click on **Camera**. Make sure the **Watershot App** has access to the Camera.
3. Go into your **iPhone Settings** and click on **Privacy**, now click on **Microphone**. Make sure the **Watershot App** has access to the Microphone.
4. Go into your **iPhone Settings** and click on **Privacy**, now click on **Photos**. Make sure the **Watershot App** has access to the Photo Album.
5. Go into your **iPhone Settings** and scroll down to the **Watershot app** and click on it. Check to make sure the **Watershot App** has access to Photos, Microphone, and Camera.

7

Using the Watershot PRO for iPhone

1. With the iPhone 7[®], you now have the option to turn off the "Auto-lock" feature or turn off the "Passcode" feature. If you turn off the "Auto-Lock" feature your iPhone 7[®] will remain "Awake" the entire time that it is housed in the Watershot Housing. If you chose to turn off the "Passcode" feature you are disabling the "Touch ID, Password, and Swipe" features on the iPhone 7[®]. To "Wake" the iPhone 7[®] from the "Lock Screen", simply push the **Home Button** twice. This is a personal choice you should make about how you would like to setup your iPhone 7[®] for use in the Watershot PRO, so choose one or the other. Turning off both the "Auto-Lock" and the "Passcode" while entirely possible is not recommended.
2. To turn off the "Auto-Lock" feature go into the **General Settings** of your iPhone 7[®] and click on "Display & Brightness", now click on "Auto-Lock" and place it to "Never." Once you place the iPhone inside of the Watershot Housing, it will not go to "Sleep"; the iPhone 7[®] will remain "Awake" and the battery discharges continuously, providing the shortest battery life from your iPhone 7[®].

So remember, if you did not turn the "Auto-Lock" feature on the iPhone 7[®] off, and it went to the Lock Screen, while it is inside of the Watershot Housing, there is no way of entering in your "Touch ID, Passcode, or Swipe" to unlock the iPhone.

8

Using the Watershot PRO for iPhone (Cont.)

3. To turn off the "Passcode" feature, go into the **General Settings** of your iPhone 7[®] and click "Touch ID & Passcode", now click "Turn Passcode Off". This action turns off the "Touch ID, Passcode, and Swipe" iPhone 7[®] features. From the "Lock Screen", all you need to do is push the "Home" Button twice and your iPhone 7[®] will "Wake" to the "Home" page or whatever page you were on when it went to "Sleep". The new "Home" Button feature provides a way to "Wake" the iPhone 7[®] after allowing it to go to "Sleep". This provides the longest battery life from your iPhone 7[®] while housed in the Watershot PRO.
4. Turn your iPhone 7[®] on first then install your iPhone 7[®] into the Housing per the installation Instructions.
5. Press the "Home Button".
6. If you have installed the **Watershot App** and the **Apple Camera App** in the "Menu Bar" of your "Home Screen", all you need to do is the push the corresponding **Touch Screen Button #1 or #3** on the Watershot Housing to open either the **Watershot App** or **Apple Camera App**. Once the App is open, to return to the "Home Screen" simply push the "Home Button".

9

Using the Watershot App

*** Before you put your iPhone in the Watershot Housing, open the **Watershot App** and click the Watershot logo in the upper left hand corner, this will take you to the **Open Mode Menu**. Click on **Housing Type** and please select "PRO Housing (6 Buttons)". You will only need to do this once, as the App will save your selection. ***

1. When you open the **Watershot App** it will automatically open in Picture mode. Press **Button 1** to toggle between PHOTO and VIDEO mode.

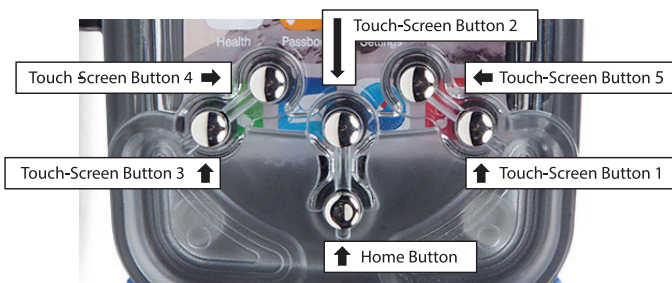

10

Using the Watershot App (Cont.)

2. Press **Button 2** to take a picture when in PHOTO mode or to Start/Stop Recording when you are in VIDEO mode.
3. Press **Button 3** to switch to PLAYBACK mode. You can review Photos and Videos that you have taken with the Watershot App.
4. Press **Button 4** to open the menu that allows you to change the settings and the operating features within CAMERA mode.
5. Press **Button 5** to turn ON/OFF the focus lock feature (Only functions in PHOTO mode).
6. Press & Hold **Button 2** to place the App in SLEEP MODE.

While in PLAYBACK Mode:

1. Press **Button 1** to scroll FORWARD thru the recorded photos/videos
2. Press **Button 2** to scroll BACKWARD thru the recorded photos/videos
3. Press & Hold **Button 1** to PLAY the video displayed on the screen
4. Press **Button 3** to switch back to CAMERA mode

Note: Additional App features may be accessed when the iPhone is not in the Housing. Press the Watershot Wave Logo in the corner to access features such as: Tutorials, Action Camera Settings, Album, Housing Type, Activity Mode, Services, Licenses, and Info.

11

Installing the iPhone

Prior to installing the iPhone, ensure that Safety and Initial Waterproof Testing Instructions have been read, understood and followed.

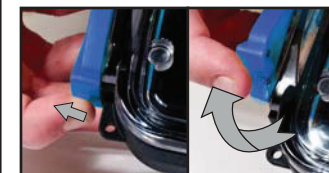

1. Open the Housing by sliding the Cam Latch Lock Button with your thumb and simultaneously rotating the Cam Latch 180 degrees, Counter Clockwise CCW to the OPEN position.
2. Place a single Desiccant Strip, lengthwise (in the middle left-to-right), into the Front Housing then Install the iPhone 7[®] into the Front Housing so that the phone's camera aligns with the black rubber, lens baffle on the Camera Housing Lens. The perimeter edges of the iPhone 7[®], along the top, bottom, left and right sides, should rest securely within the 10 grey silicone isolation bumpers located around the interior perimeter of the Front Housing.

12

Installing the iPhone (cont.)

13

3. Close the hinged clear back cover until the main body o-ring seal is fully seated into the Housing .

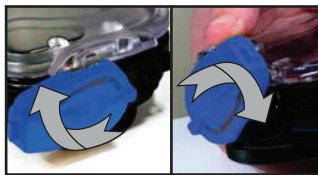

4. Rotate the Cam Latch 180 degrees, Clockwise CW, to the CLOSED Position and verify that the Cam Latch Lock Button 'clicks' and 'pops' into the fully locked position. A secondary tactile and visual verification, that the Cam Latch is CLOSED & LOCKED, can be achieved by very gently attempting to rotate the Cam Latch, when it is positioned in the CLOSED & LOCKED position, with the Cam Latch Lock Button fully extended into the locking hole.



5. Visually inspect the main body o-ring seal and ensure that you see even contact between the main body o-ring seal and the Housing around the full circumference of the Housing .

Changing or Removing Lens Ports on the Housing

14



1. Remove the Lens Port by firmly holding the Housing in one hand and grasping the diamond knurled outside edge of the Lens Port with the other hand. Rotate the Lens CCW (counter clockwise) until the Lens Port separates from the Lens Mount on the Housing.



2. After detaching the Lens Port from the Housing place it down on a smooth flat surface with the rear end up to avoid scratching the lens surface.

3. With the Lens Port removed, the PRO Housing is no longer waterproof. NEVER use a PRO Housing near the water when a Lens Port is not installed on the Housing.

Changing or Removing Lens Ports on the Housing (cont.)

15



4. Visually inspect the Lens Port prior to re-installing it onto the Housing. Inspect for damage to the screw threads and the two o-ring seals on the Lens Port. These two o-ring seals must be free from any kind of contamination such as hair, sand, dust and dirt. There should be no deformation, hairline cracks, stretch marks, wear marks or cuts visible in the o-rings.

5. If any visible damage to either o-ring is discovered during inspection DO NOT USE. Replacement o-rings kits are available from Watershot. If any visible damage to the Lens Port threads is discovered DO NOT USE.

6. Lightly lubricate the two o-ring seals with a thin coat of silicone lubricant only when necessary. If the o-ring seals have a "shiny" appearance, there is no need to lubricate.

Changing or Removing Lens Ports on the Housing (cont.)

16



7. Visually inspect the Lens Port mating surfaces on the Housing prior to installing the Lens Port. Inspect for damage to the screw threads and the mating surfaces where the Lens Port o-rings contact. These surfaces must be free from any kind of contamination such as hair, sand, dust and dirt. If any visible damage to the Lens Port threads or mating surfaces is discovered DO NOT USE.

8. To re-install the Lens Port onto the PRO Housing, firmly hold the Housing in one hand and grasp the diamond knurled outside edge of the Lens Port with the other hand. Align the threads of the Lens Port with the threads on the Housing. Rotate the Lens Port CW (clockwise) until the Lens Port stops - DO NOT OVERTIGHTEN, DO NOT USE ANY TOOL TO TIGHTEN.

9. Repeat the Initial Waterproof Test Instructions prior to using the Housing.

Important Safety Instructions



17

1. Read and follow the instructions in this manual.
2. Perform recommended test and checks.
3. Do not use the Housing beyond the rated depth rating 60m/195ft
4. After each use the Housing should be closed shut, latched and soaked (20min in fresh water), micro fiber cloth dried, then air dried with the Housing open.
5. Always follow installation and removal process per the manufacturers instructions.
6. Replace o-ring(s) that are deformed, exhibit hairline cracks, stretch marks, wear marks or cuts.
7. Apply o-ring lubricant sparingly and only when necessary, a light, thin film is all that is required.
8. If cracks, deformation, or other damage is observed – DO NOT USE.
9. Keep away from heat sources.
10. Phone may overheat (and shut off) if installed in the Housing and exposed to prolonged direct sunlight.
11. Contains small parts which may be a choking hazard. Not suitable for children under 3 years old
12. Watershot is not liable for damage to contents.
13. Desiccant strips are provided, use if lens fogging occurs (due to condensation within the Housing which may be caused by high relative humidity when loading your phone). Place the desiccant strip into the Housing (place pack flat in the front Housing between the ribs below the iPhone) and keep the Housing closed for at least 5 minutes before going into the water. Visit www.watershot.com for additional details and instructions for installing the desiccant into the Housing.

Safety Instructions (Cont.)

18

14. If there is a screen protector on your iPhone 7[®], remove it. Screen Protectors may affect the operation between the **Push Buttons** on your Watershot Housing and the **Touch Screen** on the iPhone 7[®].

15. Petroleum based products can have a damaging effect on the clear Polycarbonate Rear Housing which may lead to crazing or small crescent shaped cracks. When using your Watershot Housing avoid contact with any and all petroleum based products. This may also include sunscreens, lotions and cleaning agents. If you have any doubts, thoroughly wash and dry your hands before handling the Watershot Housing.

WARRANTY

19

Watershot Inc[®]. ("Company") warranty obligations for the Company product(s) you have purchased ("Product") are limited to the terms set forth in this document as well those set forth in the Warranty section of the company website if published. Company warrants: (i) if the Guidelines for Appropriate Use (GAU) are followed the Product will perform substantially in accordance to the specifications furnished by Company; and further warrants: (ii) the Product against substantial defects in materials and workmanship under normal use for a period one (1) year from the date of original purchase ("Limited Warranty"). This limited warranty is non-transferable and covers only the original end purchaser. An original or copy of the sales receipt from the original sales retailer or Company website and warranty card on file with Watershot is required for one year coverage. This limited warranty does not cover products purchased through non-authorized dealers and/or online auction websites. Non-authorized dealer receipts and/or online sales auction confirmations are NOT accepted for warranty verification. Warranty claims must be made directly to the Company. No warranty either expressed or implied will be extended to iDivesite or iPix camera Housing s purchased either inside or outside the United States and its territories.

Exclusions and Limitations

Company's limited warranty applies only to the Product. The warranty does not apply to any non-Company product, even if packaged or sold with the Product. This warranty applies only to the normal use of the Product. This warranty does not apply to damage caused by accident, abuse, misuse, force majeure, or modification of the Product.

Sole and Exclusive Remedy

Your sole and exclusive remedy for a breach of this limited warranty, and Company's sole and entire liability is, at Company's option, to repair or replace the defective Product or refund the purchase price of the defective Product within thirty (30) calendar days of the date of purchase. Repair or replacement (including parts, labor and shipping costs) shall be made at Company's expense. Company reserves the right to send you a replacement product that is the same or of a similar style or a equivalent substitute. Replacement products will be furnished only on an exchange basis. Replacement products are warranted as above for the remainder of the original applicable Product warranty period.

20

Warranty Disclaimers

EXCEPT AS EXPRESSLY SET FORTH ABOVE IN THIS LIMITED WARRANTY, THE PRODUCT IS PROVIDED ON AN "AS IS" BASIS AND THE COMPANY MAKES NO OTHER EXPRESS OR IMPLIED WARRANTIES TO THE EXTENT PERMITTED BY LAW AND SPECIFICALLY DISCLAIMS AND EXCLUDES ALL IMPLIED WARRANTIES, INCLUDING, WITHOUT LIMITATION, THE IMPLIED WARRANTIES OF MERCHANTABILITY AND FITNESS FOR A PARTICULAR PURPOSE. IF SUCH DISCLAIMER OF ANY IMPLIED WARRANTY IS NOT PERMITTED BY LAW, THE DURATION OF ANY SUCH IMPLIED WARRANTIES IS LIMITED TO THE DURATIONS SET FORTH IN THIS LIMITED WARRANTY. SOME JURISDICTIONS DO NOT ALLOW THE EXCLUSION OF IMPLIED WARRANTIES OR LIMITATIONS ON HOW LONG AN IMPLIED WARRANTY MAY LAST, SO SUCH LIMITATIONS OR EXCLUSIONS MAY NOT APPLY TO YOU. THIS WARRANTY GIVES YOU SPECIFIC LEGAL RIGHTS AND YOU MAY ALSO HAVE OTHER RIGHTS WHICH VARY FROM JURISDICTION TO JURISDICTION.

22

Limitation of Liability

IN NO EVENT SHALL COMPANY, ITS DISTRIBUTORS OR SUPPLIERS BE LIABLE TO YOU OR ANY THIRD PARTY FOR ANY INDIRECT, INCIDENTAL, CONSEQUENTIAL, SPECIAL, EXEMPLARY OR PUNITIVE DAMAGES ARISING OUT OF THE USE OF THE PRODUCT, INCLUDING, WITHOUT LIMITATION, PROPERTY DAMAGE, LOSS OF VALUE OF THE PRODUCT OR ANY THIRD PARTY PRODUCTS THAT ARE USED IN OR WITH THE PRODUCT, OR LOSS OF USE OF THE PRODUCT OR ANY THIRD PARTY PRODUCTS THAT ARE USED IN OR WITH THE PRODUCT, EVEN IF COMPANY HAS BEEN ADVISED OF THE POSSIBILITY OF SUCH DAMAGES. COMPANY HAS NO LIABILITY FOR ANY DAMAGE OR DESTRUCTION TO CONSUMER ELECTRONICS DEVICES OR OTHER PERSONAL PROPERTY THAT ARE IN THE PRODUCTS, INCLUDING, WITHOUT LIMITATION, LAPTOPS, CELLULAR PHONES, OR OTHER HANDHELD DEVICES, OR ANY LOSS OF DATA CONTAINED IN THE FOREGOING DEVICES, ETC. NOTWITHSTANDING ANY DAMAGES THAT YOU MIGHT INCUR FOR ANY REASON WHATSOEVER (INCLUDING, WITHOUT LIMITATION, ALL DAMAGES REFERENCED HEREIN AND ALL DIRECT OR GENERAL DAMAGES IN CONTRACT, TORT (INCLUDING NEGLIGENCE OR OTHERWISE), THE ENTIRE LIABILITY OF COMPANY AND ANY OF ITS DISTRIBUTORS AND/OR SUPPLIERS SHALL BE LIMITED TO THE AMOUNT ACTUALLY PAID BY YOU FOR THE PRODUCT. SOME STATES AND/OR JURISDICTIONS DO NOT ALLOW THE EXCLUSION OR LIMITATION OF INCIDENTAL OR CONSEQUENTIAL DAMAGES, SO THE ABOVE LIMITATIONS OR EXCLUSIONS MAY NOT APPLY TO YOU.

Obtaining Warranty Service

23

If you wish to make a claim under this warranty with respect to the Product, please e-mail support@watershot.com with the following information:

1. Attach photocopy of original purchase receipt or packaging slip.
2. Provide product SKU.
3. Provide purchase date.
4. Brief description of problem (under 500 words)
5. A telephone number and e-mail address at which you can be reached during normal business hours.
6. All of the above information is required before a warranty claim will be accepted. Once Company validates your claim, we will issue you an RMA (Returned Merchandise Authorization) receipt number and shipping information from support@watershot.com.

 **WATERSHOT[®]**
BUILT TO LIVE IN THE WATER

www.watershot.com

 PLEASE RECYCLE

Copyright Notice

This owner's manual is copyrighted, all rights reserved. It may not, in whole or in part, be copied, photocopied, reproduced, translated, or formed into any electronic format without prior consent in writing. Watershot and the Film Wave logo are the registered trademark of Watershot Inc.. Apple, and iPhone are trademarks of Apple Inc., registered in the U.S. and other countries. Apple is not responsible for the operation of this device or its compliance with safety and regulatory standards. Watershot products are protected by Pending US Patents.



Watershot Resources

24