

⚠ WARNING PLEASE READ CAREFULLY

FAILURE TO ABIDE BY THESE INSTRUCTIONS COULD RESULT IN SERIOUS OR FATAL INJURIES.

- Do not modify your helmet in any way.
- Do not remove any labels.
- Even if the helmet is not showing damage after impact, it might still be structurally compromised. Have the helmet inspected by a professional before using again.
- If you are not sure if the helmet is in proper condition, you should replace it.
- Helmets only protect the areas they cover; they do not protect the neck and face.
- Make sure the helmet is properly fitted and positioned correctly before each use.

IF YOU HAVE AN ACCIDENT

A fall or relatively hard impact can damage the helmet, even if no damage can be seen from the outside. It is necessary to replace your helmet after any such incident as the impact could have caused unseen structural damage.

CARE AND MAINTENANCE

- Any alteration to the helmet is prohibited. Regularly inspect your helmet and replace it when it shows signs of obvious wear.
- Clean your helmet with mild soap and water only. Never use petroleum products, cleaning agents, paints and decals other than those provided.
- Wash the removable lining with mild soap and water as well. Then air dry it.
- Do not expose to direct sunlight or extreme heat, such as in the interior of your car on a sunny day. Store your helmet in a cool, dry place.

wildhornoutfitters.com

For patent information please visit: wildhornoutfitters.com/ip



WILDHORN OUTFITTERS
11845 South 700 East Suite 200,
Draper, UT 84020

SNOW HELMET USER MANUAL



PRODUCT FEATURES

The Drift snow helmet features high grade light weight protection and comfort. With 13 external and 19 internal vents. Our VNT ventilation system gives you complete air flow and temperature control. The integrated fine-tune adjustment (FTA) fit system lets you customize sizing for a perfect fit every time.



TEMPERATURE CONTROL ADJUSTABLE VENTILATION SYSTEM



INTEGRATED FINE-TUNE ADJUSTMENT (FTA) FIT SYSTEM



LIGHT WEIGHT AND COMPACT PREMIUM CONSTRUCTION



PLUSH COMFORT INSULATED INTERIOR LINER

CERTIFICATION

Wildhorn helmets comply with the European standard EN1077 Class B and / or the US standard F2040 (refer to label inside the helmet). They comply with the EEC Directive 89/686.

They are intended solely for use in downhill skiing and snowboarding. It is not suitable for use in other sports, such as motorcycling, unless specifically indicated by the label inside the helmet.

Winter sports such as skiing and snowboarding are inherently dangerous. No helmet can guarantee the user will not sustain serious or fatal injuries resulting from impacts.

The helmets classes A and B are for alpine skiers, skiers and snowboarders. Class A helmets offer protection on the top of the helmet. Class B helmets provide better ventilation and allow for better hearing, but don't provide as much protection against penetration.

Notified Body: Telefication B.V. Edisonstraat 12A 6902 PK Zevenaar Country: Netherlands
Notified Body No. 0560

SIZE AND FIT

THE CORRECT SIZE WILDHORN HELMET SHOULD FIT SNUG AND COMFORTABLE WITHOUT EXCESS MOVEMENT OR OBSTRUCTION.

- 1. Determine the right helmet size.** To find the right helmet size for you, measure the circumference of your head one finger's breadth above your eyebrows.
- 2. Confirm the correct size.** To check that the helmet fits securely, leave the chin strap undone and shake your head lightly. The helmet should not change position.
- 3. Position correctly.** Make sure that the helmet is positioned horizontally on your head (see Figure 1). The helmet should not sit too far back on the head, as this leave the forehead unprotected, nor be pulled down too far over the forehead, as this could obstruct your view.
- 4. Adjust the chinstrap.** Fasten the buckle and adjust the chinstrap by pulling on the loose end of the strap. It should be snug under your chin, but not constrictive when you open your mouth. You may further adjust the side strap dividers to tighten the fit.
- 5. Fit system adjustment.** With the size adjustment system you can calibrate the size of your helmet to fit you perfectly: just put it on in the correct position and turn the adjustment knob - clockwise to tighten the fit, counterclockwise to loosen it.
- 6. Removable Sound Curtain.** If desired, the Sound Curtain can be removed by pulling directly on the ear cover while securely holding the helmet. Undo the two arms and remove the cover - then replace the arms and lining.

SIZING

SIZE	METRIC
Small	51-55cm
Medium	55-59cm
Large	59-62cm

Figure 1.

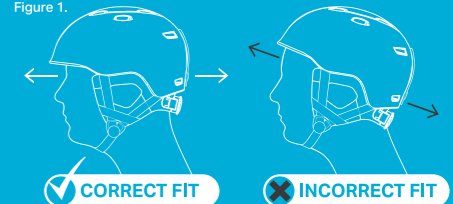

WARRANTY

We build our reputation by creating quality product. If you experience a problem that is a result of defect in materials or workmanship, Wildhorn Outfitters warrants your helmet for the lifetime of the product and will repair or replace your helmet at no charge. Warranty does not apply to damage resulting from impact, misuse, abuse, accident, negligence or normal wear and tear. Wildhorn Outfitters has the sole discretion to determine manufacturer's defects.