

Waterproof Case Operation Manual

FOR SONY

A1/A7SIII/A7RIV/A7RIVA/A9II etc..

v2.01.210923

- ① SIGMA 24-70 F2.8 DG DN φ82
- ② FE 24-70 F2.8 GM (SEL2470)
- ① FE 24-70 F4 ZA OSS
- ② TAMRON 17-28 F2.8 Di III RXD
- ③ SIGMA 14-24mm F2.8 DG DN Art
- ④ FE 16-35 F4 (SEL1635Z)
- ⑤ FE 16-35 F2.8 GM (SEL1635GM)
- ⑥ FE 12-24 F4 G
- FE 90 F2.8G OSS
- FE 28-70 F3.5-5.6 OSS

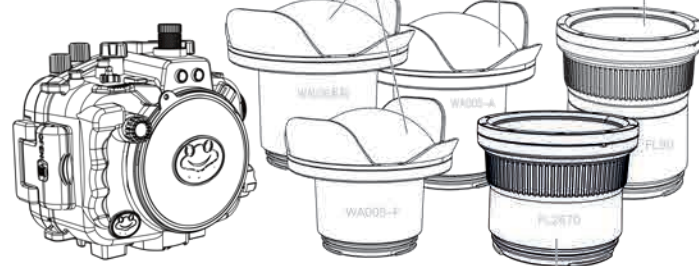

Introduction

- Thank you for choosing this product! Please read the manual carefully before using the product. Please keep the manual for reference.
- The manual takes the A1+FL2870 waterproof case set as the reference legend.
- Our company is only responsible for the defects of waterproof case. We will not be responsible for any loss caused by improper use or force majeure.

Points for attention

- When using the waterproof case for the first time or replacing the lens port or O-ring, please make sure to conduct the waterproof test of the empty case before loading the camera.
- Do not carry this product into the water from a high place, for the strong impact may cause the case to seep into water or damage the camera.
- If the temperature difference is large in a short time, the inner surface of the waterproof case may be dewed (small water drops). In case of condensation, please take out the camera from the diving shell and wipe off the water drops on the waterproof case and the camera with a soft dry cloth, and use it after the water vapor has completely evaporated.
- Do not damage the waterproof O-ring, or dust and dirt are accumulated between the waterproof O-ring and the waterproof case to avoid water leakage.
- Do not use the waterproof case in the water whose water temperature is lower than 0 °C and higher than 40 °C or more than 40 meters of water depth.
- In very hot and humid places, do not put the waterproof case in direct sunlight for a long time.
- In case of water seepage (the water leakage alarm lamp in the waterproof case flashes), stop using the waterproof case and water source immediately, and take out the camera and waterproof case from failure.

01>>

Part name(A1/A7RIV/A7RIVA/A9II)

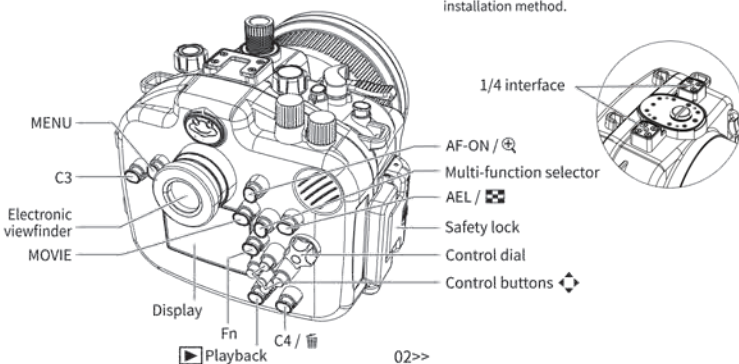
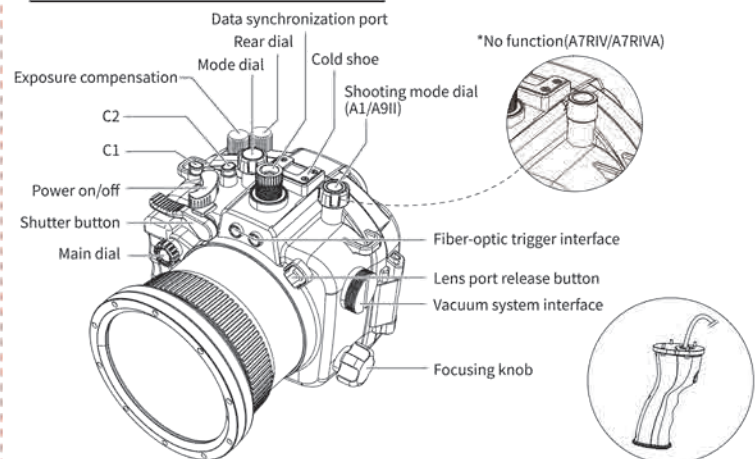

01>>

Part name(A7SIII)

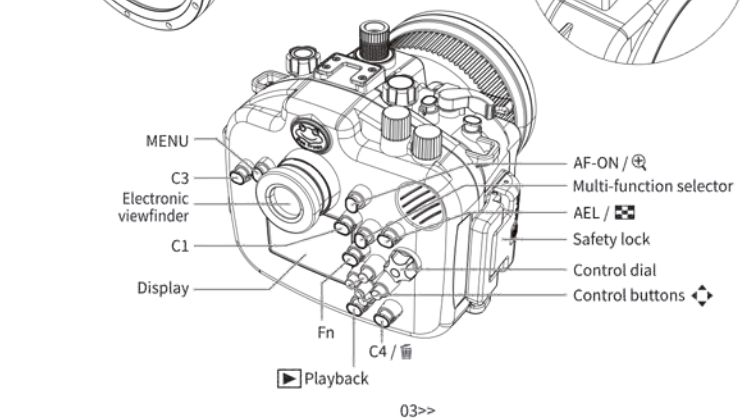
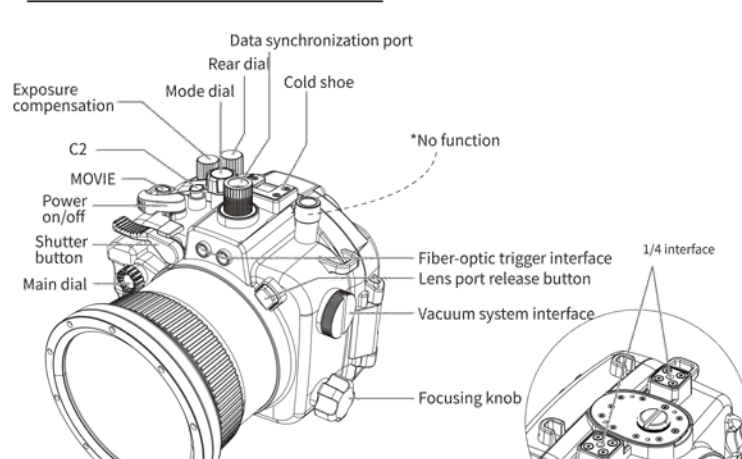

03>>

Installation of lens port

1. Select the required lens port and remove the body and dust cover of lens port;
2. Check the groove and O-ring of the interface between the fuselage and lens port to ensure that there is no debris and debris attached. Take out the O-ring of lens barrel and add a little waterproof silicone oil.
3. Align the lens port positioning point with the fuselage positioning point, push it in forcefully, and then turn the lens port clockwise until a click is heard.

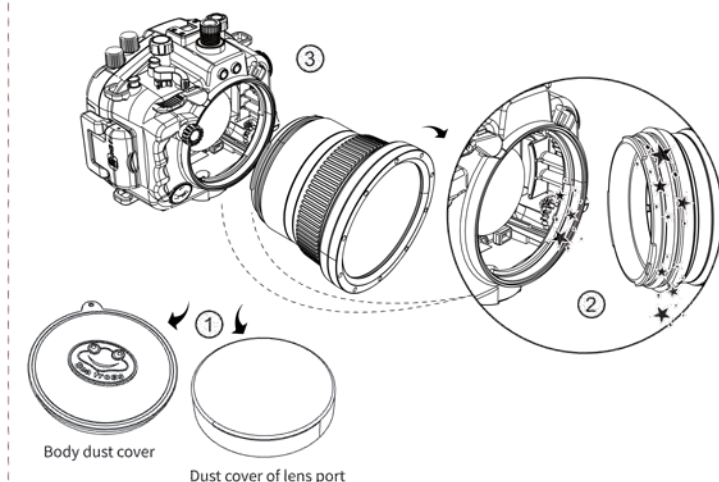

- Removal of lens port
Press and hold the lens port clockwise to release the lens port

04>>

Open the waterproof case

*This product is a clamshell structure, it is recommended to place the product on a flat surface

1. Push down the red push button and keep it;
2. Buckle part A outward;
3. Buckle part B outward;
4. After the left and right safety locks are opened, remove the back case and open it.

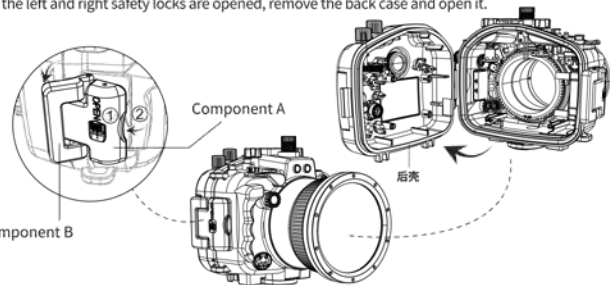

Waterproof test

• General test

1. Open the waterproof case and check whether the O-ring is damaged or foreign matters are attached. If so, please clean it or replace it with a new O-ring;
2. Put in a dry paper towel, close and lock the waterproof case, and then immerse the waterproof case in water for about 15-20 minutes;
3. Take out the waterproof case and dry the case with dry cloth.
4. Observe whether there is alarm flash in the waterproof case leakage alarm window;
5. Open the waterproof case to see if the tissue has changed.

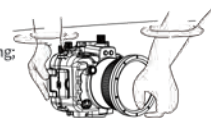

• Vacuum pump system test

If you buy the VP-100 series vacuum test system, you can use this device for quick waterproof test.

*Please refer to the manual of vacuum test system for detailed steps

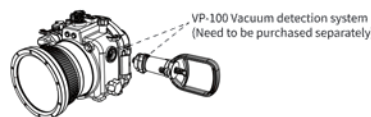

Preparation

1. Transfer your important photos and files from camera to computer;
2. Adjust the camera and configure the parameters suitable for underwater shooting;
3. Install a fully charged battery, insert the memory card and ensure that there is enough space in the memory card for recording images;
4. Remove the wrist strap from the camera;
5. Install the appropriate lens (all types of filters or shields need to be removed).

05>>

Camera installation and use

1. Put the corresponding zoom gear into the camera lens (some lenses need to be disassembled and then inserted);
2. To use the data synchronization flash mode, you need to connect the built-in hot shoe plug of the waterproof case to the camera hot shoe; *Note①
3. To use the fiber optic flash trigger mode, you need to install the SR-009 flash trigger to the camera hot shoe and turn on the power; *Note②
4. Open the waterproof case, put the camera in carefully, and then close and lock the waterproof case;
5. Operate the buttons and dials on the waterproof case repeatedly to ensure that the camera functions normally.

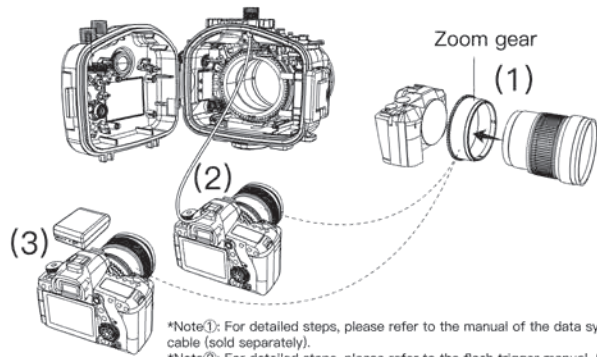

- *Note①: For detailed steps, please refer to the manual of the data synchronization cable (sold separately).
- *Note②: For detailed steps, please refer to the flash trigger manual. (sold separately)

Maintenance and maintenance

Please check the O-ring part of the main body of the waterproof case before launching. If the O-ring is stained with foreign matters, it can be taken out separately and cleaned with clean water, and then dried with a soft cloth without chips. After cleaning, the O-ring needs to add lubricating silicone oil. Refer to the following steps for operation:

1. Take out the O-ring with the attached O-ring disassembly piece
2. Check whether there are foreign matters attached to the O-ring. If the O-ring is attached with debris, clean it with clean water. If the O-ring is damaged, O-ring removal plate. Please replace the O-ring immediately;
3. After cleaning, the O-ring needs to be re-lubricated with silicone oil. Take a clean plastic bag, put the O-ring to be lubricated, and then squeeze it in
4. Pinch the plastic bag with your fingers to make the silicone oil evenly distributed to O-ring;
5. Carefully check the flash O-ring groove. If there are any foreign matters in the groove, please use clean cotton free soft cloth or special cotton swab with blowing balloon to remove, and then put the lubricated O-ring back into the groove.



- ⓘ Notice: do not remove the O-ring by force or use sharp and hard metal objects, or the O-ring or waterproof groove may be damaged

06>>

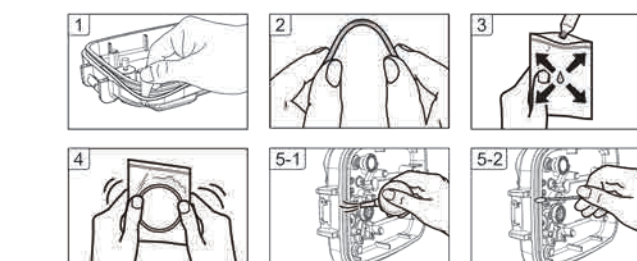

Maintenance precautions

- Please maintain in dry and bright area;
- Only use original brand spare O-ring and silicone oil;
- When installing the O-ring back into the groove of the waterproof shell, pay attention to the smoothness of the O-ring and the groove without distortion;
- Check the O-ring and groove again after installation to ensure that there is no debris attached;
- In order to ensure the waterproof performance of the product, it is recommended to replace the main O-ring once a year;
- After using the waterproof shell for 1 year or 200 times, it is recommended to send the product back to the distributor or manufacturer for professional maintenance. (*Note: there may be costs)

Storing

- After each diving, please take out the camera, close the locking waterproof case and soak it in fresh water for 15-30 minutes. During this period, operate all buttons and knobs several times to avoid salt residue accumulation and dry the waterproof case with a clean soft cloth;
- Store the waterproof case in a dry and ventilated environment without direct sunlight;
- Do not store in high temperature, cold and humid places, or near naphthalene chemicals or insecticides
- Not use waterproof case for a long time. It is recommended to remove the main O-ring and put it in plastic bag for separate storage.

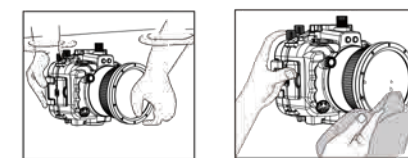

07>>

Specifications

Depth rating: 40m/130ft
Waterproof structure: O-ring seal
Main material: PC, optical glass, stainless steel, silicone rubber
Operating temperature: 0-40°C (32-104°F)
Compatible lenses:
① FE 24-70 F4 ZA OSS
② TAMRON 17-28 F2.8 Di III RXD
③ SIGMA 14-24mm F2.8 DG DN Art
④ FE 16-35 F4 (SEL1635Z)
⑤ FE 16-35 F2.8 GM (SEL1635GM)
⑥ FE12-24 F4 G
⑦ SIGMA 24-70 F2.8 DG DN φ82
⑧ FE 24-70 F2.8 GM (SEL2470)
⑨ FE 90 F2.8G OSS
⑩ FE 28-70 F3.5-5.6 OSS

Size / Weight:
A1+FL2870 kit
Size: approx. 219*193*176mm
Weight: approx.1543g

A1+FL90 kit
Size: approx. 242*193*176mm
Weight: approx. 1618g

A1+WA005-F kit
Size: approx. 312*212*223mm
Weight: approx. 1764g

Packaging list

- | | | |
|---|------------------|------------------------------|
| Camera waterproof case *1 | Cleaning cloth*1 | O-ring disassembly plate*1 |
| O-ring (back case)*1 | Instructions*1 | Hand rope *1 |
| Spare O-ring(lens port)*1 | Anti-fog sheet*1 | Heck rope *1 |
| Spare O-ring(vacuum system port)*1 | Remover*1 | Silicone grease *1(Optional) |
| Spare O-ring(vacuum sytem port cover)*1 | | |

*Optional lens ports

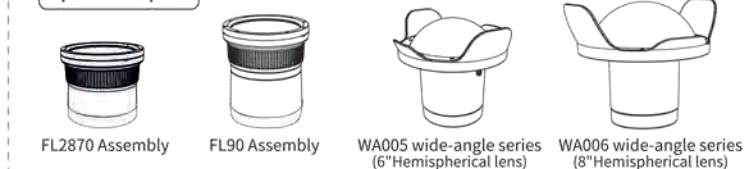

Function extension support:

- | | | |
|---|--|---|
| <input checked="" type="checkbox"/> All Camera Function | <input checked="" type="checkbox"/> 1/4 Mounting Plate | <input checked="" type="checkbox"/> Vacuum test |
| <input checked="" type="checkbox"/> Fiber Optic Cable Flash | <input checked="" type="checkbox"/> Handheld Bracket | <input checked="" type="checkbox"/> Interchangeable |
| <input checked="" type="checkbox"/> Sync Cable Flash | <input checked="" type="checkbox"/> Electronic Leak | <input checked="" type="checkbox"/> Lenses Port |
| <input checked="" type="checkbox"/> Cold Shoe Interface | <input checked="" type="checkbox"/> Detection Sensor | <input checked="" type="checkbox"/> Lenses Manual |
| | <input checked="" type="checkbox"/> Light Arms Extend | <input checked="" type="checkbox"/> Zoom |

08