

INSTRUCTIONS FOR USE – SCT-0825 – In-line adaptor for Aqualung Calypso and Apeks Flight hoses.

This tool allows the user to use the OEM hoses for the Aqualung Calypso QC or the Apeks Flight in conjunction with our balance in-line orifice adjustment tool (SCT-0808) with or w/o our gauge for balanced in-line adjustment tool (SCT-0821 is optional to SCT-0808).

Note: to connect the balanced in-line orifice adjustment tool to the 2nd stages (Calypso QC or Flight) adaptor SCT-1734 is also needed. This has to be purchased separately.

The tool set comes with 1x adaptor and 2x # 013 shore 70 O-rings. An O-ring has to be fitted onto the hose adaptor / inlet fitting of the balanced in-line orifice adjustment tool. The 2nd O-ring is a spare.

The hose adaptor (SCT-0825) screws onto the reversible hose adaptor / inlet fitting of the balanced in-line orifice adjustment tool. The hose adaptor / inlet fitting of the balanced in-line balanced orifice adjustment tool has 2 threaded sides. The longer threaded side – with o-ring - screws into the adjuster. The shorter threaded side connects with the low pressure regulator hose and in this case onto the hose adaptor (SCT-0825). Illustration below.

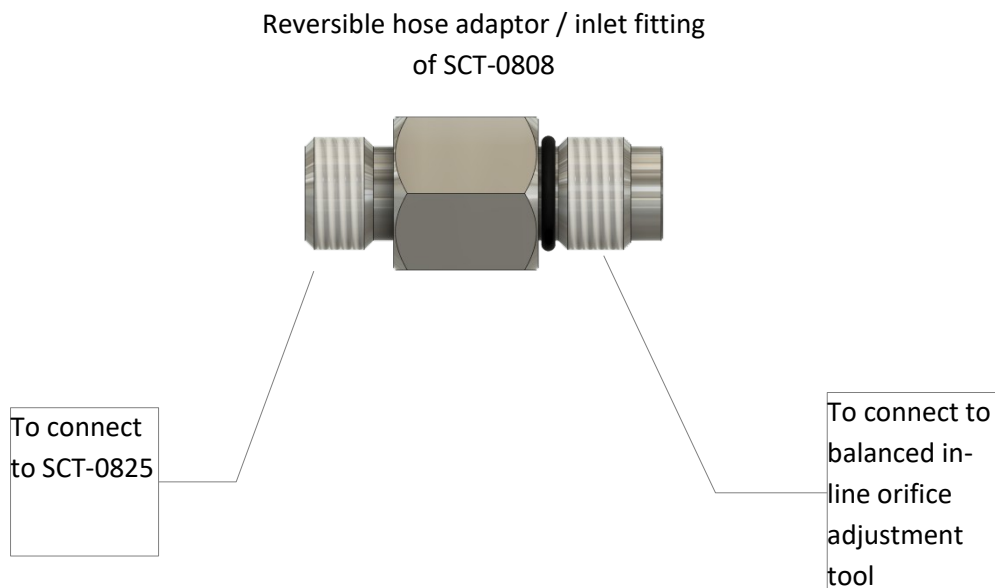

For the Apeks flight hose: connect the adaptor to the slotted side.

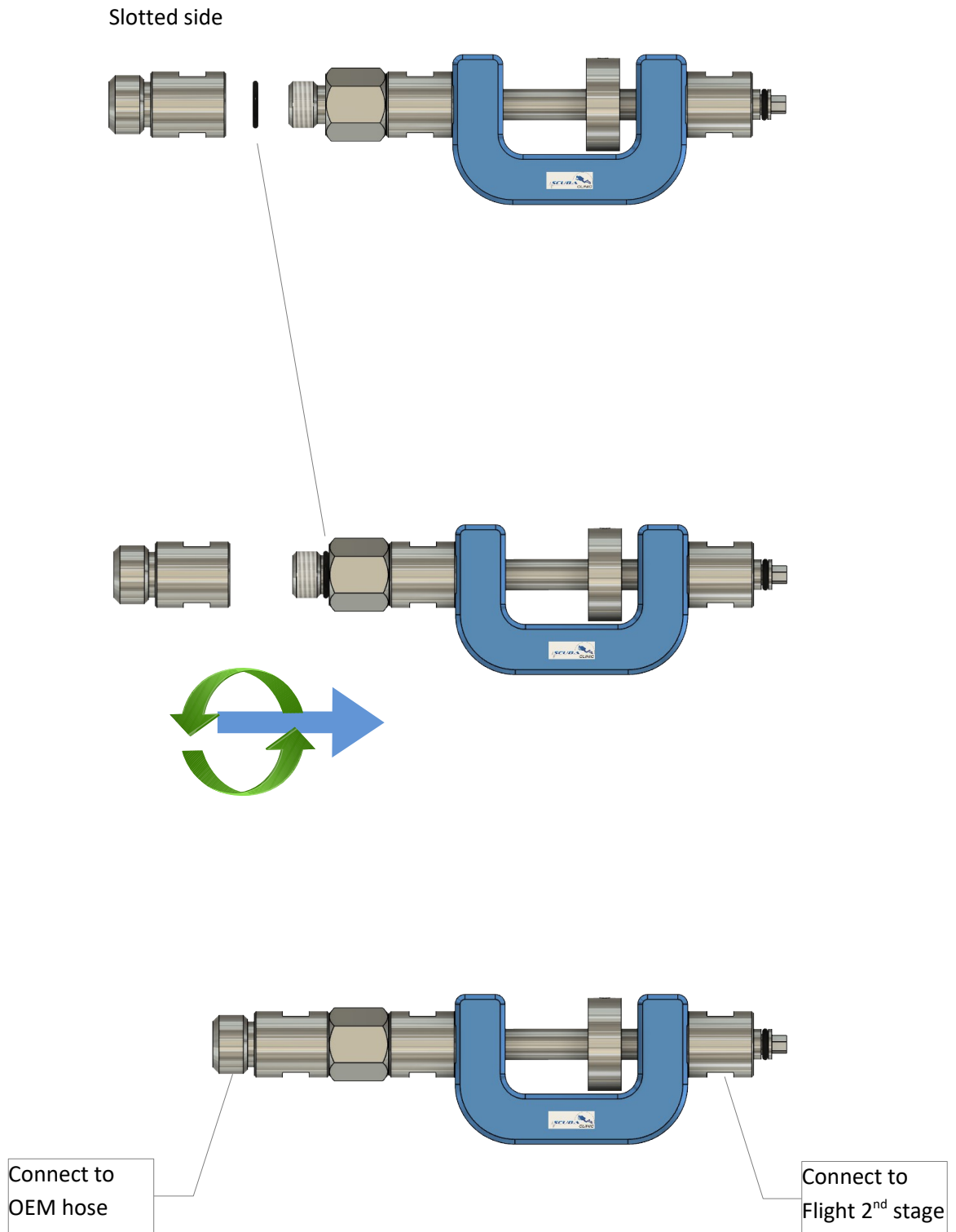

For the Aqualung Calypso QC hose: connect the adaptor to the hex side.

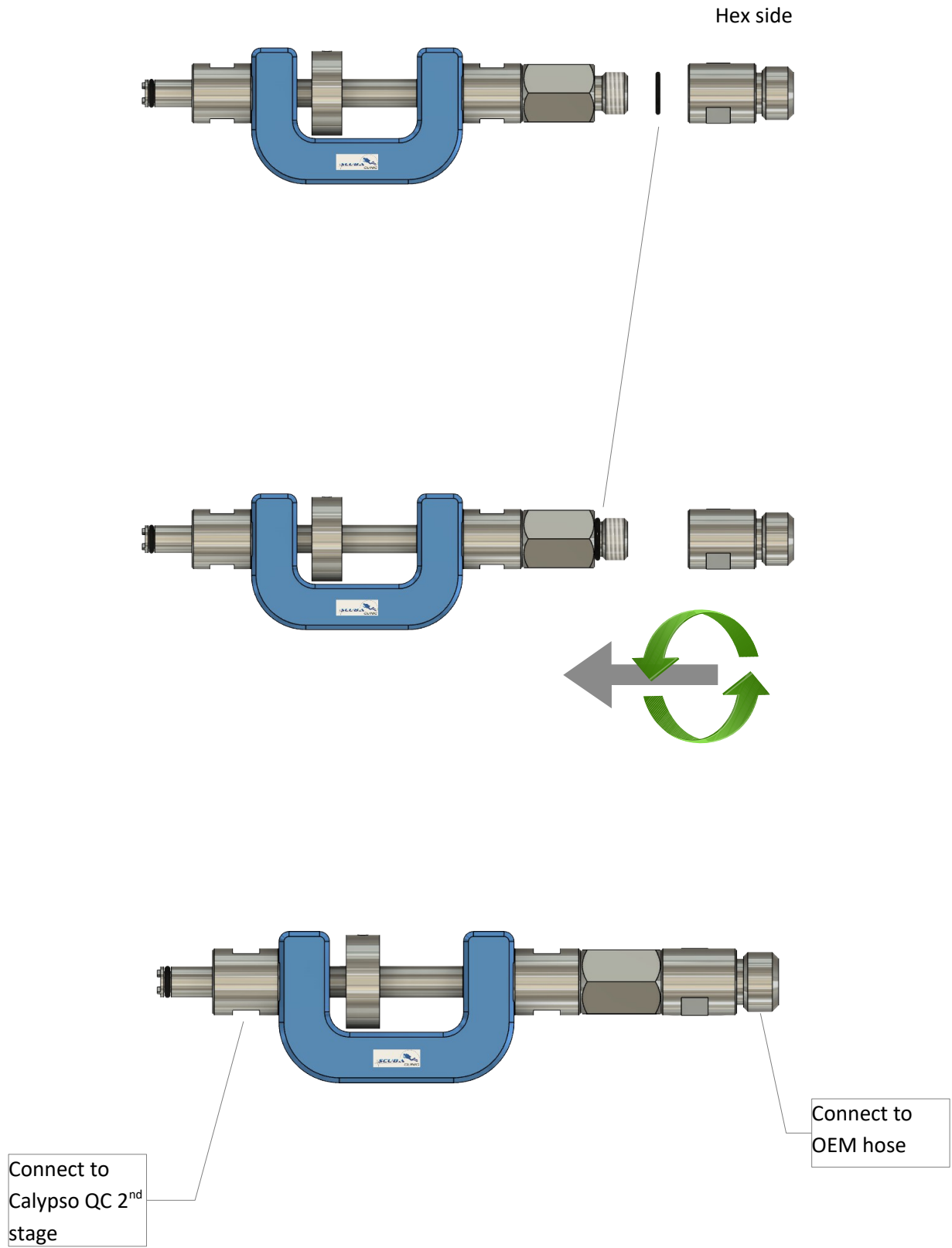

SAFETY WARNINGS:



This tool is only suitable for use with compressed low pressure air (maximum 15 bar). Do not use higher pressures or gas mixtures other than compressed air.



When the unit is pressurised, disconnecting the tool from the regulator-inflator will result in a continuous air flow from the tool. Note that the tool will not shut off the flow of air when disconnected. Never disconnect the tool from the regulator inflator if the system is pressurised.



After a regulator refurbishment, there is always a chance that something is amiss or faulty. One such catastrophic error /failure would be the full air supply pressure to travel through the first stage and into the second stage. This could lead to damage of the regulator(s), hose and tool / gauge and/or personal injury or death. Therefore, when pressurising a rebuilt set for the first time, we recommend to 1/ always slightly depress the purge button on the second stage, 2/ monitor the intermediate pressure and 3/ open the supply pressure slowly. If the intermediate pressure goes up too quickly and beyond the manufacturers settings, immediately shut down the air supply and correct the issue.



Operate this tool only whilst wearing safety glasses.