



Installation Guide
Part Number GRM1.1029.1.XXX
Last Updated 03/22/2023

GrimmSpeed GRM1.1029.1.XXX Install Guide



Fitment:

- 2015-2021 WRX/STI

Tools Needed:

- Ratchet
- 10mm Hex Socket or T-Handle
- 18mm Wrench
- 24mm Wrench or Crows foot
- 12mm Socket
- 13mm Socket
- Torque Wrench

Things to Note:

- This is a very basic installation and should only take 20-30 minutes to complete
- Be sure to follow recommended torque specs during the install.

product disclaimer:

United States 48 State Compliant:

California/New York Residents please see Prop 65.

This is a Race Only product that is to be used solely for competition, it cannot be used on vehicles that are operated on public streets, roads or highways. Its use is limited to closed-course and open-course racing that is formally sanctioned by a recognized racing organization. Any other use including recreational use could be in violation of local, state and federal laws.

GrimmSpeed is not responsible for any vehicle damage or personal injury that may occur due to an installation error, product misuse, or removal of GrimmSpeed products. GrimmSpeed highly suggests that a trained professional conduct the installation on all products. GrimmSpeed is not responsible for damaged products due to incorrect installation.

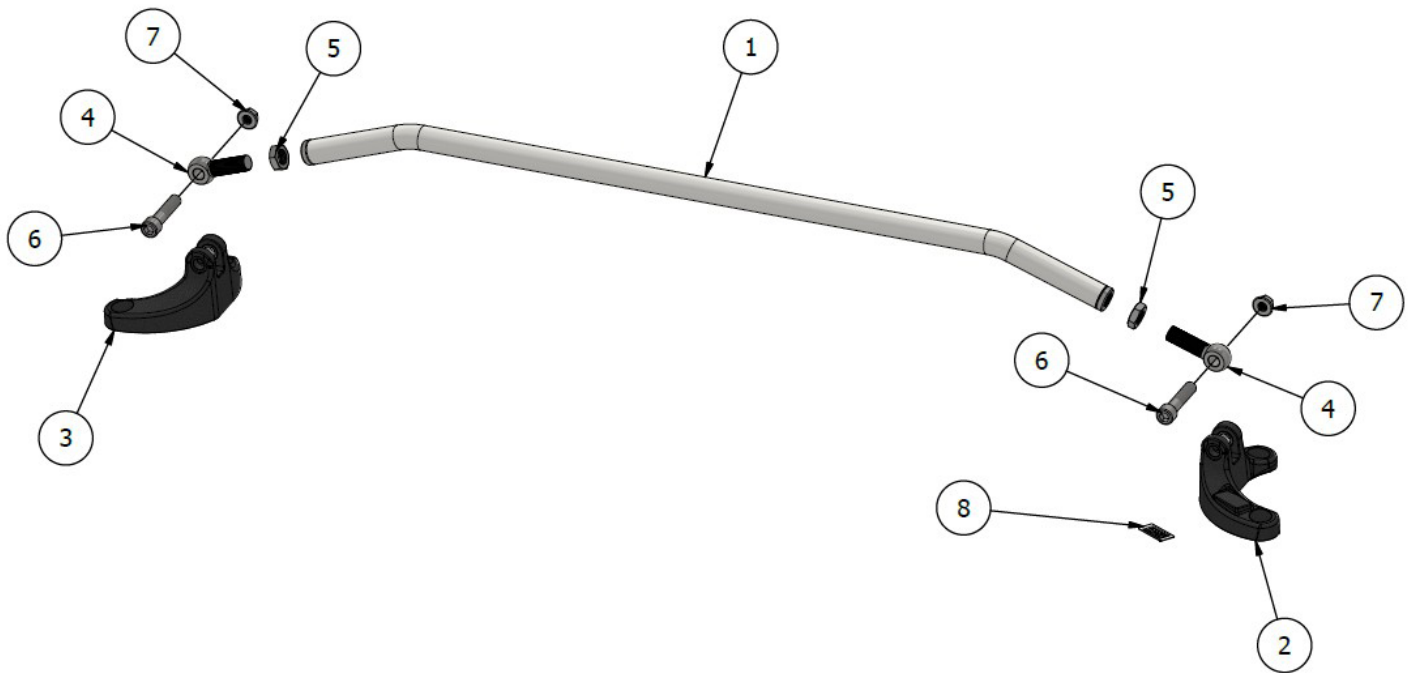

PARTS LIST			
ITEM	QTY	PART NUMBER	DESCRIPTION
1	1	098022BLK	Grimmspeed 15-21 Strut Bar - Weldment Powder Coated Black
2	1	GRM2.1029.1.BLK	Grimmspeed VA Strut Bar Forging Assembly DR
3	1	GRM2.1029.2.BLK	Grimmspeed VA Strut Bar Forging Assembly PS
4	2	098017	Grimmspeed Strut Bar Eyelet Bolt
5	2	098021	18-8 SS THIN HEX NUT
6	2	B07106	Socket Head Cap Screw - STAINLESS STEEL - M12 x 1.75 x 55
7	2	098020	18-8 Stainless Steel Flange Nut
8	1	098019	Grimmspeed Strut Bar Logo Medallion
9	1	111028	Grimmspeed Large "Packaged By" Post Card 3.5x6
10	2	111009	Grimmspeed 9" sticker
11	1	094074	GS License Plate Frame
12	1	BOX-42X10X4	BOX-42X10X4

Step 1 - Starting on a level surface, pop your hood.



Step 2 - Remove two of the strut mounting nuts pictured below on both sides of the car.



Step 3 - Take your GrimmSpeed Strut Bar and align the holes in the mounts with the two studs.



Step 4 - Reinstall the nuts one each side, torque to 14.8 Ft/Lbs.



Step 5 - Using a 10mm Hex bit and 18mm wrench tighten the nut and bolt to 35 Ft/Lbs.



Step 6 - Tighten down the locking nut. Snug is good here but if you have a crows foot, torque to 35 Ft/Lbs.



Step 7 - Congratulations on finishing your GrimmSpeed Strut Bar install!

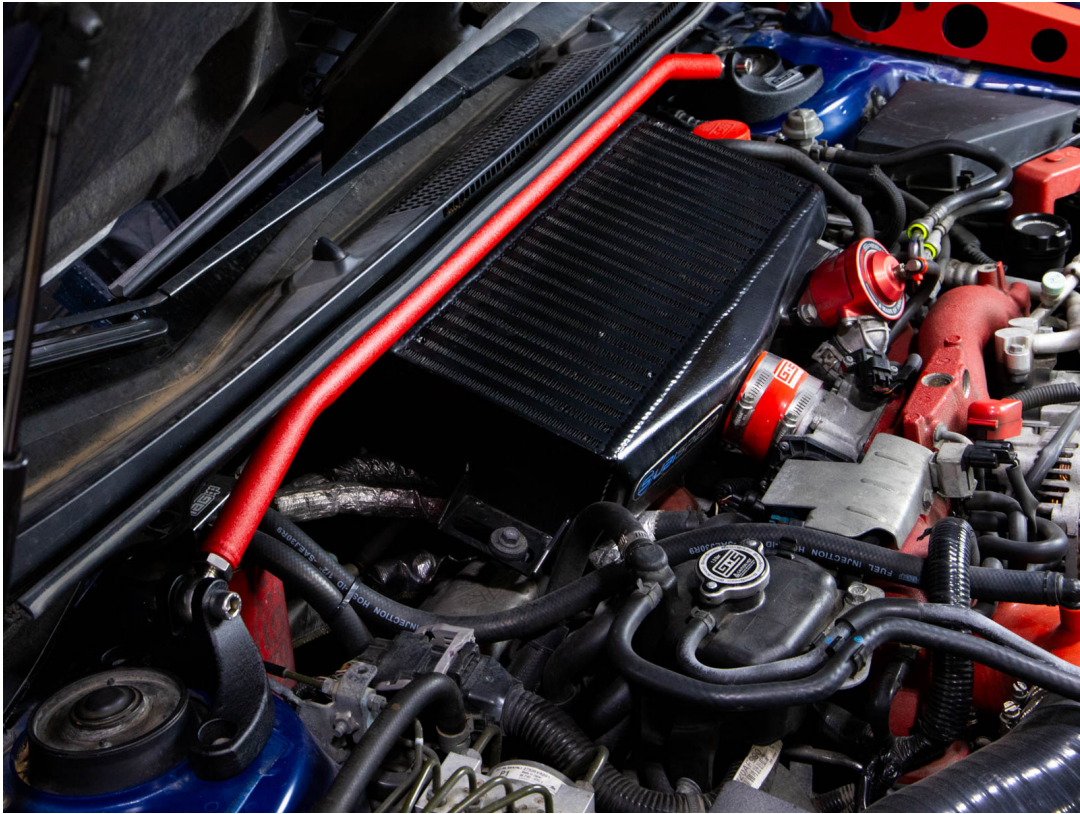



1400 Randall Ct, Unit 104
Export, PA 15632
612-379-0000
support@grimmspeed.com

www.grimmspeed.com

Follow us!
@grimmspeed

