

B1 INSTALLATION DRAWING

IF THIS DOCUMENT IS PRINTED IN HARDCOPY, IT IS FOR INFORMATION USE ONLY AND THEREFORE IS NOT SUBJECT TO UPDATING CONTROLS. ALWAYS REFER TO SOLIDWORKS VIEWER FOR LATEST ISSUE



THIS DRAWING IS CONFIDENTIAL AND IS SUPPLIED ON THE EXPRESS CONDITION THAT IT SHALL NOT BE LOANED OR COPIED OR DISCLOSED TO ANY OTHER PERSON OR USED FOR ANY OTHER PURPOSE WITHOUT THE WRITTEN CONSENT OF AP RACING LTD.



AP Racing
Wheler Road
Coventry
CV3 4LB
Tel: +44 024 7663 9595
Fax: +44 024 7663 9559
e-mail: sales@apracings.co.uk
Web site: HTTP://www.apracings.com

GENERAL DESCRIPTION
6 PISTON DIFFERENTIAL BORE CALIPER TO SUIT UP TO Ø380mm x 35.56mm MAX / 32mm MIN THICK IRON DISC.

TYPICAL APPLICATION - GENERAL USE CALIPER

TECHNICAL INFORMATION & INSTALLATION DATA
TOTAL PISTON AREA: 40.1cm²
BODY MATERIAL: ALUMINIUM ALLOY
PISTON MATERIAL: STAINLESS STEEL
ASSEMBLY WEIGHT (LESS PADS): 2.75Kg

INSTALLATION INFORMATION
DISC & CALIPER MOUNTING TOLERANCES TO BE SUCH THAT THE DISC IS CENTRAL TO THE CALIPER TO WITHIN ±0.5mm. DISC DIAMETRAL CLEARANCE SHOULD BE 2.5mm NOMINAL FROM DISC O/D TO PATHWAY.

KEY TO DIMENSIONS
'PL' DIMIN: TOP OF PAD MATERIAL TO MOUNTING BOSS FACE, WITH PAD SITTING DOWN ON LEDGE.
'U' DIMIN: WHEEL CENTRE LINE TO CALIPER MOUNTING BOSS FACE = (DISC Ø/2) - PL DIMIN

AP RACING TECHNICAL SECTION WILL BE PLEASED TO ADVISE ON THE MOST SUITABLE EQUIPMENT FOR ANY PARTICULAR APPLICATION.

CALIPER PART NUMBERS
CP9661-2S4L - RIGHT HAND
CP9661-3S4L - LEFT HAND

EXAMPLE PART # - CP9661-2 S (SIDE FEED) 4 (4lb AKB SPRINGS) L (STAINLESS PISTONS).

PADS
THE CORRECT PAD FAMILY FOR THIS CALIPER IS CP3905D54. PADS SHOULD BE ORDERED SEPARATELY.

REPLACEMENT SEAL KIT
SEAL KIT (VERY HIGH TEMPERATURE) CP8518-CDE

RECOMMENDED DISC AND PAD OPTIONS AVAILABLE
D54 DISC AND PAD COMBINATION

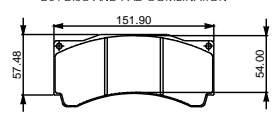

CP3905D54 FAMILY
AS CP3894D54 WITH TAG REMOVED
PAD THICKNESS 18.0mm
PAD AREA 77.44cm²
PAD VOLUME 101.6cm³

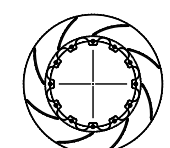

CP5772-1032/3CG8 Ø378x36 12F 72v 7.4Kg
CP5000-218/9CG8 Ø356x32 12B 72v 6.2Kg

OPTIMUM BLEED POSITIONING

FOR OPTIMUM BLEED, THE CALIPER SHOULD BE INSTALLED IN THE LEADING OR TRAILING POSITION BETWEEN THE ANGLES SHOWN

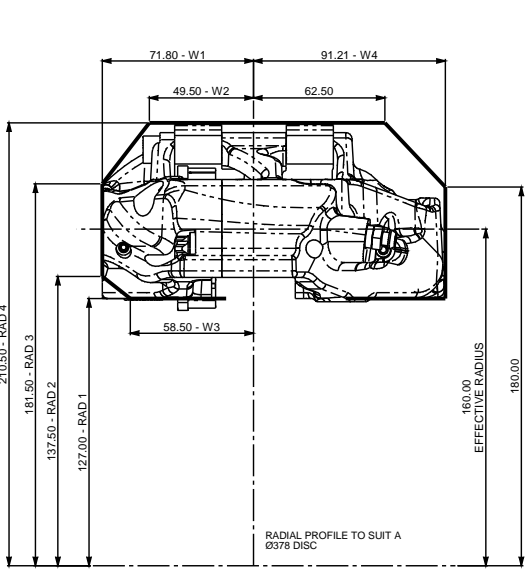
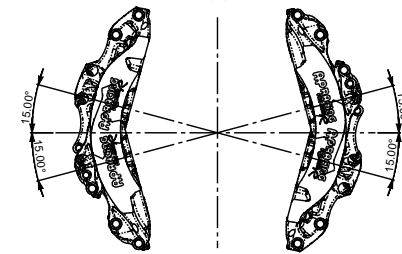

DISC Ø	EFF RAD	RAD 1	RAD 2	RAD 3	RAD 4	W1	W2	W3	W4
356	149.00	116.00	126.50	171.50	200.75	71.80	49.50	58.50	91.21

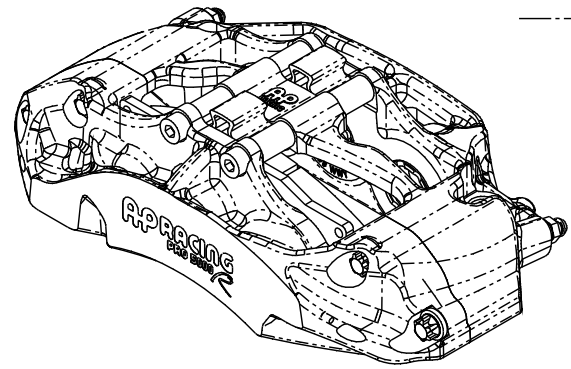
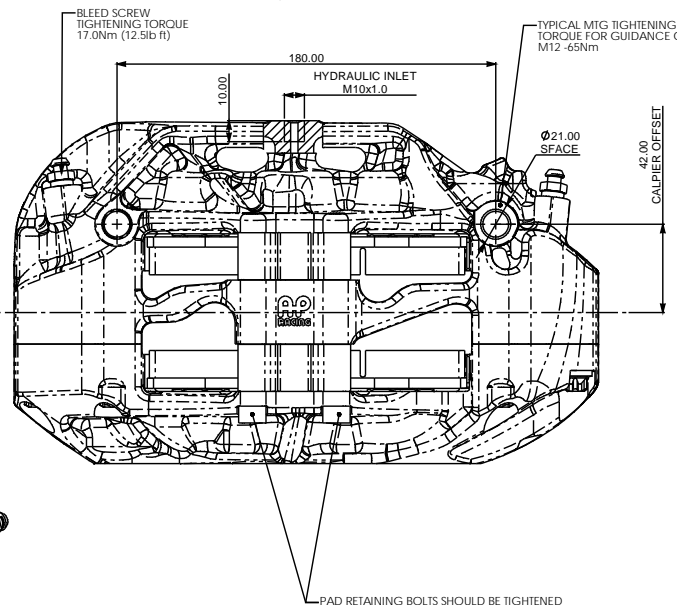
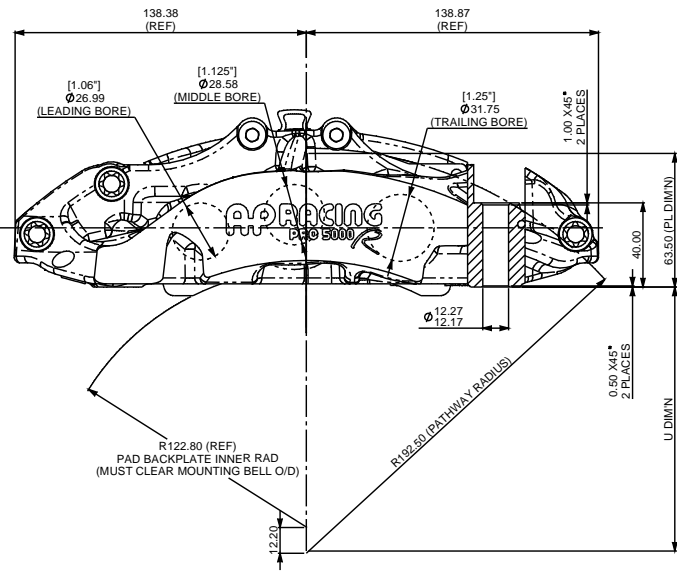

PAD RETAINING BOLTS SHOULD BE TIGHTENED TO A TORQUE OF 13.1Nm (9.7lb ft)

ISSUE NO	Alterations		Drawn	Checked
	Date & No.	Particulars		
1	18/08/16 B7606	FIRST ISSUE		NK

SCALE 1:1	SHEET 1 OF 2
DRAWN N KIBBLE	
APPROVED	
DERIVED FROM	
TITLE	
DRG NO. CP9661-1CD	

B1 INSTALLATION DRAWING

IF THIS DOCUMENT IS PRINTED IN HARDCOPY, IT IS FOR INFORMATION USE ONLY AND THEREFORE IS NOT SUBJECT TO UPDATING CONTROLS. ALWAYS REFER TO SOLIDWORKS VIEWER FOR LATEST ISSUE



FIRST ANGLE PROJECTION

THIS DRAWING IS CONFIDENTIAL AND IS SUPPLIED ON THE EXPRESS CONDITION THAT IT SHALL NOT BE LOANED OR COPIED OR DISCLOSED TO ANY OTHER PERSON OR USED FOR ANY OTHER PURPOSE WITHOUT THE WRITTEN CONSENT OF AP RACING LTD.



AP Racing
Wheler Road
Coventry
CV3 4LB
Tel: +44 024 7663 9595
Fax: +44 024 7663 9559
e-mail: sales@apracings.co.uk
Web site: HTTP://www.apracings.com

REF	PART NUMBER	DESCRIPTION	QTY / CALIPER	FITTING NOTES
1	CP3880-1	M10 BLEED SCREW KIT	2	TIGHTENING TORQUE - 17Nm
2	CP9440-116	M5 BUTTON SCREW	2	APPLY A 1-2MM DROP OF LOCTITE 270 TO THE 2ND FROM LAST THREAD WHEN FITTING. TIGHTENING TORQUE - 3.7Nm
3	CP9660-110	RH WEARPLATE	1	APPLY 736 RTV SILICONE SPARINGLY BEHIND THE ABUTMENT PLATE ENSURING ENTIRE CONTACT FACE IS COVERED.
4	CP9660-111	LH WEARPLATE	1	APPLY PRESSURE TO ABUTMENT PLATE WHEN FITTING TO ENSURE MINIMUM FILM THICKNESS AND AVOID ANY GAP.
5	CP9660-115	Ø1.25" SST PISTON	2	
6	CP9661-110	Ø1.125" SST PISTON	2	
7	CP9660-114	Ø1.06" SST PISTON	2	
8	CP8518-CDE	PISTON SEAL KIT	1	REFER TO PUBLICATION REF: P14.290 & P14.220
9	CP3796-112ST	M8 CAP SCREW	2	TIGHTENING TORQUE - 13.1Nm
10	CP9660-113	PAD RETAINER PIECE	2	

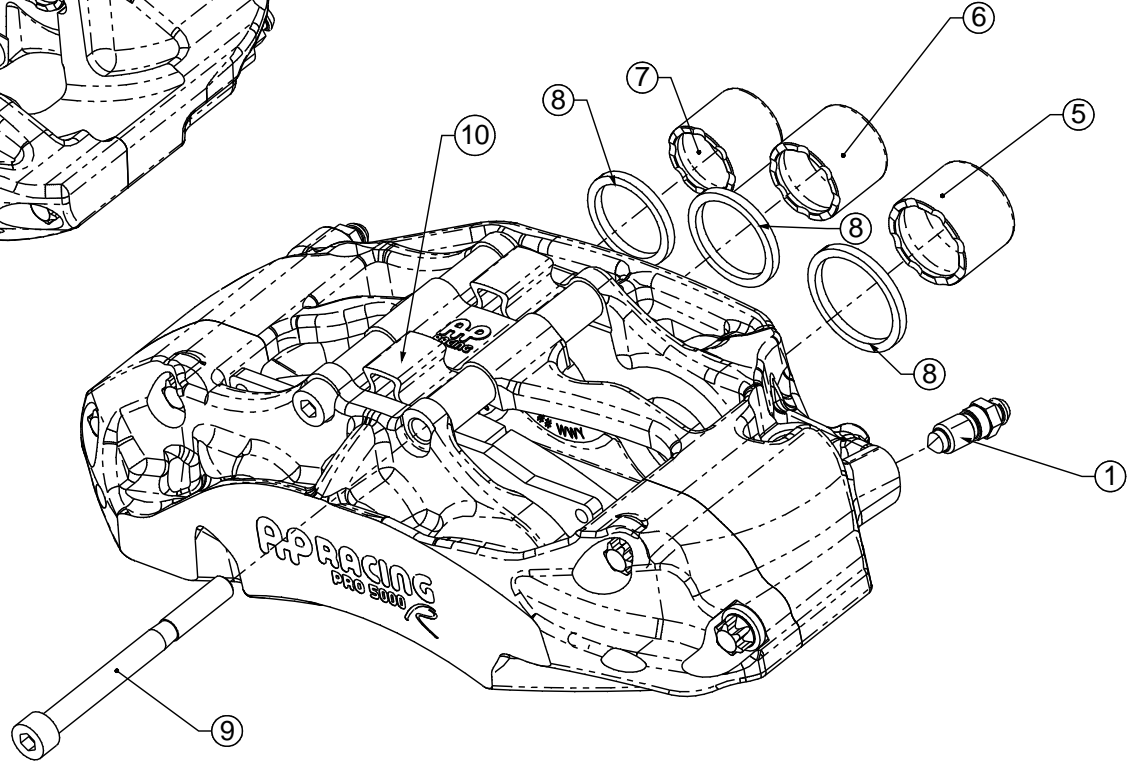
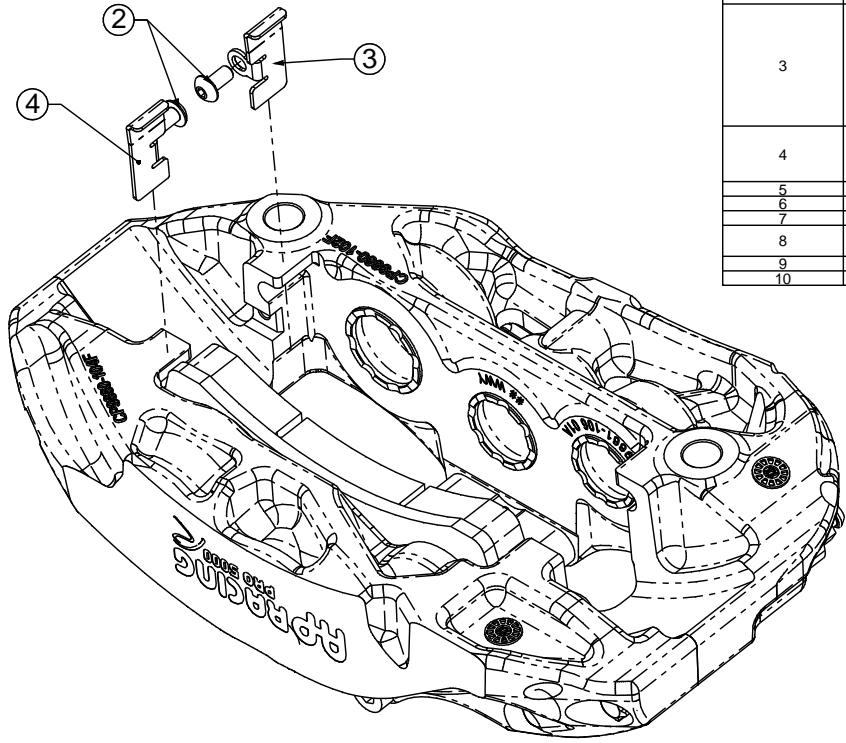

ISSUE NO	Alterations		Zone	Initials
	Date & No.	Particulars		

SCALE 1:1 SHEET 2 OF 2

DRAWN N KIBBLE

APPROVED

DERIVED FROM

TITLE

DRG NO. CP9661-1CD