



Equipped with AEM® Dryflow™ Filter
No Oil Required!

INSTALLATION INSTRUCTIONS

PART NUMBER

21-802C (GUN METAL GRAY FINISH)

2015-16	AUDI	A3	2.0T
2016-17	VOLKSWAGEN	GTI / Golf R	2.0T
2017	VOLKSWAGEN	GTI	1.8T

Not legal for sale or use on any pollution controlled motor vehicle in California or states adopting California emission procedures. See AEMIntakes.com for CARB status on each part for a specific vehicle.

ITEM NO.	PART NUMBER	DESCRIPTION	QTY.
1	21-2113D	ELEMENT PARTS KIT; 3.25 X 7" DRY ELE	1
2	2-1585C	INTAKE TUBE; 3.25"OD X 19", 21-802; GUNMETAL GRAY	1
3	20-8544	HEAT SHIELD; 21-746 VOLKSWAGEN GOLF 1.8T, TB/PC	1
4	084034	HOSE; 3-1/4" TO 2-3/4" ID X 2" L TPRD REINFORCED	1
5	102471	EDGE TRIM; 3/4 BULB, TOP LOC, 35"L	1
6	444.460.04	NUT; M6 HEX SERRATED	1
7	07027	STUD; M6-1.00 M/M, RUBBER MNTD	1
8	08160	WASHER; 1"D X 1/4 HOLE FENDER	1
9	9444	HOSE CLAMP, 2.31-3.25"	1
10	9456	1/2" BNDHOSE CLAMP,3.15"-4.00"	2
11	784646	GROMMET, 1/2" 3/32 GW	3
12	8-215	PLUG; BLIND QUICK DISCONNECT	1

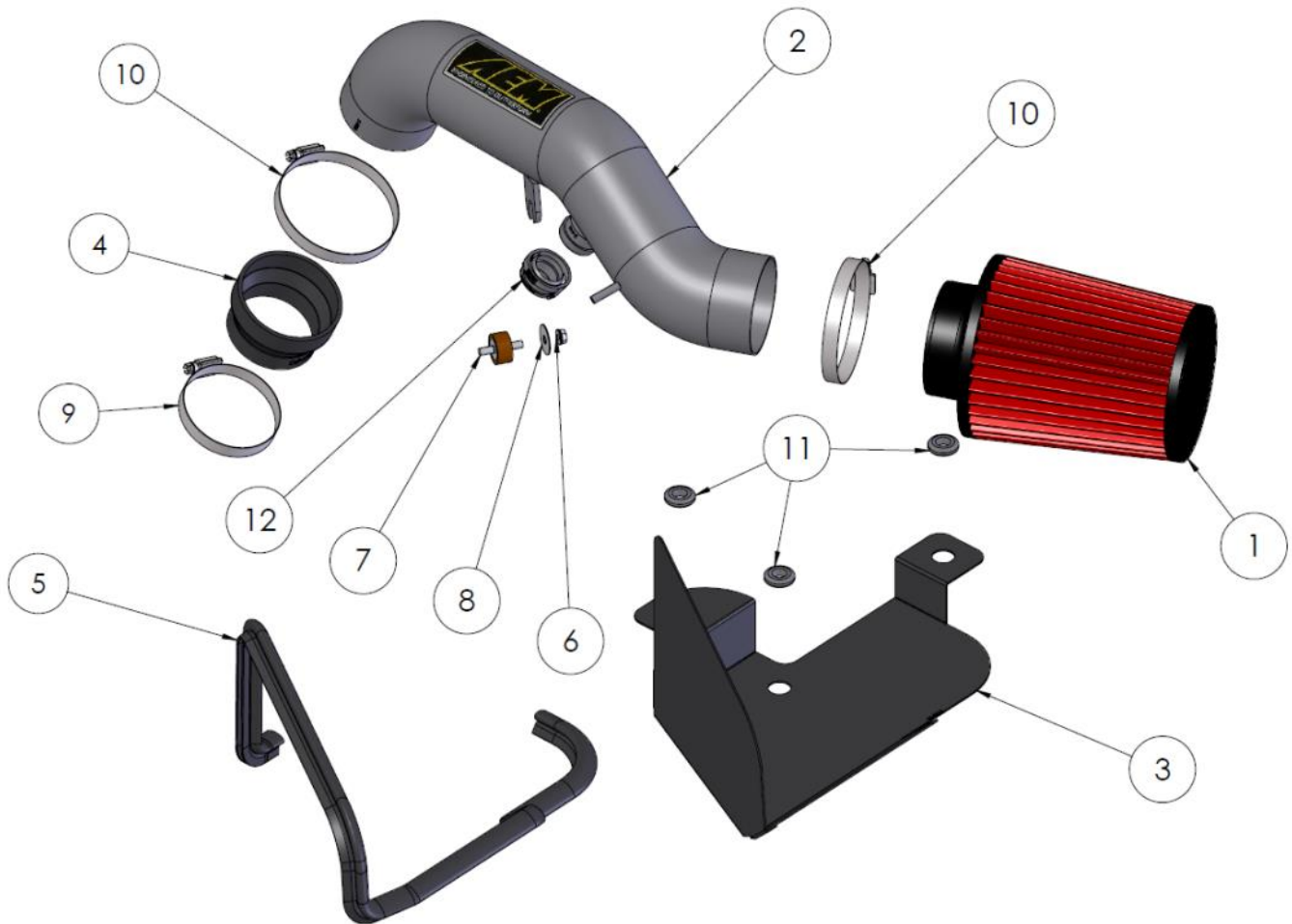

Read and understand these instructions **BEFORE** attempting to install this product. Failure to follow installation instructions and not using the provided hardware may damage the intake tube, throttle body and engine. If you need any assistance please call 1-800-858-3333 to speak with a representative in our Customer Service Center before returning the product.

Tools Needed:	Optional:
Screwdriver	Small Torque Wrench
7mm Socket	
10mm Socket	
Socket Driver	

1. Preparing Vehicle

- a. Make sure vehicle is parked on level surface.
- b. Set the parking brake.
- c. If engine has run in the past two hours, let it cool down.
- d. Disconnect negative battery terminal.
- e. Do not discard stock components after removal of the factory system.
- f. Open the air intake kit package and make sure all parts are included.

2. Removal of stock system



a. Remove the plastic engine cover by pulling up gently, releasing it from the rubber grommets.



b. Loosen the hose clamp at the turbocharger and disengage the intake hose from the turbo inlet.



c. Remove small vacuum line from the stock air box. Remove the large air injection hose by depressing the ribbed parts of the collar. Note: Not all models will have this large hose.



d. Remove the stock air box and intake hose assembly from the vehicle by pulling upwards to disengage the three rubber grommets. Lift the hose side first and maneuver the box towards the rear, clearing the cold air inlet.

3. Installation of AEM® intake system.

- a. When installing the intake system, do not completely tighten the hose clamps or mounting hardware until instructed to do so.



a. Install the provided edge trim and rubber grommets onto the AEM heat shield as shown.



b. Install the provided coupler and hose clamps onto the turbo with the small end towards the turbo inlet. Tighten the turbo-side hose clamp to 30in-lb at



c. Install the provided rubber mount onto the side of the engine. Loosely install the provided washer and nut onto the tuber mount.

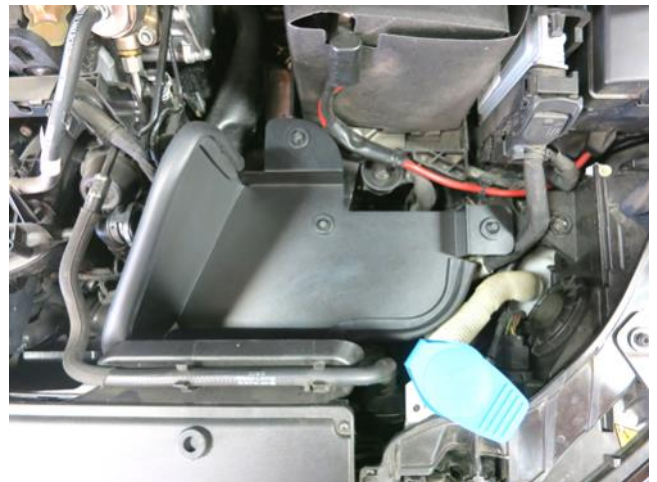

d. Install the AEM heat shield onto the factory air box mounting studs. Soapy water may be used to help the grommets engage with the studs.



e. Position the AEM intake tube in the engine bay and connect the small vacuum hose to the small nipple. Move the large air injection hose behind the AEM heat shield and connect it to the AEM intake tube. Soapy water should be used to help installation. Note: Not all models have this large hose. Install the included blind plug (8-215) in its place.



f. Lower the AEM intake tube bracket onto the rubber mount, between the washer and rubber mount, and insert the tube into the coupler. Do not tighten the mount or coupler at this time.



g. Install the AEM Dry Flow filter and hose clamp onto the intake tube and tighten to 30 in-lb. Position the tube for best fit and tighten the coupler and mounting bracket at this time.



h. Reinstall the plastic engine cover by lining up the grommets with the posts and pressing down gently.



STOCK INTAKE INSTALLED



AEM INTAKE INSTALLED

4. Reassemble Vehicle

- a. Position all kit components for best fitment. Ensure that no components contact any unintended part of the vehicle.
- b. Check for proper hood clearance. Re-adjust components if necessary and re-tighten them.
- c. Inspect the engine bay for any loose tools and ensure that all fasteners that were moved or removed are properly tightened.
- d. Reconnect negative battery terminal and start engine. Let the vehicle idle for 3 minutes. Perform a final inspection before driving the vehicle.

5. Service and Maintenance

- a. AEM Induction Systems requires cleaning the intake system's air filter element every 100,000 miles. When used in dusty or off-road environments, our filters will require cleaning more often. We recommend that you visually inspect your filter once every 25,000 miles to determine if the screen is still visible. When the screen is no longer visible some place on the filter element, it is time to clean it. To clean, purchase our Synthetic air filter cleaner, part number 1-1000 and follow the easy instructions.
- b. Use window cleaner to clean your powder coated AEM[®] intake tube.

NOTE: DO NOT USE aluminum polish on powder coated AEM[®] intake tubes.

For technical inquiries
e-mail us at
sales@aemintakes.com
or
call us at
800.992.3000

AEM Air Intake System Warranty Policy

AEM® warrants that its intake systems will last for the life of your vehicle. AEM® will not honor this warranty due to mechanical damage (i.e. improper installation or fitment), damage from misuse, accidents or flying debris. AEM® will not warrant its powder coating if the finish has been cleaned with a hydrocarbon-based solvent. The powder coating should only be cleaned with a mild soap and water solution. Proof of purchase of both the vehicle and AEM® intake system is required for redemption of a warranty claim.

This warranty is limited to the repair or replacement of the AEM® part. In no event shall this warranty exceed the original purchase price of the AEM® part nor shall AEM® be responsible for special, incidental or consequential damages or cost incurred due to the failure of this product. Warranty claims to AEM® must be transportation prepaid and accompanied with dated proof of purchase. This warranty applies only to the original purchaser of product and is nontransferable. Improper use or installation, use for racing, accident, abuse, unauthorized repairs or alterations voids this warranty. AEM® disclaims any liability for consequential damages due to breach of any written or implied warranty on all products manufactured by AEM®. Warranty returns will only be accepted by AEM® when accompanied by a valid Return Merchandise Authorization (RMA) number. Credit for defective products will be issued pending inspection. Product must be received by AEM® within 30 days of the date RMA is issued.

If you have a warranty issue, please call (800) 992-3000 and our customer service department will assist you. A proof of purchase is required for all AEM® warranty claims.

Not legal for sale or use on any pollution controlled motor vehicle in California or states adopting California emission procedures. See AEMIntakes.com for CARB status on each part for a specific vehicle.