



Equipped with AEM® Dryflow™ Filter
No Oil Required!

INSTALLATION INSTRUCTIONS

PART NUMBER

21-792C (Gun Metal Gray Finish)

2016	Honda	Civic	Excludes Test Group GHNXV02.0BK3	2.0L	C.A.R.B. E.O.# D-670-24
2017	Honda	Civic		2.0L	

Some intake systems are not legal for sale or use on any pollution controlled motor vehicle in California or states adopting CA emission procedures. To know if a part number is legal in CA on your vehicle, visit AEMIntakes.com.

ITEM NO.	PART NUMBER	DESCRIPTION	QTY.
1	9436	1/2' BNDHOSE CLAMP,1.81"-2.75"	1
2	5-256	HOSE; ADAPTER 2.50/2.75 X 2" BL	1
3	9440	HOSE CLAMP, 2.15-3.00"	1
4	5-3001	HOSE; 7/16" ID X 3"L	1
5	08553	HOSE CLAMP; SPRING BAND 20MM X 12MM	2
6	102503	EDGE TRIM; 3/4 BULB, TOP LOC, 83"L	1
7	2-1570C	INTAKE TUBE; 2.75"OD X 20", 21-792, GUNMETAL	1
8	20-8575	HEAT SHIELD, HONDA CIVIC 2.0L 2016	1
9	1-2065	BOLT; HEX M6-1 X 12MM	1
10	1-3018	WASHER, M6 x 12MM OD ZINC	2
11	070228	STUD; RUBBER MNT, M/F, 1/2"L X 1"W, M6 X 1.00	1
12	07027	STUD; M6-1.00 M/M, RUBBER MNTD	1
13	444.460.04	NUT; M6 HEX SERRATED	1
14	9444	HOSE CLAMP, 2.31-3.25"	1
15	21-2027DK	AIR FILTER; 2.75" X 7" DRYFLOW	1

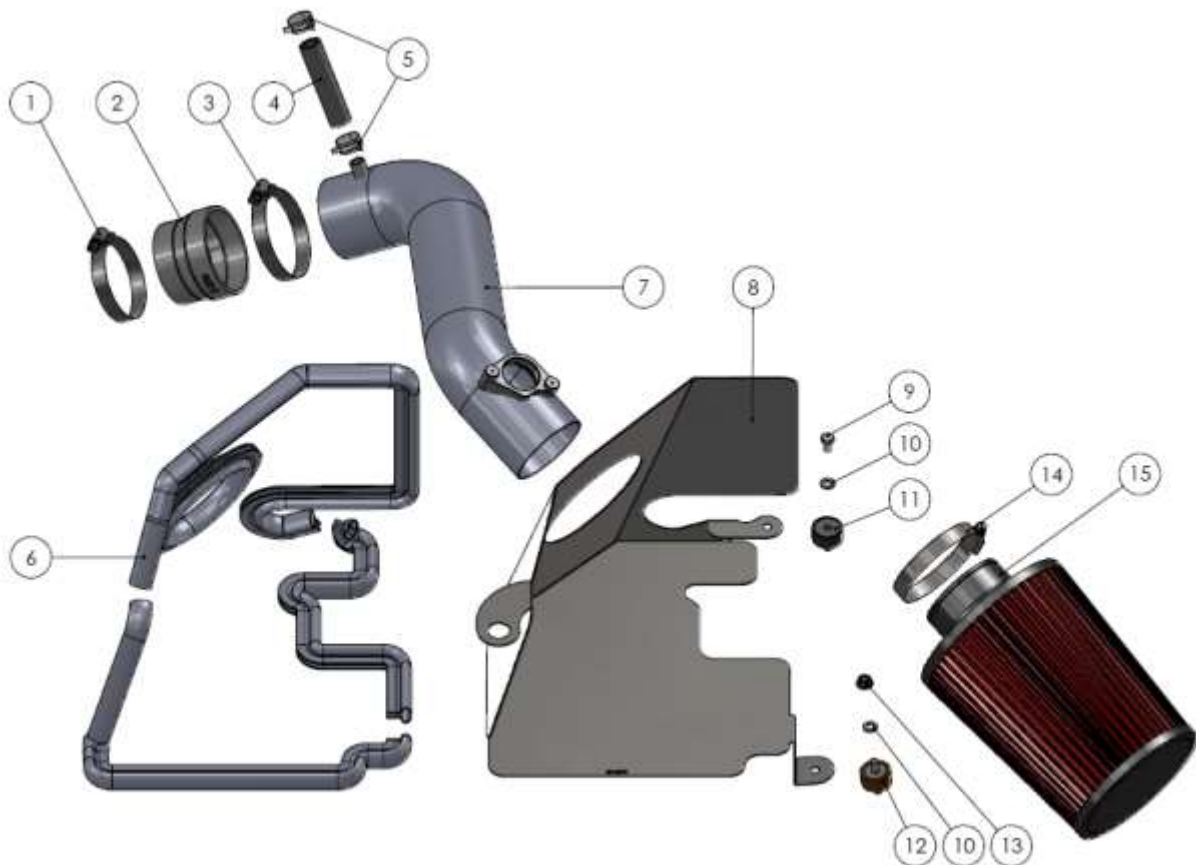

Read and understand these instructions **BEFORE** attempting to install this product. Failure to follow installation instructions and not using the provided hardware may damage the intake tube, throttle body and engine. If you need any assistance please call 1-800-858-3333 to speak with a representative in our Customer Service Center before returning the product.

1. Preparing Vehicle

- a. Make sure vehicle is parked on level surface.
- b. Set the parking brake.
- c. If engine has run in the past two hours, let it cool down.
- d. Disconnect negative battery terminal.
- e. Do not discard stock components after removal of the factory system.
- f. Open the air intake kit package and refer to diagram on page 2 to make sure all parts are included.

Tools Needed:

Screw Drivers	Torque Wrench
10mm Socket	Side Cutters
Socket Driver	Pliers
6" Extension	
10mm Ratcheting Wrench	

2. Removal of stock system



a. Remove the nine push-in clips, and remove the front shroud cover.



b. Remove the two push-in clips that secure the air box to the core support.



c. Depress the MAF (Mass Air Flow) sensor connector tab and remove the connector from the sensor. Then, disconnect the green zip tie from the harness.



d. Squeeze the spring clamp on the vent line and remove the vent line from the stock intake tube.



e. Unlatch the two clips on the stock air box.



f. Loosen the hose clamp at the throttle body.



g. Remove the upper air box with the intake arm.



h. Remove the two bolts that secure the lower air box to the vehicle.



i. Lift the lower air box out of the vehicle making sure to disconnect the grommet from the vehicle.



j. Lower air box removed.



k. Remove the grommet from the lower air box. This will be reused in step 3f.



l. Remove the two screws and pull the MAF sensor from the stock upper air box. They will be reused in step 3c.

3. Installation of AEM® intake system.

a. When installing the intake system, do not completely tighten the hose clamps or mounting hardware until instructed to do so.



a. Install the two rubber mounts into the vehicle as shown.



b. Install the provided coupler and hose clamps onto the throttle body. Tighten the circled hose clamp (30 in. lb.) at this time.



c. Install the MAF sensor into the AEM tube with the hardware that was removed in step 2l.



d. Install the provided hose and spring clamps onto the AEM intake tube. Trimming to 1.5" may be necessary.



e. Install the provided edge trim as shown. Trimming the edge trim will be necessary.



f. Install the grommet that was removed in step 2k. as shown.



g. Install the AEM heat shield into the vehicle as shown, routing it around the electrical harness.



h. Seat the grommet onto the air box post as shown.



i. With the provided hardware, secure the AEM heat shield to the previously installed rubber mount towards the rear of the vehicle.



j. With the provided hardware, secure the AEM heat shield to the previously installed rubber mount on the frame rail.



k. Lower the AEM filter with hose clamp into the AEM heat shield as shown.



l. Align the previously installed hose on the AEM intake to the factory vent hard line and secure with the spring clamp.



m. Connect the AEM intake tube to the AEM filter, and tighten the hose clamp (30 in. lb.) to secure the filter to the tube. Connect the MAF sensor connector.



n. Connect the other end of the AEM intake tube into the coupler that was installed on the throttle body.



o. Once the AEM intake tube is properly aligned with the coupler and the heat shield, tighten the circled hose clamp (30 in. lb.).



p. Re-install the front shroud cover on to the vehicle with the nine push-in clips removed in step 2a.



STOCK INTAKE INSTALLED



AEM INTAKE INSTALLED

4. Reassemble Vehicle

- a. Position all kit components for best fitment. Ensure that no components contact any unintended part of the vehicle.
- b. Check for proper hood clearance. Re-adjust components if necessary and re-tighten them.
- c. Inspect the engine bay for any loose tools and ensure that all fasteners that were moved or removed are properly tightened.
- d. Reconnect negative battery terminal and start engine. Let the vehicle idle for 3 minutes. Perform a final inspection before driving the vehicle.

5. Service and Maintenance

- a. AEM Induction Systems requires cleaning the intake system's air filter element every 100,000 miles. When used in dusty or off-road environments, our filters will require cleaning more often. We recommend that you visually inspect your filter once every 25,000 miles to determine if the screen is still visible. When the screen is no longer visible some place on the filter element, it is time to clean it. To clean, purchase our Synthetic air filter cleaner, part number 1-1000 and follow the easy instructions.
- b. Use window cleaner to clean your powder coated AEM[®] intake tube.

NOTE: DO NOT USE aluminum polish on powder coated AEM[®] intake tubes.

For technical inquiries
e-mail us at
sales@aemintakes.com
or
call us at
800.992.3000

AEM Air Intake System Warranty Policy

AEM® warrants that its intake systems will last for the life of your vehicle. AEM® will not honor this warranty due to mechanical damage (i.e. improper installation or fitment), damage from misuse, accidents or flying debris. AEM® will not warrant its powder coating if the finish has been cleaned with a hydrocarbon-based solvent. The powder coating should only be cleaned with a mild soap and water solution. Proof of purchase of both the vehicle and AEM® intake system is required for redemption of a warranty claim.

This warranty is limited to the repair or replacement of the AEM® part. In no event shall this warranty exceed the original purchase price of the AEM® part nor shall AEM® be responsible for special, incidental or consequential damages or cost incurred due to the failure of this product. Warranty claims to AEM® must be transportation prepaid and accompanied with dated proof of purchase. This warranty applies only to the original purchaser of product and is nontransferable. Improper use or installation, use for racing, accident, abuse, unauthorized repairs or alterations voids this warranty. AEM® disclaims any liability for consequential damages due to breach of any written or implied warranty on all products manufactured by AEM®. Warranty returns will only be accepted by AEM® when accompanied by a valid Return Merchandise Authorization (RMA) number. Credit for defective products will be issued pending inspection. Product must be received by AEM® within 30 days of the date RMA is issued.

If you have a warranty issue, please call (800) 992-3000 and our customer service department will assist you. A proof of purchase is required for all AEM® warranty claims.

Some intake systems are not legal for sale or use on any pollution controlled motor vehicle in California or states adopting CA emission procedures. To know if a part number is legal in CA on your vehicle, visit AEMIntakes.com.