



Equipped with AEM® Dryflow™ Filter  
No Oil Required!

# INSTALLATION INSTRUCTIONS

## PART NUMBER

### 21-779C (Gun Metal Gray Finish)

---

2015 MAZDA 6 2.5L Excludes Test Group FTKXV02.5NC2 C.A.R.B. E.O. # D-670-24

Intake systems for vehicles listed are 50 state legal. See [AEMIntakes.com](http://AEMIntakes.com) for CARB status on each part for a specific vehicle.

ITEM NO.	PART NUMBER	DESCRIPTION	QTY.
1	9444	HOSE CLAMP, 2.31-3.25"	1
2	084034	HOSE; 3-1/4" TO 2-3/4" ID X 2" L TPRD REINFORCED	1
3	9452	1/2" BNDHOSE CLAMP,2.90"-3.75"	1
4	8-4013	EDGE TRIM, 13"	1
5	8-4028	EDGE TRIM, 28"	1
6	20-8568	HEAT SHIELD, 21-779, 21-779, 2014 MAZDA 6 2.5L	1
7	784639	GROMMET,13/32"	1
8	07733	BOLT; M4 - 0.07 8MM, A/H CAP, SS	2
9	2-1558C	INTAKE TUBE; 3.25"OD X 8", 21-779, GUNMETAL GRAY	1
10	9-0378	VENTURI; 3.075"OD X 2.975"ID X 3.25"L, PLASTIC	1
11	9456	1/2" BNDHOSE CLAMP,3.15"-4.00"	1
12	21-2113DK	AIR FILTER; 3.25" X 7" DRYFLOW	1

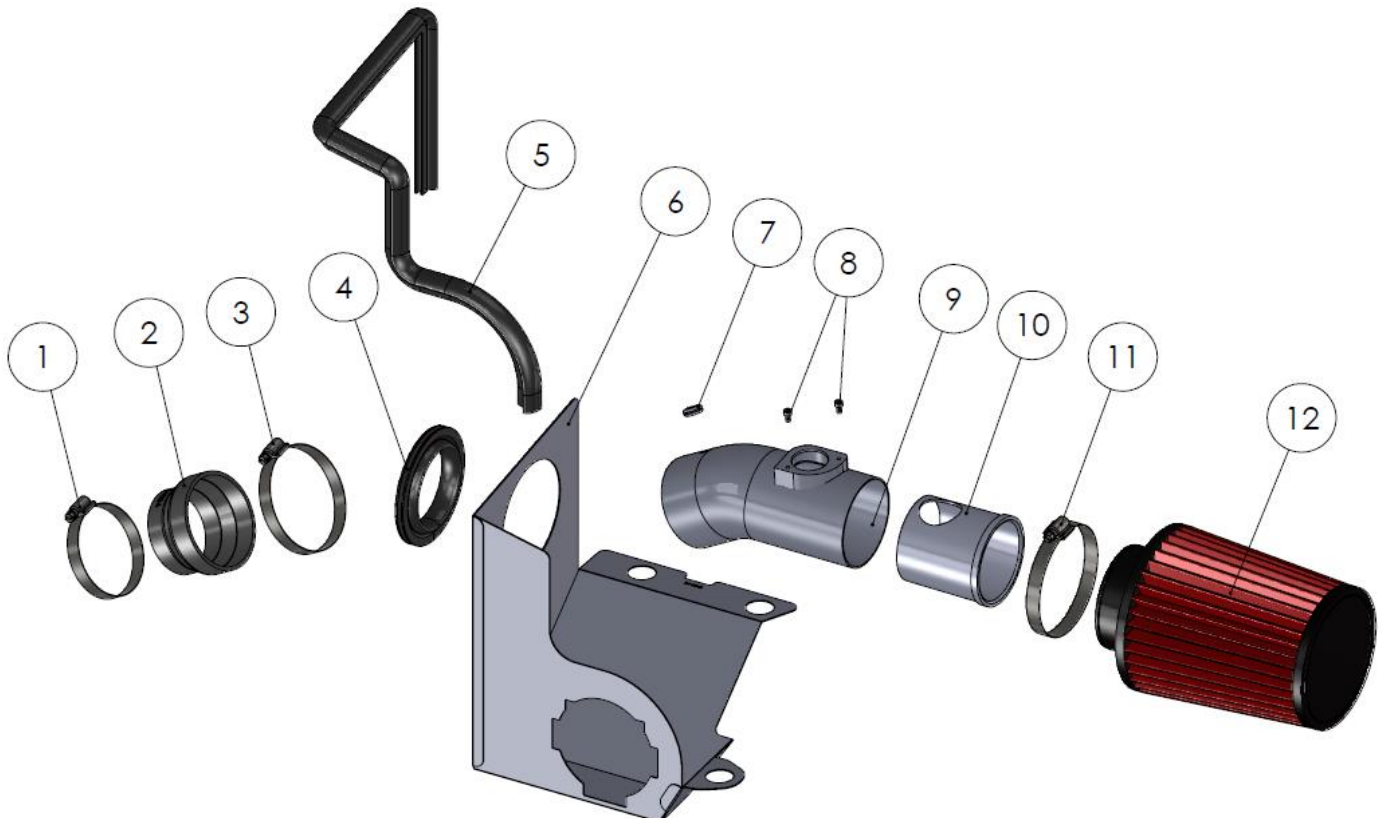

Read and understand these instructions **BEFORE** attempting to install this product. Failure to follow installation instructions and not using the provided hardware may damage the intake tube, throttle body and engine. If you need any assistance please call 1-800-858-3333 to speak with a representative in our Customer Service Center before returning the product.

**Tools Needed:**

- Screw driver
- 10MM socket
- Socket Driver
- Side Cutters
- 4MM Hex Key

## 1. Preparing Vehicle

- a. Make sure vehicle is parked on level surface.
- b. Set the parking brake.
- c. If engine has run in the past two hours, let it cool down.
- d. Disconnect negative battery terminal.
- e. Do not discard stock components after removal of the factory system.
- f. Open the air intake kit package and make sure all parts are included.

## 2. Removal of stock system



a. Remove engine cover by gently pulling it up and away from the top of the engine.

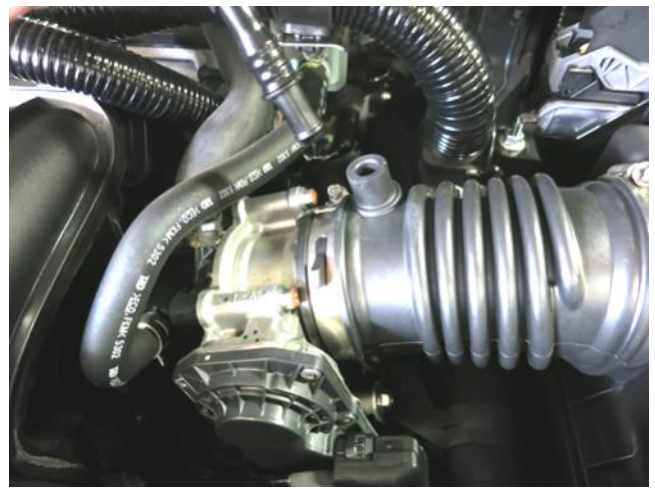

b. Remove breather hose from factory coupler.

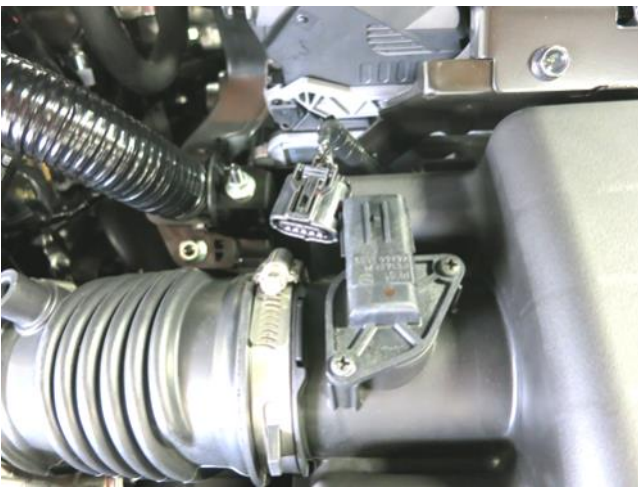

c. Unplug MAF sensor harness.



d. Loosen hose clamp securing coupler to throttle body.



e. Use needle nose pliers to unclip wire harness from air box.

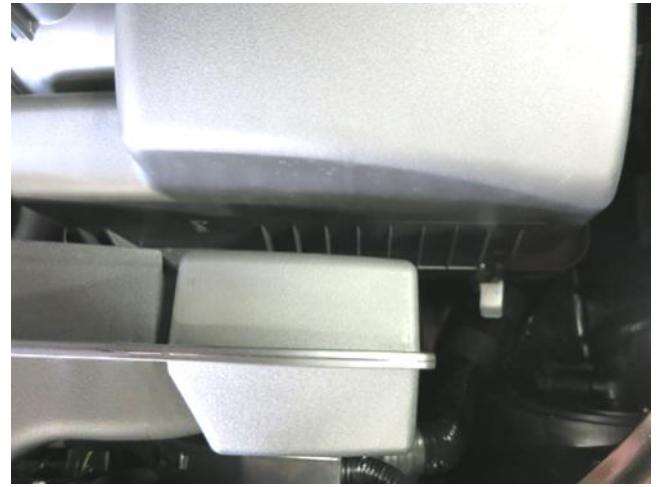

f. Unclip air box lid from lower air box.



g. Remove the air box lid along with the air inlet hose.

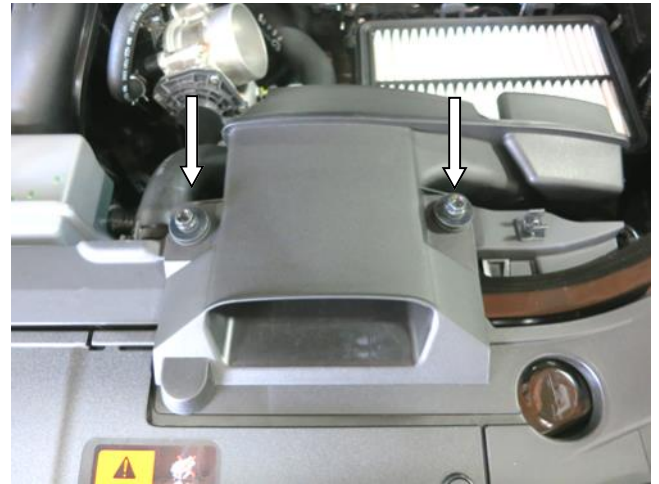

h. Loosen the two M6 bolts securing the factory cold air inlet scoop.



i. Gently remove factory lower air box and factory cold air inlet scoop.

### 3. Installation of AEM® intake system.

- a. When installing the intake system, do not completely tighten the hose clamps or mounting hardware until instructed to do so.



a. Unclip the two plastic retainers securing the cold air inlet scoop to the factory air box.



b. Unclip the resonator chamber from the cold air scoop while rotating the cold air scoop gently.



c. Separate the cold air scoop from the lower air box.



d. Remove the three rubber grommets from the factory air box and insert them into the AEM heat



e. Install edge trim around the intake tube pass through hole and around the AEM heat shield then install the air scoop into the AEM heat shield assem-



f. Install the AEM heat shield assembly into the engine compartment by lining up the three rubber grommets and secure with factory M6 bolts.



g. Install the supplied MAF sleeve into the AEM intake tube and line up the opening to the MAF

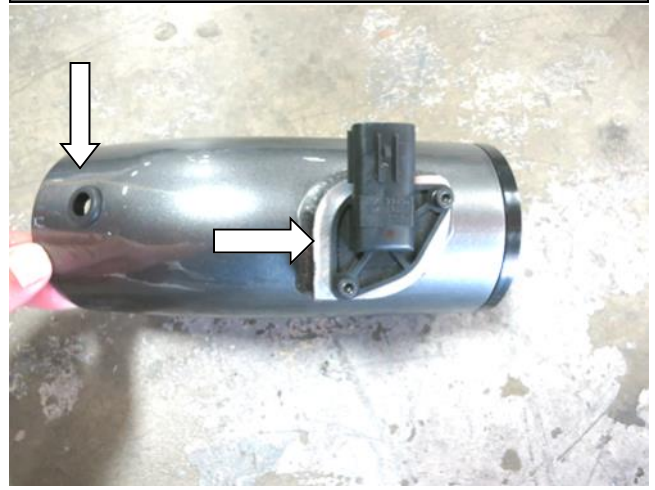

h. Install MAF sensor and rubber grommet into the AEM intake tube as shown.



i. Install provided coupler with hose clamps onto throttle body. Do not tighten hose clamps at this point.



j. Install the AEM intake tube through the heat shield to the throttle body coupler as shown.



k. Install the AEM filter onto the intake tube.

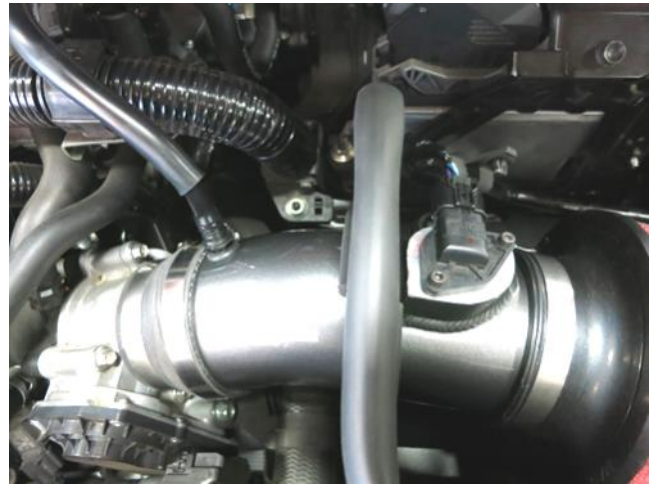

l. Install the breather hose into the coupler and re-connect the MAF sensor wiring.



m. Check for clearance around the filter, heat shield and intake tube then tighten all hose clamps. Reinstall the engine cover.



o. Factory air induction system.



p. Finished installation of AEM Intake System.

#### 4. Reassemble Vehicle

- a. Position the inlet pipes for the best fitment. Be sure that the pipes or any other components do not contact any part of the vehicle.
- b. Check for proper hood clearance. Re-adjust pipes if necessary and re-tighten them.
- c. Inspect the engine bay for any loose tools and check that all fasteners that were moved or removed are properly tightened.
- d. Reconnect negative battery terminal and start engine. Let the vehicle idle for 3 minutes. Perform a final inspection before driving the vehicle.

#### 5. Service and Maintenance

- a. AEM Induction Systems requires cleaning the intake system's air filter element every 100,000 miles. When used in dusty or off-road environments, our filters will require cleaning more often. We recommend that you visually inspect your filter once every 25,000 miles to determine if the screen is still visible. When the screen is no longer visible some place on the filter element, it is time to clean it. To clean, purchase our Synthetic air filter cleaner, part number 1-1000 and follow the easy instructions.
- b. Use window cleaner to clean your powder coated AEM<sup>®</sup> intake tube.

**NOTE: DO NOT USE aluminum polish on powder coated AEM<sup>®</sup> intake tubes.**

For technical inquiries  
e-mail us at  
[sales@aemintakes.com](mailto:sales@aemintakes.com)  
or  
call us at  
800.992.3000



## **AEM Air Intake System Warranty Policy**

AEM® warrants that its intake systems will last for the life of your vehicle. AEM® will not honor this warranty due to mechanical damage (i.e. improper installation or fitment), damage from misuse, accidents or flying debris. AEM® will not warrant its powder coating if the finish has been cleaned with a hydrocarbon-based solvent. The powder coating should only be cleaned with a mild soap and water solution. Proof of purchase of both the vehicle and AEM® intake system is required for redemption of a warranty claim.

This warranty is limited to the repair or replacement of the AEM® part. In no event shall this warranty exceed the original purchase price of the AEM® part nor shall AEM® be responsible for special, incidental or consequential damages or cost incurred due to the failure of this product. Warranty claims to AEM® must be transportation prepaid and accompanied with dated proof of purchase. This warranty applies only to the original purchaser of product and is nontransferable. Improper use or installation, use for racing, accident, abuse, unauthorized repairs or alterations voids this warranty. AEM® disclaims any liability for consequential damages due to breach of any written or implied warranty on all products manufactured by AEM®. Warranty returns will only be accepted by AEM® when accompanied by a valid Return Merchandise Authorization (RMA) number. Credit for defective products will be issued pending inspection. Product must be received by AEM® within 30 days of the date RMA is issued.

If you have a warranty issue, please call (800) 992-3000 and our customer service department will assist you. A proof of purchase is required for all AEM® warranty claims.

**Intake systems for vehicles listed are 50  
state legal. See [AEMIntakes.com](http://AEMIntakes.com) for CARB  
status on each part for a specific vehicle.**