



Please read before using equipment.

## ! IMPORTANT !

If an icon appears at the end of a paragraph, go to the box on that page with the corresponding icon for pertinent information.

-  - Caution
-  - Note

## NOTE

Do not paint the speaker element. We recommend you spray paint the grille so paint does not block the holes.

## CAUTION

Be sure not to cut into any existing wiring or plumbing hidden behind the wall.

## NOTE

Avoid routing the speaker wire near electrical wires.  
Do not nail or staple through speaker wire.

## PREPARING THE LOCATION

Required Tools: (not included)

- drywall or keyhole saw
- wire stripper
- Phillips screwdriver
- pencil
- 14 - 18 gauge speaker wire

1. Be sure the mounting surface is between 3/8" (9.5mm) and 1 1/4" (31mm) thick, with at least 2 3/4" (69mm) clearance behind the mounting surface.

2. Remove the inner cardboard rectangle with rounded edges from the template/paint mask. Keep it for later. Use the outer portion as a template to mark the cutout hole size and location for mounting the speaker.

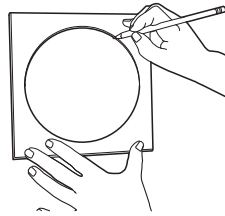

3. Use a drywall or keyhole saw to cut the hole. Do not cut into any existing wiring or plumbing hidden behind the wall.

## PAINTING THE SPEAKER(optional)

Note: Do not paint the speaker element. Also, we recommend that you use spray paint on the grille so that paint does not block the holes.

If you choose to paint the frame and/or the grille, let the paint dry completely before connecting the speaker wires or mounting the speaker.

To remove the grille, use the grille remover. If the grille remover is ever lost, you may still remove the grille by inserting a paper clip into one of the grille openings and then pulling up. Or, you may carefully twist the plastic frame back and forth until the grille edges become exposed. Then, simply lift the grille.

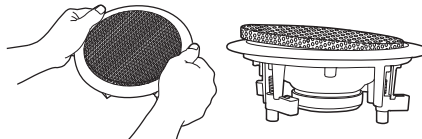

Be sure to carefully remove the dust cloth from behind the grille and replace it after the painting is completed.

You may also paint the frame to match your ceiling. To prevent paint from entering the speaker, remove the grille and insert the supplied cardboard paint mask. Once the paint is dry, remove the paint mask and replace the grille.

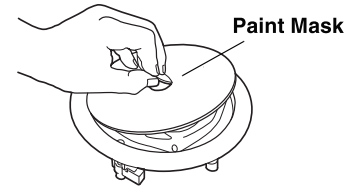

## CONNECTING THE SPEAKER WIRES

Many types of speaker wires are available. We recommend using speaker wire that is color-coded or marked to facilitate a successful connection.

1. Route the speaker wire from the receiver to the speaker. Avoid routing the speaker wire near electrical wires. Do not nail or staple through speaker wires.
2. Gently pull on the ends of the wires to separate about 4" (101mm) of wire at each end.

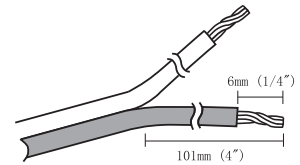

3. Using a wire stripper, remove about 1/4" (6mm) of insulation from each wire. Twist the ends of each wire.

4. Connect the marked wire to a red speaker terminal by pressing the tab, inserting the wire into the hole, and then releasing the tab. Repeat this procedure to connect the unmarked wire to the black terminal.

5. Connect the marked wire coming from the speaker to the left channel of the receiver's positive (+) terminal. Connect the unmarked wire to the left channel of the receiver's negative (-) terminal.

## MOUNTING THE SPEAKER

1. Adjust the speaker to the desired angle.
2. Remove the grille to expose the mounting screws.
3. Be sure the mounting tabs are turned in, allowing the speaker to fit into the hole. Then insert the speaker into the hole.
4. Use the four screws to fasten the mounting tabs to the ceiling. Do not over tighten the screws.
5. Replace the grille.

Mounting  
Tabs

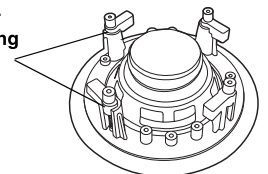

Note: If you ever want to remove the speaker from the ceiling, loosen the screws only far enough to remove the speaker. This will prevent the loss of the mounting tabs.