

Interior Downlights

# HIDE RETRACTABLE

design by Spazio



- Die cast aluminium body
- Stainless steel clip
- Class I
- IP 20
- Cut out size 90mm
- Tilt Angle 90° (Fig 2)
- Rotation Angle 330°, (Fig 2a)

Fig 1.

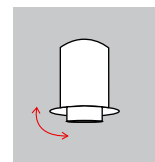

Fig 2.

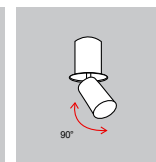
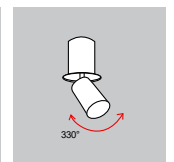

Fig 2. a



Interior Downlights

# HIDE RETRACTABLE

design by Spazio

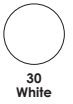

code

**8924**

lamp details

10W / GU10

