

Submersible Grinder Pumps

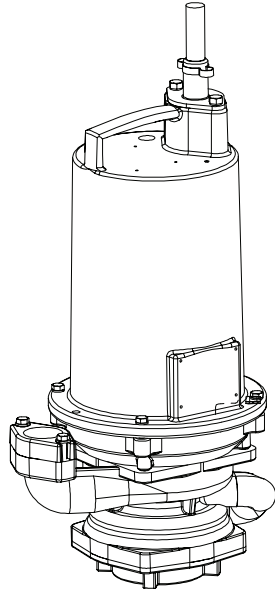

Specifications:

DISCHARGE	1¼" NPT, Vertical, Bolt-on Flange
LIQUID TEMPERATURE	104°F (40°C) Continuous
VOLUTE	Cast Iron ASTM A-48, Class 30
MOTOR HOUSING	Cast Iron ASTM A-48, Class 30
SEAL PLATE	Cast Iron ASTM A-48, Class 30
IMPELLERS: Design	12 Vane, Vortex, With Pump Out Vanes On Back Side. Dynamically Balanced,
	ISO G6.3.
	<i>Material</i>85-5-5-5 Bronze
IMPELLER SPACER	300 Series Stainless Steel
SHREDDING RING	Hardened 440C Stainless Steel Rockwell® C-55.
CUTTER	Hardened 440C Stainless Steel, Rockwell® C-55.
SHAFT	416 Stainless Steel
SQUARE RINGS	Buna-N
HARDWARE	300 Series Stainless Steel
PAINT	Air Dry Enamel.
SEAL:	
	<i>Design</i>Single Mechanical
	<i>Material</i>Rotating Faces - Silicon-Carbide Stationary Faces - Silicon-Carbide Elastomer - Buna-N Hardware -300 Series Stainless
CORD ENTRY	30 ft. (9.1 m) Std. Cord. Custom Molded Quick Connect, for Sealing and Strain Relief
CORD	<i>Manual</i>CSA/UL Approved, 12/4 Type SOW
UPPER BEARING:	
	<i>Design</i>Single Row, Angular contact Ball
	<i>Lubrication</i>Oil
	<i>Load</i>Radial & Thrust
LOWER BEARING:	
	<i>Design</i>Single Row, Angular contact Ball
	<i>Lubrication</i>Oil
	<i>Load</i>Radial & Thrust
MOTOR:	
	<i>Design</i>NEMA L-Single Phase Torque Curve, Oil-Filled, Squirrel Cage Induction (includes overload protection in the motor), NEMA B three phase torque curve.
	<i>Insulation</i>Class F
SINGLE PHASE	Capacitor Start/Capacitor Run.
THREE PHASE	Tri-Voltage 200/240-480, requires overload protection to be included in control panel.
OPTIONAL EQUIPMENT	Cord Length, Moveable Fitting
RECOMMENDED:	
	<i>Accessories</i>Break Away Fitting (BAF) Check Valve Control Panel
	<i>Seal Kit PN</i>116664
	<i>Service Kit PN</i>116665

Series: OGP 2HP, 3450RPM, 60Hz

This product may be covered by one or more of the following patents and other patent(s) pending:
US Patent 7,357,341



CSA 108 - File No. LR16567
UL 778

3 Phase Models are CSA Listed ONLY

Sample Specifications: Section 3 Page 10.

DESCRIPTION:

THE GRINDER PUMP IS DESIGNED TO REDUCE DOMESTIC SEWAGE TO A FINELY GROUND SLURRY.

Submersible Grinder Pumps

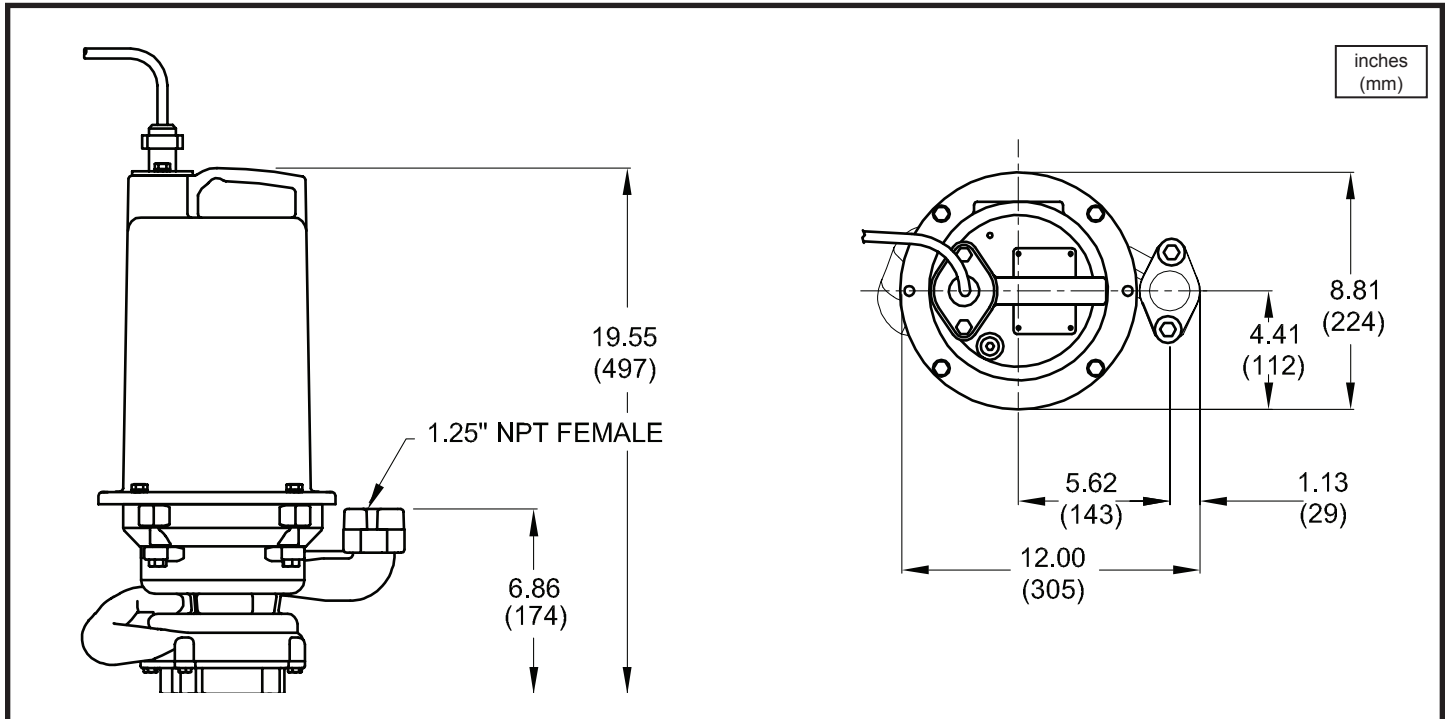

MODEL NO	PART NO	HP	VOLT	PH/Hz	RPM (Nom)	NEMA START CODE	FULL LOAD AMPS	LOCKED ROTOR AMPS	CORD SIZE	CORD TYPE	CORD O.D. ± .02 (.5) in (mm)
OGP2022L	115328	2	240	1 / 60	3450	H	16.5	53.8	12/3	SOW	.61 (15.5)
OGP2062L	134925	2	200	3 / 60	3450	L	10.8	52.7	12/4	SOW	.67 (17.0)
OGP2032L	135034	2	240	3 / 60	3450	L	8.9	43.9	12/4	SOW	.67 (17.0)
OGP2042L	135035	2	480	3 / 60	3450	L	4.5	22.0	12/4	SOW	.67 (17.0)

FOR 3 PHASE MODELS: TEMPERATURE SENSOR CORD IS 14/3 SOW, 0.55 (14MM) ± .02 (.51MM) O.D.

IMPORTANT !

- 1.) PUMP MAY BE OPERATED "DRY" FOR EXTENDED PERIODS WITHOUT DAMAGE TO MOTOR AND/OR SEALS.
- 2.) THIS PUMP IS APPROPRIATE FOR THOSE APPLICATIONS SPECIFIED AS CLASS I DIVISION II HAZARDOUS LOCATIONS.
- 3.) THIS PUMP IS NOT APPROPRIATE FOR THOSE APPLICATIONS SPECIFIED AS CLASS I DIVISION I HAZARDOUS LOCATIONS.
- 4.) INSTALLATIONS SUCH AS DECORATIVE FOUNTAINS OR WATER FEATURES PROVIDED FOR VISUAL ENJOYMENT MUST BE INSTALLED IN ACCORDANCE WITH THE NATIONAL ELECTRIC CODE ANSI/NFPA 70 AND/OR THE AUTHORITY HAVING JURISDICTION. THIS PUMP IS NOT INTENDED FOR USE IN SWIMMING POOLS, RECREATIONAL WATER PARKS, OR INSTALLATIONS IN WHICH HUMAN CONTACT WITH PUMPED MEDIA IS A COMMON OCCURRENCE.

Series OGP

Performance Curve
2HP, 3450RPM, 60Hz, High-Flow

BARNES®

www.cranepumps.com

Submersible Grinder Pumps

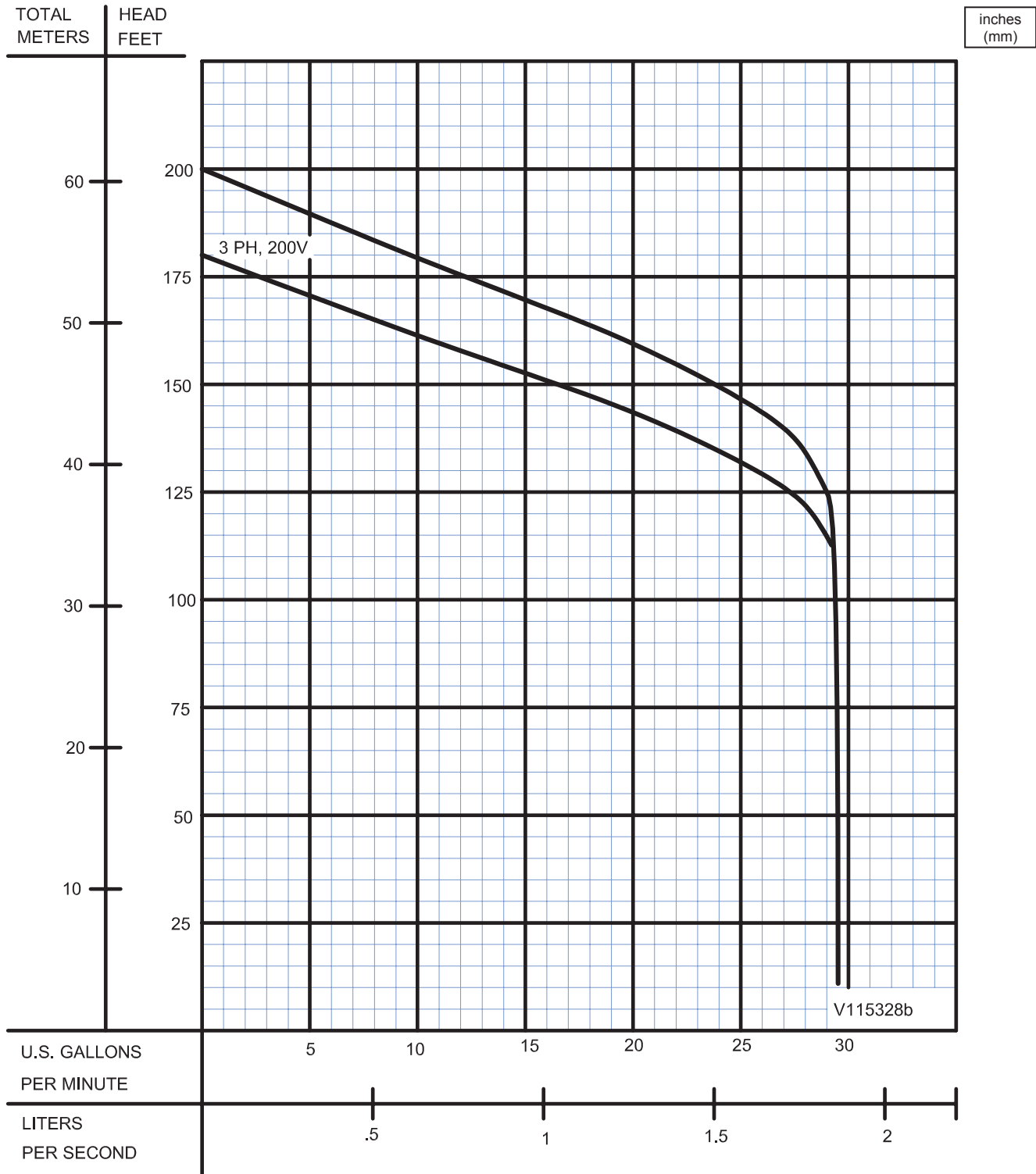

Testing is performed with water, specific gravity 1.0 @ 68° F @ (20°C), other fluids may vary performance

SECTION 3B
PAGE 22
DATE 3/13

CRANE®

A Crane Co. Company

PUMPS & SYSTEMS

USA: (937) 778-8947 • Canada: (905) 457-6223 • International: (937) 615-3598