

Tekno 25, Tekno 40
Kontur, Nexgen

Invisible

INSTALLATION INSTRUCTIONS

STEP 1 - Installing Supports

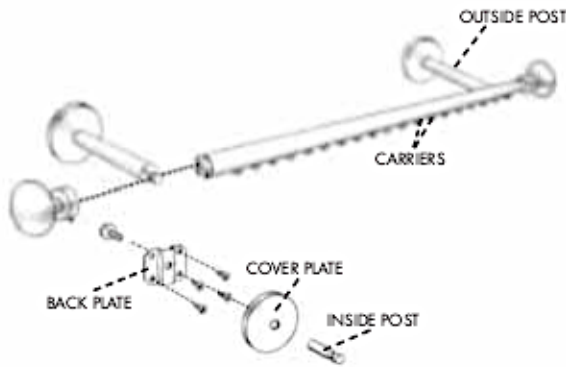

1. Install Back Plate to wall. Make sure all M-6 bolts are level. If you have a spliced track the Center Support must be installed at the position of splice.
2. Cover Back Plate with Cover Plate.
3. Screw on Inside Post very securely. Do not leave any play.

Note: The inside post is removed from the outside post by loosening the set screw on the outside post. Then proceed with screwing the inside post on the cover plate (M6) bolt.

Additional note for Step 3 on right side of this page: When sliding outside post into back channel of rail, it may be beneficial to have the set screw facing down when the post is in its final tightened position. This would only be necessary when installing close to the ceiling, making screwdriver access difficult.

STEP 2 - Splice track if necessary



1. Join the track sections together.
2. Tighten set screws.
3. Screw Center Support directly into center hole of Splice.

STEP 3 - Installing Outside Posts



1. Loosen all screws on Outside Posts.
2. Slide Outside Posts into back channel of Rail.
3. Align Outside Posts with Inside Posts from **Step 1**.

STEP 4 - Mount rail onto supports

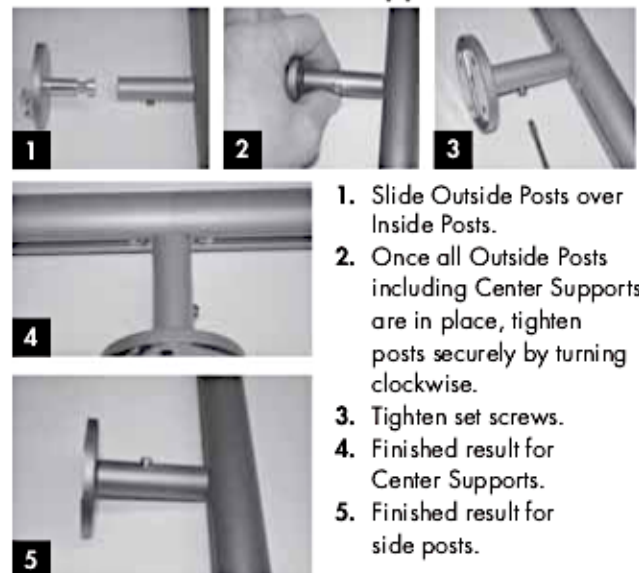

1. Slide Outside Posts over Inside Posts.
2. Once all Outside Posts including Center Supports are in place, tighten posts securely by turning clockwise.
3. Tighten set screws.
4. Finished result for Center Supports.
5. Finished result for side posts.