

KS Recess track installation:

A sheetrock channel 5/8" wide is created to insert the track. Wood blocking is installed flush with the ceiling joists. With sheetrock thicker than 1/2", do not overtighten the screws. Typical projection away from the wall is 3" for a single track; 2 1/2" and 6" for double tracks.

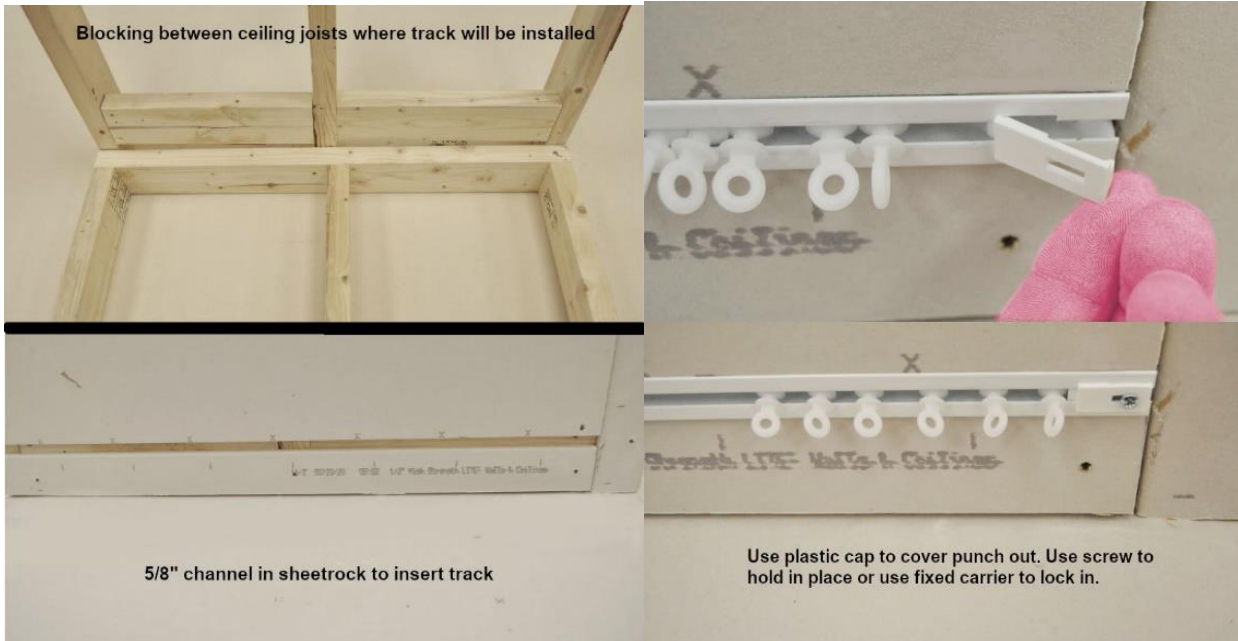

Screw the track approximately every 24". If a screw is needed where a hole is not pre-drilled, use the center indentation line on the track as a guide to drill a small pilot hole. Use trim head screws and take care not to score the channel. The flanges on the track will cover the edges of the sheetrock with no compound (mud) needed.



The square punched area on one end will allow slides to be added or removed. Cover with the plastic cap. Either screw the cap in place or use the fixed carrier to lock it in place.