



TUSHY

HOW TO PUT THIS SHIT TOGETHER

WARM & COOL BIDET

HELLOTUSHY.COM

HELLO@TUSHY.ME

INSTAGRAM / FB @HELLOTUSHY

Check out our installation video at

HELLOTUSHY.COM/WARMINSTALL

and some common setup hacks at

HELLOTUSHY.COM/HACKS

KNOW YOUR TUSHY

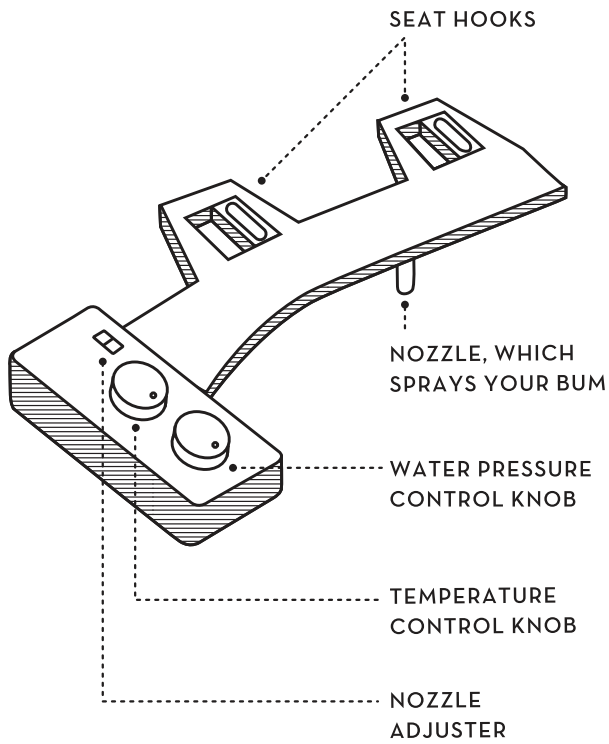

INCLUDED PARTS

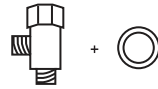

Mega Adapter + Rubber Washer



Mini Adapter + Rubber Washer



Flexible Hose (60cm)



Plastic Tube (300cm)



Teflon Tape

YOU MIGHT ALSO NEED



Wrench



Screwdriver

PREP WORK

1. WATER VALVES



Turn off the water valve near the toilet and the warm water supply under the sink in small increments to avoid damage, especially to older valves. There may be some mineral build up - slow and steady wins the race. Try twisting it in one direction and then the other, each time rotating a little further until it's free to turn all the way around.

2. TOILET TANK

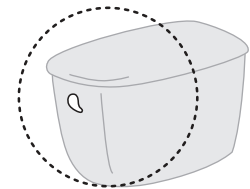

Flush your toilet to drain the tank completely. Hold down that flusher until it empties! (A couple inches of water is okay.)

3. TOILET SEAT

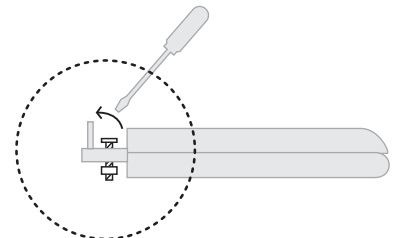

Flip up the screw caps behind the seat with a flat head screwdriver to access the screws. You may need to hold the bolt beneath the screw with your other hand while unscrewing. Remove the seat and set aside. Dealing with a unique toilet seat? Check out [HELLOTUSHY.COM/HACKS](https://www.hellotushy.com/hacks) for some tips.

4.

WARM WATER CONNECTION

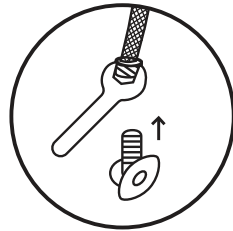

Disconnect the existing flexible steel hose from the warm water supply valve with a wrench. (If you have a hard metal pipe, visit [HELLOTUSHY.COM/PARTS](https://www.hellotushy.com/parts) to get a flexible hose.)

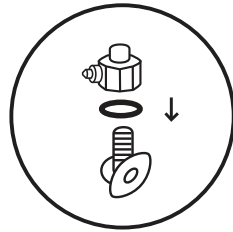

Place the rubber washer in the mini adapter. Fasten the mini-adapter to the warm water supply valve using your hand. Make sure it's tight, but don't go nuts.

Optional: Use teflon tape inside each connection. **

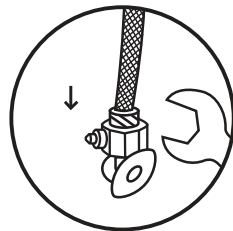

Reconnect the flexible steel hose to the other side of the mini adapter using a wrench.

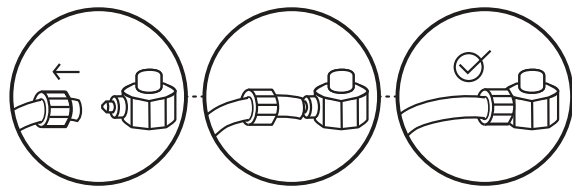

Unscrew the metal fastener from the mini adapter. Grab the plastic tube and thread one end of the tube through the fastener, then onto the mini adapter port and tighten the fastener to secure the connection. *

*

PSST!

Over-tightening the adapter can cause damage to the threads and result in water leakage, so use only hand pressure at first. Rotate less than a quarter turn at a time, checking as you go for leaks.

**

LEAKY JOINTS?

Plug these freaky leaky connections by wrapping teflon tape on the threading of the pipe clockwise while maintaining some tension on it. Leave some room so that there is no fraying of the tape when you are securing the adapters. [HELLOTUSHY.COM/TAPE](https://www.hellotushy.com/tape)

LEG ROOM FOR THE NOZZLE

Make sure that the bidet sits far enough from the rim of the toilet bowl so the nozzle has enough room to swing up and back. You can do by just playing with the nozzle adjuster on the bidet console.

6.

FINISHING UP

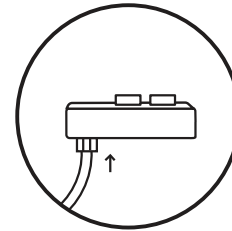

WARM WATER CONNECTION: Thread the other end of the plastic tube from the warm water connection through the plastic fastener and onto the labeled port under your TUSHY. Tighten the fastener.

COOL WATER CONNECTION: Connect the other end of the flexible hose from the cool water connection to the labeled port under your TUSHY.

Make sure all the connections are secure and turn on one water supply at a time. Use teflon tape if there are any leaks.

Now for the big moment ... place the TUSHY on top of your toilet and align the seat brackets with your toilet seat mounting holes. Make sure the nozzle is centered to your toilet bowl for that precise spray of water. Secure the toilet seat on top of the TUSHY by threading the toilet seat bolts through the seat fasteners and the mounting holes. ***

Now sit down, relax, doo your business. Use the temperature and pressure control knob & let the spray begin!

Email us your questions at SUPPORT@TUSHY.ME We've got your back!

5.

COOL WATER CONNECTION

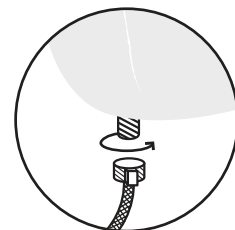

Disconnect the existing flexible hose from your toilet tank. To unscrew the connection, turn right. (If you have a hard pipe, visit [HELLOTUSHY.COM/PARTS](https://www.hellotushy.com/parts) to get a flexible hose.)

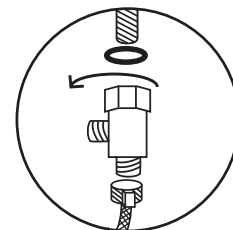

Place the rubber washer in the mega adapter. Screw the adapter onto the tank connection and then attach the flexible hose to the bottom of the adapter. Do not over tighten.

Optional: Use teflon tape inside each connection. **

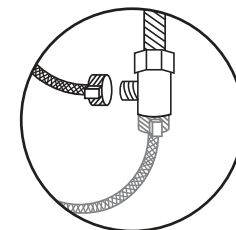

Attach the flexible hose to the mega adapter for connection to your TUSHY. Use a wrench to tighten it if necessary, but do not over tighten.

