

T.10.S.2"

INSTALLATION
AND OPERATION

TULGA

F I F T H W H E E L

Tulga Fifth Wheel Co

📍 127 E. Alton ave
Santa Ana, CA 92707

🌐 www.tulgafifthwheel.com

Any Problems ? Contact Us

✉ support@tulgafifthwheel.com

☎ Toll Free No: (888) 611 2366

TULGA

F I F T H W H E E L

T.10.S.2"



www.tulgafifthwheel.com



FIFTH WHEEL

INSTRUCTION MANUAL

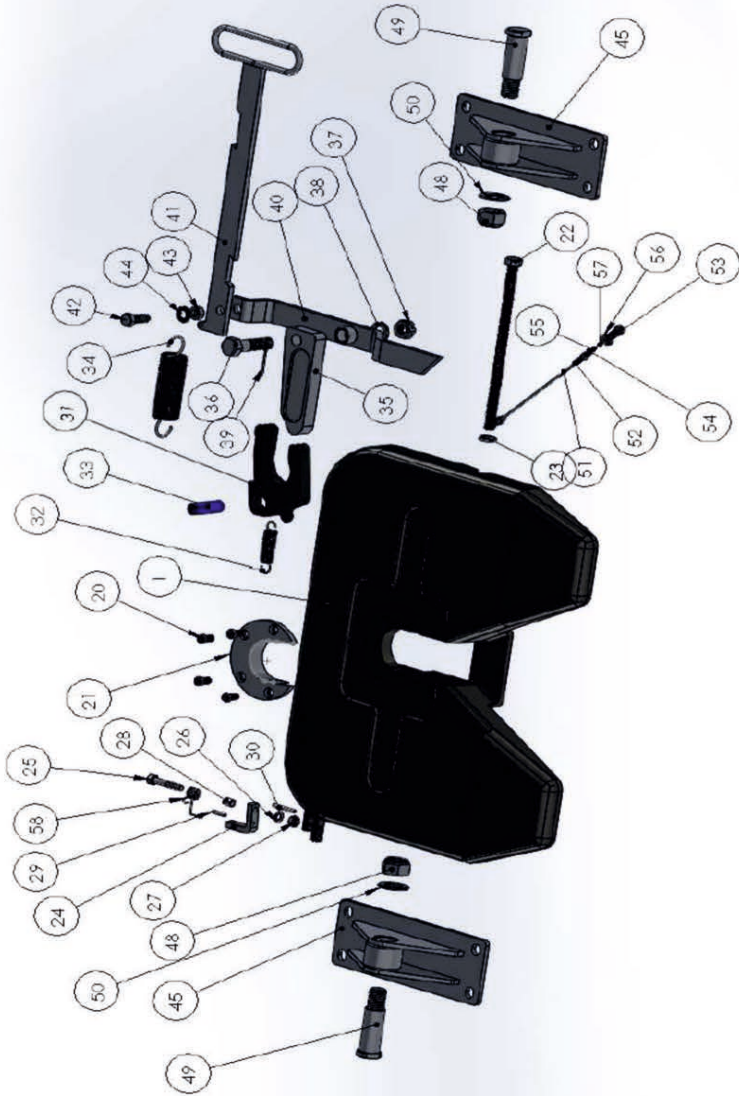

FIFTH WHEEL

A LIST OF MATERIALS

FIGURE	PART NO	TECHNICAL DRAWING	DESCRIPTION	UNIT
1	5002	TR.T10-5002-001	Plate	1
20	2501-1	TR.T10-2501-1-001	Socket head bolt	4
21	4025-B	TR.T10-4025-B-001	Wear Ring	1
22	5032	TR.T10-5032-001	Adjusting Screw	1
23	5032-1	TR.T10-5032-1-001	Hexagon Nut	1
24	2545-1	TR.T10-2545-1-001	Latch	1
25	2560-1	TR.T10-2560-1-001	M 10x60 Hexagon Bolt	1
26	2560-2	TR.T10-2560-2-001	M 10 Washer	1
27	2560-3	TR.T10-2560-3-001	M 10 Hexagon Nut	1
28	2570-1	TR.T10-2570-1-001	Latch Bush	1
29	2570-2	TR.T10-2570-2-001	Latch Spring	1
30	2570-3	TR.T10-2570-3-001	6x27 Slotted spring pins	1
31	2570-4	TR.T10-2570-4-001	6x27 Slotted spring pins	1
31	1023	TR.T10-1023-001	Lock Jaw	1
32	1030	TR.T10-1030-001	Tension Spring	1
33	1028	TR.T10-1028-001	Lock Jaw Pin	1
34	1013-2	TR.T10-1013-2-001	Tension Spring	1
35	5022	TR.T10-5022-001	Locking Bolt	1
36	5066-1	TR.T10-5066-1-001	M 20x80 Hexagon Bolt	1
37	5066-2	TR.T10-5066-2-001	M 20 Hexagon Nut	1
38	5066-3	TR.T10-5066-3-001	M 20 Washer	1
39	5066-4	TR.T10-5066-4-001	4x40 Cotter Pin	1
40	5004	TR.T10-5004-001	Lever	1
41	5106	TR.T10-5106-001	Handle	1
42	5010-1	TR.T10-5010-1-001	M 14x40 Hexagon Bolt	1
43	5010-2	TR.T10-5010-2-001	M 14 Hexagon Nut	1
44	5010-3	TR.T10-5010-3-001	M 14 Washer	1
45	5003	TR.T10-5003-001	Pedestal	2
48	5014-2	TR.T10-5014-2-001	M 27 Hexagon Nut	2
49	5014-1	TR.T10-5014-1-001	Spring Bolt	2
50	5014-3	TR.T10-5014-3-001	M 27 Washer	2
51	2504-1	TR.T10-2504-1-001	Lubrication Line	2
52	2504-2	TR.T10-2504-2-001	Lubrication Line 1. Adapter	4
53	2504-3	TR.T10-2504-3-001	Lubrication Line 2. Adapter	4
54	2504-4	TR.T10-2504-4-001	Lubrication Line 3. Adapter	2
55	2504-5	TR.T10-2504-5-001	Lubrication Line Conic Bush	4
56	2504-7	TR.T10-2504-7-001	M 12 Hexagon Nut	2
57	2506-6	TR.T10-2504-6-001	Lubrication Line Pin	4

1. OPENING THE FIFTH WHEEL COUPLING

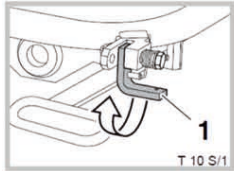

Lift the latch (1)

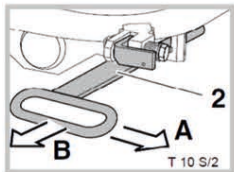

Swing the handle (2) towards the front into position **A** to release the lock.
Pull out the handle (2) as far as possible in to position **B**

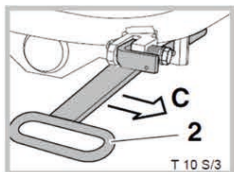

With handle (2) pulled out swing it forwards into position **C** and engage it on the edge of the plate

2. COUPLING UP A TRAILER

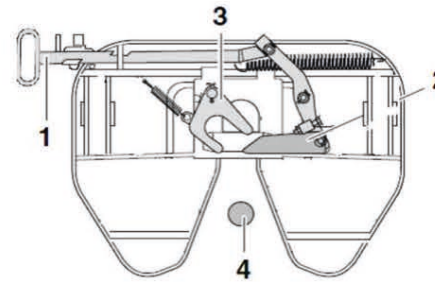

Şekil 1

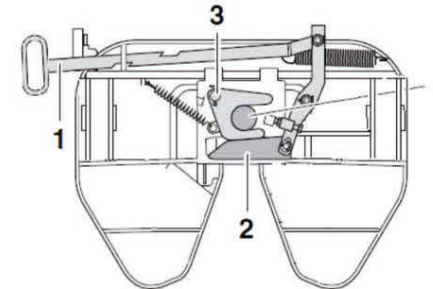

Şekil 2

- i. Secure the semi trailer to prevent it from rolling a way
- ii. The fifth wheel coupling must be ready to engage otherwise open the fifth wheel coupling
- iii. Check the height of the semi trailer the skid plate must ideally be at the same height as or no more than 50 mm lower than the coupling plate on the fifth wheel coupling
- iv. Drive the tractor unit under the semi trailer
- v. The locking mechanism will close automatically

3. CHECKING THE LOCKING MECHANISM

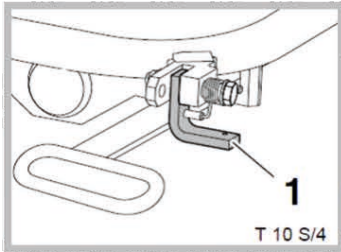

Latch (1) must be down as shown

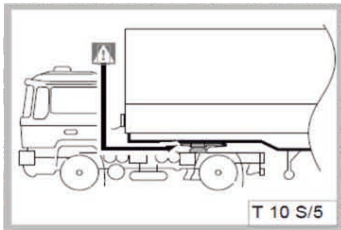

! The skid plate must rest on the fifth wheel coupling without a gap

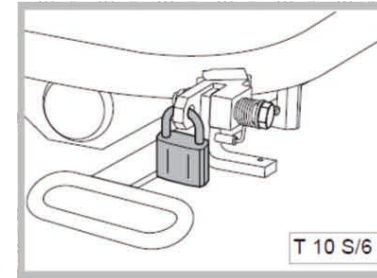

Note :to prevent the fifth wheel coupling being opened without authorisation , a security device (for example a padlock)can be inserted into the hole in the latch holder as shown

4. TEST INSTRUCTIONS

Depending on the conditions of use, but no later than every 50,000 km or every six months, the fifth wheel coupling, the mounting plate, the slider, the king pin and their fast ening elements should be checked for.

5. CHECKING FOR WEAR

Fifth wheel couplings and king pins are subject to more or less wear depending on the conditions in which they are used, and this wear is noticeable by play towards the front of the vehicle.

Excessive play causes shocks and may lead to instability on the road and damage to the fifth wheel coupling, mounting plate and vehicle chassis.

TULGA Fifth wheel couplings T 10 S offer the possibility of

6. INSTALLATION OF THE FIFTH WHEEL COUPLING ON THE MOUNTING PLATE

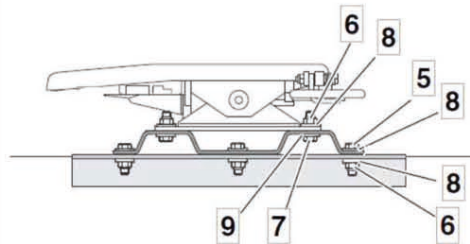
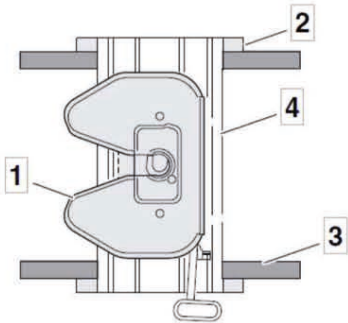

1-Fifth wheel coupling

2-Flitch

3-Vehicle chassis

4-Mounting Plate

5-Hexagon bolt (M 14-10.9 *8)

6-Hexagon nut M 14 10.9*8 / 7-Hexagon bolt (M 14-10.9 *8)

8-Washer 15 DIN 7349 mm thick

9-Optional Washer

Note: Alternatively, the mounting plate can also be attached to the tractor vehicle using M16 bolts.

7. FASTENING MATERIAL

7. STRENGTH CLASS 10.9

Hexagon bolt DIN EN ISO 4014/4017 (DIN 931/933) standard thread M16	260 Nm
Hexagon bolt DIN EN ISO 4014/4017 (DIN 931/933) standard thread M 14	170 Nm
Hexagon bolt DIN EN ISO 8765/8676 (DIN 960/961) fine thread M16 x 1.5	280 Nm
Hexagon bolt DIN EN ISO 8765/8676 (DIN 960/961) fine thread M14 x 1.5	180 Nm
Countersunk bolt DIN EN ISO 10642 (DIN 7991) M14 or M14 x 1.5	250 Nm
Countersunk bolt DIN EN ISO 10642 (DIN 7991) M14 or M14 x 1.5	145 Nm



FIFTH WHEEL

SETTING THE FUNCTION PLAY.

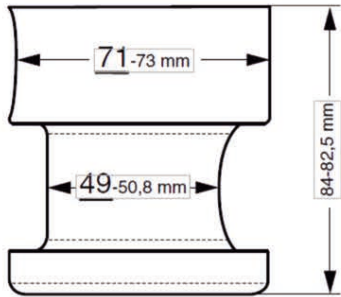

When the wear limit on the king pin has been reached, it must be replaced.
After the king pin has been replaced, the locking mechanism must be adjusted again.
Play caused by wear on the king pin should either be accepted if within the permitted wear limit for the king pin (see illustration) or should be rectified by fitting a new king pin.



FIFTH WHEEL