

PRO
MECH

S
N
I
C
T
I
O
N
S
T
R
U
C
T
I
O
N
S

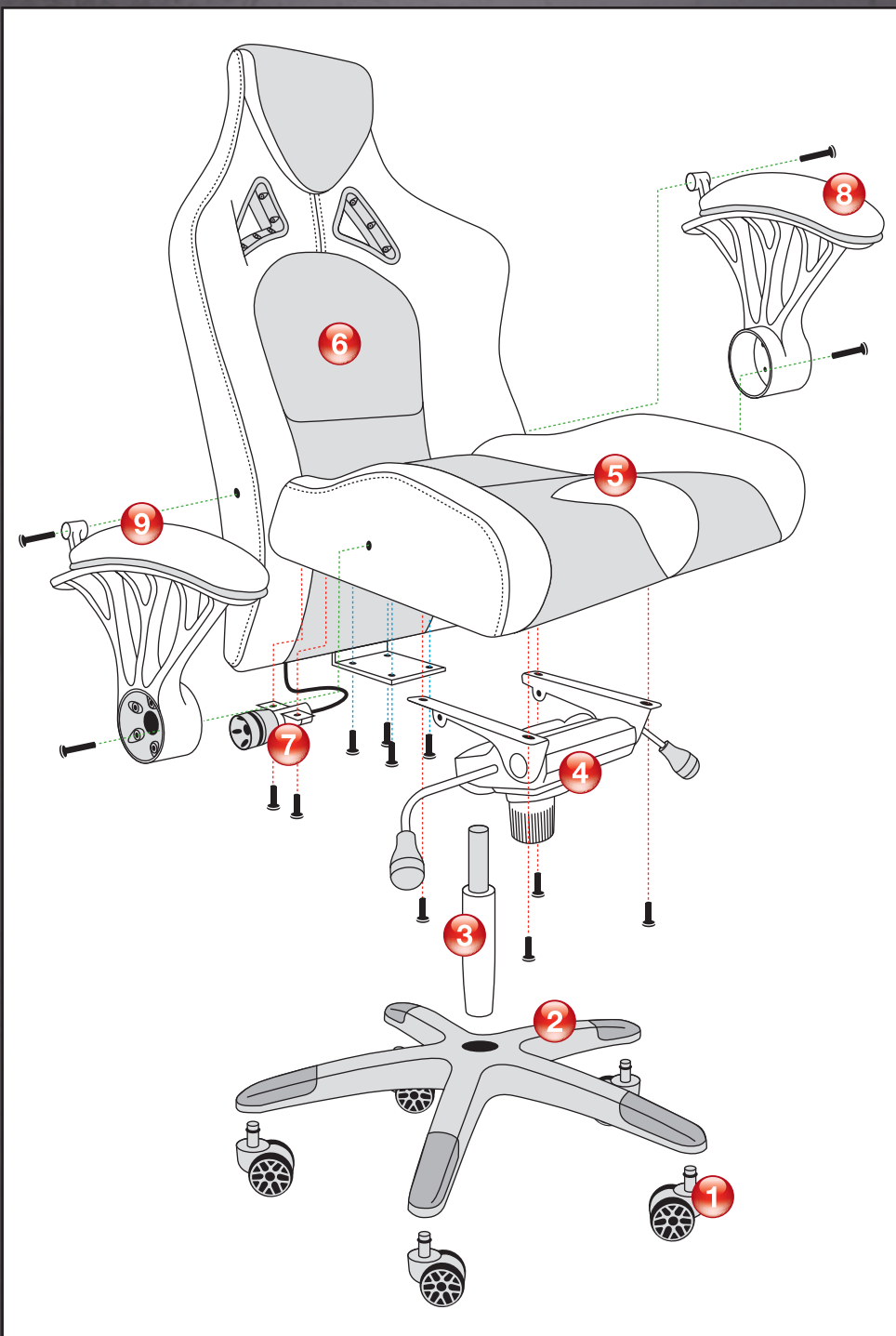

SPEED 998



ASSEMBLY

Carefully unpack all parts to identify each item against the parts list prior to assembly. Only fully tighten the bolts once the chair has been assembled.

1. Insert the casters (1) into the five-arm base (2).
2. Insert the gas lift (3) into the centre hole of the five-arm base (2).
3. Attach the fully adjustable seat mechanism (4) to the underside of the chair seat (5) using 4x socket cap bolts (10) M6 x 20mm.
4. Attach the lower bracket of the chair back (6) onto the rear of the chair seat (5) using 4x socket cap bolts (11) M8 x 20mm.
5. Secure the lumber control (7) onto the underside of the chair seat (5) using 2x socket cap bolts (10) M6 x 20mm.
6. Attach the left armrest (8) and right armrest (9) to the chair. Use 2x socket cap bolts (12) M8 x 55mm, to secure the arms to the chair seat. Use 2x socket cap bolts (13) M8 x 35mm, to secure the arms to the chair back. Locate both bolts first, then tighten alternately.
7. Insert the pre-assembled base unit (steps 1 & 2) into the seat mechanism (4) by pushing the gas lift shaft into the centre hole of the mechanism.
8. Once the chair is assembled fully tighten all socket cap bolts.

OPERATION

1. **Lumber Control:** Turn clockwise to increase or anti-clockwise to decrease the amount of lumber.
2. **Height Adjustment:** Pull the lever up to activate the height control. Sit on the seat when lowering the seat height and reduce the load on the seat when raising the seat height.
4. **Recline Tensioner:** Turn clockwise to increase or anti-clockwise to decrease the amount of recline resistance.
4. **Recline / Lock:** Push the lever downwards to prevent recline movement or lock the chair whilst in a recline position. Pull the lever upwards to release the lock, allowing recline movement.



PARTS LIST

Item	Description	Qty
1	Caster	5
2	Five-Arm Base	1
3	Gas Lift	1
4	Fully Adjustable Seat Mechanism	1
5	Chair Seat	1
6	Chair Back	1
7	Lumber Control (attached to item 6)	1
8	Left Armrest	1
9	Right Armrest	1
10	Socket Cap Bolt (M6 x 20mm)	6
11	Socket Cap Bolt (M8 x 20mm)	4
12	Socket Cap Bolt (M8 x 55mm)	2
13	Socket Cap Bolt (M8 x 35mm)	2



ATTENTION

Ensure all bolts are fully tightened before use.
Periodically inspect bolts and tighten if necessary.



RESISTANT

Filling material(s) and covering fabric(s) meet the requirements for resistance to cigarette and match ignition in the 1988 safety regulations

CARELESSNESS CAUSES FIRE



RESISTANT

FIRA

The ProMech SPEED 998 has been tested to:

BS EN 1335-1: 2000

Passing the determination of dimensions for a Type C office work chair.

PROMECH RACING

ANCHOR HOUSE, NETHERHAMPTON ROAD, SALISBURY, WILTSHIRE SP2 8RA

TEL: 01722 412233 FAX: 01722 412234

EMAIL: SALES@PROMECHRACING.COM

WWW.PROMECHRACING.COM