

Operation and Maintenance Manual

Salon Series



Congratulations!

You are moments away from fresher, cleaner indoor air. Your new AllerAir unit will combat many of the chemicals, gases, odors and particles responsible for poor indoor air quality (IAQ). Poor IAQ may cause or worsen allergies, asthma, multiple chemical sensitivities (MCS) and sick building syndrome. We recommend proper maintenance of your unit to keep it running efficiently for years to come.

Operation:

All units except D and DX models are shipped fully assembled and ready for use. (D and DX model owners may refer to their additional instruction sheet for filter installation, or refer to Page 3 of this booklet.)

Note:

As original packaging is required for warranty returns, new AllerAir owners are advised to keep boxes and shipping materials.

Model No. _____

Serial No. _____

WARNING!

- No user serviceable parts inside.
- Risk of fire, electric shock, or injury to persons through misuse.
- This is an electrical appliance. It is not intended for use by persons (including children) with reduced physical, sensory or mental capabilities, or lack of experience and knowledge, unless they have been given prior instructions concerning use of the appliance or they are being supervised by a person responsible for their safety.
- Children should be supervised to ensure that they do not play with the appliance.
- Do not operate any unit with a damaged cord or plug. Discard unit or return to AllerAir for examination and/or repair.
- Do not run cord under carpeting and do not cover it up in any way. Do not place cord under furniture or appliances. Arrange cord away from high-traffic areas and do not make it a tripping hazard.
- Refrain from poking or sticking any object into the unit's air vent discharge.
- Do not use any parts, attachments or filters not recommended by AllerAir.

The Salon Series is equipped with a 3 feet Loc-Line Modular hose.

Installing the Modular Hose

Push modular hose into adaptor at riser firmly until you hear a light "click"

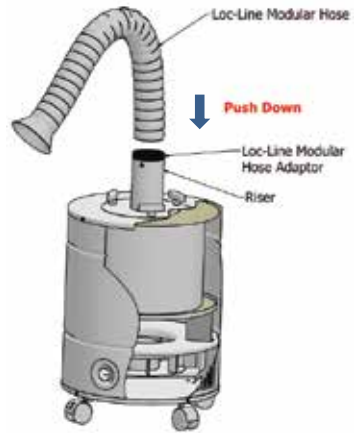

WARNING!

- Do not pull/push the unit by the Loc-Line modular hose.

REPLACING OR CLEANING THE PRE-FILTER

We recommend changing or cleaning pre-filters every one to two months.

STEP 1
Turn the unit off, unplug it, and using a #2 Philips screwdriver, remove the four screws that hold the top onto the unit.

STEP 2
Grasp the top. Remove by pulling gently up. Slowly remove the dirty pre-filter to avoid dispersing its contents.
To clean: Carefully vacuum both sides of the filter.
To discard: Gently insert into a plastic bag and discard.

STEP 3
To install: Gently press the pre-filter flat against the inner walls of the innermost filter. Replace the top, making sure the arrow on the gold sticker lines up with unit's rear seam. Replace the four screws.

PRE-FILTER ORDER REFERENCE NUMBERS*

To order a new pre-filter, call AllerAir toll-free at 1-888-852-8247 during regular business hours (EST), or send an e-mail to info@allerair.com

Models	Prefilters		Salon 5000	Salon 6000	Notes
Exec, Vocarb	Poly Prefilters		A5FMP009	A6FMP012	packs of 4 or 8

*Please use the above part numbers when ordering your replacement parts.

FILTER ASSEMBLY D, DS and DX

The model you have selected is shipped in 2 separate boxes to protect certain components. The filter comes in one box, and the outer shell of the unit, containing the motor and the fan, comes in another. Filters must be installed before turning the unit on in order for it to work. AllerAir technicians recommend removing the base, installing the filter, and replacing the base according to steps 1 - 4 and 12 - 16 of the following procedure.

REPLACING superHEPA and/or CARBON FILTERS

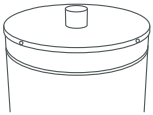

STEP 1

Make sure the unit is set to "Off" and the unit is unplugged.

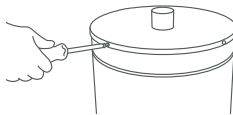

STEP 2

Using a #2 Phillips screwdriver, remove the four screws that hold the top onto the unit.

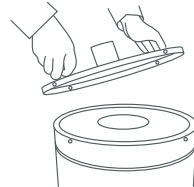

STEP 3

Grasp the top. Remove by pulling gently up.



STEP 4

Reach inside the unit, and remove felt pad.

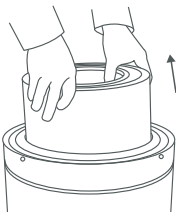

STEP 5

Remove the carbon filter along with the 0.1 micron superHEPA filter. (pull up gently by placing thumbs on the inner side of the filter)



STEP 6

Remove the used 0.1 micron superHEPA filter.



STEP 7

Replace with a new 0.1 micron superHEPA.



STEP 8

Position metal bar on the edge of overlap after wrapping the superHEPA around the outside of the carbon canister.



STEP 9

Place "hook" side of the velcro strap on the inside and start wrapping the strap around the edge of the filter.



STEP 10

While wrapping the strap around the filter make sure to exert a reasonable amount of tension on the strap so it is not loose once the loop is complete.



STEP 11

Procedure ended successfully - metal angle exerts pressure on the edge of the superHEPA. Straps keep the material in contact with filter's edges.

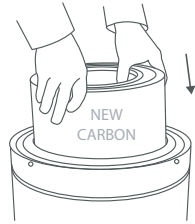

STEP 12

Gently insert the new carbon filter into the unit, either end up. See page 6 for instructions on replacing carbon filling.



STEP 13

Put back the felt pad removed in STEP 4.

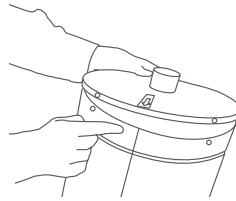

STEP 14

Replace the base, making sure the arrow on the gold sticker lines up with unit's rear seam.

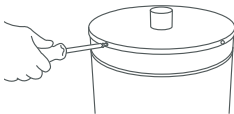

STEP 15

Replace the four screws.



STEP 16

Turn the unit back onto its wheels. It is now ready for use.

HEPA & CARBON FILTERS ORDER GUIDE

- These replacement filters will extend the life of your AllerAir unit. Please be sure to follow the instructions for changing the filters in your unit.
- We recommend changing pre-filters every two months, HEPA filters every three to five years, and carbon filters every two years.

ORDER REFERENCE NUMBERS

Please use the numbers in the following charts when placing your order. Call AllerAir at 1-888-852-8247 during regular business hours (EST) or send an e-mail to info@allerair.com.

Please use the following part numbers when ordering your replacement parts.

This is the filter that wraps around any carbon filter.

Microparticulate superHEPA Filter Order Guide

Models	AirMedic Pro 4	AirMedic Pro 5	AirMedic Pro 6
Exec, Vocarb	A4FSH642	A5FSH942	A6FSH1242
D Models	A4FSH645	A5FSH945	A6FSH1245
DX Models	A4FSH648	A5FSH948	A6FSH1248

Replacement Carbon Filter Order Guide

Please use the following part numbers when ordering your replacement parts.

If you have ordered a special blend of carbon in the past please let us know about it when ordering the replacement.

**Please refer to your carbon filter depth when ordering a replacement.

Models		Salon 5000	Salon 6000
Exec Models 2 ^{**}		A5FCW320	A6FCW320
Exec Models 2.5 ^{**}		A5FCW325	A6FCW325
Vocarb Models 2 ^{**}		A5FCW220	A6FCW225
Vocarb Models 2.5 ^{**}		A5FCW225	A6FCW225
D Exec Models 3"		A5FCW330	A6FCW330
D Vocarb Models 3"		A5FCW230	A6FCW230
DX Exec Models 3.5"		A5FCW230	A6FCW335
DX Vocarb Models 3.5"		A5FCW235	A6FCW235
DS Models 3"		A5FCW630	A5FCW630
MCS Models 2"		A5FCW120	A6FCW120
DXS 3.5"		A5FCW635	A6FCW635

REFILLING THE CARBON CANISTER

▪ Your AllerAir unit contains a refillable carbon filter. You may choose to refill it* or simply purchase a new filter. **Tools Required:** Philips screwdriver, garbage bag large enough to hold all of the old carbon, rubber mallet.

*When changing the carbon filter, it should be placed on a newspaper or protective surface as it may leak some carbon particles.

▪ AllerAir makes a special funnel to evenly refill carbon filters. Call 1-888-852-8247 during regular business hours (EST) or send an e-mail to info@allerair.com.



STEP 1

Remove the carbon filter from the unit by pressing thumbs against the inner rim and pulling up.

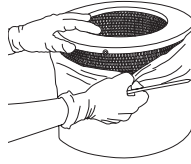

STEP 2

Gently pull back the pre-filter to access the four screws at the top of the filter. Remove the screws with a Philips screwdriver and take off the lid of the filter.

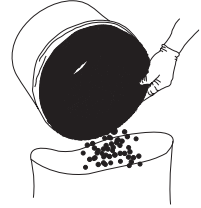

STEP 3

Discard all of the old carbon. Pour it into a garbage bag of adequate size and tie the bag shut.

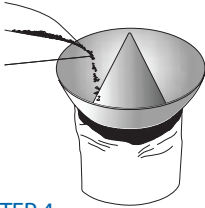

STEP 4

Pour in the new carbon, using a funnel if desired. As you pour, tap the sides of the filter with the rubber mallet to help settle the carbon granules.

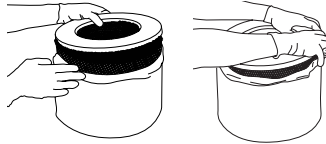

STEP 5

When the filter is full, replace the lid and its screws. Adjust the pre-filter, and gently slide the filter back into the unit.

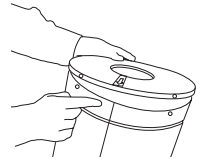

STEP 6

Replace the felt gasket. Replace the top of the unit. Align the arrow on the gold sticker with the unit's seam, and replace the four screws with a Philips screwdriver.

Empty Carbon Canisters Order Guide

Models		Salon 5000	Salon 6000	Notes
2" Canister**		A5FC0500	A6FC0500	Exec & Vocarb; MCS models
2.5" Canister**		A5FC1500	A6FC1500	Exec & Vocarb models
D Models		A5FC2500	A6FC2500	-
DX Models		A5FC3500	A6FC3500	-

Please use these part numbers when ordering your replacement parts.

**Please refer to your carbon filter depth when ordering a replacement.

Bulk Carbon Order Guide

Models		Salon 5000	Salon 6000
Exec Mix		AM000911	AM000911
Vocarb Mix		AM000912	AM000912
Tobacco Smoke Mix		AM000912	AM000912
MCS Mix		AM000901	AM000901
Special Blend Mix	Please Call		

Please use these part numbers when ordering your replacement parts.

REPLACING UV BULB AND BALLAST

WARNING!

ALWAYS UNPLUG UNIT FROM POWER SOURCE BEFORE PERFORMING ANY MAINTENANCE.

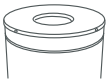
**STEP 1**

Turn the unit "Off" and unplug it.

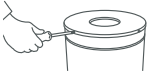
**STEP 2**

Using a #2 Philips screwdriver, remove the four screws that hold the top onto the unit.

**STEP 3**

Gently grasp the top, and remove the lid by pulling gently.

**STEP 4**

Remove the felt pad.

**STEP 5**

Remove the filter(s) according to the indicated directions.

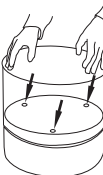
**STEP 6**

Remove the three screws in the filter end plate, and remove the end plate.

7A

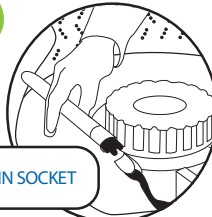

4 PIN SOCKET

7B

WING NUT

**STEP 7**

For a 10-watt bulb:

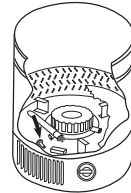

- Unplug the four-pin socket from the bulb.
- Loosen the wing nut that holds the bulb in place.
- Carefully remove the bulb.

7A

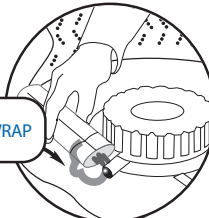

NYLON WRAP

7B

4 PIN SOCKET

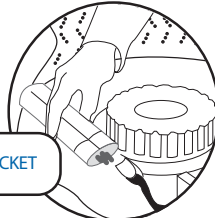
**STEP 7**

For a 20-watt bulb:

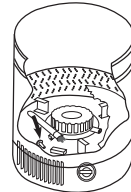

- Carefully cut the band of nylon that holds the UV bulb in place (for shipping purpose only).
- Unplug the four-pin socket.
- Carefully remove the bulb.

STEP 8

Place the new bulb in the holder. Make sure it is horizontal. Make sure it is not touching any of the other components.

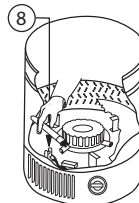
**STEP 9**

Replace the four-pin socket.

STEP 10

Replace the filter end plate. Replace the screws, filter(s) and top with the 4 screws.

IMPORTANT!

UV SYSTEMS NOT AVAILABLE IN CALIFORNIA.

TEN YEAR LIMITED WARRANTY

Your AllerAir unit comes with a 10-year limited warranty excluding expendable parts such as pre-filters and filters. This warranty provides for the repair of any defective components and labor for 5 years from the date of delivery. An additional 5-year warranty is provided on parts. This product is not covered against damage resulting from misuse. This warranty does not cover damage, fault or failure due to alteration or repairs made by anyone other than AllerAir or the use of supplies and accessories other than those manufactured by AllerAir. This warranty is provided to the original purchaser and may not be transferred. A return authorization number is required for warranty repairs. Please contact AllerAir at 1-888-852-8247 for more information.

THE ALLERAIR AIR FILTRATION SYSTEM

ACTIVATED CARBON

Your AllerAir air purifier contains activated carbon that permanently traps dangerous airborne chemicals, gases and odors. This vital filter should be changed approximately every two to three years, depending on the environment in which the unit is operating. You can also upgrade your Exec, Vocarb or D unit at any time to accommodate a larger and deeper carbon filter suitable for removing heavier concentrations of chemicals, gases and odors.

PRE-FILTER

The pre-filter included with your unit removes larger particles and helps prolong the life of your HEPA filter. The pre-filter should be vacuumed or replaced every three months.

SUPER-HEPA*

HEPA filters are widely recommended by allergists, doctors and indoor air quality experts for home and office use. The robust and flexible Super-HEPA in AllerAir units traps 99.9% of fine particles at 0.1 microns in size, including dust, hair, pollen and even some bacteria and viruses. Depending on the particle level in the environment in which the unit is used, your HEPA filter should be replaced every three to five years.

*Note that a pleated HEPA filter is also available. Contact AllerAir or check our website for more information.

THE ALLERAIR ADVANTAGE

- Our units offer complete air filtration removing airborne chemicals, gases, odors and particles.
- Our deep bed, activated carbon filters last longer than the average thin filter which is generally carbon sprayed onto a synthetic material.
- Our units do not use dangerous ozone technology
- Our units are manufactured to clean your air and therefore are not made with a plastic housing, or other materials which may off-gas chemicals.
- Our units are powered by American-made motors that are energy efficient and cost only pennies a day to operate.

IMPORTANT NOTICE!

PLANNING ON PAINTING YOUR HOME? READ THIS FIRST:

Particles from paint may clog your HEPA filter, therefore we recommended that users unplug their units and remove the HEPA filter, storing it off-site until the paint job is complete. Due to the serious toxic nature of paint it is also recommended that your carbon filter be replaced or refilled in the weeks after the paint job is complete. See, Replacing HEPA and/or carbon filters, for instructions on how.

