



Kit Contents			
Description	Part No	Used on model	Pcs
1 Sleeve	24638-01	987 Only	2
2 ABS cord bracket	25619-01	986 and 987	2
3 Shock absorber	POU 5U40 U01	986 and 987	2
4 Dust boot	10216-01	986 and 987	2
5 Helper spring and adapter kit	U00159-49	986 and 987	2
6 Main spring	U00159-51	986 and 987	2
7 Plastic spring spacer	25602-01	986 and 987	2
8 Upper spring perch	24637-02	986 and 987	2
9 Front strut mount	U00204-01	986 and 987	2
10 Lock nut M14	24627-04	986 and 987	2
11 C-spanner	24639-03	986 and 987	1
12 C-spanner	24639-01	986 and 987	1
13 Öhlins sticker	10207-01	986 and 987	1
14 Öhlins emblem kit	10207-02	986 and 987	1
15 Öhlins Owner's Manual		986 and 987	1

⚠ Warning!

For off-road use only. Dedicated kits have been designed specifically for track use and should never be used on the streets.

👁 Note!

Please note that during storage and transport, especially at high ambient temperature, some of the oil and grease used for assembly may leak and stain the packaging. This will not cause damage to the product, wipe off the excessive oil or grease with a cloth.

👁 Note!

Please note that there can be small differences between your product and the images in these instructions.

👁 Note!

Before you install this product, check the kit contents. If anything is missing, please contact an Öhlins dealer.

⚠ Warning!

Before you install this product, read the Öhlins Owner's manual. This product is an important part of the vehicle and the vehicle stability.

Shock absorber Kit for Porsche 986 and 987 Boxster/Cayman

POU MU50S1 front

Mounting Instructions



MOUNTING INSTRUCTIONS

⚠ Warning!

We strongly recommend to let an Öhlins dealer install this product.

⚠ Warning!

If you work with a lifted vehicle, make sure that it is safely supported to prevent it from tipping over.

👁 Note!

When you work with this product, see the vehicle service manual for vehicle specific procedures and important data.

👁 Note!

Before you install this product clean the vehicle.

1

Raise the vehicle and put it on jack stands.

2

Remove the front wheels.

3

Loosen the bolts for the lower strut attachments.

👉 Caution!

Support the wheel hubs in an appropriate way on each side of the vehicle so that the brake hoses can not be damaged.

4

Loosen the upper attachments. Remove the original struts from the car.

5

Cut the dust boot 62 mm from the lower end with a pair of scissors according to fig 2.

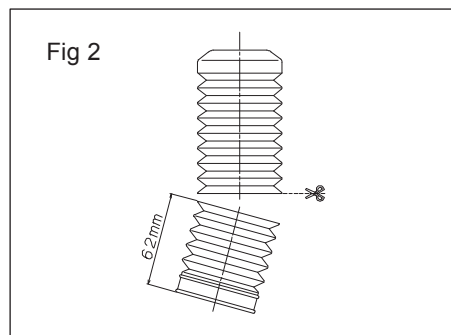
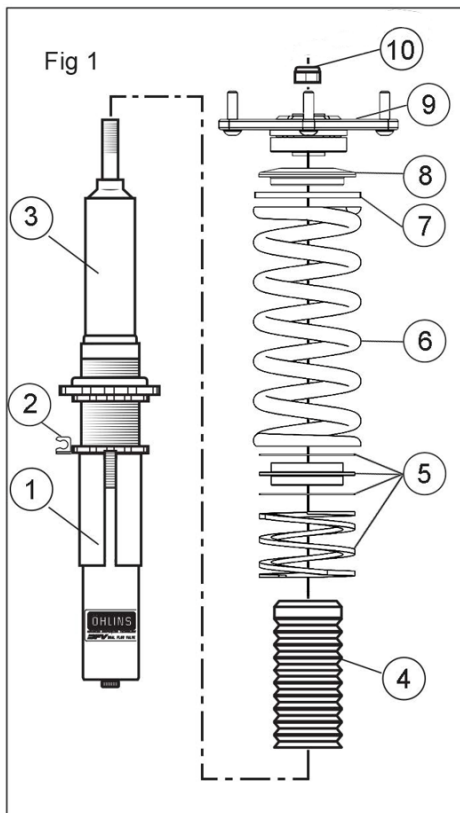

MOUNTING INSTRUCTIONS

6

Fit the sleeve (1)(987 only), ABS cord bracket (2) the dust boot (4), the helper spring with spring adapter kit (5), the main spring (6), the plastic spacer (7), the upper spring seat (8), the Strut mount (9) and the M14 lock nut (10) to the strut according to fig 1. Tighten the lock nut to 35 - 40 Nm. Adjust the spring seat and the lock ring according to fig 4 and tighten to 50 -60 Nm.

Note!

When tightening the top mount nut, the shock absorber shaft must be held in position with an Allen key.

7

Fasten the upper attachments to the vehicle.

8

Raise the wheel hub with a jack to remove the freeplay of the lower strut attachment bolts before tightening them.

Note!

Make sure that all bolts are tightened to the correct torque and that nothing fouls or restricts movement of the strut when it is being fully compressed or extended. Test this over the whole steering range from lock to lock.

9

Adjust the height adjuster lock ring according to fig 4 and tighten to 40 - 50 Nm.

10

Make sure that all removed parts are reinstalled in the same way as they were before the installation of the Öhlins shock absorber.

Note!

If the vehicle is equipped with OEM PASM shock absorbers, use Öhlins cancellation kit.

Fig 3

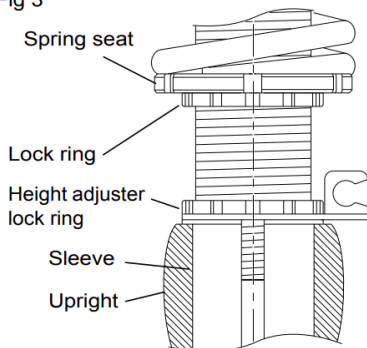

ADJUSTMENTS

⚠ Warning!

Before you ride/drive, always make sure that the setup is according to the recommended setup data. Read about adjustments and setting up in the Öhlins Owner's Manual before you make any adjustments. Contact an Öhlins dealer if you have any questions about setting up.

SETUP DATA

Recommended set-up

Rebound setting

Track	5	clicks
-------	---	--------

Spring assembly preload length	186	mm
--------------------------------	-----	----

Height adjuster location(986/987)	75	mm
-----------------------------------	----	----

(Start here and adjust to suit ride height preference)

Spring

Main Spec H152, ID65	110	N/mm
----------------------	-----	------

Helper Spec H135, ID65	0.8	N/mm
------------------------	-----	------

The actual vehicle height

With both the preload and height adjustments in their standard positions, the vehicle is lowered approximately 25 mm when compared to the original suspension. As the height adjuster is turned one rotation, the position moves 1.5 mm.

Fig 4

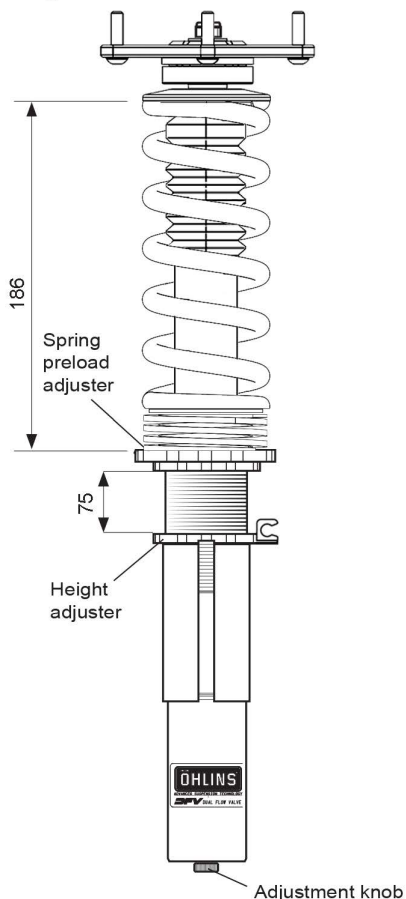

Öhlins products are subject to continuous improvement and development, therefore, although these instructions include the most up-to-date information available at the time of printing, minor updates may occur.

To find the latest information contact an Öhlins distributor. Please contact Öhlins if you have any questions regarding the contents in this document.

Part no. U00250-06_2
Issued 2022-06-29

© Öhlins Racing AB. All rights reserved. Any reprinting or unauthorized use without the written permission of Öhlins Racing AB is prohibited.

Öhlins USA
703 South Grove St
Hendersonville NC, 28792

Phone 1-800-336-9029
fax 828-692-0595



www.ohlinsusa.com



Kit Contents

Description	Part No	Used on model	Pcs
1 Sleeve	24638-06	987 only	2
2 ABS cord bracket	25619-01	986 only	2
3 Shock absorber	POU 6U40 U01	986 and 987	2
4 Dust boot	10216-01	986 and 987	2
5 Helper spring and adapter kit	U00159-49	986 and 987	2
6 Main spring	U00159-58	986 and 987	2
7 Plastic spring spacer	25602-01	986 and 987	2
8 Rear shock mount	U00211-01	986 and 987	2
9 Lock nut M14	24627-04	986 and 987	2
10 Brake pad cable bracket	25619-02	986 only	2

⚠ Warning!

For off-road use only. Dedicated kits have been designed specifically for track use and should never be used on the streets.

👁 Note!

Please note that during storage and transport, especially at high ambient temperature, some of the oil and grease used for assembly may leak and stain the packaging. This will not cause damage to the product, wipe off the excessive oil or grease with a cloth.

👁 Note!

Please note that there can be small differences between your product and the images in these instructions.

👁 Note!

Before you install this product, check the kit contents. If anything is missing, please contact an Öhlins dealer.

⚠ Warning!

Before you install this product, read the Öhlins Owner's manual. This product is an important part of the vehicle and the vehicle stability.

Shock absorber Kit for Porsche 986 and 987 Boxster/Cayman

POU MU50S1 rear

Mounting Instructions



MOUNTING INSTRUCTIONS

⚠ Warning!

We strongly recommend to let an Öhlins dealer install this product.

⚠ Warning!

If you work with a lifted vehicle, make sure that it is safely supported to prevent it from tipping over.

👁 Note!

When you work with this product, see the vehicle service manual for vehicle specific procedures and important data.

👁 Note!

Before you install this product clean the vehicle.

1

Raise the vehicle and put it on jack stands.

⚠ Warning!

Ensure that it is securely supported.

2

Remove the rear wheels.

3

Remove the interior in the rear compartment to access the top mount nuts.

4

Remove the lower and the upper attachments and remove the original shock absorbers.

5

Cut the dust boot 62 mm from the lower end with a pair of scissors according to fig 2.

6

Fit the sleeve (1)(987 only), ABS cord bracket (2)(986 only), the dust boot (4), the helper spring with spring adapter (5), the main spring (6), the plastic spacer (7), the strut mount (8) and the M14 lock nut (9) to the strut according to fig 1. Adjust the spring seat and lock ring according to fig 5 and tighten to 50 - 60 Nm.

👉 Caution!

When tightening the top mount nut, the shock absorber shaft must be held in position with an Allen key.

Fig 1

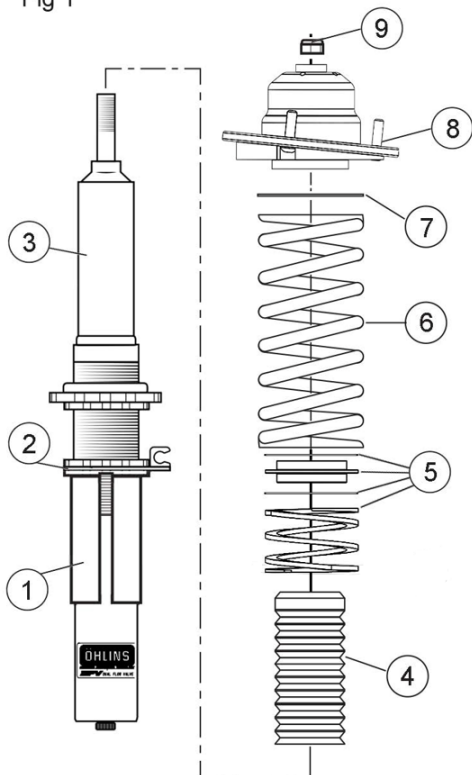
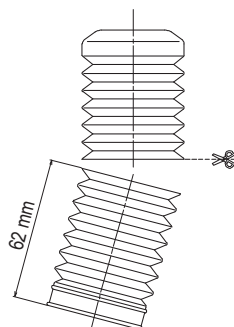

Fig 2



MOUNTING INSTRUCTIONS

7

Install the Öhlins shock absorbers on the vehicle and fasten the upper attachments.

8

Raise the wheel hub with a jack to remove the freeplay of the lower strut attachment bolts before tightening them. Make sure to install the Brake pad cable bracket at this time (986 models only)

9

Make sure that all removed parts are reinstalled in the same way as they were before the installation of the Öhlins shock absorber.

Note!

Make sure that all bolts are tightened to the correct torque and that nothing fouls or restricts movement of the shock absorber when it is being fully compressed or extended.

10

Tighten the height adjuster lock ring to 40 - 50 Nm according to fig 5.

Note!

If the vehicle is equipped with OEM PASM shock absorbers, use Öhlins cancellation kit.

Fig 3

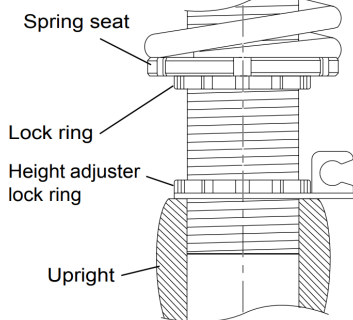
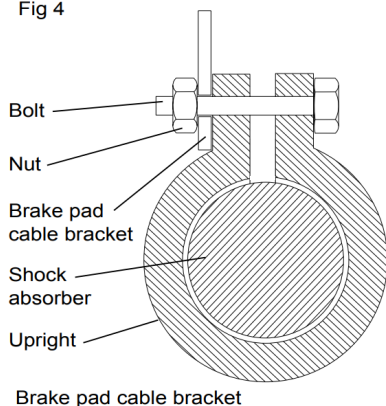

Fig 4



Brake pad cable bracket



⚠ Warning!

Before you ride/drive, always make sure that the setup is according to the recommended setup data. Read about adjustments and setting up in the Öhlins Owner's Manual before you make any adjustments. Contact an Öhlins dealer if you have any questions about setting up.

SETUP DATA

Recommended set-up

Rebound setting

Track	4	clicks
-------	---	--------

Spring assembly preload length	187	mm
--------------------------------	-----	----

Height adjuster location (986/987)	115	mm
------------------------------------	-----	----

(Start here and adjust to suit ride height preference)

Spring

Main Spec H152, ID65	130	N/mm
----------------------	-----	------

Helper Spec H135, ID65	0.8	N/mm
------------------------	-----	------

The actual vehicle height

With both the preload and height adjustments in their standard positions, the vehicle is lowered approximately 25 mm when compared to the original suspension. As the height adjuster is turned one rotation, the position moves 1.5 mm.

👁 Note!

Confirm there is clearance between strut and axle

Fig 5

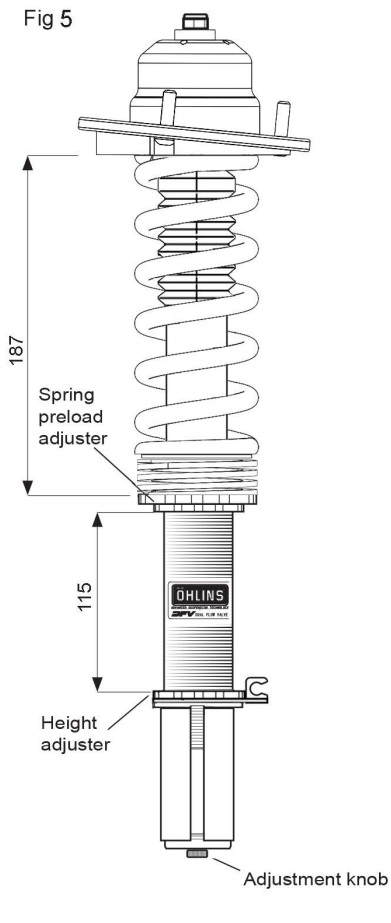

Öhlins products are subject to continuous improvement and development, therefore, although these instructions include the most up-to-date information available at the time of printing, minor updates may occur.

To find the latest information contact an Öhlins distributor. Please contact Öhlins if you have any questions regarding the contents in this document.

Part no. U00250-06_2
Issued 2022-06-29

© Öhlins Racing AB. All rights reserved. Any reprinting or unauthorized use without the written permission of Öhlins Racing AB is prohibited.

Öhlins USA
703 South Grove St
Hendersonville NC, 28792

Phone 1-800-336-9029
fax 828-692-0595

