

WV
SERIES



B
SERIES

OWNER'S MANUAL

Thank you for purchasing Westone Earphones.

**Please read the following instructions
to guarantee a lifetime of listening pleasure.**

Please register your product to receive information on new product releases, promotions, and all of the latest updates from Westone Audio.

Register at: www.westone.com/productregistration

Eartips

Westone includes two complete sets (10 pair) of eartips with all Universal Earphones.

Choose from the easy insertion of a silicone Star-Tip™, or from the maximum attenuation (noise reduction) provided by a True-Fit™ foam eartip. It is very important that you take a few moments to experiment with the different sizes and types of eartips provided, to find the one that fits the best.

Note: It is essential to find the right size eartip, as the transmission of low-frequency information is seal dependent.

***Please Note:** It is advisable to change the foam True-Fit eartips when they become soiled. Dirt, dust, dried skin, body oil, ear wax, and other foreign materials may become attached to the eartips. To prevent this and extend the life of the foam eartips (they should occasionally be replaced), please wipe them down with a clean tissue or dry cloth after each use. If using the silicone STAR-Tips occasionally remove them from the earphones and wash them in warm soapy water. It is very important that they are completely dry before reinstalling them on the earphones.*

Insertion Instructions

Before inserting the earphone, turn down the volume on your sound source and either drape the cord over your shoulders and down your back, or run the cord down in front. The earphones are marked (R) and (L); (R) for the right ear, (L) for the left. If you have selected a True-Fit™ foam eartip, compress the foam by rolling it between your fingers (fig. 1). If using a silicone STAR™ tip, the instructions are the same except that there is no need to compress the tips. With the body of the earphone toward the back of your ear and the cord facing forward, insert the eartip into your ear canal before the foam expands back to its original shape (fig.2). If you have trouble inserting the earphone reach over your head with your opposite hand and gently pull up and back on the top of your ear before inserting the eartip. This helps straighten your ear canal and may allow for easier insertion. The earphone cord should run over and behind your ear. Hold the earphone in place for 5 to 10 seconds to allow the foam to expand and conform to the shape of your ear canal (fig. 3).

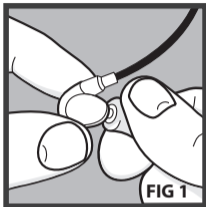

IDENTIFY EARPIECES

marked (R) for right
and (L) for left

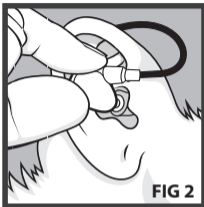

ALIGN EARPIECES

at the ear canal, with cord
facing forward & slightly
downward

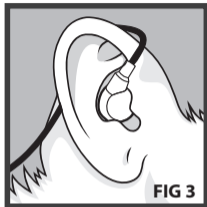

INSERT EARTIP

into ear canal and rotate
earpiece backwards &
into position

Once the earphones and cords are comfortably in place, slide the cable zipper on the cable up to the base of your skull (not too snugly, as this may cause discomfort). This will limit cable movement and help ensure that your earphones stay in place during use.

Cable Removal

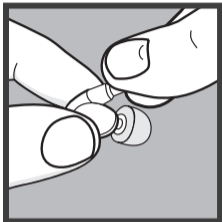

HOLD

the earphone and cable firmly
with each hand

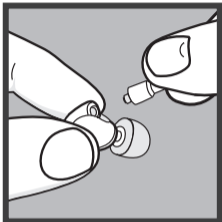

REMOVE

the cable by holding close to the
connection and pulling at a straight
angle from the socket
Do not pull from the wire!

Cable Replacement

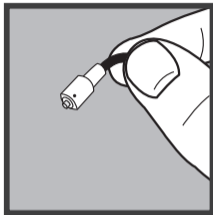

CHECK

if the cable is for the left
(blue) or right (red) earphone



MATCH

the cable to the
appropriate earphone

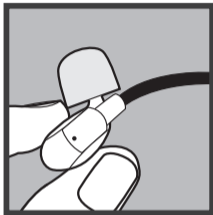

INSERT

the cable into the earphone
by pushing directly into the
socket



How to Get the Most from Your Earphones

- 1.) Please avoid shock damage/strong impacts to the earphones, as this can affect the performance of the balanced armature drivers.
- 2.) Do not immerse earphones into water or liquids of any kind. This could temporarily or permanently damage the earphones.
- 3.) Never use the cable to remove the earphones, this could affect cable performance. Damage of this nature is not covered by the warranty.
- 4.) To avoid damage when the earphones are not in use, always store them in the carrying case.

Westone Earphone Care + Maintenance

Here are a few simple guidelines that can greatly increase your listening enjoyment and the lifespan of your Westone earphones:

- In case of poor sound quality due to earwax in the sound bore, use the included wax removal loop to carefully remove the earwax. Never use any other object to attempt to remove the earwax as this may result in damage to the earphones and will void the warranty.

- Do not expose your earphones to temperature extremes.
- Wipe down your earphones after each use.
- If the earphone volume seems diminished, inspect the output nozzle for built-up/impacted earwax (cerumen). Use the cerumen removal tool (included) to flick the impacted cerumen out of the output nozzle. Never use any other tool/object to remove impacted cerumen as this could damage the earphone and void the warranty.
- Wipe the earphones and cable with a soft clean dry cloth occasionally to clean them and remove any foreign material. This is especially important after vigorous exercise, the earphones and cables should always be wiped down to remove perspiration.

Please Note:

Never insert earphones into the ear, if the ear is wet or covered with perspiration, always dry ears before inserting earphones. Moisture in the earphone output nozzle can cause temporary performance problems. If water or perspiration should inadvertently find its way into the output nozzle of the earphone, and it stops working, please allow the earphone to dry completely (8 hours-24 hours). When dry the earphone will should function properly. (Extended exposure to moisture or submersion in liquids of any kind could result in permanent damage and is not covered by the warranty.)

Exchanging the Faceplate

1. Using supplied tool, unscrew faceplate fastener. Note: Screw is attached to the faceplate and cannot be removed.
2. Remove faceplate by sliding it directly away from your earphone.
3. Locate the correct decorative clip (right side or left side) for the earphone. Align and then slide the clip straight into the opening in the sides of the earphone body until fully seated.
4. Tighten faceplate fastener, ensuring not to cross-thread screw or over-tighten.

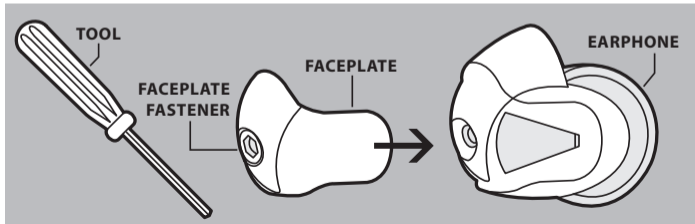

Universal Earphones

Westone warrants the external shell of the product, and the internal components to be free of defects in material or workmanship for a period of two (2) years from the date of original retail purchase. The carrying case, cleaning tool, any adapters and other included accessories are covered for ninety (90) days. Ear tips are not covered by the warranty. This warranty is available only to the original purchaser, and only if purchased from an authorized Westone distributor or reseller.

If your product is found to be defective during the warranty period, Westone will, at its sole option, either repair the product or replace the product with a new or factory reconditioned or substantially equivalent model. This limited warranty does not apply to loss, theft, or any defects attributable to damage beyond the reasonable control of Westone including damage caused by abuse, misuse, misapplication or modifications performed by anyone other than Westone.

Repair/Replacement Warranty

This Limited Warranty shall apply to any repair, replacement part or replacement product for the remainder of the original warranty period or for ninety (90) days, whichever period of time is greater. Any parts or product replaced under warranty will become the property of Westone. Replacement cables, carrying case, cleaning tool, any adapters and other included accessories are covered for ninety (90) days.

Requesting Warranty Support

If your product is not functioning properly, first ensure that the sound bore is not blocked by

earwax and that the unit is completely dry. Performing these simple troubleshooting steps could solve the problem and eliminate the need for factory service.

Valid warranty claims are generally processed through the point of purchase during the first thirty (30) days after retail purchase.

United States & Canada

If it is necessary to return your product to Westone for warranty or post-warranty service, contact Westone to request a return merchandise authorization (RMA) number. You may call 1-800-525-5071 or click the Product Return link on the sidebar to submit a Product Return Request Form. Please note you will be required to submit reasonable proof of purchase date, ownership, and that the product was purchased from an authorized Westone retailer. Once you receive your RMA number, package the product securely to prevent damage in transit, include the documentation, and send prepaid and insured through a trackable shipping carrier to:

Westone Laboratories, Inc. Attn: Music Returns Dept.
2260 Executive Circle | Colorado Springs, CO 80906 | USA

Westone will be responsible for shipping to the consumer after repair/replacement only. The customer is responsible for all shipping/handling charges related to returning the product to Westone.

International

The warranty on this product if it is sold to a consumer outside of the United States and Canada shall comply with applicable law. To obtain warranty service, contact the dealer from which you

purchased or the distributor that supplied this product. Additional charges and limitations may apply.
International Dealer List

If purchased through an authorized Westone retailer, but not through the local distributor or distributor's network, contact Westone directly (see United States & Canada instructions above).

If purchased in an international location without a Westone distributor, contact Westone directly (see United States & Canada instructions above).

Limitation of Liability

Westone disclaims any and all implied warranties, warranties of merchantability and fitness for a particular purpose to the maximum extent permissible by law. Westone shall not be liable for any special, incidental or consequential damages caused by the use, misuse, or inability to use this product. If purchased under a government contract, those contract terms supersede terms stated herein. In some locations, implied warranties cannot be limited. Under certain conditions, these limitations or exclusions may therefore not apply to you. This warranty replaces all other warranties for this product.

Our Story

Since 1959, Westone has been creating and manufacturing premium custom-fit and universal-fit products for the human ear. Westone in-ear monitors and universal earphones are designed and built to perform in the most demanding environments, and are trusted and loved by not only the biggest names in the music industry, but also by the most discriminating music lovers.

It is our experience, our products, and our people that make Westone *The In-Ear Experts*.

Important Information

Used wisely, your new earphones will provide years of enjoyment.

Noise-induced hearing loss is preventable but often undetected until it is too late. Westone and the Electronic Industries Association's Consumer Electronics Group recommend you avoid prolonged exposure to excessive noise. Used responsibly, your Westone Series earphones can help prevent noise-induced hearing loss. If you have questions, contact your audiologist or hearing care professional.

Be sure to observe the following guidelines:

- Do not turn up the volume so high that you can't hear what's around you.
- You should use extreme caution or temporarily discontinue use in potentially hazardous situations.
- Do not use while operating a motorized vehicle as it may create a traffic hazard and is illegal in many areas.

If you would like more information or would like to purchase other Westone products and accessories, please call 1-877-290-3988 or visit us at: westoneaudio.com

Listen for a Lifetime!

Please read this important information before using your Westone earphones. If everything sounds muffled or you hear ringing or buzzing after using your earphones, your ears are trying to give you a warning! These are symptoms normally associated with a condition known as Temporary Threshold Shift and are an indication of conditions that could lead to permanent hearing loss.

While no two individuals' hearing sensitivity is exactly the same, there are established safety guidelines for sound levels versus time of exposure. The chart (see below) is based on OSHA's (Occupational Health and Safety Administration) exposure information for industry. Remember that these guidelines are based on average hearing sensitivity. Your sensitivity may be above or below these levels.

The use of any earphones offers benefits and risks. Westone earphones can lower ambient sound levels approximately 25dB when properly worn. However, the performance capabilities of the earphones can allow the user to negate the benefits of hearing protection from ambient sound. We want you listening for a lifetime!

Remember, personal hearing protection is your responsibility!

dB Level	MAXIMUM Exposure Time	dB Level	MAXIMUM Exposure Time
85	8hr	105	1hr
90	8hr	110	30mins
95	4hr	115	15mins
100	2hr	120	Avoid



westoneaudio.com

At Westone, we value your satisfaction.

If you have any questions, please contact us:
Phone: 877-290-3988 | Email: music@westone.com

Designed in Colorado Springs, CO