

User Manual

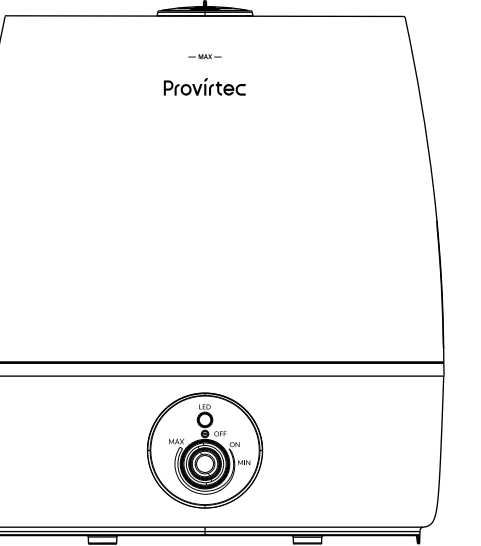

HC-12

CleanMist Humidifier

READ AND SAVE THESE INSTRUCTIONS

Contents

1. Important Safety Instructions	01
2. Package Contents	03
3. Specification	03
4. Introduction	04
5. Installation and Usage	05
6. Control Panel Guide	11
7. Cleaning & Storage Instructions	13
8. FAQ	18
9. Notice	21
10. Warranty	21
11. Contact Us	21

1. Important Safety Instructions

General Safety

1. Please use this humidifier strictly according to the instructions in the user manual to avoid accidents such as fire, electric shock, or personal injury.

2. This humidifier is suitable for people over 12 years old. Children or individuals with sensory disabilities or intellectual disabilities should use it only under the supervision of a guardian.

3. This humidifier is for indoor use only and should be placed on a suitable flat surface. Please do not use this humidifier outdoors.

4. Keep the humidifier away from heat sources (e.g., furnaces) and direct sunlight.

5. This humidifier uses ultrasonic technology to generate mist. It is recommended to use purified or distilled water to avoid residual water stains or white dust in the environment.

6. Using the humidifier in small, enclosed spaces or environments with humidity above 70% RH may lead to moisture accumulation around the device.

7. For nighttime use, it is recommended to turn the humidifier at maximum output 2 hours in advance, then switch to a lower setting before bedtime. In environments with humidity below 40%RH, it is recommended to turn on the maximum setting for humidification.

- Operational Safety

1. Do not insert or cover any objects into this humidifier to avoid damaging the air inlet and mist outlet, which may cause electric shock or fire.

2. Do not immerse the humidifier main unit, power cord, or plug in water or any other liquid.

3. To reduce the risk of fire or electric shock, do not use with solid-state speed control devices.

4. Do not add essential oils to the water tank or base. This may damage the humidifier and cause leakage.

5. When not in use for extended periods, please turn off the humidifier and unplug it from the outlet.

- Electrical Safety

1. The input voltage of the humidifier is AC 100-240V 50/60Hz. Please ensure that the voltage meets the requirements before use.

2. If the humidifier is damaged or malfunctions during operation, please contact customer service or a qualified electrician for repair or replacement. Do not attempt to repair or replace the humidifier yourself.

3. Do not touch the power cord or plug with wet hands. The power cord and plug should be kept away from liquids.

Scan for Installation, Usage & Cleaning Guides.



Installation Method



Cleaning Method

2. Package Contents

Humidifier Base x 1

Filter x 1

Cleaning Brush x 1
(Taped to the foam packaging at the bottom)

Water Tank x 1

User Manual x 1

Tank Lid x 1

Mist Outlet x 1

3. Specification

Product Name	CleanMist Humidifier
Model No.	HC-12
Power Input	AC 100-240V 50/60Hz
Humidifier Power	25W
Capacity	6.5L
Dimensions	11.42X6.42X12.99inch 290X163X330mm

4. Introduction

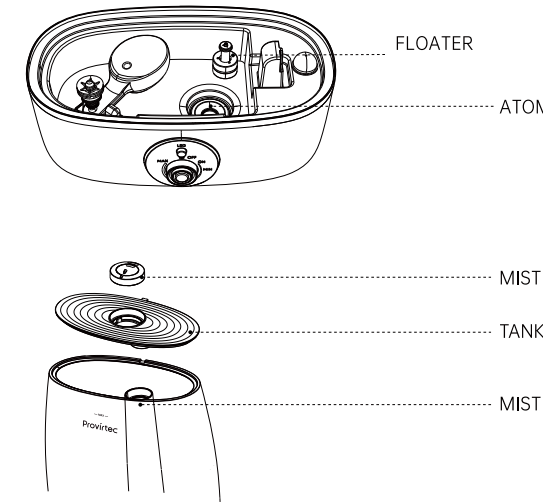
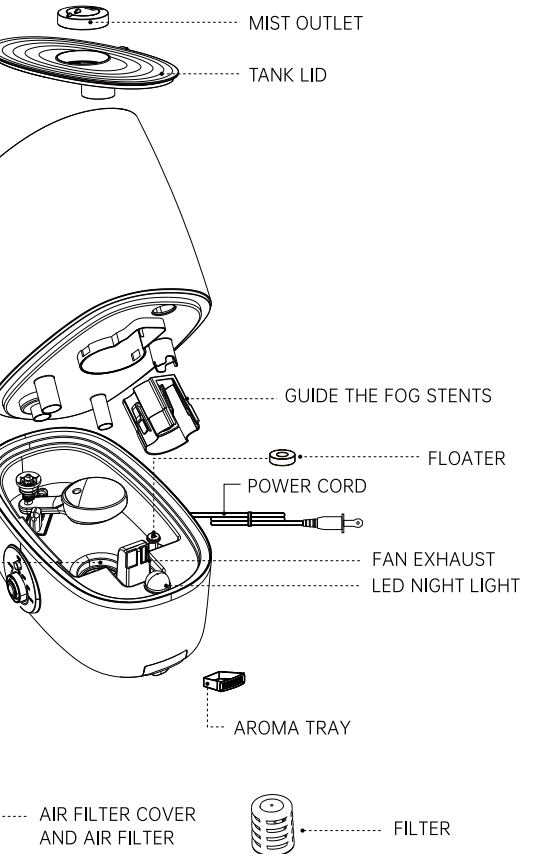

5. Installation and Usage

Attention! When placing the humidifier, ensure the following:

1. Place the humidifier on a firm, stable, flat, and dry surface. Avoid any tilting.

2. Keep the humidifier away from heat sources (e.g., furnaces) and direct sunlight.

3. Place the humidifier at least 1.7 feet away from walls, furniture, curtains, and other non-electrical items.

4. Keep at least 6.6 feet of clearance between the side of the humidifier and televisions or other electronic devices.

5. The top is at least 4.2 feet away from any objects.

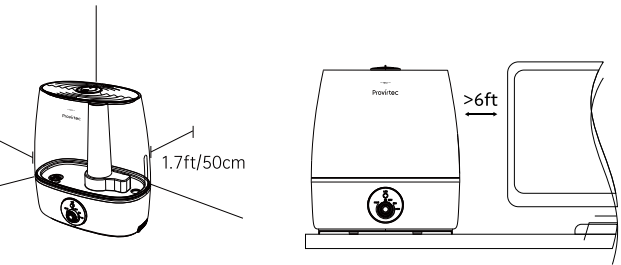

Preparation before using the humidifier:

1. Remove all packaging, take out and check if all parts: base x 1, water tank x 1, tank lid x 1, mist outlet x 1, filter x 1.

2. Remove the water tank from the base, take out the sponge packaging material from the base, clean all parts thoroughly before the first use, and reinstall the water tank on the base.
- Align the front side of the water tank (marked with **MAX**) with the side of the base that has the control knob. Place the humidifier in a suitable location.

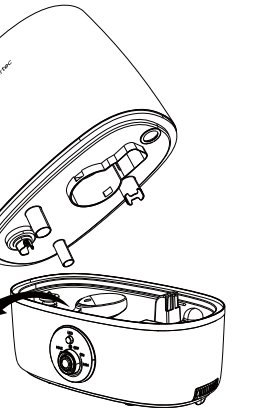

3. Find the filter in the box, install the filter to the water tank valve, and press it into place.

Note: Be sure to install the filter properly. It filters impurities in the water to prevent the valve from being blocked and avoid leakage!

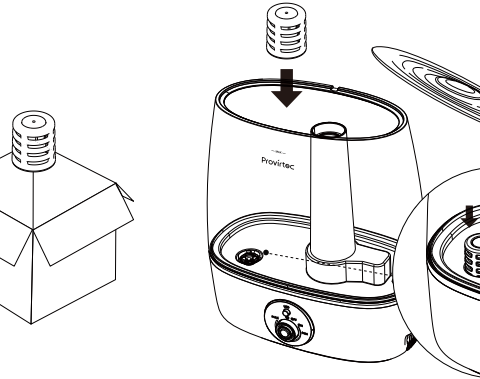

4. Remove the tank, open the tank lid (you can directly add water into the tank), and avoid the mist tube to add water.
- Ensure the water level stays below the MAX line.**

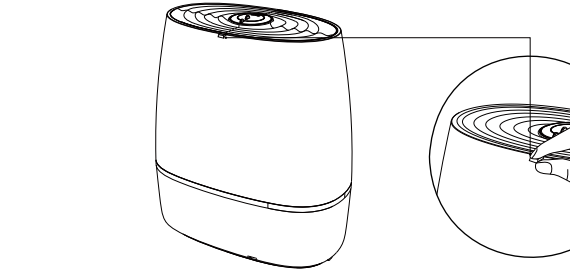
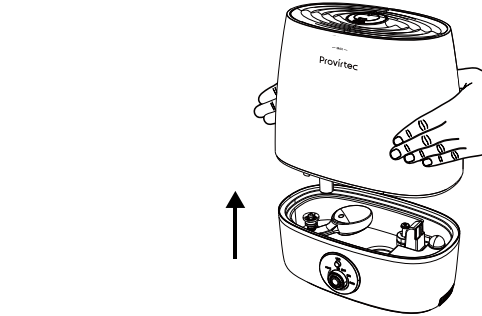

Important:

- We recommend using purified or distilled water. Tap water may lead to mineral buildup.

• Do not add water directly into the mist tube; this may cause leakage.

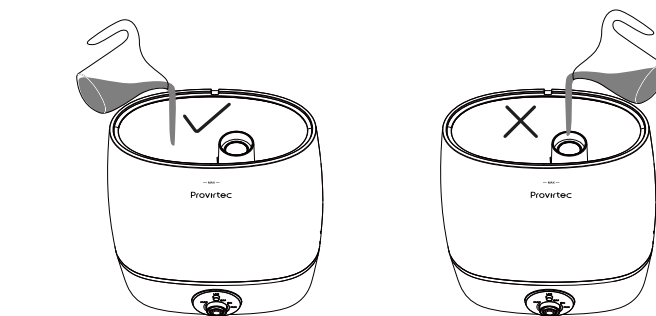

5. Reattach the tank lid and reinstall the water tank onto the base.

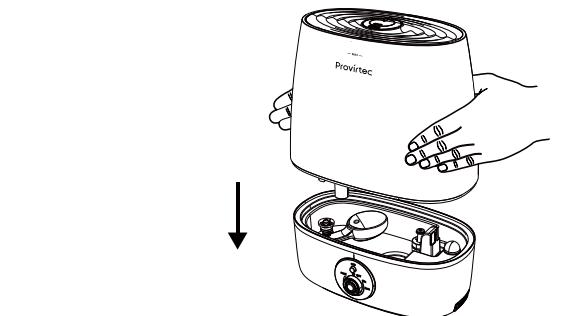

6. Plug in the power cord. Turn the control knob clockwise to select the desired output level.
- When the indicator light turns green, the humidifier is operating normally.

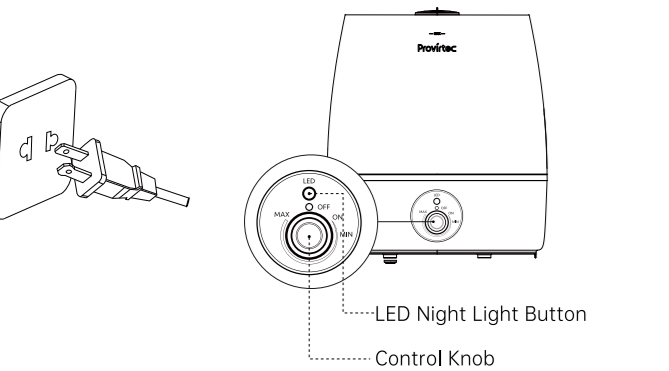

7. There is an aroma tray on the side of the humidifier. Remove the tray and apply essential oil to the aroma pad until it is saturated. Reinsert the tray, turn on the humidifier, and enjoy fragrant misting.

- Note:**
- Do not add essential oils directly to the water tank or base to avoid corrosion and leakage.
 - We recommend using antibacterial essential oils.

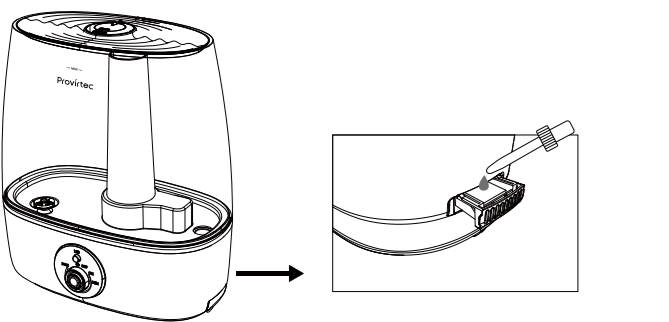

6. Control Panel Guide

Control Button Instructions

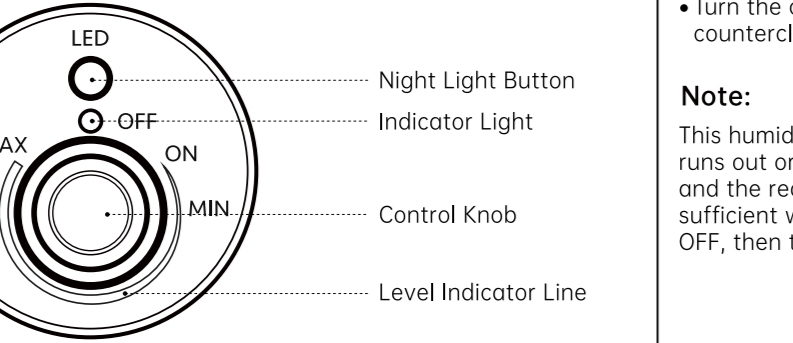

Indicator Light

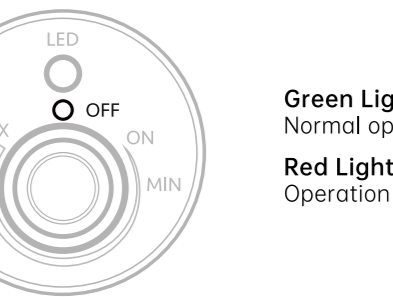

- Green Light:**
Normal operation.
- Red Light:**
Operation stopped.

Control Knob

- When the water tank has sufficient water and is correctly installed on the base after about 30 seconds, turn the knob clockwise. The indicator light will turn green, and when the level indicator line exceeds ON, the humidifier will start humidifying.
- Turn the control knob clockwise to increase mist output; turn counterclockwise to reduce mist until it turns off.

Note:

This humidifier has an "Auto Shut-off" safety feature. If the water runs out or the tank is lifted, the humidifier stops automatically and the red light turns on. After installing a water tank with sufficient water on the base, turn the knob counterclockwise to OFF, then turn it clockwise again to resume operation.

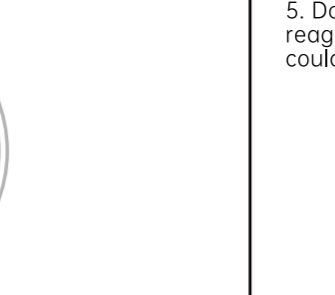

LED Night Light Button

- While powered on, press to activate the night light. Press again to turn it off.

Precautions:

1. After extended use, it is necessary to clean the water tank and grooves to prevent scale or impurities from blocking the water tank valve and avoid possible malfunctions.

2. To avoid excessive humidity that may cause dampness and water accumulation around the humidifier, please adjust the mist output to a lower level when using it in an enclosed space for a long time.

7. Cleaning & Storage Instructions

1. Regular cleaning can extend the life of the humidifier. It is recommended to clean the humidifier every 2 to 3 days to remove any slimy film or scale from the water tank and base.
2. If the humidifier will not be used for an extended period, be sure to clean the device before long-term storage.
3. Unplug the power cord from the outlet and wait for the humidifier to cool down before cleaning.
4. Do not immerse the base or power cord in water or any liquid.
5. Do not use corrosive, dissolving cleaning agents or chemical reagents. Avoid steel wire brushes or other sharp or hard tools that could damage the humidifier.

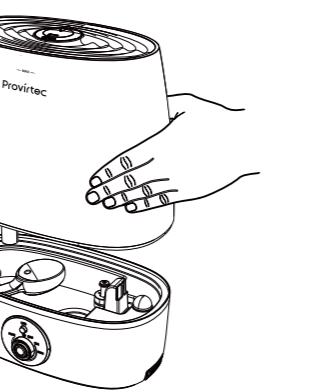

Cleaning Steps

First, remove the water tank from the base and clean the water tank and base separately.

Water Tank Cleaning:

1. Remove the tank lid and mist outlet from the water tank.

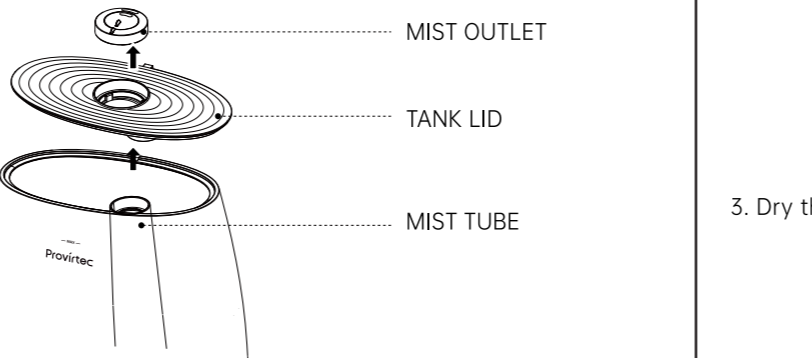

2. Clean the tank lid, mist outlet, and water tank with a mild soapy water solution or a cleaning solution of 1 part vinegar and 3 parts water (1:3 ratio of vinegar to water). When cleaning the water tank, pour the cleaning solution into the water tank, use a soft brush to remove the scale on the inner wall of the tank, pour out the cleaning solution, and then rinse the tank with clean water.

Cleaning Steps

First, remove the water tank from the base and clean the water tank and base separately.

Water Tank Cleaning:

1. Remove the tank lid and mist outlet from the water tank.

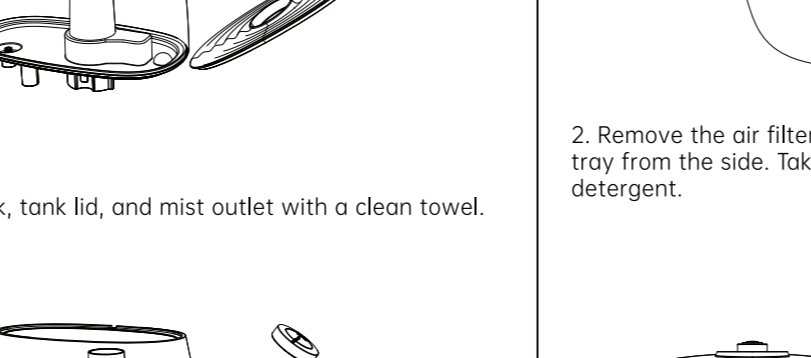

2. Clean the tank lid, mist outlet, and water tank with a mild soapy water solution or a cleaning solution of 1 part vinegar and 3 parts water (1:3 ratio of vinegar to water). When cleaning the water tank, pour the cleaning solution into the water tank, use a soft brush to remove the scale on the inner wall of the tank, pour out the cleaning solution, and then rinse the tank with clean water.

Cleaning Steps

First, remove the water tank from the base and clean the water tank and base separately.

Water Tank Cleaning:

1. Remove the tank lid and mist outlet from the water tank.

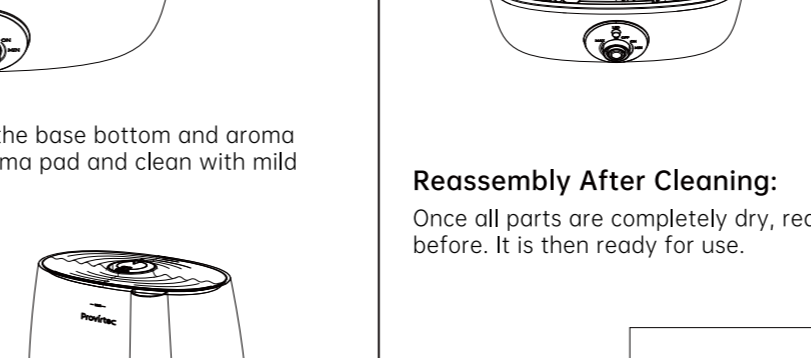

2. Clean the tank lid, mist outlet, and water tank with a mild soapy water solution or a cleaning solution of 1 part vinegar and 3 parts water (1:3 ratio of vinegar to water). When cleaning the water tank, pour the cleaning solution into the water tank, use a soft brush to remove the scale on the inner wall of the tank, pour out the cleaning solution, and then rinse the tank with clean water.

Cleaning Steps

First, remove the water tank from the base and clean the water tank and base separately.

Water Tank Cleaning:

1. Remove the tank lid and mist outlet from the water tank.

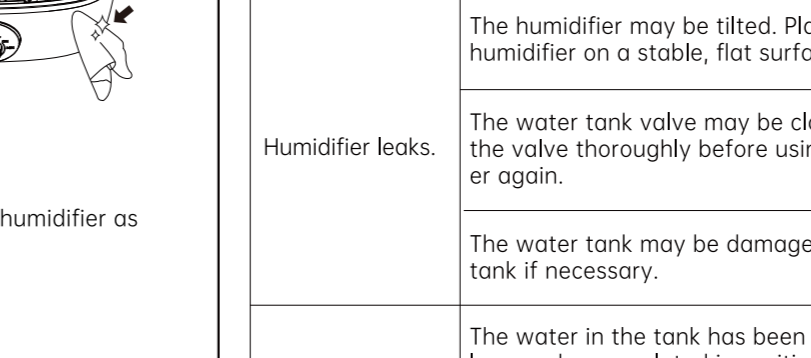

2. Clean the tank lid, mist outlet, and water tank with a mild soapy water solution or a cleaning solution of 1 part vinegar and 3 parts water (1:3 ratio of vinegar to water). When cleaning the water tank, pour the cleaning solution into the water tank, use a soft brush to remove the scale on the inner wall of the tank, pour out the cleaning solution, and then rinse the tank with clean water.

Cleaning Steps

First, remove the water tank from the base and clean the water tank and base separately.

Water Tank Cleaning:

1. Remove the tank lid and mist outlet from the water tank.

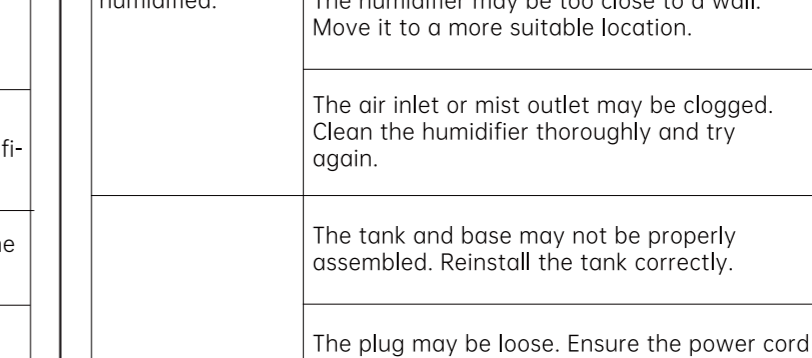

2. Clean the tank lid, mist outlet, and water tank with a mild soapy water solution or a cleaning solution of 1 part vinegar and 3 parts water (1:3 ratio of vinegar to water). When cleaning the water tank, pour the cleaning solution into the water tank, use a soft brush to remove the scale on the inner wall of the tank, pour out the cleaning solution, and then rinse the tank with clean water.

Cleaning Steps

First, remove the water tank from the base and clean the water tank and base separately.

Water Tank Cleaning:

1. Remove the tank lid and mist outlet from the water tank.

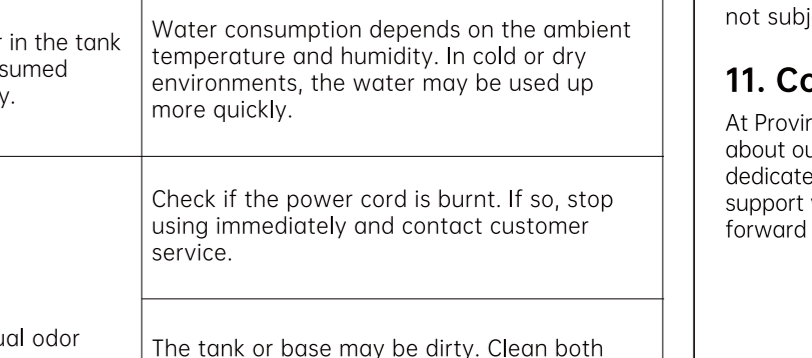

2. Clean the tank lid, mist outlet, and water tank with a mild soapy water solution or a cleaning solution of 1 part vinegar and 3 parts water (1:3 ratio of vinegar to water). When cleaning the water tank, pour the cleaning solution into the water tank, use a soft brush to remove the scale on the inner wall of the tank, pour out the cleaning solution, and then rinse the tank with clean water.

Cleaning Steps

First, remove the water tank from the base and clean the water tank and base separately.

Water Tank Cleaning:

1. Remove the tank lid and mist outlet from the water tank.

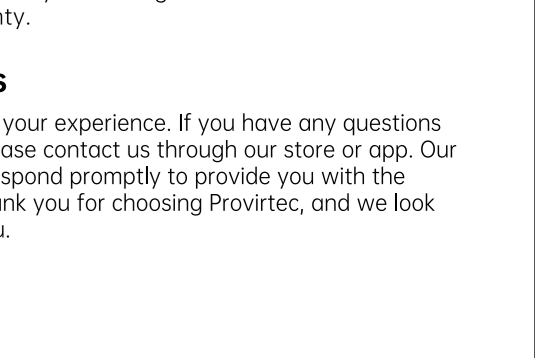

2. Clean the tank lid, mist outlet, and water tank with a mild soapy water solution or a cleaning solution of 1 part vinegar and 3 parts water (1:3 ratio of vinegar to water). When cleaning the water tank, pour the cleaning solution into the water tank, use a soft brush to remove the scale on the inner wall of the tank, pour out the cleaning solution, and then rinse the tank with clean water.

Base Cleaning:

1. Pour out the water from the base from the opposite side of the air outlet to ensure that water does not flow into the base and damage the internal components.

Storage Instructions:

When not using the humidifier for an extended period, store it in the original packaging or a dustproof bag. Keep it in a cool, dry, and dust-free place, away from direct sunlight.

8. FAQ

Problems	Possible Solution
Humidifier leaks.	The humidifier may be tilted. Place the humidifier on a stable, flat surface.
	The water tank valve may be clogged. Clean the valve thoroughly before using the humidifier again.
	The water tank may be damaged. Replace the tank if necessary.
White dust appearing in the environment.	The water in the tank has been left for too long and accumulated impurities. Refill with fresh water.
	The water quality is poor. Use purified or distilled water for humidification.
No mist, low mist output, or the air doesn't feel humidified.	The water tank may be empty. Ensure it is filled and restart the humidifier.
	This humidifier is designed for use in bedrooms or living rooms. If you are too far from the humidifier, you may not feel the humidity effect clearly.

Storage Instructions:

When not using the humidifier for an extended period, store it in the original packaging or a dustproof bag. Keep it in a cool, dry, and dust-free place, away from direct sunlight.

8. FAQ

Problems	Possible Solution
Humidifier leaks.	The humidifier may be tilted. Place the humidifier on a stable, flat surface.
	The water tank valve may be clogged. Clean the valve thoroughly before using the humidifier again.
	The water tank may be damaged. Replace the tank if necessary.
White dust appearing in the environment.	The water in the tank has been left for too long and accumulated impurities. Refill with fresh water.
	The water quality is poor. Use purified or distilled water for humidification.
No mist, low mist output, or the air doesn't feel humidified.	The water tank may be empty. Ensure it is filled and restart the humidifier.
	This humidifier is designed for use in bedrooms or living rooms. If you are too far from the humidifier, you may not feel the humidity effect clearly.

Storage Instructions:

When not using the humidifier for an extended period, store it in the original packaging or a dustproof bag. Keep it in a cool, dry, and dust-free place, away from direct sunlight.

8. FAQ

Problems	Possible Solution
Humidifier leaks.	The humidifier may be tilted. Place the humidifier on a stable, flat surface.
	The water tank valve may be clogged. Clean the valve thoroughly before using the humidifier again.
	The water tank may be damaged. Replace the tank if necessary.
White dust appearing in the environment.	The water in the tank has been left for too long and accumulated impurities. Refill with fresh water.
	The water quality is poor. Use purified or distilled water for humidification.
No mist, low mist output, or the air doesn't feel humidified.	The water tank may be empty. Ensure it is filled and restart the humidifier.
	This humidifier is designed for use in bedrooms or living rooms. If you are too far from the humidifier, you may not feel the humidity effect clearly.

Storage Instructions:

When not using the humidifier for an extended period, store it in the original packaging or a dustproof bag. Keep it in a cool, dry, and dust-free place, away from direct sunlight.

8. FAQ

Problems	Possible Solution
Humidifier leaks.	The humidifier may be tilted. Place the humidifier on a stable, flat surface.
	The water tank valve may be clogged. Clean the valve thoroughly before using the humidifier again.
	The water tank may be damaged. Replace the tank if necessary.
White dust appearing in the environment.	The water in the tank has been left for too long and accumulated impurities. Refill with fresh water.
	The water quality is poor. Use purified or distilled water for humidification.
No mist, low mist output, or the air doesn't feel humidified.	The water tank may be empty. Ensure it is filled and restart the humidifier.
	This humidifier is designed for use in bedrooms or living rooms. If you are too far from the humidifier, you may not feel the humidity effect clearly.

Storage Instructions:

When not using the humidifier for an extended period, store it in the original packaging or a dustproof bag. Keep it in a cool, dry, and dust-free place, away from direct sunlight.

8. FAQ

Problems	Possible Solution
Humidifier leaks.	The humidifier may be tilted. Place the humidifier on a stable, flat surface.
	The water tank valve may be clogged. Clean the valve thoroughly before using the humidifier again.
	The water tank may be damaged. Replace the tank if necessary.
White dust appearing in the environment.	The water in the tank has been left for too long and accumulated impurities. Refill with fresh water.
	The water quality is poor. Use purified or distilled water for humidification.
No mist, low mist output, or the air doesn't feel humidified.	The water tank may be empty. Ensure it is filled and restart the humidifier.
	This humidifier is designed for use in bedrooms or living rooms. If you are too far from the humidifier, you may not feel the humidity effect clearly.

Storage Instructions:

When not using the humidifier for an extended period, store it in the original packaging or a dustproof bag. Keep it in a cool, dry, and dust-free place, away from direct sunlight.

8. FAQ

Problems	Possible Solution
Humidifier leaks.	The humidifier may be tilted. Place the humidifier on a stable, flat surface.
	The water tank valve may be clogged. Clean the valve thoroughly before using the humidifier again.
	The water tank may be damaged. Replace the tank if necessary.
White dust appearing in the environment.	The water in the tank has been left for too long and accumulated impurities. Refill with fresh water.
	The water quality is poor. Use purified or distilled water for humidification.
No mist, low mist output, or the air doesn't feel humidified.	The water tank may be empty. Ensure it is filled and restart the humidifier.
	This humidifier is designed for use in bedrooms or living rooms. If you are too far from the humidifier, you may not feel the humidity effect clearly.

Storage Instructions:

When not using the humidifier for an extended period, store it in the original packaging or a dustproof bag. Keep it in a cool, dry, and dust-free place, away from direct sunlight.

8. FAQ

Problems	Possible Solution
Humidifier leaks.	The humidifier may be tilted. Place the humidifier on a stable, flat surface.
	The water tank valve may be clogged. Clean the valve thoroughly before using the humidifier again.
	The water tank may be damaged. Replace the tank if necessary.
White dust appearing in the environment.	The water in the tank has been left for too long and accumulated impurities. Refill with fresh water.
	The water quality is poor. Use purified or distilled water for humidification.
No mist, low mist output, or the air doesn't feel humidified.	The water tank may be empty. Ensure it is filled and restart the humidifier.
	This humidifier is designed for use in bedrooms or living rooms. If you are too far from the humidifier, you may not feel the humidity effect clearly.

Storage Instructions:

When not using the humidifier for an extended period, store it in the original packaging or a dustproof bag. Keep it in a cool, dry, and dust-free place, away from direct sunlight.

8. FAQ

Problems	Possible Solution
Humidifier leaks.	The humidifier may be tilted. Place the humidifier on a stable, flat surface.
	The water tank valve may be clogged. Clean the valve thoroughly before using the humidifier again.
	The water tank may be damaged. Replace the tank if necessary.
White dust appearing in the environment.	The water in the tank has been left for too long and accumulated impurities. Refill with fresh water.
	The water quality is poor. Use purified or distilled water for humidification.
No mist, low mist output, or the air doesn't feel humidified.	The water tank may be empty. Ensure it is filled and restart the humidifier.
	This humidifier is designed for use in bedrooms or living rooms. If you are too far from the humidifier, you may not feel the humidity effect clearly.

材质：125G双铜版纸

折好尺寸：105*150mm

装订方式：骑马钉

印刷风格：黑白印刷