

Tools needed:  
Philips Screwdriver,  
Tape Measure or Ruler

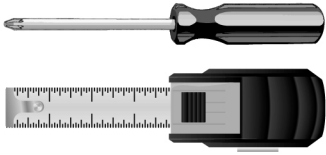

# BATH ROYALE

LUXURY BATHROOM ACCESSORIES

Model No.  
BR620 Round  
BR606 Elongated  
Premium Seat

## INSTALLATION INSTRUCTIONS



**CAUTION:** Installation is not difficult, but it is **VERY DIFFERENT** from other seats. The quality of this seat starts with proper installation. Please follow these instructions step-by-step.

*Questions? Please call 7 days/week 704-589-1009.*

**INSTALLATION OVERVIEW:** Please follow the details inside

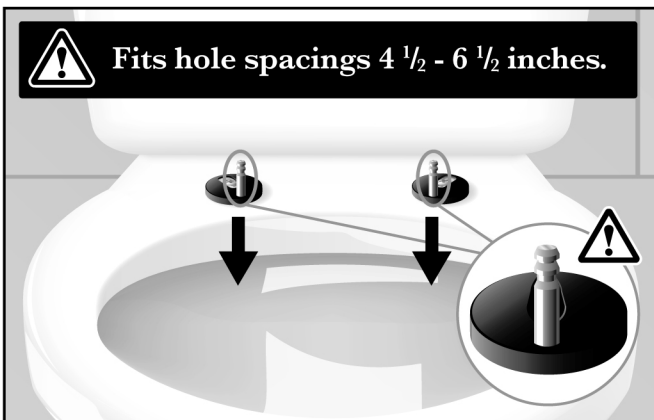

1. Attach mounting bases to toilet first.



2. Attach seat to the mounting posts.



3. Adjust seat for a proper fit.



4. Firmly tighten using screwdriver while holding wingnuts.

*Questions? Please call 7 days/week 704-589-1009*

# PARTS LIST



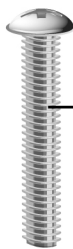

**MISSINGS PARTS? Please do not return your seat.**  
Call (704) 589-1009 or email [info@bathroyale.com](mailto:info@bathroyale.com)  
and we will immediately send parts at no charge.

**x4**  **Mounting base covers (x4).**  
(2 sets included, choose color-matched or stainless steel).

**x2**  **Stainless Steel Screws (x2).**

**x2**  **Stainless Steel Washers (x2).**

**x2**  **Mounting bases with Stainless Steel mounting posts (x2).**

**x2**  **White Split Wingnuts (x2).**

 **Toilet Seat and Lid (x1).**



**NOTE: Some 1-piece toilets and toilet bowls with 'skirted' or flat sides (aka concealed trap way) require 'top-mount' hardware. Top-mount hardware is sold separately at Amazon.com (search 'B0759WR3F9') or at [www.bathroyale.com](http://www.bathroyale.com)**

# INSTALLATION INSTRUCTIONS



**IMPORTANT: Mounting surface of toilet must be flat (level), clean and dry with no chemical residue.**

**TIP: Please use a little Windex® (or any glass cleaner) around the mounting holes to get the mounting surface squeaky clean.**

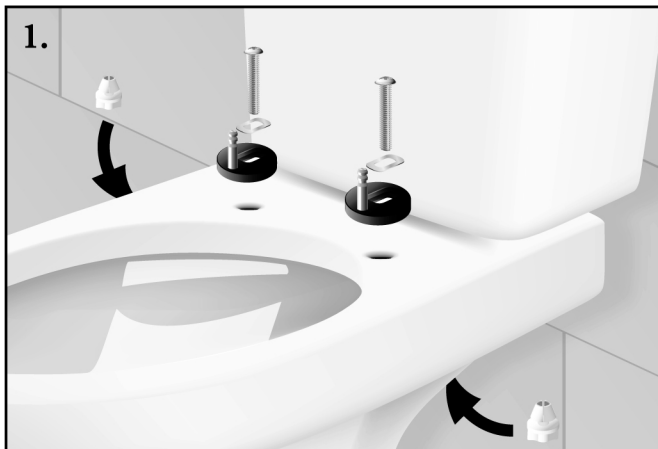

## 1. Install the mounting bases on the bowl.

- Place mounting bases over holes in toilet (posts facing front of bowl).
- Place stainless steel washers in mounting base slots.
- Insert screws through the washers, mounting bases and holes in the toilet.



## 2. Install wingnuts.

Thread wingnut by holding the screw down and sliding the wingnut up the length of the screw. Turn the wingnut (or screw) while pushing the tips of the wingnut into the underside of the mounting hole (this compresses the tips around the screw to engage the threads). Once threaded, each turn wedges the wingnut further and tighter into the mounting hole. This wedge principal creates an extremely strong, self-locking effect to hold your seat firmly in place.

**IMPORTANT: Do not completely tighten. The mounting bases must be able to move so the seat can be adjusted in Step 6.**

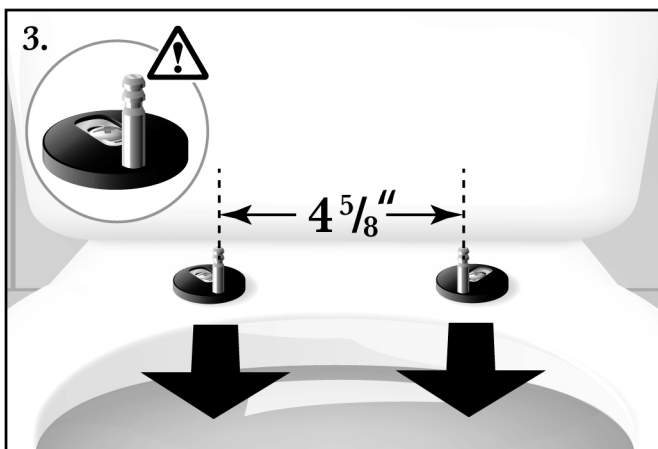

## 3. Rotate mounting bases so the posts are closest to the front of the bowl (not tank).

Using a tape measure or ruler, adjust the mounting bases so the posts are 4 -  $\frac{5}{8}$  inches apart (this is the distance between the mounting holes in the seat). Do not completely tighten the wing nuts.



**IMPORTANT: The mounting posts must face forward.**

# INSTALLATION INSTRUCTIONS



## 4. Attach seat.

Gently lower the seat (holes) onto the mounting posts (move posts as needed). **TIP: You may hear a 'click' as the gray release button pops out, locking the seat onto the posts.** The Quick Release mechanism is unlocked by pushing the button 'in'. If button is pushed before attaching seat, don't worry, it will pop 'out' when you attach the seat.

**TIP 2: If posts are not perfectly aligned and inserted at the same time, one post may lock into place. If this happens, don't try to unlock or remove the seat. Instead, move the base(s) so the second post can be inserted (loosen wingnuts as needed).**

**TIP 3: The Quick Release button works much better if both posts are inserted and locked into place.**



## 5. Close seat and cover.

Tap forward and let the seat and cover close by themselves.

**TIP: It is OK to push closed if desired. Unlike other slow close seats, Bath Royale seats can be force-closed repeatedly, without damaging the slow-close mechanism.**

**Closing too slow? Push it closed.**

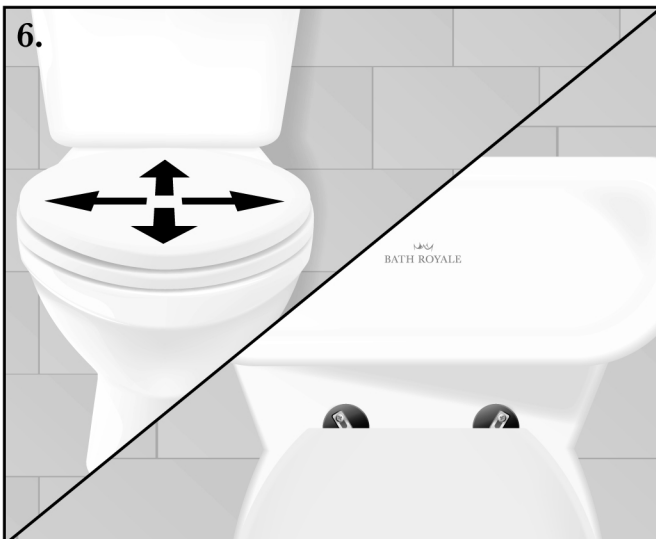

## 6. Adjust seat.

With the seat and cover closed, adjust its position by moving the seat and bases together. (Loosen nuts further, if necessary).

**TIP: We recommend installing the seat overhanging the front of the bowl by 1/4 inch. That way, users can lift the seat without touching the toilet bowl.**

**TIP: In most cases, screw heads should be back of screw slot.**

# INSTALLATION INSTRUCTIONS



**7. Double check seat alignment and tighten screws very firmly.**

**TIP: If screw heads are obstructed by the seat, hand tighten, then remove seat for final tightening (see next step).**



**IMPORTANT: To tighten properly, it is necessary to hold the wingnuts beneath while using a Phillips head screwdriver. Again, tighten very firmly.**



**8. Remove seat.**

a) With seat and cover closed, press and release the Quick Release button. (Pressing the button 'unlocks' the seat).

b) Carefully open the seat (hinges will pivot and you will feel some resistance, this is normal and the seat should remain connected to the posts).

c) With seat and cover open, lift straight up with one hand. (You will hear a 'click' as the seat slips off the posts very easily).

**TIP: If difficult, re-check post alignment.**

# INSTALLATION INSTRUCTIONS

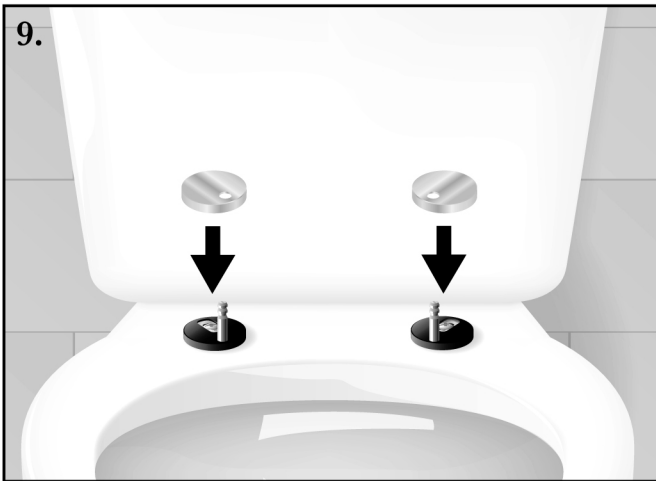

9. Place mounting base covers on mounting bases.

**BONUS:** There is an extra pair included. Choose color-matched or stainless steel.



10. Replace seat.

Align holes with mounting posts and carefully lower seat back into place (a 'click' will be heard as the button pops out and seat locks into place). **NOTE: Do not push hard or force seat onto posts. (If difficult, re-check alignment of posts and holes).**

#### TROUBLE SHOOTING TIPS:

- a) Mounting surface must be level (flat).
- b) Rear bumpers are not supposed to touch the bowl until person is seated.
- c) If seat or lid do not stay open, adjust the seat forward (step 6) to increase layback angle, (also make sure tank lid is pushed back as far as possible).

**CONGRATULATIONS,  
YOU ARE NOW FINISHED.**

**TIP:** Practice removing seat (step 8) and replacing seat (step 10).

**Questions? Contact us at (704) 589-1009 (7 days/week)**



**BATH ROYALE**

LUXURY BATHROOM ACCESSORIES

© 2018 Marcobelle Company. All Rights Reserved

88529C  
04.10.2019