

<div>Basic joints</div> <div>59</div>	<div>AA-001</div> 	<div>AA-001C</div> 	<div>AA-021</div> 	<div>AA-002</div> 	<div>AA-004</div> 
	<div>BA-001H</div> 	<div>BA-001C</div> 	<div>BA-044B</div> 	<div>BA-001T</div> 	<div>Angle joints</div> <div>62</div>
	<div>AA-027F</div> 	<div>AA-027M</div> 	<div>AA-013</div> 	<div>AA-090</div> 	<div>BA-045</div> 
	<div>BA-006</div> 	<div>BA-007F</div> 	<div>BA-027F</div> 	<div>BA-027M</div> 	<div>BA-007R</div> 
	<div>BA-090</div> 	<div>BA-013</div> 	<div>BA-015</div> 	<div>BA-145</div> 	<div>Attachment joints</div> <div>67</div>
	<div>AH-540</div> 	<div>AH-555</div> 	<div>AH-640</div> 	<div>AH-655</div> 	<div>AH-770</div> 
<div>APHA-3027</div> 	<div>Parallel joints</div> <div>70</div>	<div>AH-800</div> 	<div>AA-009</div> 	<div>AA-028</div> 	<div>BA-008</div> 
				<div>AA-023</div> 	<div>A28-A301</div> 
				<div>BA-011</div> 	



The right basic external clamping joint for every pipe.

## Basic external clamping joints

- Die-cast aluminium external clamping joints which permit tolerances when processing the pipes
- Profile and round pipes can be partially inserted

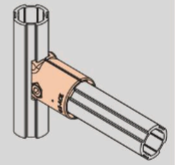

### A-001 Basic external clamping joint for profile pipe



Aluminium: 117693

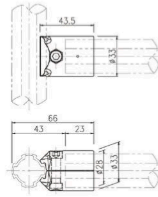

Weight: 23 g  
Packaging unit: 200 pcs

### AA-001 Set of basic joints for profile pipe



Aluminium: 117734

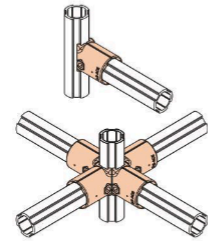

The set consists of following parts:

- 2 x A-001
- 1 x M0625, 1 x N06-55 W

### A-001C Basic external clamping joint for profile or round pipe



Aluminium: 123463

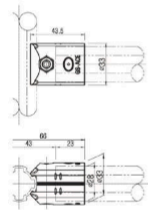

Weight: 25 g  
Packaging unit: 200 pcs

### AA-001C Set of basic joints for round pipe



Aluminium: 124268

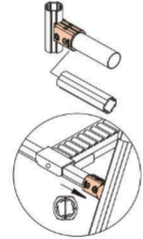

The set consists of following parts:

- 2 x A-001C
- 1 x M0625, 1 x N06-55 W

### A-021 Basic external clamping joint



Aluminium: 130774

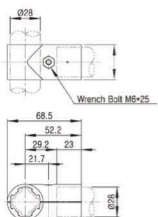

Weight: 33 g  
Packaging unit: 200 pcs

### AA-021 Set of basic joints, one-sided



Aluminium: 130785

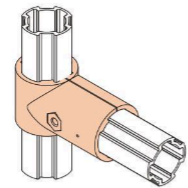

The set consists of following parts:

- 2 x A-021
- 1 x M0625, 1 x N06-55 W

### A-003 Basic external clamping joint for corner



Aluminium: 121231

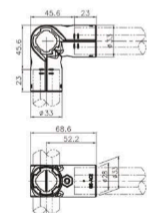

Weight: 59 g  
Packaging unit: 90 pcs

### AA-002 Set of basic joints for corner



Aluminium: 121230

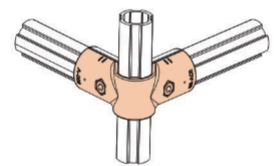

The set consists of following parts:

- 1 x A-003
- 2 x A-001
- 2 x M0625, 2 x N06-55 W



● Aluminium: 119383

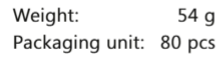

Aluminium: 119850

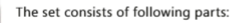

- ## Adaption
- 
- Aluminium: 401529

- 
- The right basic internal clamping joint for every pipe.



Aluminium: 402059



Aluminium: 501018

- The set consists of following parts:

- 
- Aluminium: 130808



Aluminium: 130850

- The set consists of following parts:

- 2 x B-001C
- 1 x M0620      • 2 x N06-55 W

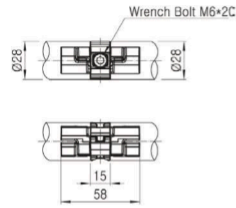
**B-044B** Basic internal clamping joint, two-sided

Weight: 24 g  
Packaging unit: 1000 pcs

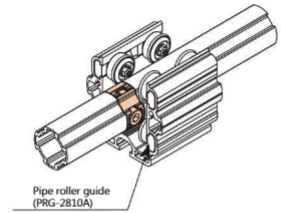
**BA-044B** Set of basic joints, two-sided

The set consists of following parts:

- 2 x B-044B
- 1 x M0620 • 1 x N06-55 W

**B-101** Hybrid joint**Adaption**

- Adaption to G.S. ACE AP28xx to 28 mm pipe and aluminium round profile pipe (S System)

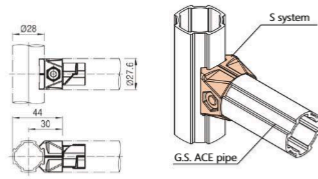

Weight: 20 g  
Packaging unit: 200 pcs

**B-001TA** T-form joint

- For connecting AT2829 pipe with round/square pipe Ø 28 mm

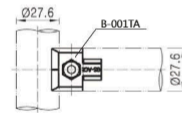

Weight: 13 g  
Packaging unit: 400 pcs

**BA-001T** Set of T-form joints

- For connecting AT2829 pipe with round/square pipe Ø 28 mm

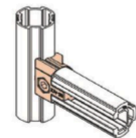

The set consists of following parts:

- 1 x B-001TA • 1 x M0615 WZ
- 1 x B-001TB • 1 x N06-55 W

**B-001TB** T-form joint

- For connecting AT2829 pipe with round/square pipe Ø 28 mm

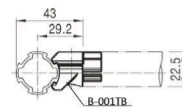

Weight: 13 g  
Packaging unit: 400 pcs

**Application examples B-044B**

The B-044B is used to connect two profile pipes. It thus makes it possible to use it as a guide rail for trolleys.

Attached to the SUS pipe is the GA-15S joint set which connects the basic joint B-044B by a screw M6.

The profile pipe is held in the middle by the B-044B, on which the flexible pipe guide rail PRG-2810A is mounted.

Under the pipe guide rail there is the end piece GS-1014CH located on which loads can be attached.



## External Clamping and movable angle joints

- Join profiles and pipes at any angle
- Die-cast aluminium, movable external angle joints which permit tolerances when processing the pipes
- Profile and round pipes can be inserted

### A-007B Angle external clamping joint

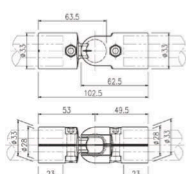

Weight: 31 g  
Packaging unit: 200 pcs

### AA-007F Set of angle external clamping joint

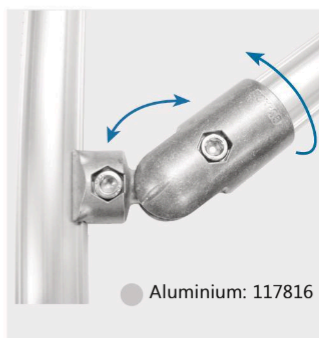

- The angle joint is **fixed** in the tightened state

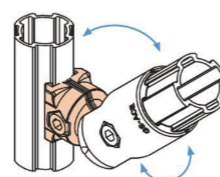

The set consists of following parts:

- 2 x A-007B • 2 x B-007A
- 1 x M0625, 1 x N06-55 W
- 1 x M0620, 1 x N06-55 W

### A-007C Angle external clamping joint

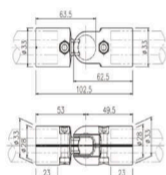

Weight: 27 g  
Packaging unit: 200 pcs

### AA-027F Set of angle external clamping joints

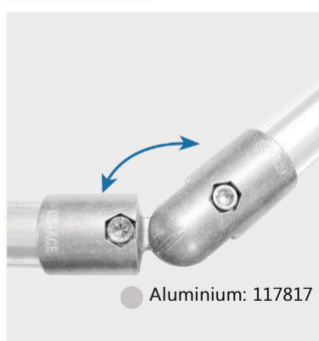

- The angle joint is **fixed** in the tightened state

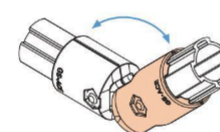

The set consists of following parts:

- 2 x A-007B • 2 x A-007C
- 2 x M0625, 2 x N06-55 W

### A-007D Angle external clamping joint

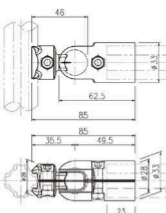

Weight: 31 g  
Packaging unit: 200 pcs

### AA-027M Set of angle external clamping joints



- The angle joint is **movable** in the tightened state

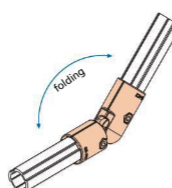

The set consists of following parts:

- 2 x A-007C • 2 x A-007D
- 2 x M0625, 2 x N06-55 W



## Fixed external clamping angle joints

- Die-cast aluminium, fixed external clamping angle joints which permit tolerances when processing the pipes
- Only profile pipes can be inserted

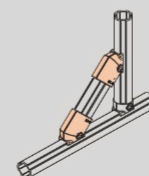

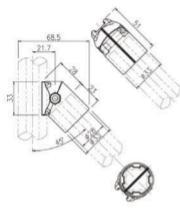
**A-013L** Angle external clamping joint, 45° left

Weight: 23 g  
Packaging unit: 200 pcs

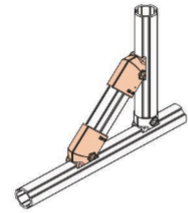
**AA-013** Set of angle clamping joints, 45°

The set consists of following parts:

- 1 x A-013L • 1 x A-013R
- 1 x M0625, 1 x N06-55 W

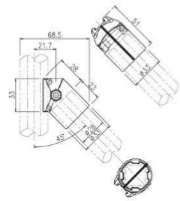
**A-013R** Angle external clamping joint, 45° right

Weight: 23 g  
Packaging unit: 200 pcs

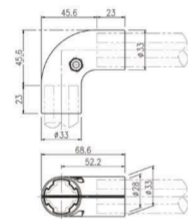
**A-090** Angle clamping joint, 90°

Weight: 50 g  
Packaging unit: 80 pcs

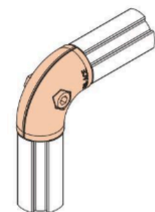
**AA-090** Set of angle clamping joints, 90°

The set consists of following parts:

- 2 x A-090
- 1 x M0625 • 1 x N06-55 W

**A-120** Angle clamping joint, 120°

Weight: 32 g  
Packaging unit: 80 pcs

**AA-120** Set of angle clamping joints, 120°

The set consists of following parts:

- 2 x A-120
- 1 x M0625 WZ, 1 x N06-55 W

**A-135** Angle clamping joint, 135°

Weight: 32 g  
Packaging unit: 80 pcs

**AA-135** Set of angle clamping joints, 135°

The set consists of following parts:

- 2 x A-135
- 1 x M0625 WZ, 1 x N06-55 W

**A-150** Angle clamping joint, 150°

Weight: 32 g  
Packaging unit: 80 pcs

**AA-150** Set of angle clamping joints, 150°

The set consists of following parts:

- 2 x A-150
- 1 x M0625 WZ, 1 x N06-55 W

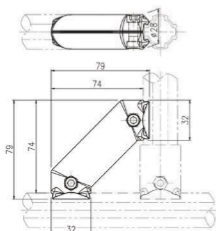
**B-045** Angle clamping joint for corner

Weight: 48 g  
Packaging unit: 100 pcs

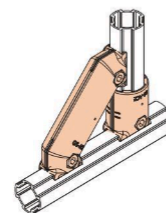
**BA-045** Set of angle joint for corner

The set consists of following parts:

- 2 x B-045
- 2 x M0620, 2 x N06-55 W

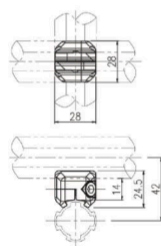
**B-006** Angle clamping joint, 90°

Weight: 12 g  
Packaging unit: 400 pcs

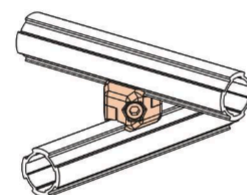
**BA-006** Set of angle joints, 90°

The set consists of following parts:

- 2 x B-006
- 1 x M0625 WZ, 1 x N06-55 W

**B-015L** Angle clamping joint, 90°, left

- Joint half-shell left, angle 90°
- One side as socket with guide for e.g. BA-001H, BA001C
- Flexible and space-saving strut

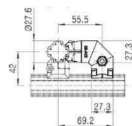

Weight: 24 g  
Packaging unit: 200 pcs

**BA-015** Set of angle joints, 90°

- One side as socket with guide for e.g. BA-001H, BA001C
- Flexible and space-saving strut

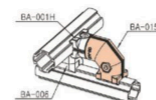

The set consists of following parts:

- 1 x B-015L • 1 x M0620 WZ
- 1 x B-015R • 1 x N06-55 W

**B-015R** Angle clamping joint, 90°, right

- Joint half-shell right, angle 90°
- One side as socket with guide for e.g. BA-001H, BA001C
- Flexible and space-saving strut

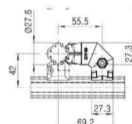

Weight: 24 g  
Packaging unit: 200 pcs

**B-145** Corner joint, 90°

NEW



Aluminium: 403444

- For aluminum profile pipe Ø28 mm and aluminum square pipe 28x28 mm
- With profile connection
- Space-saving corner strut

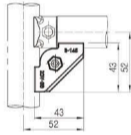

Weight: 20 g  
Packaging unit: 400 pcs

**BA-145** Set of corner joints, 90°

NEW



Aluminium: 501060

- For aluminum profile pipe Ø28 mm and aluminum square pipe 28x28 mm
- With profile connection
- Space-saving corner strut

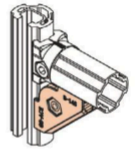

The set consists of following parts:

- 2 x B-145
- 1 x M0610 WZ • 1 x N06-55 W



Keep mobile with internal clamping,  
movable angle joints.

**Movable internal clamping angle joints**

- Join profiles and pipes at any angle
- Die-cast aluminium, movable internal clamping angle joints
- Profile pipes can be inserted
- Easy, angled assembly on profile grooves

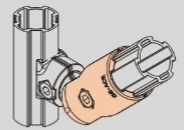
**B-007A** Angle internal clamping joint, 45°

Aluminium: 117704

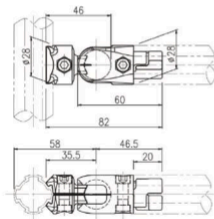

Weight: 17 g  
Packaging unit: 400 pcs

**BA-007F** Set of angle internal clamping joints

Aluminium: 117826

- The angle joint is **fixed** in the tightened state

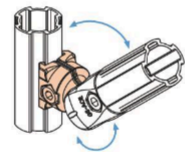

The set consists of following parts:

- 2 x B-007A • 2 x B-007B
- 2 x M0620, 2 x N06-55 W

**B-007B** Angle joint, counter part to B-007A

Aluminium: 117705

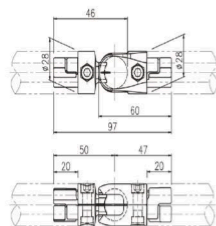

Weight: 25 g  
Packaging unit: 250 pcs

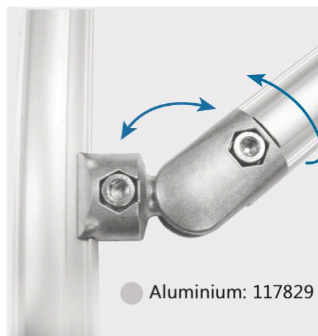
**BA-007R** Set of angle internal clamping joints

Aluminium: 117829

- The angle joint is **movable** and **rotatable** in the tightened state

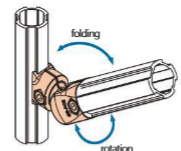

The set consists of following parts:

- 2 x B-007A • 2 x B-007D
- 2 x M0620, 2 x N06-55 W

**B-007C** Angle internal clamping joint

Aluminium: 117706

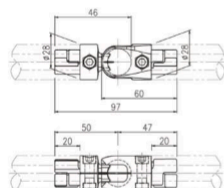

Weight: 23 g  
Packaging unit: 250 pcs

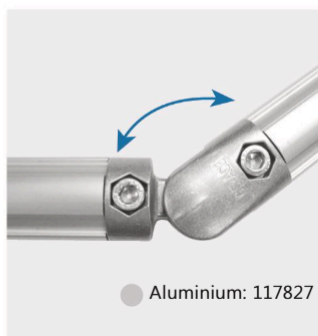
**BA-027F** Set of angle internal clamping joints

Aluminium: 117827

- The angle joint is **fixed** in the tightened state

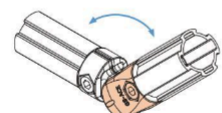

The set consists of following parts:

- 2 x B-007B • 2 x B-007C
- 2 x M0620, 2 x N06-55 W

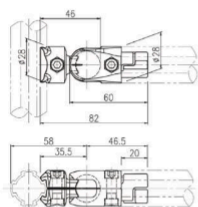
**B-007D** Angle joint, counter part to B-007C

Weight: 24 g  
Packaging unit: 250 pcs

**BA-027M** Set of angle internal clamping joints

- The angle joint is **movable** in the tightened state

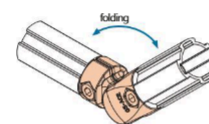

The set consists of following parts:

- 2 x B-007C • 2 x B-007D
- 2 x M0620, 2 x N06-55 W

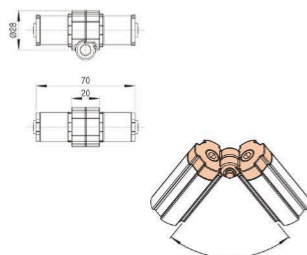
**AFU-28A** Angle clamping folding joint

Weight: 8 g  
Packaging unit: 80 pcs

**Fixed internal clamping angle joints**

- Die-cast aluminium, fixed internal clamping angle joints
- Profile pipes can be inserted
- Easy, angled assembly on profile grooves

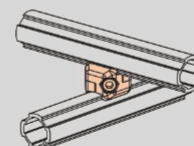
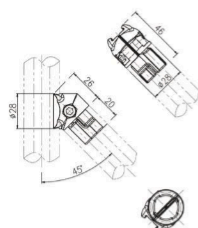
**B-013L** Angle internal clamping joint, 45° left

Weight: 18 g  
Packaging unit: 300 pcs

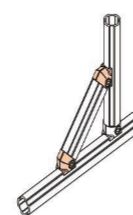
**BA-013** Set of angle joints, 45°

The set consists of following parts:

- 1 x B-013L • 1 x B-013R
- 1 x M0620, 1 x N06-55 W

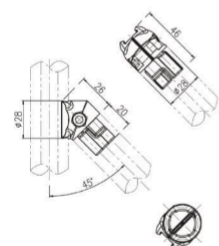
**B-013R** Angle internal clamping joint, 45° right

Weight: 18 g  
Packaging unit: 300 pcs

Weight: 47 g  
Packaging unit: 100 pcs

### AH-770 Slide bush

NEW



Aluminium: 403195

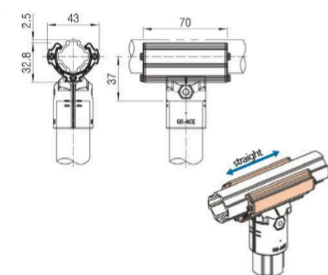

Weight: 48 g  
Packaging unit: 100 pcs

### AH-800 Slide bush

NEW

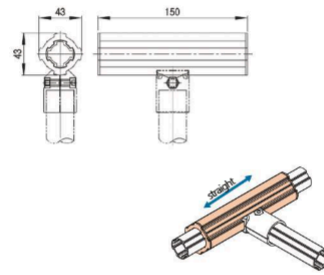

Aluminium: 130802

Weight: 58 g  
Packaging unit: 80 pcs

### ARU-28A Slide bush with rotating unit

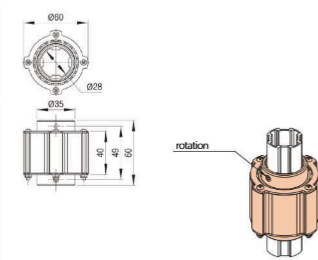

Aluminium: 128677

Weight: 240 g  
Packaging unit: 40 pcs

### ACA-309A Slide bush with rotation unit



Aluminium: 401493

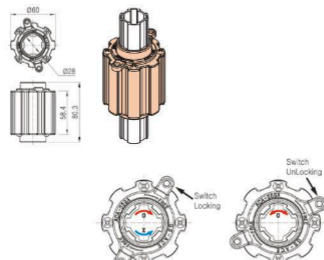

Weight: 42 g  
Packaging unit: 160 pcs

### ACA-321A Rotation damper

NEW

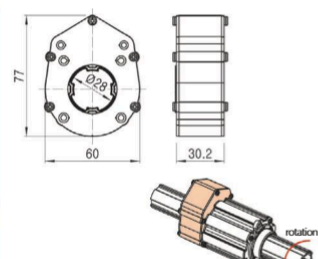

Aluminium: 402479

Weight: 141 g  
Packaging unit: 45 pcs

### Application examples ACA-309A

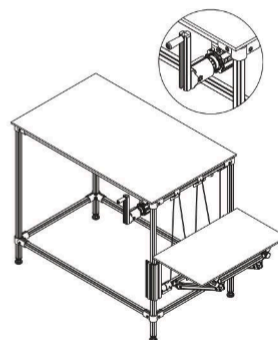

### Attachment joints

- various aluminium attachment joints

Universal connection!

### A-023 Attachment joint as stopper

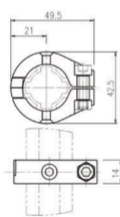

Aluminium: 119042

Weight: 17 g  
Packaging unit: 300 pcs

### AA-023 Set of attachment joints as stopper



Aluminium: 120172

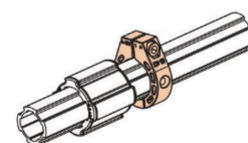

The set consists of following parts:

- 2 x A-023
- 1 x M0620, 1 x N06-55 W

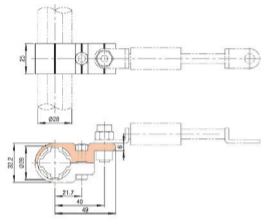
**A28-A301A** Attachment for gas spring

Weight: 27 g  
Packaging unit: 80 pcs

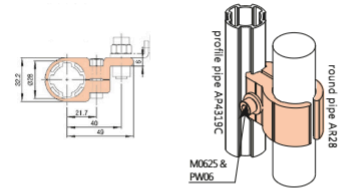
**A28-A301** Set of attachment joints for gas spring

The set consists of following parts:

- 1 x A28-A301A • 1 x A28-A301B
- 1 x M0625, 1 x N06-55 W

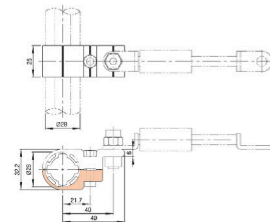
**A28-A301B** Attachment for gas spring

Weight: 19 g  
Packaging unit: 80 pcs

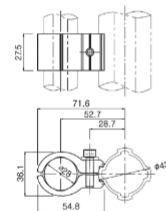
**APH-3027A** Attachment joint

Can be used with handle  
(black: Art. No. 126942, grey: Art. No. 126979)

Weight: 31 g  
Packaging unit: 200 pcs

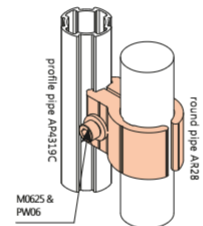
**APHA-3027** Set of attachment joints (profile pipe Ø43 mm)

The set consists of following parts:

- 1 x APH-3027A • 1 x APH-3027B
- 1 x M0625, 1 x US06

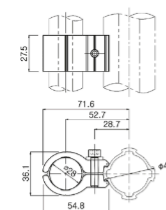
**APH-3027B** Attachment joint

Can be used with handle  
(black: Art. No. 126942, grey: Art. No. 126979)

Weight: 31 g  
Packaging unit: 200 pcs

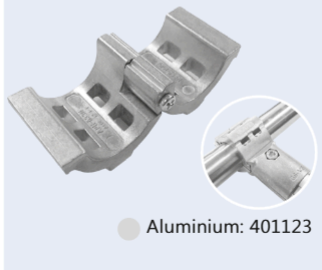
**APHA-633N** Attachment joint (round pipe)**Adaption**

- To combine aluminium profile pipe with round pipe

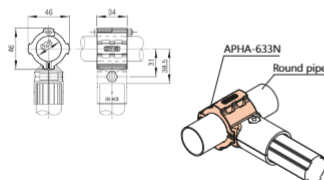

Weight: 111 g  
Packaging unit: 80 pcs



## Parallel joints

- Join parallel profiles and pipes
- Die-cast aluminium external clamping parallel joints to increase load-bearing capacity
- Easy, angled assembly on profile grooves

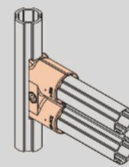

### A-009 Parallel joint

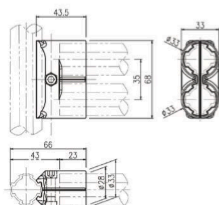

Weight: 50 g  
Packaging unit: 100 pcs

### AA-009 Set of parallel joints

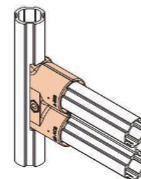

The set consists of following parts:

- 2 x A-009
- 1 x M0625, 1 x N06-55 W

### A-028 Parallel joint

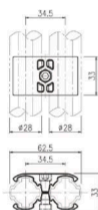

Weight: 24 g  
Packaging unit: 200 pcs

### AA-028 Set of parallel joints



The set consists of following parts:

- 2 x A-028
- 1 x M0625, 1 x N06-55 W

### B-008 Parallel joint

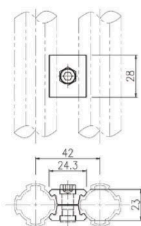

Weight: 9 g  
Packaging unit: 400 pcs

### BA-008 Set of parallel joints

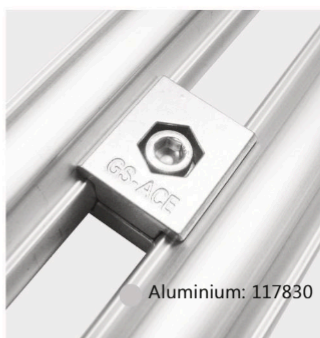

The set consists of following parts:

- 2 x B-008
- 1 x M0620, 1 x N06-55 W

### B-011 Parallel joint

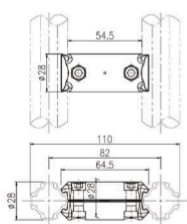

Weight: 30 g  
Packaging unit: 200 pcs

### BA-011 Set of parallel joints

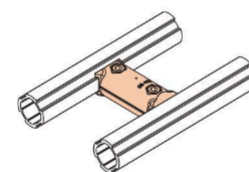

The set consists of following parts:

- 2 x B-011
- 2 x M0625, 2 x N06-55 W

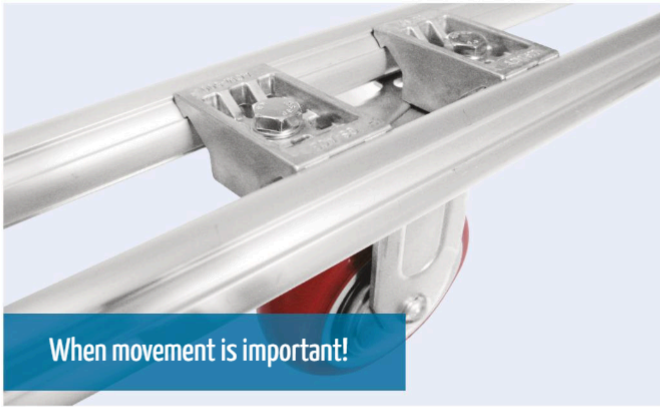

## Castor mounting

- Die-cast aluminium castor mount for attaching wheels
- Easy, angled assembly on profile grooves

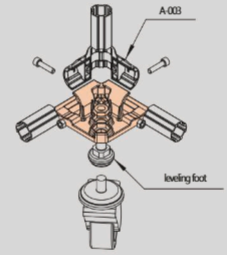

### ACM-500 Aluminium mounting for castors with 6 holes

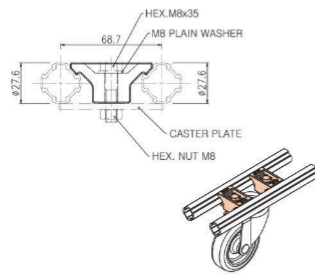

Weight: 54 g  
Packaging unit: 100 pcs

### ACM-500-S Support panel for castor mounting



- Support plate, in combination with ACM-500
- Application for smaller plates

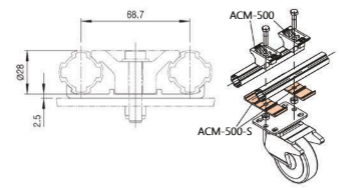

Weight: 47 g  
Packaging unit: 60 pcs

### ACB-B28B Corner joint for mounting of castors/feet

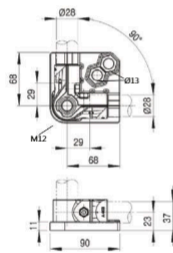

Weight: 208 g  
Packaging unit: 24 pcs

### ACBA-B28B Set of corner joints for mounting of castors/feet

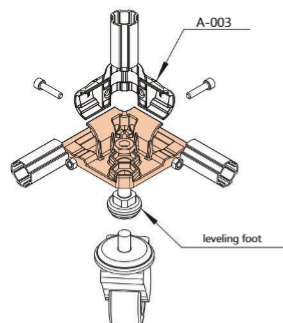

- ACB-B28B: 130867  
1x thread M12 (outer corner)  
2x bore D13

The set consists of following parts:

- 1 x ACB-B28B • 1 x A-003
- 2 x M0625 • 2 x N06-55



### Drive-in bushes

- M12 and M10 drive-in brushes with 1/2" thread for screwing in wheels or mounting brackets
- The aluminium and steel drive-in bushes have a great retention force in the pipe and conduct electricity

**BA2800A/B** Aluminium drive-in bush

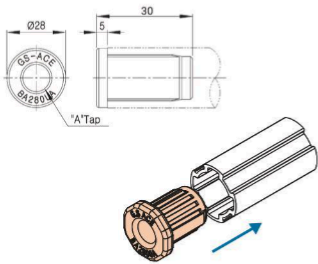

Weight: 94 g  
Packaging unit: 160 pcs

Art. No.	Name	Pipe	Ø Pipe	Threads	Material
117714	BA2800A	Aluminium	28 mm	1/2"-12N	Aluminium
117715	BA2800B	profile pipe		M12 x 1,75	

**BA280LA/LB/LD** Steel drive-in bush

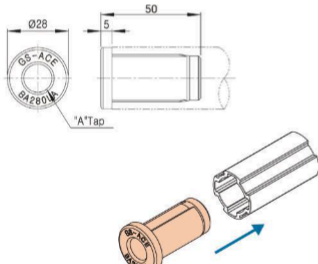

Weight: 94 g  
Packaging unit: 160 pcs

Art. No.	Name	Thread form	Pipe	Ø Pipe	Threads	Material
402039	BA280LA	○	Aluminium profile pipe	28 mm	1/2"-12N	Steel
402040	BA280LB	□			M12 x 1,75	
402041	BA280LD	⬡			M10	

**BC2810A/B/D** Steel drive-in bush

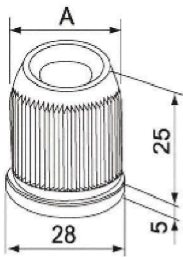

Art. No.	Name	Pipe	Ø Pipe	Threads	Material
100101	BC2810A	For pipe AL2820	28x2,2 mm	1/2"-12N	Steel
100102	BC2810B			M12 x 1,75	
100114	BC2810D			M10 x 1,5	

	Image	Name	AD* ID*	20.5 mm	20.4 mm	20.7 mm	23,5 mm	25,5 mm	23,5mm	25,3mm
Ø28mm Aluminium round pipe		AL2820	23.2 mm				✗		✗	
		AP2812	20.3 mm	✗	✗	✗				
		AP2820	20.3 mm	✗	✗	✗				
		AP2829	20.3 mm	✗	✗	✗				
		AP2812H	-							
		AD2812	20.3 mm	✗	✗	✗				
		AD2812H	-							
		AR2812	20.3 mm	✗		✗				
		AR2829	20.3 mm	✗		✗				
		AT2829	-							
		AGP-28A	-							
		AGP-28B	-							
		ALS2812	25.2 mm					✗		✗
		ACF2812	25.2 mm					✗		✗
		ALF2812	20.3 mm	✗	✗	✗				
		ATF2812	20.3 mm	✗	✗	✗				
		ASGP-08	20.3 mm	✗	✗	✗				
		AFS2812	20.3 mm	✗	✗	✗				
		AL2812	-							
		AP2812R	20.3 mm	✗	✗	✗				
		AQ2812	20.3 mm	✗	✗	✗				
	* ID = Inner diameter   OD = Outer diameter									