

70.00mm

113.00mm



USER MANUAL

### THANK YOU FOR PURCHASING THE TITANIC 3!

Before your first use of the device, read and follow the instructions carefully. It is recommended that these instructions are put in a safe place for future reference.

#### WARNINGS AND PRECAUTIONS:

The device is for aromatherapy and is not for the use of illegal substances and may only be used by adults over 18 years. It is not suitable for children, pregnant and lactating women, also not for people experiencing health problems. Keep away from children and pets. Any other use is inadmissible. The manufacturer/importer accepts no responsibility for damages caused by inappropriate, wrong or unreasonable use. Never use electronic devices near water. Never block or cover ventilation openings. Only use accessories which are also available from manufacturer and released for this product. Maintenance and repair should only be carried out by qualified personnel. To avoid electric shock, do not open the device by yourself. For safety reasons it is only allowed to have the device opened by qualified personnel. As long as the device is in

1

operation, do not leave it unattended. Seek medical help when adverse physical reactions occur during or after use.

**CAUTION!** Some parts - especially the Filling chamber - can get very hot. Do not touch or clean these parts until they have completely cooled down.

#### DISPOSAL:

Please dispose of the product in an environmentally friendly and responsible manner. In the interests of environmental protection, this device must not be disposed of with household waste. Disposal can be made through locally available return and collection systems.

2

### TITANIC 3 VAPORIZER OVERVIEW

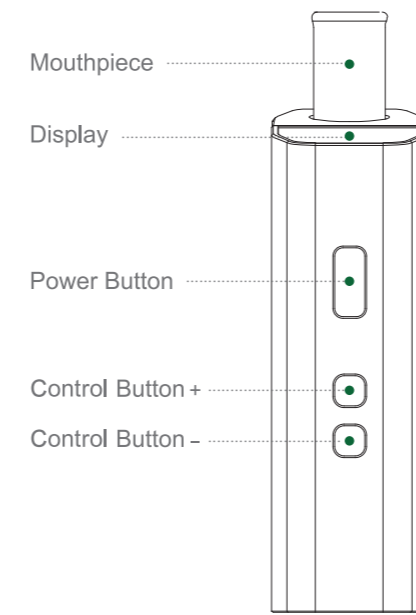

3

### INCLUDES



4

### IMPORTANT USAGE TIPS

- ▶ Turn the device on/off: Rapidly press power button 5 times on/off with vibration feedback.
- ▶ Press and hold power button and (-) button simultaneously for 2 seconds to change from Fahrenheit to Celsius degrees or from Celsius to Fahrenheit.
- ▶ Temperature 160-221°C / 320-430°F: the device vibrates when the temperature is reached.
- ▶ Working time: press and hold power button for 2 seconds until the cursor position is under SET of timer. Then press the control button (+)/(-) to adjust working time from 180 to 360 seconds.
- ▶ Display indicates temperature information, battery status and duration timer.
- ▶ Quick battery check: briefly press the power button when device is off, the icon on screen will show remain battery level.

5

### HOW TO LOAD WITH DRY HERB

- Slip off mouthpiece from the device.
- Loosely Dry Herb. Load choice dry herb loosely into heating chamber. Do not overfill.
- Attach the mouthpiece back to device.

6

### DISPLAY INDICATION

- 
- FAHRENHEIT DISPLAY**  
Default display is Fahrenheit. Mark SET (page 5) to select the temperature.
- 
- CELSIUS DISPLAY**  
Mark SET (page 5) to select the temperature.
- 
- TIME DISPLAY**  
Mark SET (page 5) to select the operating time.

7

### HOW TO REPLACE THE MOUTHPIECE FILTER

- Remove mouthpiece from the device.
- Pull out the filter.
- Insert the filter into mouthpiece.

8

### HOW TO CLEAN AIR PATH

- Pull out the chamber remove tool from device.
- Poke the chamber filter from the small opening.
- Use the air path clean brush to sweep the remaining residue from air path. Dry it before reassemble it onto chamber.

**CAUTION:** Apply light pressure to the chamber filter removal tool to remove the chamber filter. Make sure there are no people nearby and keep the chamber away from you to avoid injury!

9

### CHARGING INSTRUCTIONS

- ▶ Battery capacity 2300 mAh, regular USB charging, micro 5V/1.5A suggested.
- ▶ Initially charge the TITANIC 3 for 2 hours. The battery will stop charging when the icon is full.
- ▶ When battery level is low, charge battery with included micro USB cable to compatible wall charger. Low battery level will be indicated with icon .
- ▶ Do not use while charging.

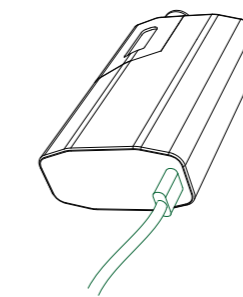

10



<https://www.puri5.com/>

