

Snow Pusher 7'/9' SS

Model:TMG-SP07/09



- Please read the product manual completely before assembly
- Check against the parts list to make sure all parts are received
- Wear proper safety goggles or other protective gears while in assembly

Missing parts or questions on assembly?

Please call: 1-877-761-2819 or email: cs@tmgindustrial.com

Do not return the product to dealer, they are not equipped to handle your requests

Model	TMG-SP07	TMG-SP09
Working Width	82"	108"
Tare Weight	513lbs	683lbs
Power Required	40-70HP	40-70HP

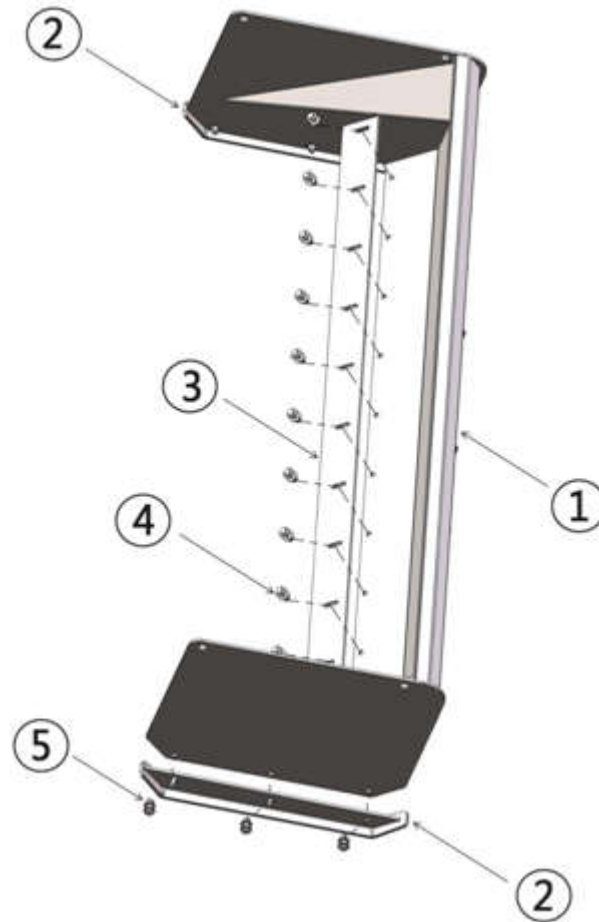

TMG-SP07/SP09 Snow Pusher components list			
Part Number	Description	QTY	
		TMG-SP07	TMG-SP09
1	Main frame welding component	1	1
2	Slide rail plate welding component	2	2
3	Knife plate	1	1
4	Pressure plate M16 x 40mm	8	11
5	Hexagonal bolt M16 x 45mm(8.8series)	6	6