

## 72-IN SKID STEER HYDRAULIC BRUSH CUTTER

MODEL: TMG-SBC72

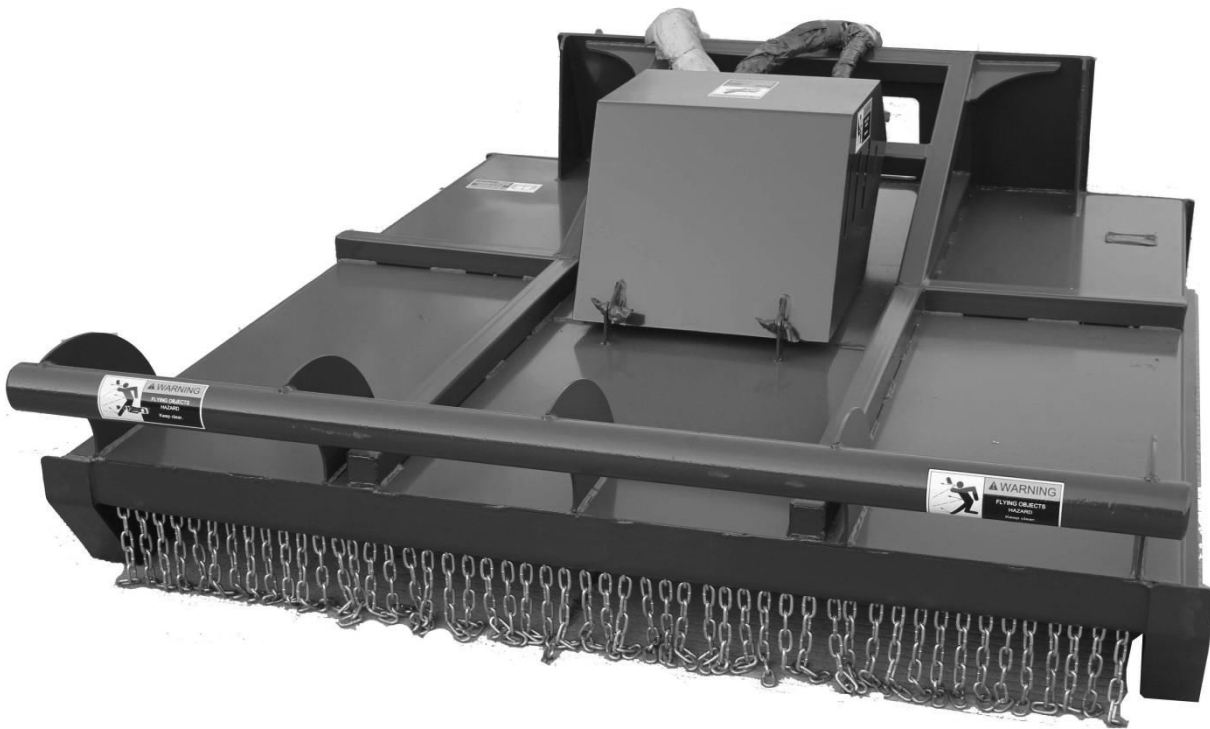

- Please read the product manual completely before assembly
- Check against the parts list to make sure all parts are received
- Wear proper safety goggles or other protective gears while in assembly

Missing parts or questions on assembly?

Please call: 1-877-761-2819 or email: [cs@tmgindustrial.com](mailto:cs@tmgindustrial.com)

Do not return the product to dealer, they are not equipped to handle your requests

# TABLE OF CONTENTS

---

TO THE OWNER.....	2/13
SAFETY PRECAUTIONS.....	3/13
BRUSH CUTTER ASSEMBLIES.....	7/13
OPERATION INSTRUCTIONS.....	10/13
MAINTENANCE INSTRUCTIONS.....	11/13
STORAGE INSTRUCTIONS.....	12/13
SPECIFICATIONS.....	13/13

# TO THE OWNER

---

## GENERAL COMMENTS

Congratulations for having this brush cutter! Your cutter was carefully designed and manufactured to give you years of dependable service. Your cutter will require some minor maintenance (such as cleaning) to keep it in top working condition. Be sure to observe all safety precautions and maintenance procedures as described in this manual.

## ABOUT THIS MANUAL

This manual has been designed to help you do a better and safer job. Read this manual carefully and become familiar with its contents. Remember, never let anyone operate this unit without reading the "Safety Precautions" and "Operation Instructions" sections of this manual. Unless noted otherwise, right and left sides are determined from the position of the skid steer operator sitting in the seat facing forward.

## SERVICE

When service your brush cutter, pls. remember to use only manufacturer replacement parts. Substitute parts may not meet the standards required for safe, dependable operation. To facilitate parts ordering, pls. record the model No. and serial No. of the metal plate on your unit.

# SAFETY PRECAUTIONS

---

The brush cutters are designed to be easy to use and maintain. They are operated by the skid steer auxiliary hydraulics. The cutters mount to the toolbar or quick attach mechanism for easy mounting.

## BEFORE OPERATION

- 1.1 Understanding all security labels, and keeping the tags clean, please do not casually graffiti, remove or damage any security labels, such as damage or writing fuzzy should be replaced immediately.
- 1.2 Ensure the brush cutter is installed firmly, replace possible broken parts, and ensure all hydraulic joints and hydraulic devices are firmly connected.
- 1.3 Check all the hydraulic hoses system is leaked or not.
- 1.4 Test the motion of brush cutter before operate, ensure the normal use.
- 1.5 Familiar with the performance, parameters and rotation of the device.
- 1.6 Require the working condition flat, and no hard material in the grass.
- 1.7 Must stop the skid steer loader and brush cutter before maintenance.
- 1.8 Mustn't modify the brush cutter by any kind of way!

## TO THE OPERATOR

**WARNING!**  Before leaving the operator's seat: Lower the lift arms against frame and place unit on the ground. Disengage auxiliary hydraulics. Stop Engine. Engage parking brake. Remove the key.

**DANGER!**  **ROTATING BLADE HAZARD! STAY BACK!**  
**OBJECTS CAN BE THROWN!**  
DO NOT operate near bystanders.  
DO NOT place hands or feet under deck while in operation or with engine running.  
DO NOT operate without a shatterproof door (or front shield) installed on loader.

# SAFETY PRECAUTIONS

These are common practices that may or may not be applicable to the products described in this manual.

## Safety at All Times

Thoroughly read and understand the instructions given in this manual before operation. Refer to the "Safety Label" section, read all instructions noted on them.

Do not allow anyone to operate this equipment who has not fully read and comprehended this manual and who has not been properly trained in the safe operation of the equipment.

- ▲ The operator must not use drugs or alcohol as they can change the alertness or coordination of that person while operating equipment. The operator should, if taking over-the-counter drugs, seek medical advice on whether he/she can safely operate the equipment.
- ▲ Operator should be familiar with all functions of the unit.
- ▲ Make sure all guards and shields are in place and secured before operating implement.
- ▲ Keep all persons away from equipment and work area.
- ▲ Start skid steer with steering levers and hydraulic controls in neutral.
- ▲ Operate implement and loader arms from the driver's seat only.
- ▲ Dismounting from a moving unit can cause serious injury or death.
- ▲ Do not allow anyone to stand between skid steer and implement while hooking-up to implement.
- ▲ Keep hands, feet, and clothing away from power-driven parts.
- ▲ Watch out for objects overhead and along side such as fences, buildings, wires, trees, limbs, etc., while transporting and operating attached implement.
- ▲ Detach and store implement in an area where children normally do not play. Secure implement by using blocks and supports.

## Look For The Safety Alert Symbol



The SAFETY ALERT SYMBOL indicates there is a potential hazard to personal safety involved and extra safety precaution must be taken. When you see this symbol, be alert and carefully read the message that follows it. In addition to design and configuration of equipment, hazard control, and accident prevention are dependent upon the awareness, concern, prudence, and proper training of personnel involved in the operation, transport, maintenance, and storage of equipment.

## Be Aware of Signal Words

A Signal word designates a degree or level of hazard seriousness. The signal words are:

### ▲ DANGER

Indicates an imminently hazardous situation which, if not avoided, will result in death or serious injury. This signal word is limited to the most extreme situations, typically for machine components that, for functional purposes, cannot be guarded.

### ▲ WARNING

Indicates a potentially hazardous situation which, if not avoided, could result in death or serious injury, and includes hazards that are exposed when guards are removed. It may also be used to alert against unsafe practices.

### ▲ CAUTION

Indicates a potentially hazardous situation which, if not avoided, may result in minor or moderate injury. It may also be used to alert against unsafe practices.

## For Your Protection

- ▲ Thoroughly read and understand the "Safety Label" section, read all instructions noted on them.

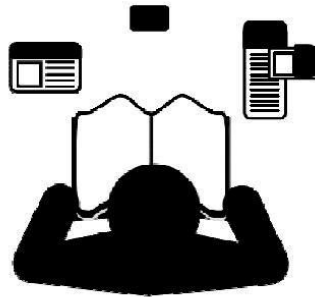

## Avoid Underground Utilities

### ▲ Dig Safe

- Always contact your local utility companies (electrical, telephone, gas, water, sewer, and others) before digging so that they may mark the location of any underground services in the area.
- ▲ Be sure to ask how close you can work to the marks they positioned.



# SAFETY PRECAUTIONS

These are common practices that may or may not be applicable to the products described in this manual.

## Shutdown and Storage

### Before leaving operator's seat:

- ▲ Lower lift arms and put attachment flat on the ground.
- ▲ Turn off engine and engage parking brake.
- ▲ If included, raise seat bar and move controls until both lock.
- ▲ Remove key to prevent unauthorized starting.
- ▲ Use steps, grab-handles and anti-slip surfaces when getting on or off the loader.
- ▲ Detach and store implements in an area where children normally do not play. Secure implement by using blocks and supports.

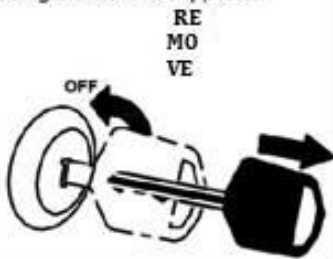

## Transport Safely

- ▲ Comply with state and local laws.
- ▲ Never travel at a speed which does not allow adequate control of steering and stopping. Some rough terrains require a slower speed.
- ▲ Avoid contact with any over head utility lines or electrically charged conductors.
- ▲ Always drive with load on end of loader arms low to the ground.
- ▲ Always drive straight up and down ramps with load on "uphill" side of skid steer.
- ▲ Engage parking brake when stopped on an incline.

- ▲ **IMPORTANT:** Do not tow a load That is more than double the weight of the vehicle towing the load.
- ▲ Use towing vehicle and trailer of adequate size and capacity. Secure equipment towed on a trailer with tie downs and chains.
- ▲ Sudden braking can cause a towed trailer to swerve and upset. Reduce speed if towed trailer is not equipped with brakes.



## Use Safety Lights and Devices

- ▲ Slow moving self-propelled equipment, and towed implements can create a hazard when driven on public roads. They are difficult to see, especially at night.
- ▲ Flashing warning lights and turn signals are recommended whenever driving on public roads.

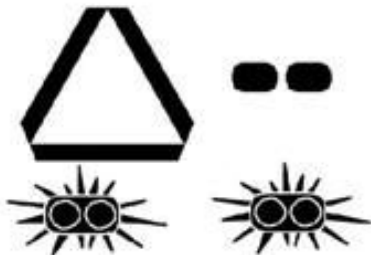

## Practice Safe Maintenance

- ▲ Understand procedure before doing work. Use proper tools and equipment, refer to Operator's Manual for additional information.
- ▲ Work in a clean dry area.
- ▲ Lower attached implement to the ground and follow all shutdown procedures before leaving the operator's seat to perform maintenance.
- ▲ Allow implement to cool completely before working on it.

- ▲ Disconnect battery ground cable (-) before servicing or adjusting electrical systems or before welding on implement.
- ▲ Do not grease or oil implement while it is in operation.
- ▲ Inspect all parts. Make sure parts are in good condition & installed properly.
- ▲ Remove buildup of grease, oil, or debris.
- ▲ Remove all tools and unused parts from implement before operation.



# SAFETY PRECAUTIONS

These are common practices that may or may not be applicable to the products described in this manual.

## Prepare for Emergencies

- ▲ Be prepared if a fire starts.
- ▲ Keep a first aid kit and fire extinguisher handy.
- ▲ Keep emergency numbers for doctor, ambulance, hospital, and fire department near phone.



## Wear Protective Equipment

- ▲ Wear protective clothing and equipment appropriate for the job. Clothing should be snug fitting without fringes and pull strings to avoid entanglement with moving parts.
- ▲ Prolonged exposure to loud noise can cause hearing impairment or hearing loss. Wear suitable hearing protection such as earmuffs or earplugs.
- ▲ Operating equipment safely requires the operator's full attention. Avoid wearing radio headphones while operating machinery.



## Avoid High Pressure Fluids Hazard

- ▲ Escaping fluid under pressure can penetrate the skin causing serious injury.
- ▲ Avoid the hazard by relieving pressure before disconnecting hydraulic lines or performing work on the system.
- ▲ Make sure all hydraulic fluid connections are tight and all hydraulic hoses and lines are in good condition before applying pressure to the system.
- ▲ Use a piece of paper or cardboard, NOT BODY PARTS, to check for suspected leaks.
- ▲ Wear protective gloves and safety glasses or goggles when working with hydraulic systems.
- ▲ **DO NOT DELAY.** If an accident occurs, see a doctor familiar with this type of injury immediately. Any fluid injected into the skin or eyes must be treated within a few hours or gangrene may result.



## Tire Safety

- ▲ Tire changing can be dangerous and should be performed by trained personnel using the correct tools and equipment.
- ▲ When inflating tires, use a clip-on chuck and extension hose long enough to allow you to stand to one side and NOT in front of or over the tire assembly. Use a safety cage if available.
- ▲ When removing and installing wheels, use wheel handling equipment adequate for the weight involved.



## Use Seat Belt and ROPS

- ▲ Operate only skid steers equipped with a Roll-Over Protective Structure (ROPS) and seat belt.
- ▲ Fasten seat belt snugly and securely to help protect against serious injury or death from falling and skid steer overturn.
- ▲ Wearing protective equipment such as safety shoes, safety glasses, hard hat, and ear plugs is highly recommended.



## Keep Riders Off Machinery

- ▲ Never carry riders or use Machinery as a person lift.
- ▲ Riders obstruct operator's view.
- ▲ Riders could be struck by foreign objects or thrown from the machine.
- ▲ Never allow children to operate equipment.



# BRUSH CUTTER ASSEMBLIES

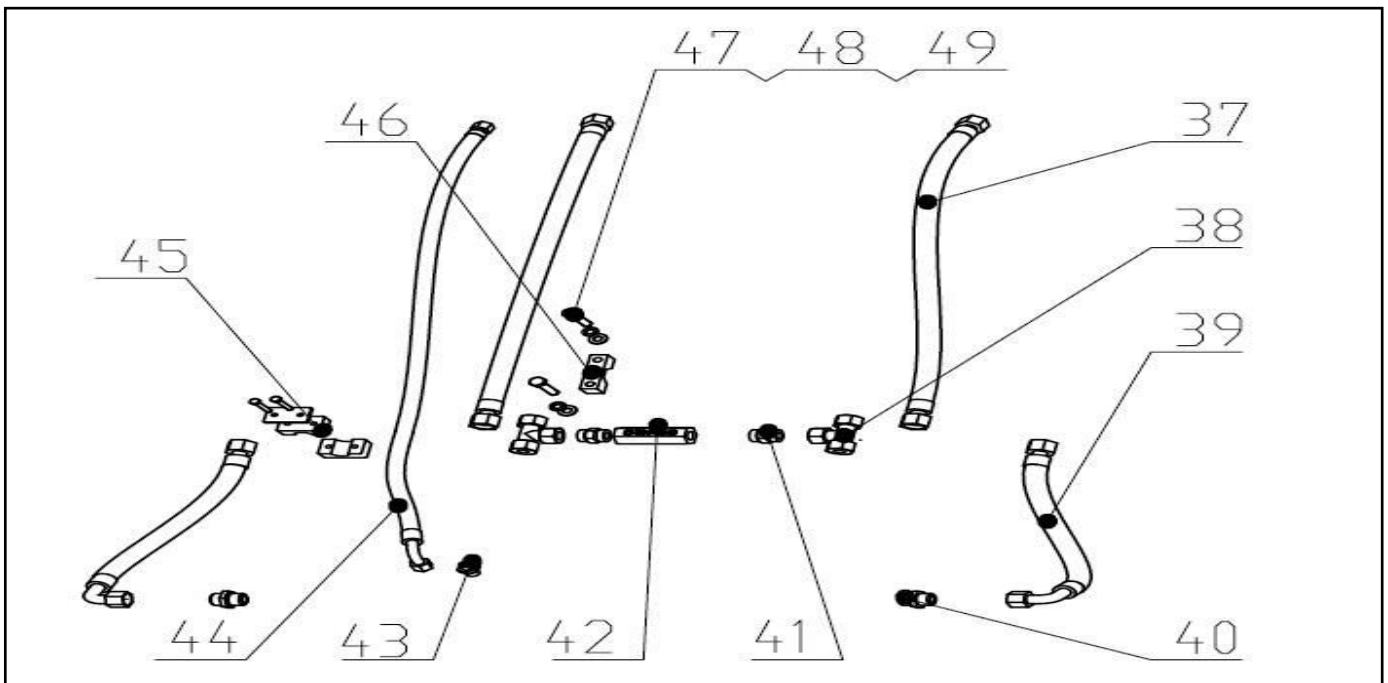
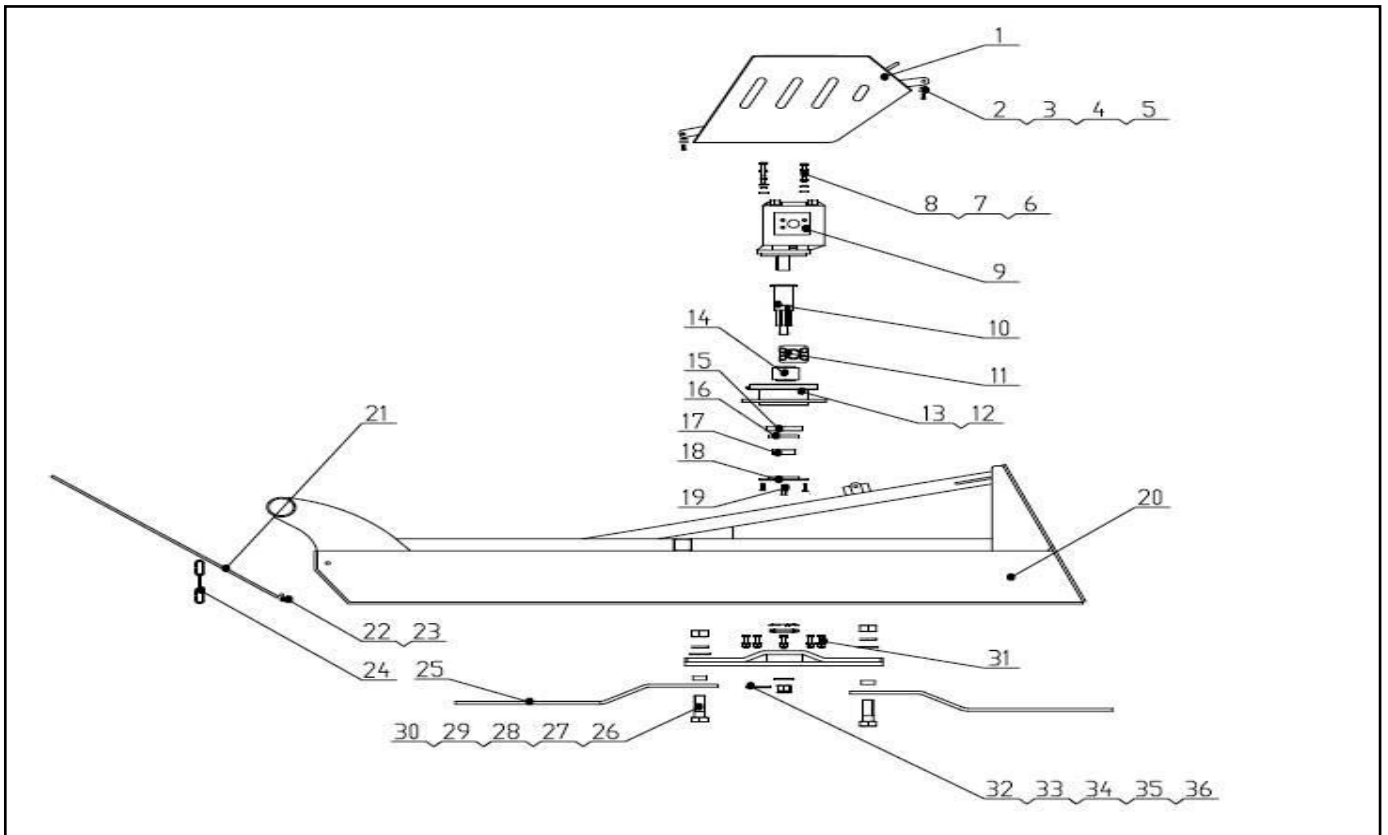



# BRUSH CUTTER ASSEMBLIES

S/N	PART NO.	PART DESCRIPTION	QTYS	NOTE
1	050872I-01	COVER	1	
2	050872I-02	BOLT M8*25	4	GB/T 5783-2000
3	050872I-03	FLAT WASHER D8	6	GB/T 5783-2000
4	050872I-04	SPRING WASHER D8	6	GB/T 93-1987
5	050872I-05	NUT M 8	6	GB/T 6170-2000
6	050872I-06	BOLT M12*45	12	GB/T 5783-2000
7	050872I-07	SPRING WASHER D12	12	GB/T 93-1987
8	050872I-08	FLAT WASHER D12	12	GB/T 97.3-2000
9	050872I-09	MOTOR	1	Motor Used Seals
10	050872I-10	SPLINED SHAFT	1	
11	050872I-11	JOINT	2	
12	050872I-12	BEARING SEAT	1	
13	050872I-13	GREASE NIPPLE	1	
14	050872I-14	BEARING	1	
15	050872I-15	OUTER BLOCK	1	
16	050872I -16	SEALING RING	1	
17	050872I -17	INNER BLOCK	1	
18	050872I -18	END CAP	1	
19	050872I -19	SCREW M8*25	8	GB/T 70.3-2000
20	050872I -20	FRAME	1	
21	050872I -21	CHAIN BEARING	1	
22	050872I -22	NUT M8	8	GB/T 6170-2000
23	050872I -23	FLAT WASHER D8		GB/T 5783-2000
24	050872I -24	CHAIN	62	
25	050872I -25	BLADE	2	
26	050872I -26	BOLT M30*90	2	GB/T 5783-2000

# BRUSH CUTTER ASSEMBLIES

---

27	050872I -27	BEARING SLEEVE	2	
28	050872I -28	FLAT WASHER D30	2	GB/T 97.3-2000
29	050872I -29	SPRING WASHER D30	2	GB/T 93-1987
30	050872I -30	NUT M30	1	GB/T 6170-2000
31	050872I -31	NUT M12	6	GB/T 6170-2000
32	050872I -32	SPLIT PIN	1	GB/T91-2000
33	050872I -33	SLOTTED HEX NUT M24	1	GB/T 9458-1988
34	050872I -34	GASKET	1	
35	050872I -35	ROUND NUT	1	GB/812-1988
36	050872I -36	STOP WASHER	2	GB/T858-1988
37	050872I -37	HOSE A	2	
38	050872I -38	TEE JOINT	2	
39	050872I -39	HOSE B	2	
40	050872I-40	JOINT A	2	
41	050872I-41	JOINT B	2	
42	050872I-42	CHECK VALVE	1	
43	050872I-43	JOINT C	2	
44	050872I-44	HOSE C	1	
45	050872I-45	HOSE CLAMP A	1	
46	050872I-46	HOSE CLAMP B	1	
47	050872I-47	BOLT M10*45	1	GB/T 5783-2000
48	050872I-48	FLAT WASHER D10	1	GB/T 97.3-2000
49	050872I -49	SPRING WASHER D10	1	GB/T 93-1987

## OPERATION INSTRUCTIONS

---

The brush cutter can cut off the tall grass and brush up to 2" in diameter.

1. Attach the cutter to the toolbar or quick attach mechanism of your skid steer loader, raise the back of the unit of the ground about 4" to allow the material to clear from under the cutting deck as you travel forward.
2. Place the front skid shoes 1-2inches off the ground. This is the preferred position for cutting grass and heavy vegetation. Never drive your skid steer loader with the front of the brush cutter tilted to the point your view is obstructed. Always make sure you can see what you are cutting.
3. Check the work area. Never operate the brush cutter in populated areas where thrown objects could injure persons or damage property. Never raise the unit and expose yourself or anyone else to the rotating blades. If you can see the blades then the back of the unit is raised too high.
4. Activate the auxiliary hydraulics with the engine at idle. Increase engine speed. Supply the power to the brush cutter, and let the hydraulic motor work.
5. Be sure the rotary cutter is operating smoothly and at full speed, and then slowly push the skid steer loader forward when the brush cutter monitoring the blade rotation.
6. Return the engine speed to idle and discharge the auxiliary hydraulics. Remove the brush cutter from debris.

**WARNING!**  Operating the standard flow rotary cutter on a high flow hydraulic system may cause severe injury or death to the operator or bystanders due to the increased RPM. Do NOT operate the standard flow rotary cutters on high flow hydraulic systems.

**WARNING!**  Lift limiting chain must be properly installed before operation.

## MAINTENANCE INSTRUCTIONS

---

1. Check the skid steer loader hydraulic system to ensure an adequate level of hydraulic oil every day.
2. Check all the fasteners loose regularly, and tighten them promptly every day.
3. Check the hydraulic system whether leak, if does, replace the new hose joints or hoses every day.
3. Check the parts whether damaged, and the solders whether crack, repair them if necessary every day.
4. Long-time use may let the cutting edge blunt and influence the working efficiency, and should grind the cutting edge or replace the new ones every day.
5. After work, should clean the weeds, debris of the disc in time, to keep the disc rotate flexibly every day.
6. Check the oil level of the motor once a week, fill as necessary with 80-90 weight gear lubricant. Remember don't overfill, as too much lubricant may rupture the motor seals.

### **WARNING!**



Escaping fluid under pressure can have sufficient force to penetrate the skin, causing serious personal injury. Fluid escaping from a very small hole can be almost invisible. Use a piece of cardboard or wood, rather than hands to search for suspected leaks.

Keep unprotected body parts, such as face, eyes, and arms as far away as possible from a suspected leak. Flesh injected with hydraulic fluid may develop gangrene or other permanent disabilities.

If injured by injected fluid, see a doctor at once. If your doctor is not familiar with this type of injury, ask him to research it immediately to determine proper treatment.

## **STORAGE INSTRUCTIONS**

---

- 1. Clean all the debris, all mud, dirt and grease.**
- 2. Replace all the blades at the same time and don't try to weld or straighten damaged blades; loss of integrity may result.**
- 3. Inspect the unit for bent, loose, cracked, damaged or missing parts, Order any parts required, and make the necessary repairs to avoid delays when starting next season.**
- 4. Tighten all loose nuts, bolts, screws and hydraulic connections.**
- 5. Touch up all the unpainted and exposed areas with paint to prevent rust.**
- 6. Replace security labels and tags if damaged, or in unreadable condition.**
- 7. Connect the hydraulic couplers together or use the oil nuts to block the hydraulic hoses.**
- 8. Check the motor for proper lubricant level.**
- 9. Apply a rust-preventive spray to all moving parts and to the bottom of the deck.**
- 10. Should put the device in the dry non-corrosive place. If in nude outside, will lessen the lifetime of the unit.**

## SPECIFICATIONS

---

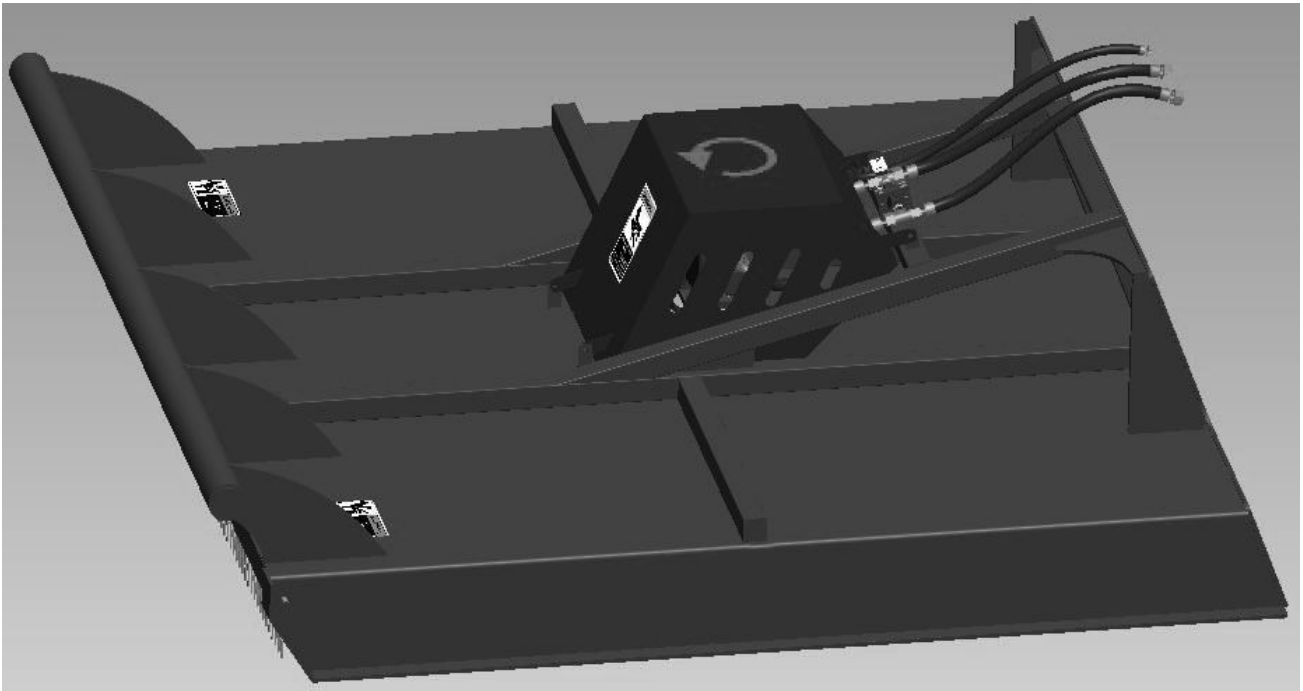

MODEL	TMG-SBC72
TOTAL LENGTH (MM)	2345
TOTAL WIDTH (MM)	2035
TOTAL HEIGHT (MM)	595
TOTAL WEIGHT (KGS)	575
CUTTING WIDTH (MM)	1830
MIN.CUTTING HEIGHT (MM)	≥50
SYSTEM FLOW (L/MIN)	60-80
MAX. PRESSURE (MPA)	21
CUTTING BLADE NUMBER (PCS)	2