

Pick-up Sweeper 72" SS

Model:TMG-PS72

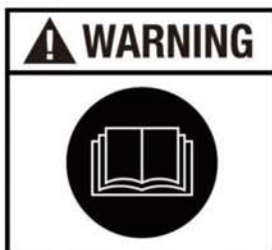

- Please read the product manual completely before assembly
- Check against the parts list to make sure all parts are received
- Wear proper safety goggles or other protective gears while in assembly

Missing parts or questions on assembly?

Please call: 1-877-761-2819 or email: cs@tmgindustrial.com

Do not return the product to dealer, they are not equipped to handle your requests

TABLE OF CONTENTS

GENERAL COMMENTS.....	2
SAFETY PRECAUTIONS	2
SAFETY DECALS.....	5
MAIN SPECIFICATIONS.....	6
SKID STEER REQUIREMENTS	7
IDENTIFICATIONS OF MAIN COMPONENTS.....	9
OPERATING INSTRUCTIONS	10
Attaching	
Check before operation	
Operation	
Dumping	
Disconnecting	
Transporting	
Storage	
MAINTENANCE	20
LONG TERM STORAGE.....	20
PARTS CHART	21

GENERAL COMMENTS

Congratulations on the purchase of a new Sweeper. This product has been designed and built to clean and handle all types of material including fine dirt, gravel, mud, millings and other debris. You or any other person who will be assembling, operating, maintaining, or working with this product are required to read and completely understand the information and instructions contained in this manual. If any questions about it, please obtain further assistance by contacting the dealer from which this product was purchased.

Your attachment was carefully designed and manufactured to give you many years of dependable service. Only minor maintenance (such as cleaning and lubricating) is required to keep it in top working condition. Be sure to observe all maintenance procedures and safety precautions in this manual, on the safety decals located on the attachment, and on any equipment on which the attachment is mounted.

The purpose of this manual is to assist in assembling, mounting, operating, and maintaining your Hydraulic Sweeper. It can help you to do a better, safer job. The manual covers models of 72"/560 and 72"/670. The difference between the models is the dimensions of the broom and hydraulic flow capacity of the product

Read this manual carefully, and become familiar with the operating procedures before attempting to operate your attachment.

The illustrations and data used in this manual were current at the time of printing, but due to possible engineering and/or production changes, this product may vary slightly in detail. Our company reserves the right to redesign and/or change components as may be necessary without notification to anyone.

REMEMBER: never let anyone operate this attachment without them having read and completely understand the "Safety " and "Operating Instructions" sections of this manual, or having them be fully trained by an experienced, qualified person who has read and completely understands the "Safety Precautions" and Operating Instructions".





SAFETY PRECAUTIONS

THE USE OF THIS EQUIPMENT IS SUBJECT TO CERTAIN HAZARDS WHICH CANNOT BE PROTECTED AGAINST MECHANICAL MEANS OR PRODUCT DESIGN. ALL OPERATORS OF THIS EQUIPMENT MUST READ AND UNDERSTAND THIS ENTIRE MANUAL, PAYING PARTICULAR ATTENTION TO SAFETY AND OPERATING INSTRUCTIONS, PRIOR TO USING THE HYDRAULIC ATTACHMENT. IF THERE IS SOMETHING IN THIS MANUAL YOU DO NOT UNDERSTAND, ASK YOUR SUPERVISOR TO EXPLAIN IT TO YOU. FAILURE TO OBSERVE THESE SAFETY PRECAUTIONS CAN RESULT IN DEATH OR SERIOUS INJURY OR SERIOUS EQUIPMENT DAMAGE.

 All bystanders should be kept a minimum of 10 feet (3 meters) away from working area of the attachment.

 **PROTECT AGAINST FLYING DEBRIS:** Always wear an OSHA approved hard hat and safety eye protection when operating or servicing this equipment. Do not wear loose fitting clothing, flopping cuffs, dangling neckties and scarves, or rings and wrist watches that can catch moving parts.

 An operator must not use drugs or alcohol which can change his alertness or coordination. An operator taking prescription or over-the-counter drugs should seek medical advise on whether or not he can safely operate equipment.

 Never alter or remove any safety decals or shields. Replace all missing or damaged safety decals or safety shields. Check this manual for location of these items and replace immediately if damaged or illegible.

 Never adjust a relief valve for pressure higher than recommended by vehicle manufacturer.

 Whenever changing or installing this or other attachments, make sure all connections are securely fastened. Travel only with the attachment in a safe transport position to prevent uncontrolled movement. Drive slowly over rough ground and on slopes. Remove attachment from vehicle when transporting to and from job site.

 **LOWER OR SUPPORT RAISED EQUIPMENT:** Before exiting vehicle, lower attachment to ground, turn off vehicle engine and lock vehicle brakes. Do not work under raised booms without supporting them. Do not use support material made of concrete blocks, logs, buckets, barrels or any other material that could suddenly collapse or shift positions. Make sure support material is solid, not decayed, warped, twisted, or tapered. Lower booms to ground level or onto blocks. Lower booms and

attachments to the ground before leaving the cab or operator's station.

 Never check a pressurized system for leaks with your bare hand. Oil escaping from pinhole leaks under pressure can penetrate skin and could cause serious infection. Hold a piece of cardboard up next to suspected leaks and wear a face shield or safety eye protection. If any fluid is injected into the skin, it must be removed immediately by a doctor familiar with this type of injury.

 Before disconnecting hydraulic lines or fittings, be sure to relieve all pressure by cycling all hydraulic controls after shutdown. Remember hydraulic systems are under pressure whenever the engine is running and may hold pressure after shutdown. Before applying pressure to the system make sure all connections are tight and that there is no damage to lines, fittings and hoses.

 Flow and pressure gauges, fittings and hoses must have a continuous operating pressure rating of at least 25% higher than highest pressures of the system.

 Avoid steep hillside operation which could cause the vehicle to overturn. Consult your vehicle operator's and safety manuals for maximum incline allowable.

 Never perform any work on an attachment unless you are authorized and qualified to do so. Always read the operator service manual(s) before any repair is made. After completing maintenance or repair, check for correct functioning of the attachment. If not functioning properly always tag "DO NOT OPERATE" until all problems are corrected.

 This manual covers the safe use, installation, operation and service instructions for the attachment only. Always read the operating and safety manuals prepared for your vehicle and any other attachments before using them.

EQUIPMENT SAFETY PRECAUTIONS

 **CAUTION!** Avoid pinch points and be aware of rotating parts when operating the attachments.

 **WARNING!** ROTATING OBJECTS!

- **Check your work area, for objects that could harm** the operator or others if thrown by the attachment. Remove these items before working.
- **Do not carry load with arms in the raised position.** Always carry loads close to the ground. Do not step off platform with load raised.
- Use extra care when loading or unloading the machine onto a trailer or truck.

- **Slow down before turning.** Sharp turns on any terrain may cause loss of control.
- **Always lower the loader arms to the ground,** shut off the engine and remove the key before getting off the unit.
- **Turn off engine before performing maintenance.** If lift arms must be left raised for maintenance or any other reason, use a positive lift arm lock to secure the arms in place. Serious damage or personal injury could result from lift arms accidentally lowering.

SAFETY DECALS

1、WARNING

READ AND UNDERSTAND OPERATING INSTRUCTIONS AND SAFETY INFORMATION PRIOR TO OPERATING YOUR ATTACHMENT.。

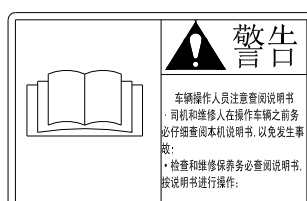

2、PINCH POINT HAZARD



3、FLYING OBJECTS HAZARD



4、HIGH PRESSURE FLUID HAZARD



MAIN SPECIFICATIONS:

SPECIFICATIONS	Standard PICK-UP	Standard PICK-UP
Model Number	TMG-PS72	72"/670
Working Width	1828 mm (72")	1828 mm (72").
Overall Width	2200 mm	2200 mm
Brush Diameter	22" (560mm)	26"(670mm)
Heaped Capacity	14.3 cu.ft (0.4 m ³)	14.3 cu.ft (0.4 m ³)
Cutting Edge on bucket	Bolt on, and replaceable full length cutting edge	Bolt on, and replaceable full length cutting edge
Number of Motors	1	1
Maximum Articulation	30°	30°
Hydraulic Flow Rate	42-95 L/min (12-25GPM)	45-95 L/min (12-25GPM)
Oil Pressure Range	16-21 MPa	16-21 MPa
Overall dimension L*W*H	1350*2200*630 mm	1560*2200*700 mm
Weight (approximate)	440 kg	585 kg

- SPECIFICATIONS AND DESIGN ARE SUBJECT TO CHANGE WITHOUT NOTICE AND WITHOUT LIABILITY THEREFOR.

NOTE: The illustrations and data used in this manual were current (according to the information available to us) at the time of printing, however, we reserve the right to redesign and change the brooms as may be necessary without notification.

SKID STEER LOADER REQUIREMENTS

The Sweeper is designed to attach to skid steers with the following minimum requirements:

- SAE Lift Capacity 1200 lbs.
- Hitch Type Universal Quick Attach Hitch
- Hydraulic Pressure Rating 1600 - 2200 PSI.
- Motors & Hoses 10 - 23 GPM.
- Hydraulic Hoses 3 - Hydraulic couplings: Inlet/Outlet/Case drain line
- **Connection:** *with Flat-Faced Couplers:*
 - 1/2" Flat-face Quick Coupling (male) & 1/2" Flat-face Quick Coupling (female)
 - 3/8" Flat-face Quick Coupling (female); (for case drain line if equipped on skid steer loader)

Caution:

DO NOT EXCEED 23 GALLONS PER MINUTE!!

Severe injury or death could occur due to the increased RPM.

CAUTION: NEVER store angle broom with weight on bristles. This will cause warping of bristles. ALWAYS store on stands keeping broom bristles off the ground.

DANGER! ROTATING PARTS HAZARD! STAY BACK!

OBJECTS CAN BE THROWN!

DO NOT operate near bystanders.

IMPORTANT: The attachments have been equipped with 3 hoses. Hose fittings and quick couplers to the skid steer loader are optional. If not purchased with it, they can be purchased from your dealer or local market. Make sure the couplers compatible to attach the unit to the skid-steer auxiliary hydraulic couplers, including the type, the dimensions and the quantities.



NOTE! DEALERS AND/OR OWNERS MUST DETERMINE THAT COMPATIBILITY BETWEEN THE SKID STEER LOADER AND ATTACHMENT EXISTS.

Compatibility includes, but is not limited to items such as operator clearance, hitch (mounting assembly) component strength, and hydraulics.

The 3rd hose and quick coupler for case drain line is only an option. It is only used for attaching to the skid steer loader equipped with Case drain line along its path to the sump/tank. If not equipped, then just remove the hose of the attachment.

⚠ ATTENTION

The 3rd hose (3/8") is designed to use in newer bobcat models. If your machine is not designed to have the 3rd hose, please disregard it, and plug the outlet.

The sweeper was supplied with hoses. Proper hose end fittings and/or quick couplers must be purchased as the hose threads.

Hose End Fittings:..... One hose end must be metric M18X1.5. The fitting for the other end can be whatever you determine to be the most beneficial to making the connection to your skid steer.

HOSE THREAD LIST

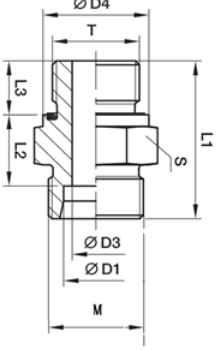
ATTACHMENTS	HOSE THREAD FOR HOSE FITTING (HOSE END) (connected with male & female G1/2" quick coupler)	HOSE THREAD FOR HOSE FITTING (HOSE END) OF THE 3 RD CASE DRAIN LINE <i>if equipped</i> (connected with female G3/8" quick coupler)	REMARKS 管与油口连接接头 IE-G-ED 端直通接头 
SWEEPER, ANGLE BROOM, 4 IN 1 BUCKET, BRUSH CUTTER	METRIC M18x1.5	METRIC M18x1.5	
VIBRATORY ROLLER	METRIC M26x1.5	METRIC M18x1.5	
TRENCHER	METRIC M22x1.5	METRIC M18x1.5	
RECOMMENDED MODELS OF QUIICK CUPLER	BRAND FASTER OR SIMILAR: 2FFI 12GAS_F 2FFI 12GAS_M	BRAND FASTER OR SIMILAR: 2FFI 38GAS_F	

IDENTIFICATIONS OF MAIN COMPONENTS

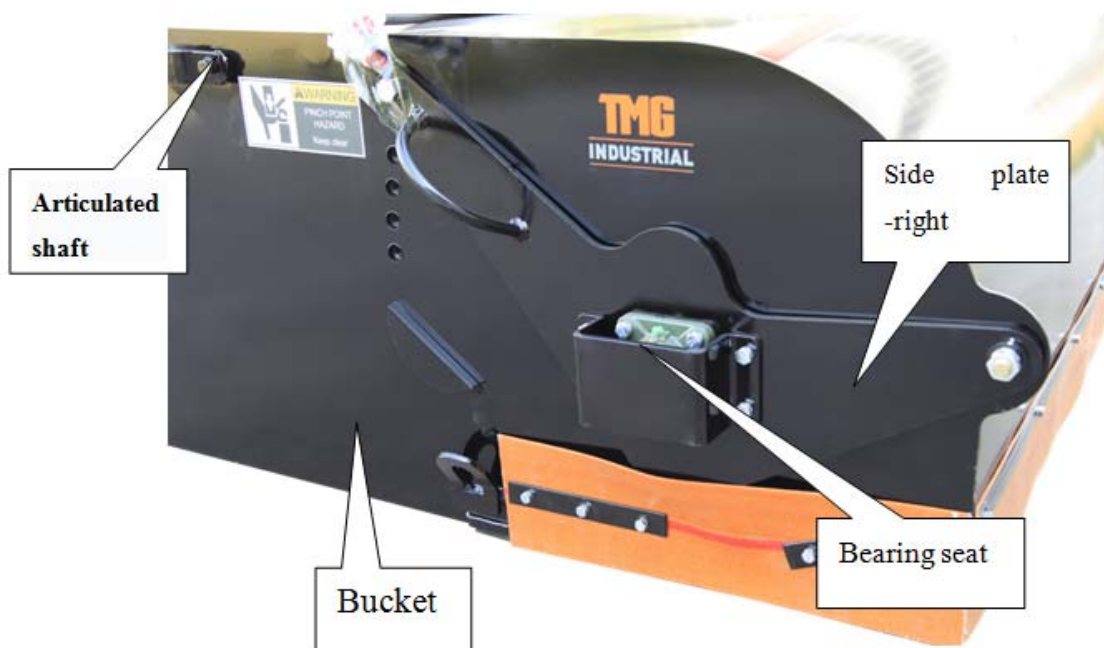
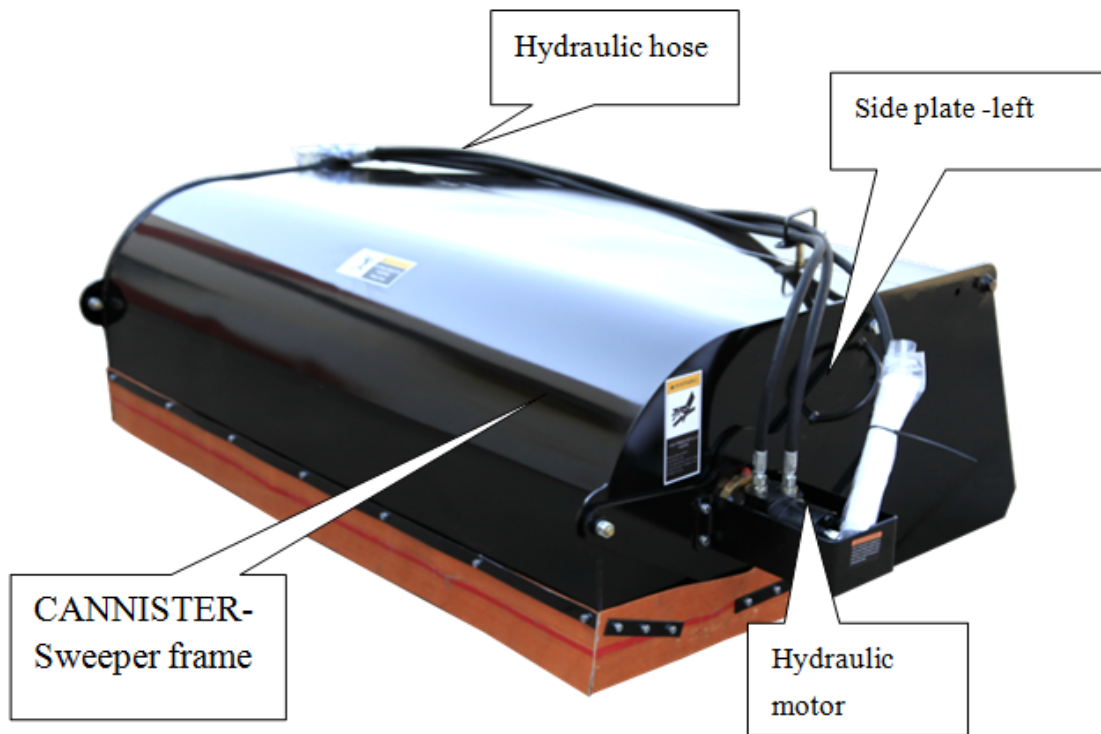

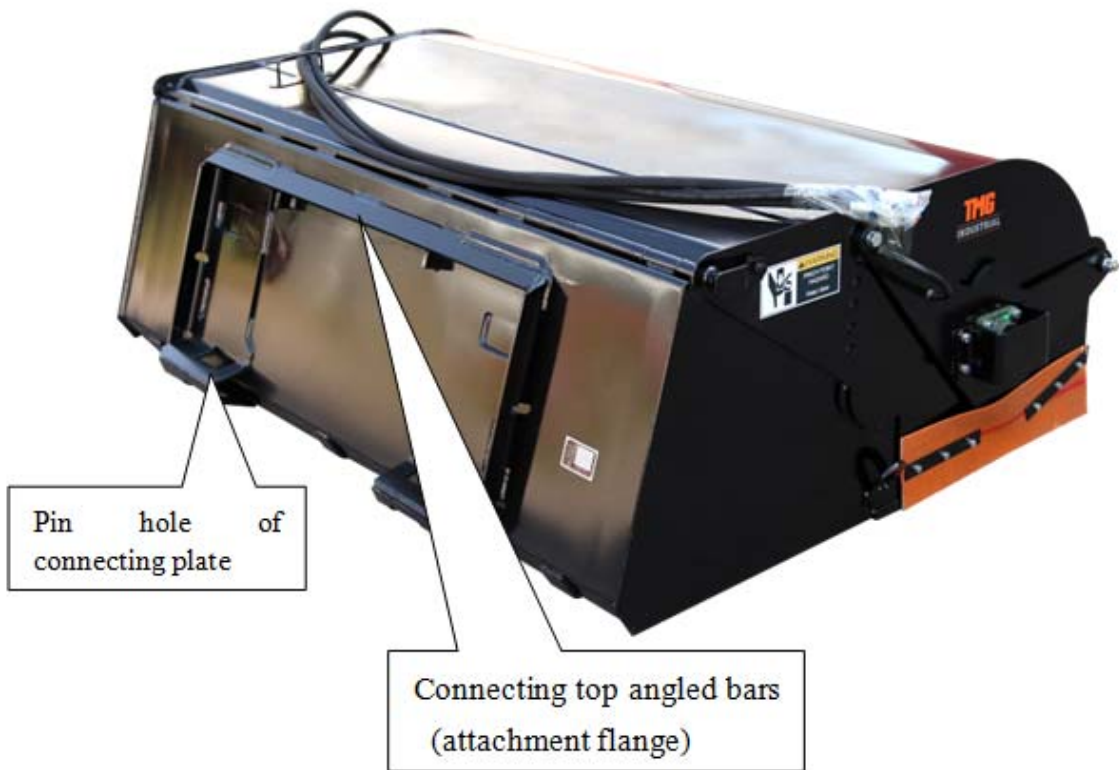
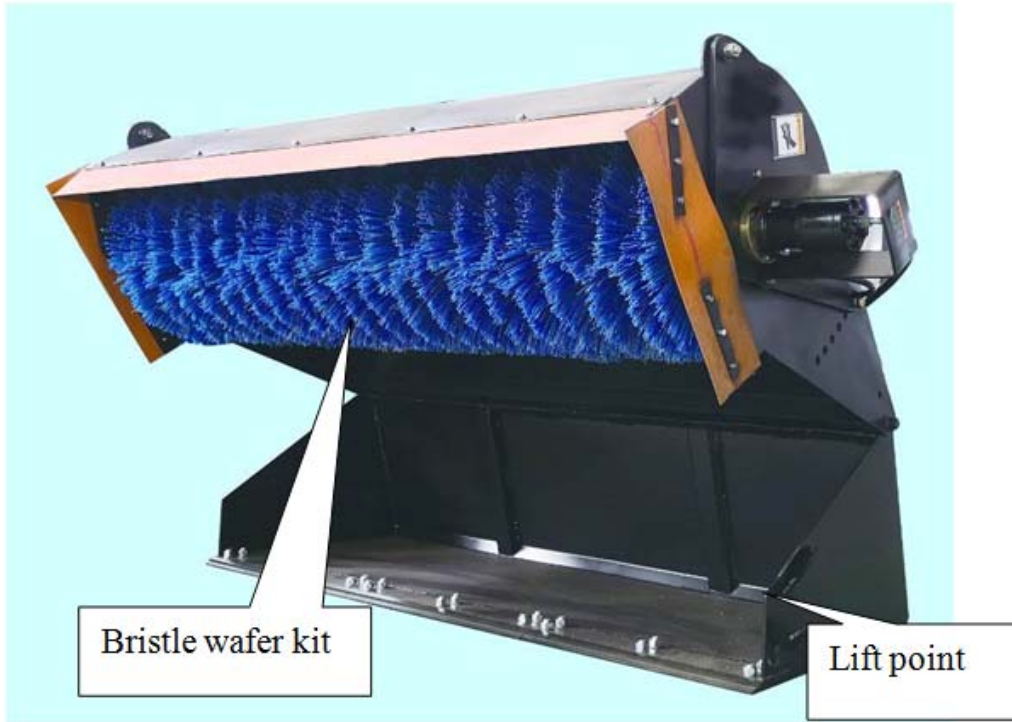

OPERATION INSTRUCTIONS:

*INSTALLATION INSTRUCTIONS

The installation of your ATTACHMENT is the same for any other powered attachment for your skid steer loader:

NOTE:

1. Remove any attachments from the front of the loader.
2. Following all standard safety practices and the instructions for installing an attachment in your skid-steer operator's manual, install the ATTACHMENT onto your skid-steer.

NOTE: It is important to make sure the locking mechanism on your quick attach is engaged, therefore locking the attachment onto the skid-steer.



DANGER

*A Crushing Hazard exists when hooking-up equipment. **Do not** allow anyone to stand between skid steer loader and implement while hooking-up to implement. **Do not** operate hydraulics while someone is near the skid steer loader or implement.*



CAUTION

Make sure your skid steer loader hitch is properly attached to the Sweeper hitch. It must be secured under the Sweeper top angle bars and loader hitch plate lock handles must be locked down with locking pins extending fully through bottom slots in the Sweeper hitch. An improperly attached Sweeper can come loose and fall.



WARNING

Never go underneath equipment (lowered to the ground or raised) unless it is properly blocked and secured. Never place any part of the body underneath equipment or between moveable parts even when the engine has been turned off. Hydraulic system leak down, hydraulic system failures, mechanical failures, or movement of control levers can cause equipment to drop or rotate unexpectedly and cause severe injury.

* ATTACHING TO SKID STEER LOADER:

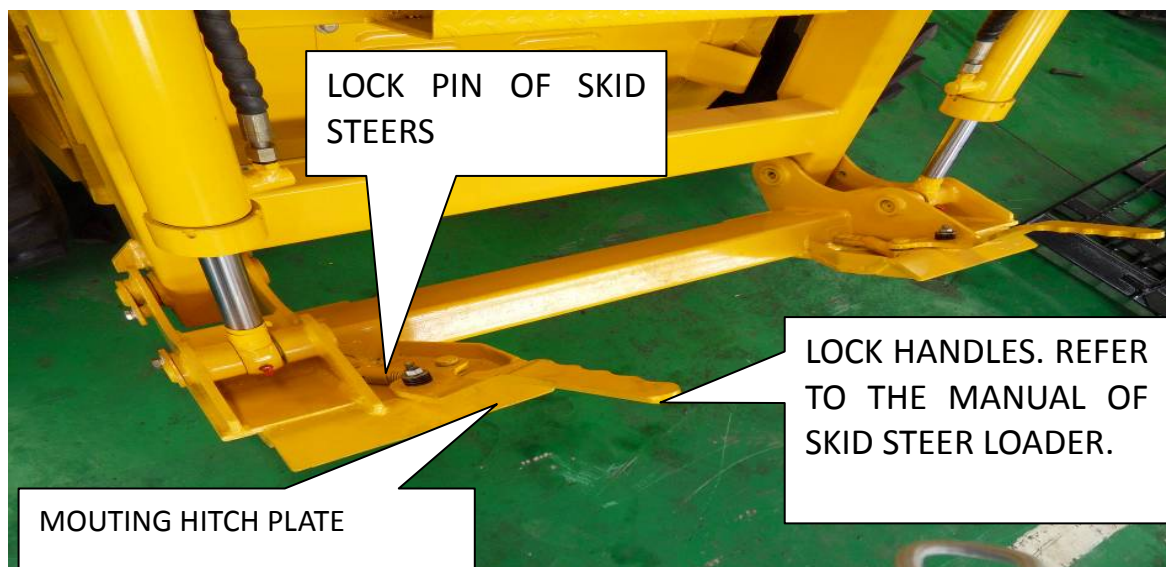

1. Check for and remove any debris in the hitch point areas before attaching to Sweeper to skid steer loader.

Read the skid steer operator's manual connecting and removing instructions.

Position hydraulic hoses so they will not be pinched when connecting the sweeper.

The skid steer lock handles should be in the unlocked position and the lock pins retracted.

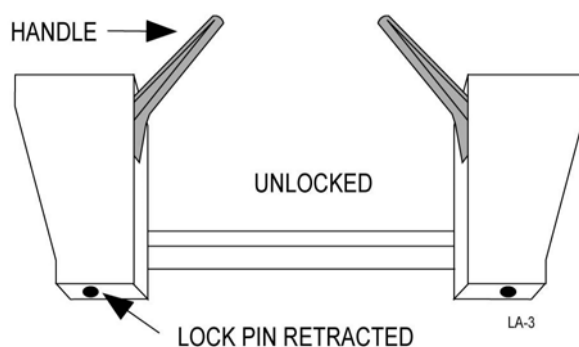

2. Drive skid steer loader slowly to the Sweeper and carefully align the skid steer to the sweeper, making sure hitch plate on the skid steer loader is parallel with the Sweeper's top angle bars.

3. Rotate top of skid steer loader tilt arms slightly forward.

4. Position top of skid steer loader hitch plate under the top angled bars and slowly raise loader hitch plate up until hitch plate is seated under the top angle bars (attachment flange). Lower skid steer lift arms to their lowest position.

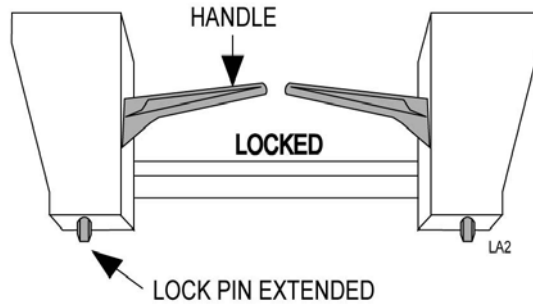

5. Rotate top of skid steer loader tilt arms back until Sweeper makes full contact with face of hitch plate so the lock handles can be engaged.

6. Push lock handles on the skid steer loader hitch down. Make sure lock pins go through bottom slots in the Sweeper hitch and handles are fully locked down.

The lock pins must be completely extended and secured into the slots provided on the sweeper.

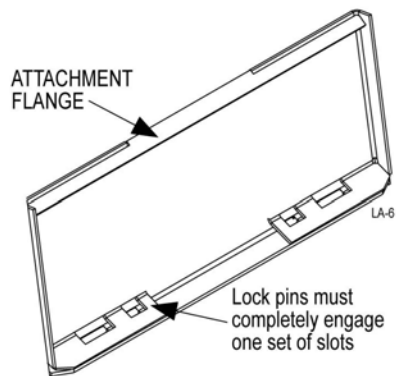

Hydraulic Hose Hook-up

Connect hydraulic hoses to skid steer auxiliary quick couplers.

2 or 3 quick couplers should be connected according to the equipment on the skid steer loader. If only 2 couplers are equipped on the skid steer without the case drain line, then just remove the 3rd one and plug the outlet port accordingly.



DANGER

Hydraulic fluid under high pressure can penetrate skin. Wear protective gloves and safety glasses or goggles when working with hydraulic systems. Use a piece of cardboard or wood rather than hands when searching for hydraulic leaks. If hydraulic fluid is injected into the skin or eyes, it must be treated by a doctor familiar with this type of injury within a few hours or gangrene may result. DO NOT DELAY.

IMPORTANT: Collect and dispose all oil spills and leaks in an environmentally safe manner.

IMPORTANT: Hose routing is the responsibility of the owner/operator of the Sweeper. Pinched and/or stretched hoses are not covered under the warranty.

IMPORTANT: Make sure all coupler fittings are clean before connecting them together.

Two high pressure hydraulic outlets are required for the hydraulic motor.

1. Route hydraulic hoses along the most convenient path to access your skid steer loader.
2. Clean quick connect couplers of dirt and then connect couplers to the skid steer couplers. Make sure quick connect couplers have fully engaged.

If they have not, check the following:

- a. Make sure couplers are same size and type.
- b. Make sure hydraulic pressure has been released.

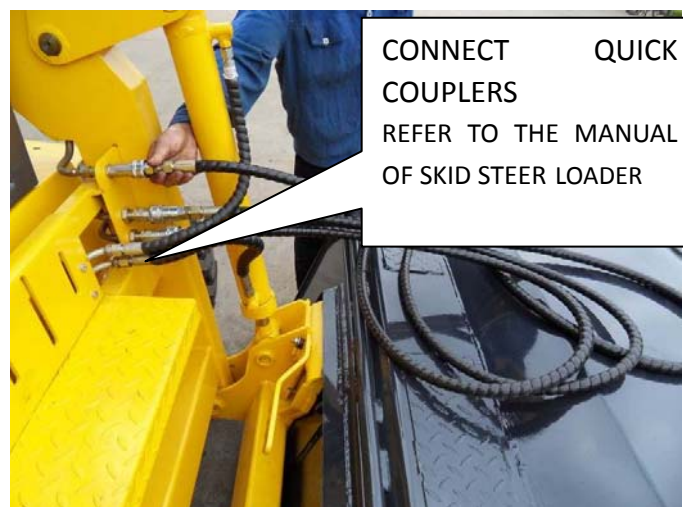

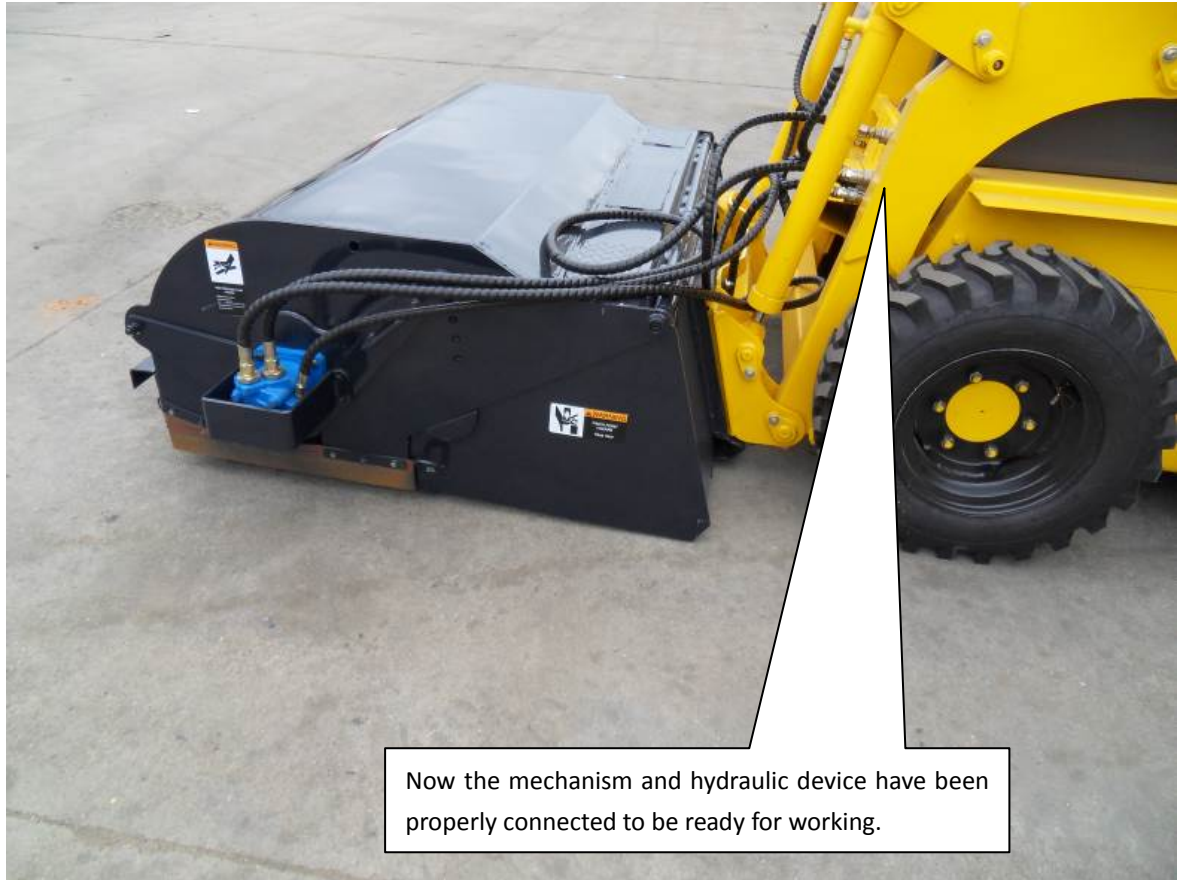

NOTE:

The ATTACHMENT attaches to the toolbar/quick-attach mechanism of your skid-steer loader. Due to this arrangement, thorough knowledge of the skid-steer controls is necessary for machine operation. Read and understand your skid steer operator's manual for information regarding skid-steer operation before attempting to use the ATTACHMENT.

Follow all installation instructions for the proper installation of the unit onto your skid-steer before attempting to operate your ATTACHMENT.

Check Equipment before operation

It is important to check clearance before putting the Sweeper into operation. Make sure hydraulic hoses are long enough and won't become pinched or entangled in the equipment.

1. Visually inspect hydraulic hoses for possible pinch points and shortness. If needed, make hose adjustments before putting equipment into service.
2. Start skid steer/tractor and raise loader arms high enough to tilt the hitch plate fully down without Sweeper making contact with the ground.
3. Fully extend and retract hydraulic cylinders on the end of the skid steer loader arms while watching for interferences between skid steer loader and Sweeper frame.
4. Raise skid steer/ loader arms fully up and repeat steps above.

IMPORTANT: Make sure hydraulic hoses are long enough and properly secured so that they do not become stretched or pinched through their full range of motions.

NOTICE:

- **Maximum oil flow is 25 gpm (94.8 liters/min) at 3000 psi (206.8 bars). See the skid steer manual for oil flow specifications.**

Before Each Use

Run the sweeper with the skid steer at a slow idle. Check for hydraulic leaks or other problems and make corrections, if necessary, before using the sweeper

During Use

Carry the sweeper low to the ground so that the operator has good visibility and stability. Avoid any sudden movements. Avoid excessive downward pressure on the brush sections to prevent excessive wear. A two to four inch wide pattern for the broom is sufficient for most applications. Ensure that the adjustment bolts are equally adjusted in order to prevent an uneven wear pattern.

5. Rotate top of skid steer loader tilt arms back until Sweeper makes full contact with face of hitch plate so the lock handles can be engaged.
6. Push lock handles on the skid steer loader hitch down. Make sure lock pins go through bottom slots in the Sweeper hitch and handles are fully locked down.

The lock pins must be completely extended and secured into the slots provided on the sweeper.

Check Equipment before operation

It is important to check clearance before putting the Sweeper into operation. Make sure hydraulic hoses are long enough and won't become pinched or entangled in the equipment.

1. Visually inspect hydraulic hoses for possible pinch points and shortness. If needed, make hose adjustments before putting equipment into service.
2. Start skid steer/tractor and raise loader arms high enough to tilt the hitch plate fully down without Sweeper making contact with the ground.
3. Fully extend and retract hydraulic cylinders on the end of the skid steer loader arms while watching for interferences between skid steer loader and Sweeper frame.
4. Raise skid steer/ loader arms fully up and repeat steps above.

IMPORTANT: Make sure hydraulic hoses are long enough and properly secured so that they do not become stretched or pinched through their full range of motions.

NOTICE:

- **Maximum oil flow is 25 gpm (94.8 liters/min) at 3000 psi (206.8 bars). See the skid steer manual for oil flow specifications.**

Before Each Use

Run the sweeper with the skid steer at a slow idle. Check for hydraulic leaks or other problems and make corrections, if necessary, before using the sweeper

During Use

Carry the sweeper low to the ground so that the operator has good visibility and stability. Avoid any sudden movements. Avoid excessive downward pressure on the brush sections to prevent excessive wear. A two to four inch wide pattern for the broom is sufficient for most applications. Ensure that the adjustment bolts are equally adjusted in order to prevent an uneven wear pattern.

Operation of sweeping

The sweeper is capable of, and in fact intended to be utilized for, sweeping away dirt, light snow and other debris. Directions for use are as follows:

1. Start the skid steer at idle speed and raise the brush head.
2. Use low engine speeds to save wear and tear on the sweeper and to prevent dust from billowing up during sweeping.

NOTE: Do not engage the brush at high engine speeds. This damages the sweeper and motor.

3. Engage the brush head and lower it to the ground.
4. Gradually increase skid steer engine rpm to sweeping speed.
Travel forward at 5 mph or less.

NOTICE

■ **Shifting brush rotation from forward to reverse while the brush is rotating damages the sweeper and motor.**

5. When sweeping forward, rotate the brush so debris goes over the brush and into the bucket.

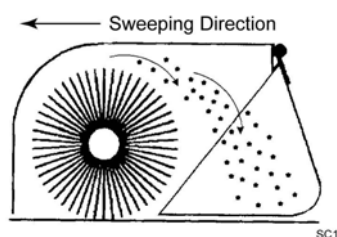

6. When sweeping in reverse, rotate the brush so debris is pushed into the bucket, similar to sweeping into a dustpan.

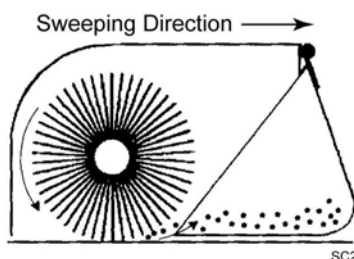

7. If necessary, install or replace plastic ties in flap holes to hold the front and sides together.

SLOW DOWN!!

Directing Debris

Observe wind direction. Sweeping with the wind makes sweeping more effective and helps

keep debris off the operator.

Dirt and Gravel

To keep dust at a minimum, plan your sweeping for days when it is overcast and humid, or after it has rained. Also, sweep so the wind blows at your back or in the direction the brush head is angled.

Low brush speeds and moderate ground speeds work best for cleaning debris from hard surfaces. Brush speeds that are too fast tend to raise dust because of the aggressive sweeper action.

To sweep gravel, use just enough brush speed to roll gravel, not throw it.

Heavy Debris

For two inches or more of heavy debris, medium/high and ground speeds of less than five mph are recommended. Sweep path less than the full width of the broom. Increase engine speed if debris becomes very heavy.

Transporting

Always follow safety rules, carry low to ground and travel slowly.

Only raise a load when dumping.

Dumping Loads

Transport to dumping location before raising. Only dump load while on a firm level surface.

Slowly raise load to required dumping height. Rotate pick-up broom forward to empty the bucket.



Dump Position

Unhooking Sweeper

1. Park skid steer loader on a flat, level, solid surface, and lower Sweeper onto the ground.
2. Place transmission in park, set park brake, shut engine off, release operator restraint and remove switch key.
3. With Sweeper resting on the ground, release all hydraulic system pressures before disconnecting hydraulic hoses from skid steer loader. See Skid Steer Operator's Manual for instructions on how to release skid steer hydraulic system pressures.
4. Disconnect hydraulic hoses from skid steer loader quick couplers. Install dust plugs and couple hoses together for storage. Store hoses on the Sweeper frame to keep dirt away from the couplings.
5. Pull lock handles up allowing lock pins to clear bottom slots in hitch plate.
6. Return to skid steer loader and tilt top of loader hitch slightly forward towards the Sweeper.
7. Slowly lower skid steer loader hitch plate until top angle bars and hitch plate have separated.
8. Back skid steer loader slowly away from the Sweeper

STORAGE



Keep brush away from intense heat or flame. Brush material can ignite and burn.

Keep children and bystanders away from storage area.

■ **Do not store polypropylene brushes in direct sunlight. The material can deteriorate and crumble before the bristles are worn out.**

■ **Do not store the broom with weight on the brushes. Weight will deform them, destroying the sweeping effectiveness.**

Inspect the sweeper thoroughly and prepare for storage. Repair or replace any damaged components.

Remove the sweeper from Skid Steer, page 15. Place on blocks to prevent brush damage.

Clean and cover hose ends, fittings, and hydraulic ports.

MAINTENANCE

- Make sure that all nuts and bolts are in place and properly tightened.
- Make sure that all other fasteners are in place and are performing their specified function.
- Make sure that all hydraulic fittings are tightened and that there are no leaks in any fittings or hoses.
- Replace any damaged parts and excessively worn parts.
- Grease all fittings after every ten hours of use.

GENERAL MAINTENANCE INFORMATION

If you detect a malfunction in either your Sweeper or skid steer loader during the operational safety check, immediately shut skid steer loader off, remove switch key, and make all necessary repairs and adjustments before continuing.

Proper servicing and adjustment is the key to the long life of any implement. With careful inspection and routine maintenance, you can avoid costly downtime and repair.

Check all bolts after using unit for several hours to be sure they are tight.

The parts on your Sweeper have been specially designed and should only be replaced with genuine parts. Do not alter the Sweeper in a way which will adversely affect its performance.

LONG TERM STORAGE

Clean, inspect, service, and make necessary repairs to the Sweeper when parking it for long periods and when parking it at the end of a working season. This will help ensure the Sweeper is ready for field use the next time you hook-up to it.

PARTS CHART FOR PICKUP SWEEPER

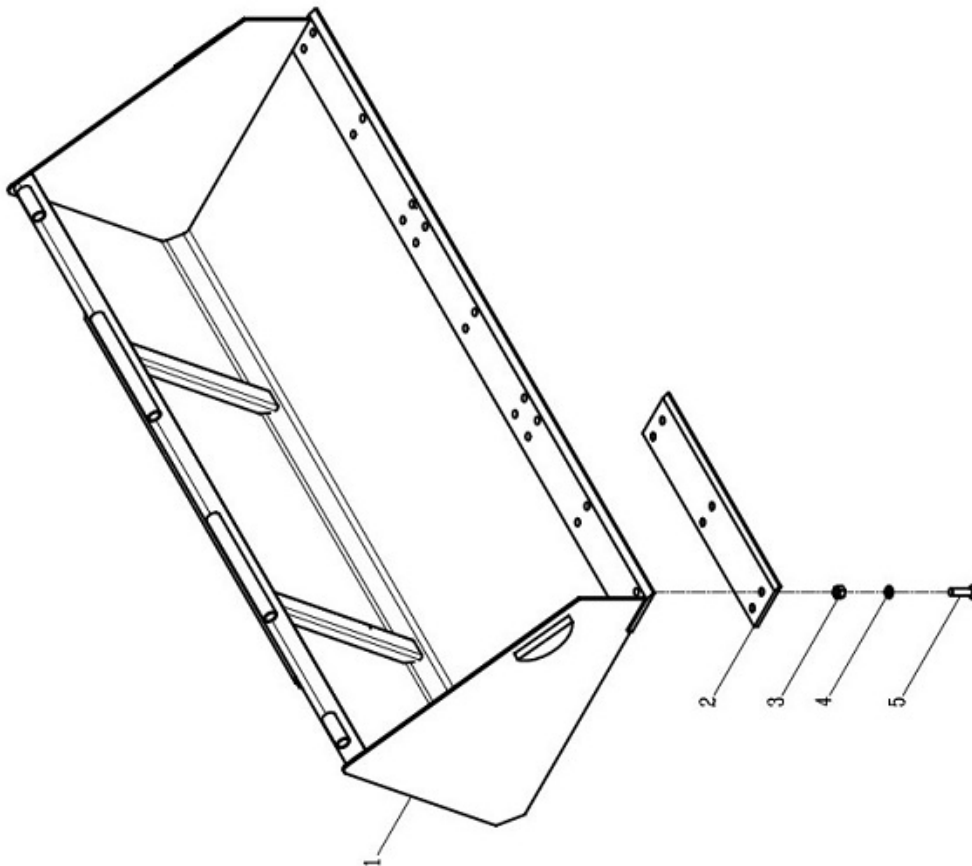

Part no.	Serial no.	Description	REQ'D Quantity/unit	remarks
A1	1856001	Bucket weldment	1	
A2	1856002	Removable Cutting Edge	3	
A3	1856003	Nut M16	18	
A4	1856004	Spring Washer 16	18	
A5	1856005	Screw M16x50	18	

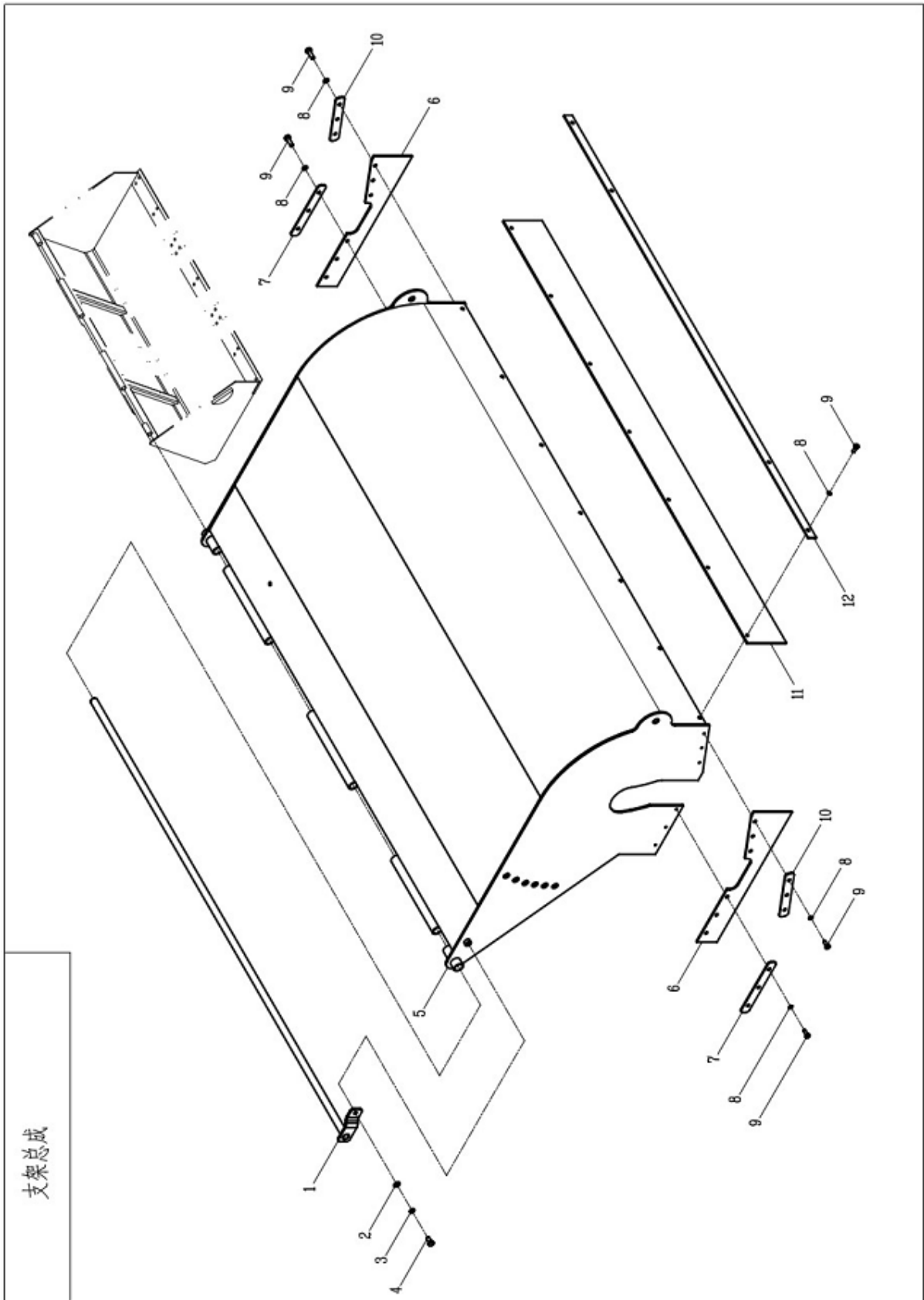

Part no.	Serial no.	Description	REQ'D Quantity/unit	remarks
B1	1856006	Rod hinge weldment	1	
B2	1856007	Flat Washer 10	1	
B3	1856008	Spring Washer 10	1	
B4	1856009	Bolt M10x20	1	
B5	1856010	Main frame weldment	1	
B6	1856011	Side Rubber Flap	2	
B7	1856012	Side strip	2	
B8	1856013	Spring Washer 8	19	
B9	1856014	Bolt M8x20	19	
B10	1856015	Front Side Strip	2	
B11	1856016	Front Rubber Flap	1	
B12	1856017	Front strip	1	

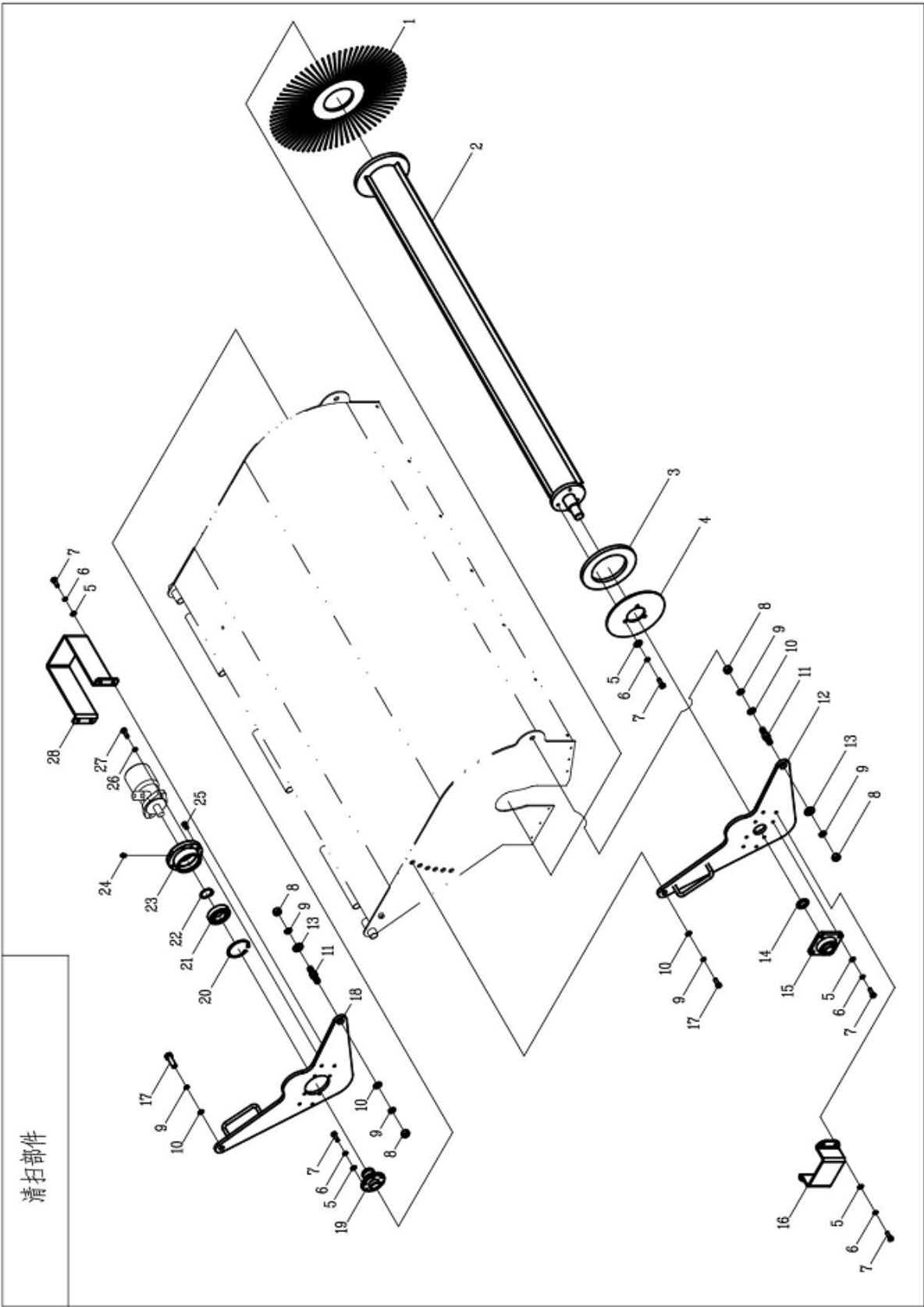

清扫部件

Part no.	Serial no.	Description	REQ'D Quantity/unit	remarks
C1	1856018	Φ560 Bristles wafer	39	
C2	1856019	Brush core weldment	1	
C3	1856020	Backing plate	1	
C4	1856021	Sliding sealing plate	1	
C5	1856022	Flat Washer 10	21	
C6	1856023	Spring Washer 10	21	
C7	1856024	Bolt M10x30	21	
C8	1856025	Nut M16	4	
C9	1856026	Spring Washer 16	6	
C10	1856027	Flat Washer 16	4	
C11	1856028	Pin	2	
C12	1856029	Right support plate	1	
C13	1856030	Washer	2	
C14	1856031	Adjusting Washer	1	
C15	1856032	F206 flange bearing assembly	1	
C16	1856033	Guard plate	1	
C17	1856034	Bolt M16x50	2	
C18	1856035	Left support plate	1	
C19	1856036	Spline housing	1	
C20	1856037	Circlips for hole 85	1	
C21	1856038	Bearing 6209-RS	1	
C22	1856039	Circlips for hole 45	1	
C23	1856040	Bearing seat	1	
C24	1856041	Grease cup M10x1	1	
C25	1856042	Hexagon socket head cap screw	4	
C26	1856043	Spring Washer 12	2	
C27	1856044	Bolt M12x40	2	
C28	1856045	Motor guard plate	1	

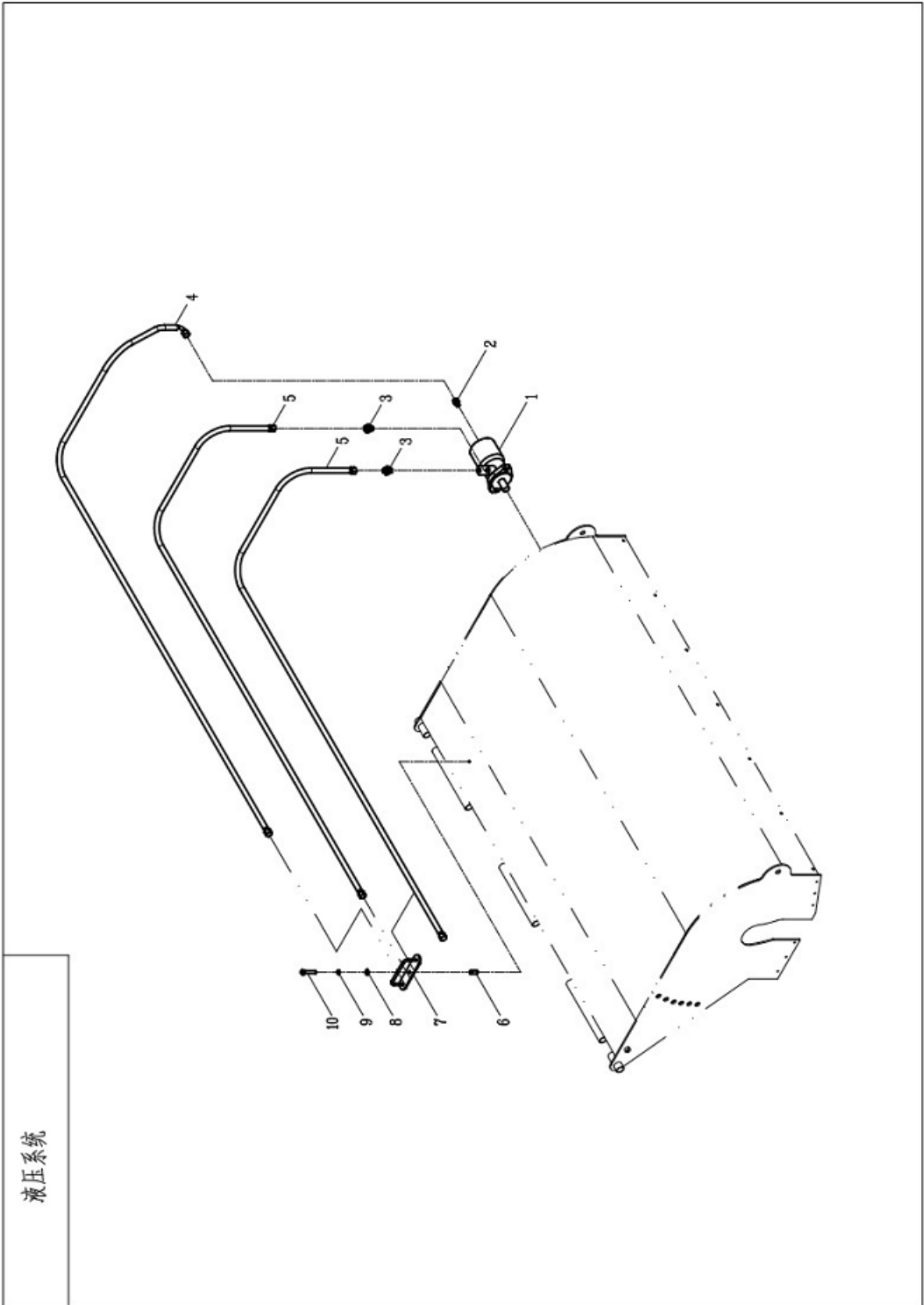

液压系统

Part no.	Serial no.	Description	REQ'D Quantity/unit	remarks
D1	1856046	Hydraulic motor	1	
D2	1856047	Adapter 1	1	
D3	1856048	Adapter 2	2	
D4	1856049	Hose 1	1	
D5	1856050	Hose 2	2	
D6	1856051	Sleeve	1	
D7	1856052	Bracket weldment	1	
D8	1856053	Flat Washer 10	1	
D9	1856054	Spring Washer 10	1	
D10	1856055	Bolt M10x55	1	