

ZERO GRAVITY MULTI-FUNCTION ULTRA PRO MASSAGE CHAIR

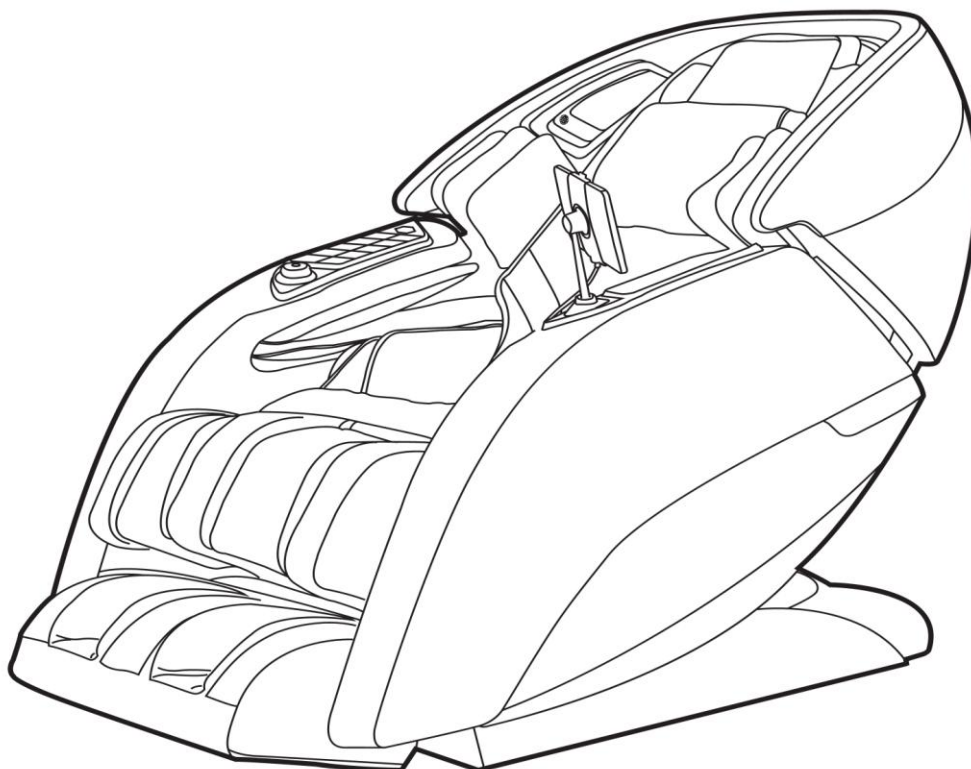

- Please read and understand the product manual completely before assembly
- Check against the parts list to make sure all parts are received
- Wear proper safety goggles or other protective gears while in assembly
- Do not return the product to dealer. They are not equipped to handle your requests.

Missing parts or have questions on assembly?
Please call: 1-877-761-2819 or email: cs@tmgindustrial.com

HEADING 1

TITLE OF BODY TEXT

Body text,

Please call: 1-877-761-2819 or email: cs@tmgindustrial.com

 **CONTENTS**

SAFETY PRECAUTIONS 3

NAME AND FUNCTION OF EACH COMPONENT 5

 External Structure 5

 Internal Structure 5

 Controller 6

 Controller Instructions 7

 AI Voice Touch screen Controller User Guide 8

FUNCTIONS AND FEATURES 9

PRELIMINARY CHECKS10

 Installation Method 10

 Moving the Massage Chair 14

 Connecting to Power 14

 Position & Placement for Installation 15

 Floor Protection 16

 Surrounding Environment 16

 Grounding 16

 Commissioning 17

 Before Sitting in the Chair 17

 Feet Extension 18

 After Use18

PRODUCT STORAGE AND MAINTENANCE 19

TROUBLESHOOTING20

TECHNICAL SPECIFICATIONS21

IMPORTANT SAFETY INSTRUCTIONS

Read all instructions before using (this appliance).

DANGER - To reduce the risk of electric shock:

1) Always unplug this appliance from the electrical outlet immediately after using and before cleaning.

WARNING - To reduce the risk of burns, fire, electric shock, or injury to persons:

- 1) An appliance should never be left unattended when plugged in. Unplug from outlet when not in use, and before putting on or taking off parts.
- 2) Do not operate under blanket or pillow. Excessive heating can occur and cause fire, electric shock, or injury to persons.
- 3) Close supervision is necessary when this appliance is used by, on, or near children, invalids, or disabled persons.
- 4) Use this appliance only for its intended use as described in this manual. Do not use attachments not recommended by the manufacturer.
- 5) Never operate this appliance if it has a damaged cord or plug, if it is not working properly, if it has been dropped or damaged, or dropped into water. Return the appliance to a service center for examination and repair.
- 6) Do not carry this appliance by supply cord or use cord as a handle.
- 7) Keep the cord away from heated surfaces.
- 8) Never operate the appliance with the air openings blocked. Keep the air openings free of lint, hair, and the like.
- 9) Never drop or insert any object into any opening.
- 10) Do not use outdoors.
- 11) Do not operate where aerosol (spray) products are being used or where oxygen is being administered.
- 12) To disconnect, turn all controls to the off position, then remove plug from outlet.
- 13) Do not use massager in close proximity to loose clothing or jewelry.
- 14) Keep long hair away from massager while in use.
- 15) Use heated surfaces carefully. May cause serious burns, Do not use over insensitive skin areas or in the presence of poor circulation. The unattended use of heat by children or incapacitated persons may be dangerous..



SAVE THESE INSTRUCTIONS

For use household only

SAFETY PRECAUTIONS

SAFETY PRECAUTIONS

- ▶ Before using, please read the SAFETY PRECAUTIONS carefully to ensure correct operation of this appliance.
- ▶ Precautions and warnings listed below will help to ensure proper operation of this appliance.
- ▶ The classes of accidents caused by incorrect use are classified into WARNING and CAUTION. Read all WARNINGS and CAUTIONS below and follow all instructions within this manual.

 WARNING	Improper operation may cause injury to users.
 CAUTION	Improper operation may cause injury to users or damage to product.

	Prohibited		NO Disassemble
-----------------------------------------------------------------------------------	------------	-----------------------------------------------------------------------------------	----------------

NOT SUITABLE FOR BELOW PERSONS

We recommend that those with any of the following conditions should consult your physician before using.

 WARNING	<ul style="list-style-type: none"> ◆ Those with pacemaker or electronic devices implanted in the body. ◆ Those undergoing treatment, especially those who are not feeling well. ◆ Those with malignant tumors, acute disease, heart disease or severe hypertension. ◆ Need to be supervised. ◆ Women who are pregnant or menstruating. ◆ Those with osteoporosis, distorted joints, dysfunction or recent fracture. ◆ Those with serious or injured skin conditions. ◆ Those with high fever. ◆ The appliance has a heated surface. Persons insensitive to heat must be careful when using the appliance. (Need to be supervised) ◆ This appliance is not intended for use by persons (including children) with reduced physical, sensory or mental capabilities, or lack of experience and knowledge, unless they have been given supervision or instruction concerning use of the appliance by a person responsible for their safety. ◆ This appliance can be used by children aged from 8 years and above and persons with reduced physical, sensory or mental capabilities or lack of experience and knowledge if they have been given supervision or instruction concerning use of the appliance in a safe way and understand the hazards involved.
-------------------------------------------------------------------------------------------------------	---------------------------------------------------------------------------------------------------------------------------------------------------------------------------------------------------------------------------------------------------------------------------------------------------------------------------------------------------------------------------------------------------------------------------------------------------------------------------------------------------------------------------------------------------------------------------------------------------------------------------------------------------------------------------------------------------------------------------------------------------------------------------------------------------------------------------------------------------------------------------------------------------------------------------------------------------------------------------------------------------------------------------------------------------------------------------------------------------------------------------------------------------------------------------------------------------------------------------------------------------------------------------------------------------------------------------------------------------------------------

CONTROLLER PRECAUTIONS

 CAUTION	<ul style="list-style-type: none"> ◆ Do not operate the controller with wet hands or pull the controller wire by force. ◆ Do not spill water or other liquid into the controller to avoid fault. ◆ Do not lay heavy items on the controller.
-------------------------------------------------------------------------------------------------------	-------------------------------------------------------------------------------------------------------------------------------------------------------------------------------------------------------------------------------------------------------------------------------

CAUTIONS REGARDING THE POWER CONNECTORS AND POWER CORD





 CAUTION	<ul style="list-style-type: none"> ◆ The appliance is only to be used with the power supply unit provided with the appliance. ◆ It must only be supplied at safety extra low voltage corresponding to the marking on the appliance. ◆ Do not use a wet hand to unplug the AC cord to avoid electric shock. ◆ Do not pull on the power cord, reach to the front end to unplug it. ◆ Do not squeeze the power cord by heavy objects. ◆ Do not damage, over bend, pull hard or twist the power cord. ◆ If the supply cord is damaged, it must be replaced by the manufacturer or its service agent or a similarly qualified person in order to avoid a hazard.
-------------------------------------------------------------------------------------------------------	----------------------------------------------------------------------------------------------------------------------------------------------------------------------------------------------------------------------------------------------------------------------------------------------------------------------------------------------------------------------------------------------------------------------------------------------------------------------------------------------------------------------------------------------------------------------------------------------------------------------------------------------------------------------------------------------------------------------------------

SAFETY PRECAUTIONS

BEST CIRCUMSTANCES

 CAUTION	<ul style="list-style-type: none"> ◆ Do not use this appliance where temperature is over 40°C. ◆ Do not use this appliance in moist or dusty environment. ◆ Unplug from outlet during thunder or lightening storms. ◆ Do not use outdoors. ◆ Please place the product on the flat level floor. ◆ Do not store near heat or open flame.
-----------------------------------------------------------------------------------------------------	----------------------------------------------------------------------------------------------------------------------------------------------------------------------------------------------------------------------------------------------------------------------------------------------------------------------------------------------------------------------------------------------------

BEST PRACTICES FOR SAFE USE

 CAUTION	<ul style="list-style-type: none"> ◆ Only for users weighs below 120kg. ◆ Do not use other therapeutic device together with this product. ◆ Use this product only for its intended use as described in this manual. ◆ Appliance should only be used by one person, do not use by two or more persons at the same time to avoid damage to the products. ◆ Do not use the product right after meal, it may cause discomfort. ◆ Remove the accessories from the arms and empty the pockets while use the massage services. ◆ Check the upholstery under the cushions and other spots, if any damages are present, do not use it and refer to a qualified service professional for servicing. ◆ If you feel any abnormal discomfort during the operation of this product, turn off the power immediately and do not use the product. ◆ Use the appliance for 20 minutes each time is highly recommended. ◆ Make sure there is no obstacles behind the chair and there is enough clearance before adjusting the backrest or footrest angle ◆ Make sure no other excessive load pressed on the backrest or footrest, keep children, pets or any other barrier away from the unit reclining backrest/extending footrest to prevent any accidental injury. ◆ Please be seated properly while using the appliance to avoid injury to the user or damage to the appliance. ◆ Do not drag or push the chair or roll on its casters on wood floor or carpet to avoid damage
 PROHIBITED	<ul style="list-style-type: none"> ◆ Never operate this product if it has damaged /exposed parts or power leakage. ◆ Do not stand on or stack heavy objects on the footrest. ◆ Children should be supervised to ensure that they do not play with the massage chair. ◆ Do not fall into sleep while the product is operating. ◆ Avoid using the product under the influence of alcohol. ◆ Do not put hands or foreign objects in the openings of the appliance to avoid injury to the user or damage to the appliance. ◆ If there is any smoke or unusual smell during operation, stop using immediately.
 NO DISASSEMBLE	<ul style="list-style-type: none"> ◆ Do not disassemble this product to avoid failure. ◆ Do not attempt to repair or dismantle the appliance without permission. ◆ Please contact authorized dealer or service agent.
 UNPLUG POWER CORD	<ul style="list-style-type: none"> ◆ Pull out the power cord from the power strips before maintenance. ◆ Never plug in or pull out power cord with wet hand to avoid shock or injury. ◆ Pull out the power cord from the power strips after use. ◆ Unplug from outlet when the power supply is cut.

NAME AND FUNCTION OF EACH COMPONENT

EXTERNAL STRUCTURE

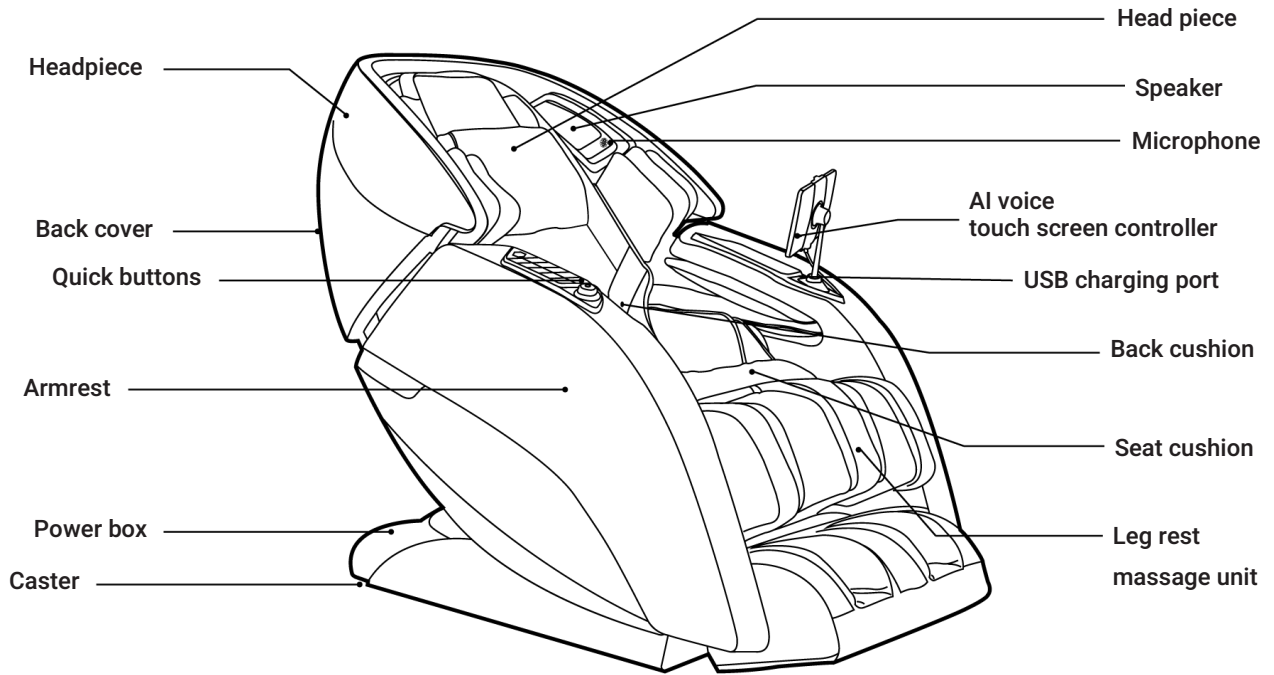

INTERNAL STRUCTURE

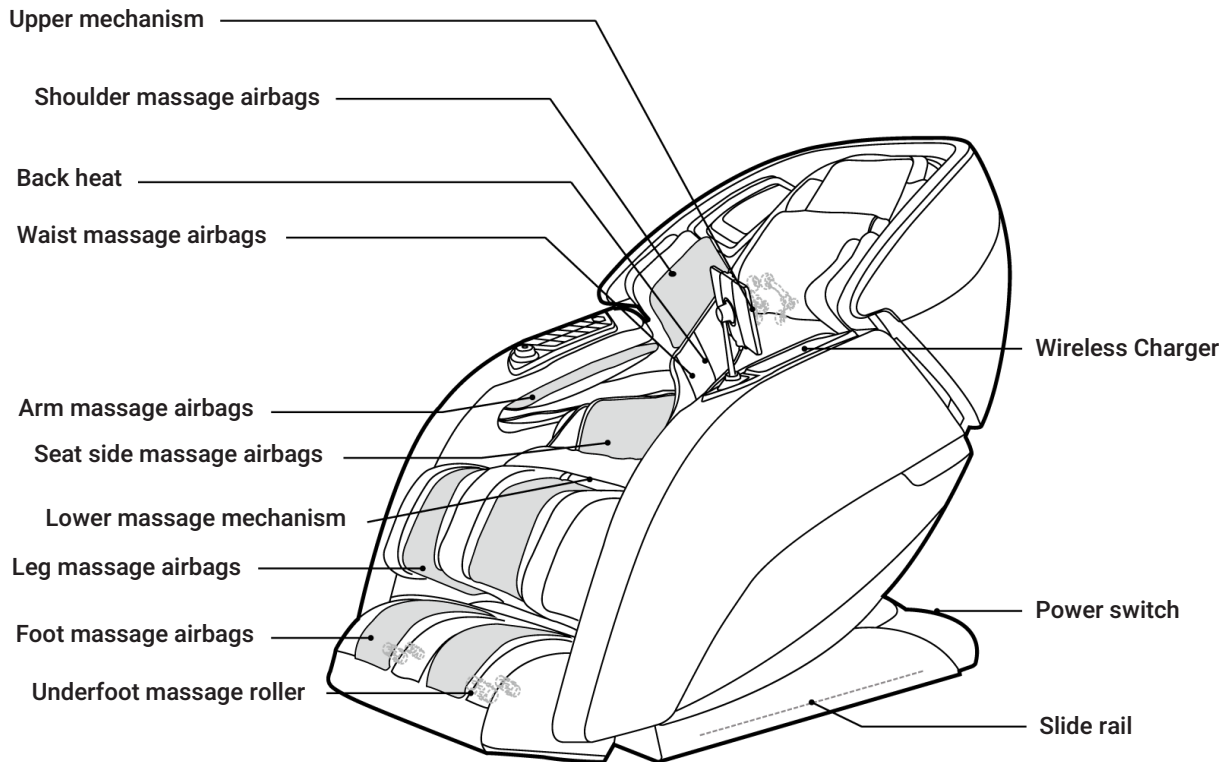

CONTROLLER

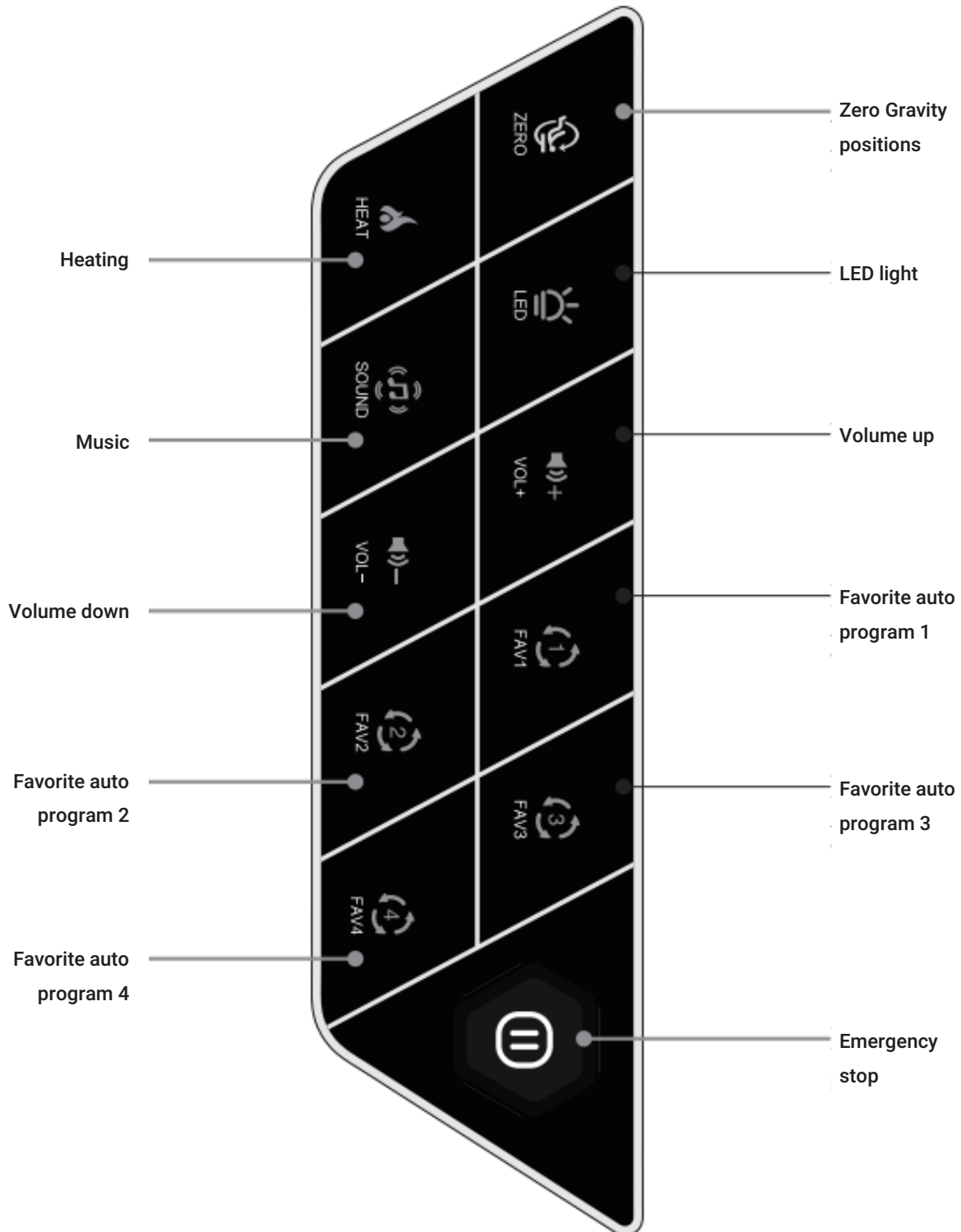

CONTROLLER INSTRUCTIONS



ZERO

ZERO GRAVITY POSITIONS

▶ Precautions Press to put massage chair into Zero Gravity position,the indicator light of the button turns green when Zero Gravity Position 1 is chosen, it turns blue when Zero Gravity Position 2 is chosen.



HEAT

HEATING

▶ Press to turn on heating,the indicator light of the button turns yellow when level 1 heating is chosen, it turns red when level 2 heating is chosen.



LED

LED LIGHT

▶ Short press this button,the indicator light of the button turns blue, you may change the color of the LED light for speakers and armrests; Long press this button to turn on/off the LED light for speakers and armrests, the indicator light of the button turns white.



SOUND

MUSIC

▶ Short press this button,the indicator light of the button turns blue,the pre-set sound soothe music starts to play, you may short press this button to change the sound soothe music.



VOL+

VOLUME UP

The indicator light of the button displays white when press this button to increase the volume, it turns blue when the maximum volume is reached.



VOL-

VOLUME DOWN

▶ The indicator light of the button displays white when press this button to decrease the volume, it turns blue when the minimum volume is reached.



(FAV1)
(FAV2)
(FAV3)
(FAV4)

FAVORITE AUTO PROGRAM 1 (2,3,4)

▶ Shortcut button: Press this button to go to your favorite massage program that you added to the collection(it goes to a default massage program if there is no program added in the collection),the indicator light of the button turns blue.Collect function: While an auto massage program is working,press and hold the button to add this auto massage program to the collection, the color of the indicator light turns blue if operation succeeded, if the color of the indicator light didn't change, this auto massage program has been added to other collection button.



EMERGENCY STOP

▶ Press to pause all functions of massage chair, the indicator lights of all buttons blinks white (blink intervals:0.5 second);press again to continue.

AI VOICE TOUCH SCREEN CONTROLLER USER GUIDE

► See the “AI Voice Touchscreen Controller User Guide” at touch screen controller display.

INTELLIGENT VOICE COMMAND + CONTROL

TURN OFF LISTENING

You can turn off intelligent voice control listening by using the tablet remote. Tap System from Home display, then toggle Voice Control to Off. Tap screen to select setting. Intelligent voice control will now no longer activate until turned back on. Your chair comes with built in intelligent voice command+ control. This feature allows you to control your chair and massage experience completely hands-free by using one of the many voice commands.

TURN ON LISTENING

To turn on the intelligent voice control function, tap System from Home display, then toggle Voice Control to On. Tap screen to select setting.

ACTIVATING VOICE CONTROL

To activate, simply say ‘Activate Voice Control’. You may now give your chair any of the commands to the right within 5 seconds. Alternatively, you can touch the voice command button on the left speaker, located beside your head to activate, and then speak your command within 5 seconds. Make sure to speak clearly and slowly. After 5 seconds the Intelligent Voice Command function will go to sleep automatically and must be awakened again.

<p>Say Phrase “ACTIVATE VOICE CONTROL”</p>
<p>Then speak one of the following COMMANDS</p>
<ul style="list-style-type: none"> ◆ Turn Off Massage Chair ◆ Flex Massage ◆ Stretch Massage ◆ Gentle Massage ◆ Deep Breathe Massage ◆ Energize Massage ◆ Rest & Recover Massage ◆ Upper Body Massage ◆ Neck & Spine Massage ◆ Lower Body Massage ◆ Tension Release Massage ◆ Full Body Massage ◆ Demo Massage ◆ Start Foot Rollers ◆ Foot Rollers Off ◆ Start Heat ◆ Heat Off ◆ Increase the Volume ◆ Turn Volume Down

1. ONE PRESS CONTROL SLIDING FORWARD

It will slide forward by 28 cm and recline afterwards.

Glider recliner linkage mechanism to save space and provide utmost relaxing position.

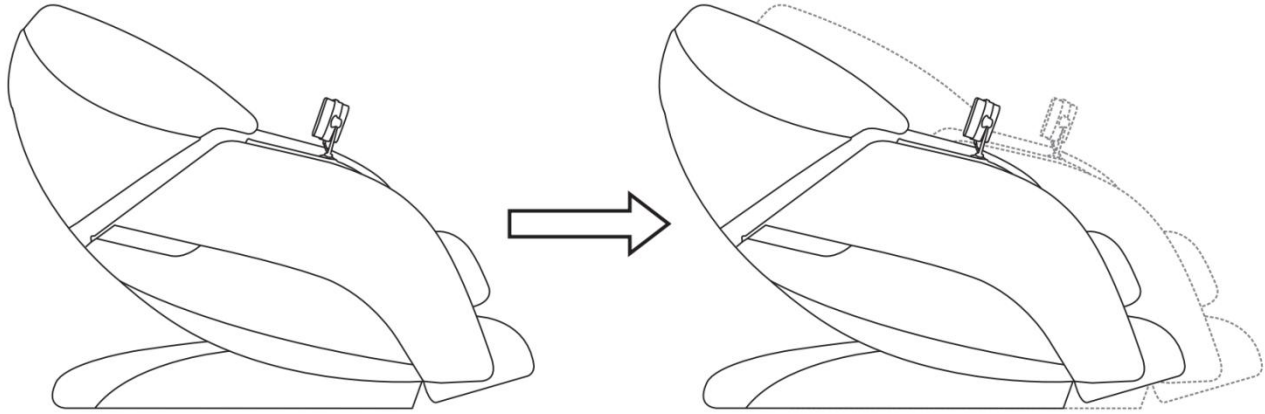

2. ZERO GRAVITY POSITION

At such a weightless position that the height of the legs slightly higher than the upper body, the weight of body can evenly distributed throughout, reducing the pressure of the spine and joints both physically and mentally.

3. AUTO/MANUAL FOOTREST EXTENSION

The footrest can extend automatically to customize the user's leg length, you may also use the controller button to adjust the footrest according to your needs. The lower footrest can extend by 15cm automatically for various users with different stature.

4. AIR PRESSURE MASSAGE

Whole body air pressure massage for shoulders, arms, back, waist, hips, legs and feet.

5. ROLLING MASSAGE

3 underfoot rollers provide all-direction pressure massage for the reflex zone.

6. VERSATILE MASSAGE TECHNIQUES

Mimic human hand Kneading, knocking, sync, tapping, shiatsu and 3D shiatsu massage techniques for custom-tailored relaxation.

7. INTELLIGENT VOICE CONTROL

Intelligent voice control system meets the demands for easier control.

INSTALLATION METHOD

STEP 1, TAKE ALL MASSAGE CHAIR UNITS OUT OF THE CARTONS

- ▶ Unpack the cartons and take out all sewing and other accessories out of the cartons.
- ▶ Before beginning installation, please verify that all components are included.(check with the packing list carefully)

STEP 2: INSTALL ARMREST UNIT

- ▶ Connect the two air valve plugs and one air hose to the matching numbered nozzles on the armrest and plug in the air valve connector.(Same installation method with the other side)

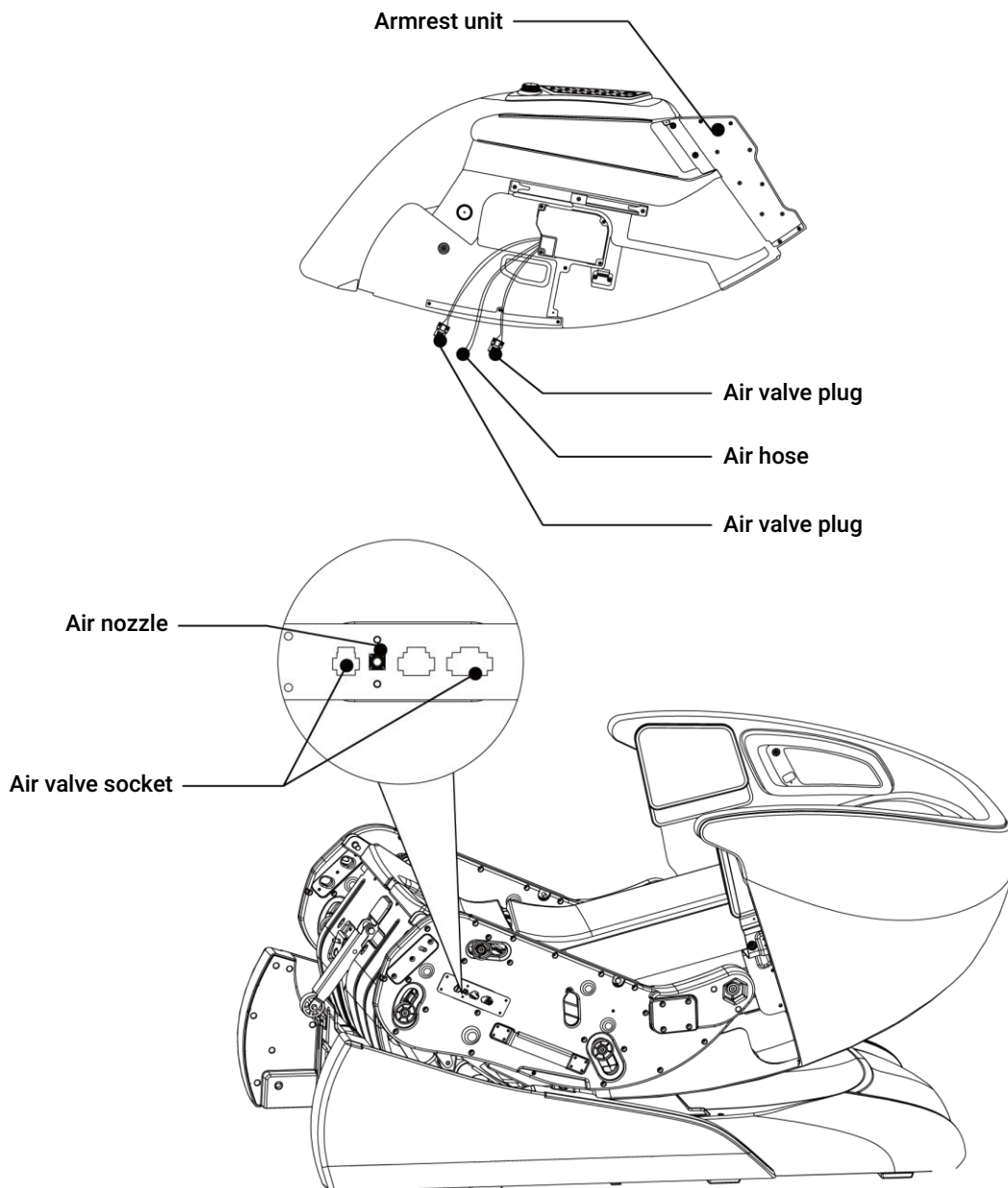

PRELIMINARY CHECKS

► Hold the armrest unit up and hook the bracket 2 onto the carrier groove, slowly push the armrest unit back into the chair linkage until bracket 2 aligns completely with bracket 4, insert bracket 1 into bracket 3, use a screw to secure the armrest into place. (Same installation method with the other side)

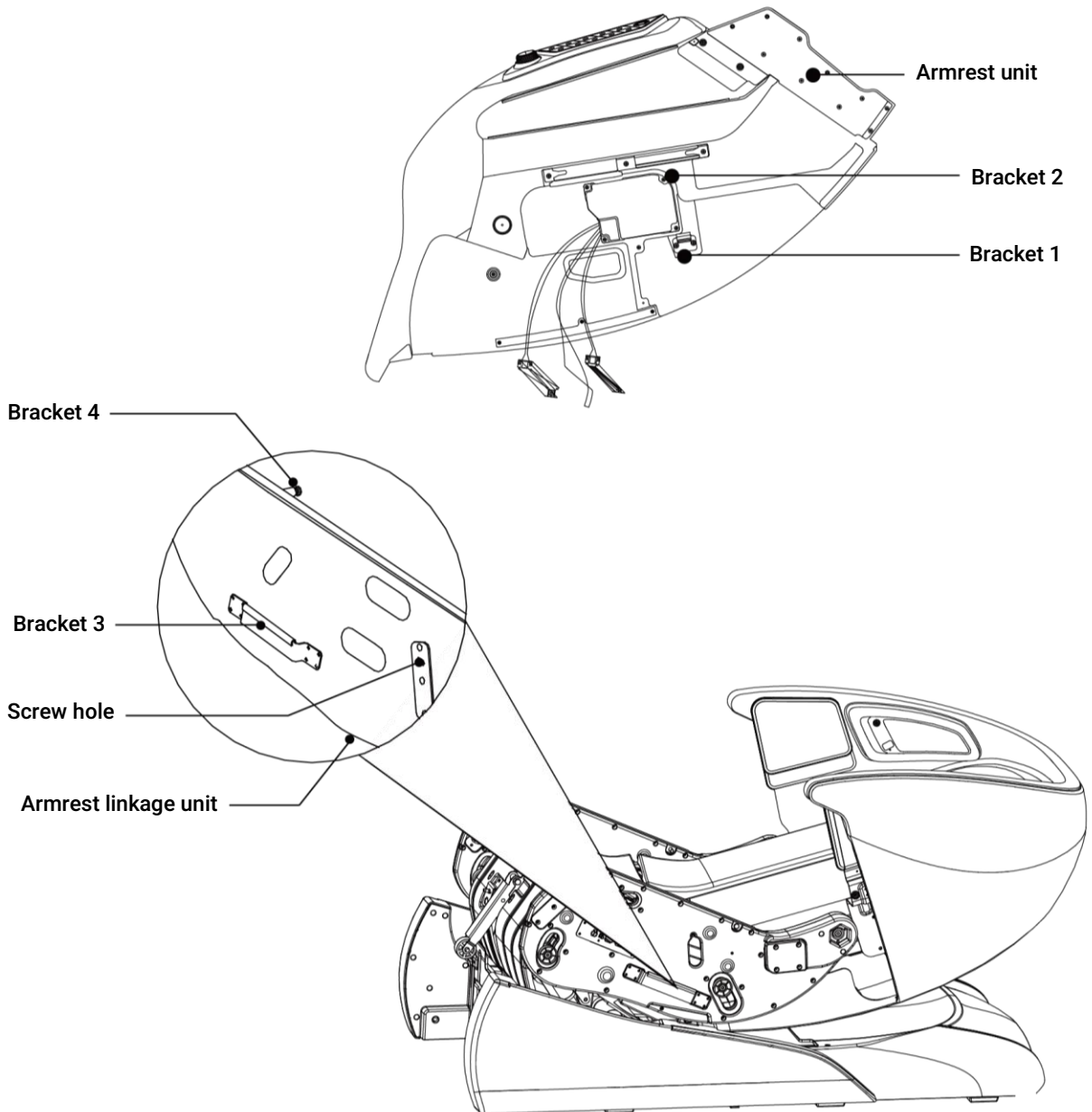

PRELIMINARY CHECKS

STEP 3: INSTALL TOUCHSCREEN CONTROLLER HOLDER

► Insert the lower end of Touch screen Controller holder into the socket, turn the nut clockwise to secure the holder into place; fit touch screen controller wire plug into the drive wire socket by the seat side, make sure they are well secured.

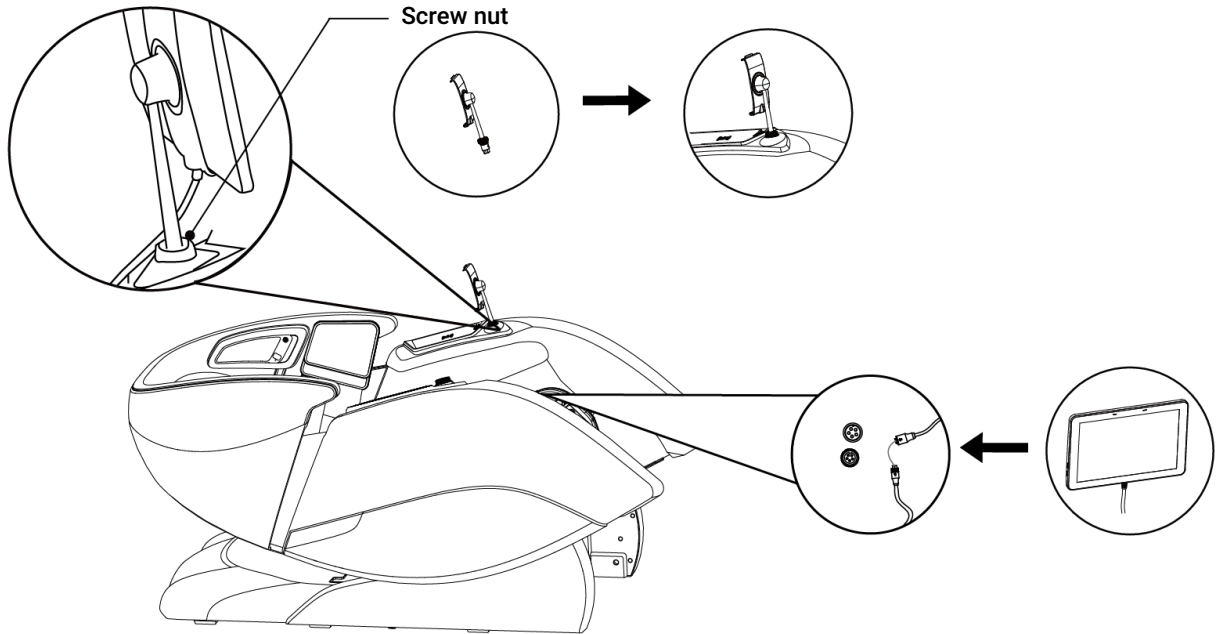

STEP 4, INSTALL THE FOOTREST UNIT

► Raise the leg rest unit, thread the air hose into the air nozzle, and fit the air valve plug into the air valve port which located at the face side of seat base, make sure they are well secured.

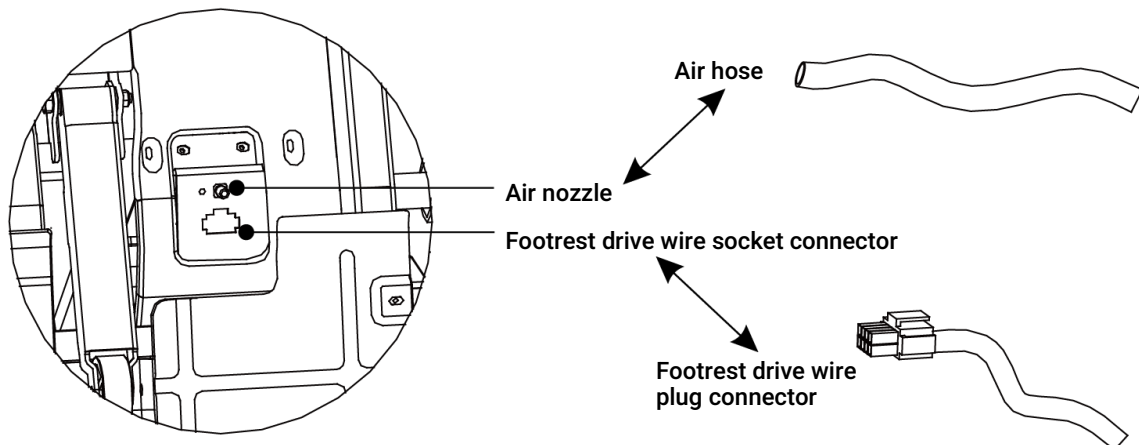

PRELIMINARY CHECKS

► Thread the air hose into the air nozzle, and fit the air valve plug into the air valve port which located at the face side of seat base, make sure they are well secured. Put the leg rest bracket sleeve into the leg rest bracket, attach the leg rest bracket onto the leg rest rotation shaft ,then attach a DK circlip to the end of the leg rest rotation shaft to hold the leg rest in place, then zip the footrest and main chair together.

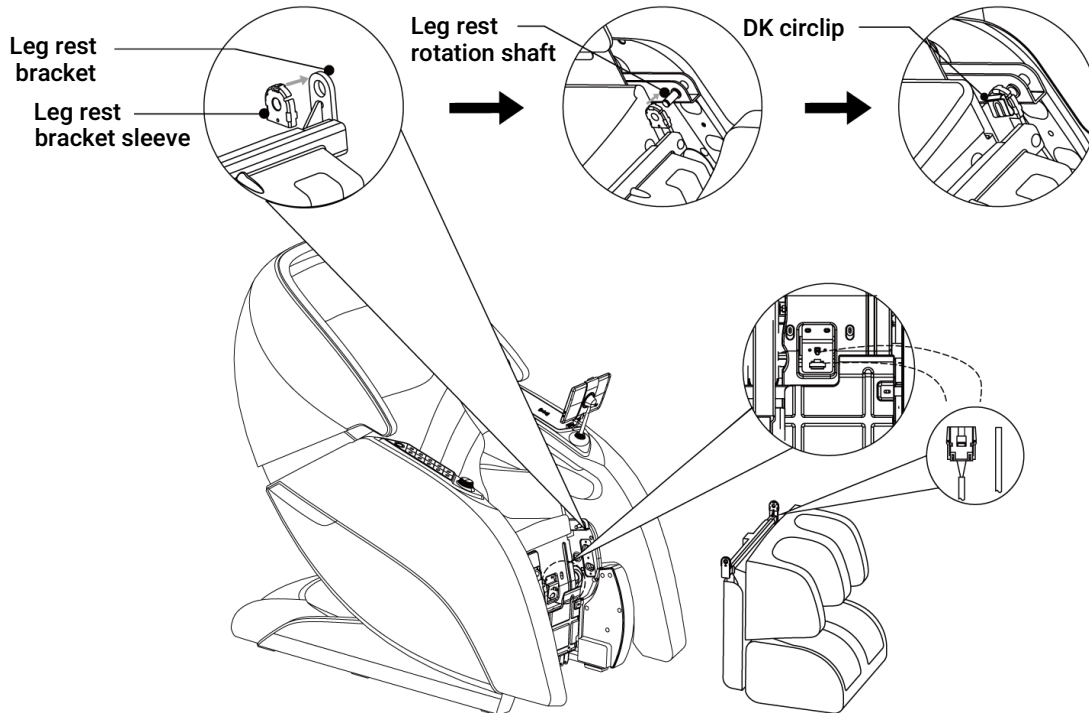

STEP 5: OTHER ACCESSORIES

- Connect the power cable to the product power socket located at the power box.
- Connect power to chair, switch ON the power button, use the controller to raise the backrest to fully upright position.

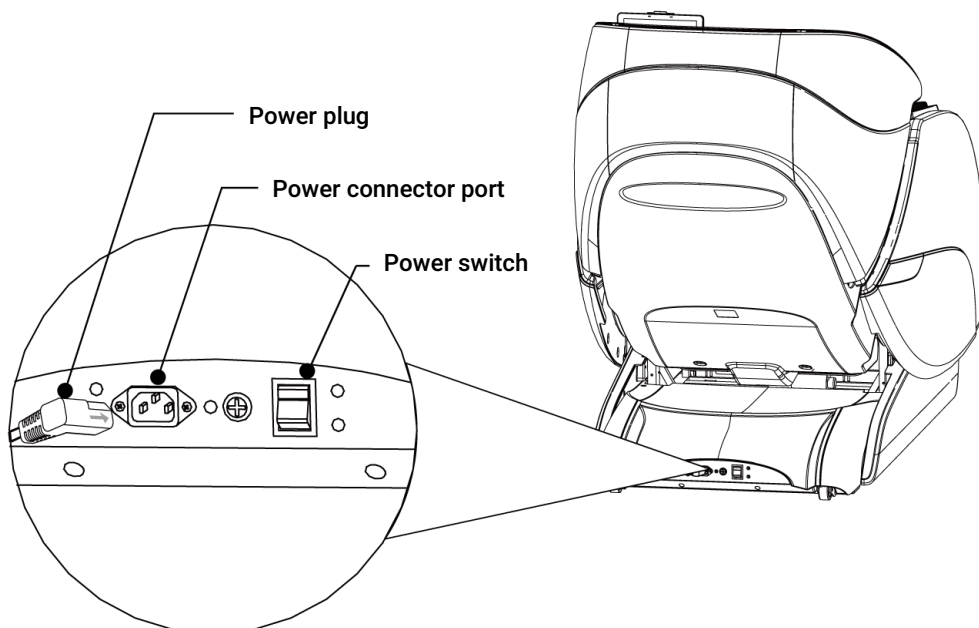

PRELIMINARY CHECKS

MOVING THE MASSAGE CHAIR

- ▶ Roll the chair on its casters to the desired location.
- ▶ Incline the backrest to upright position.
- ▶ Turn off the power switch and unplug the appliance from the electrical outlet.
- ▶ Using two people, push down on the backrest and lift up on the front side by grabbing the moving Holder located to the front bottom of the armrest),roll the chair on its casters to the desired location(check the sketch for reference).

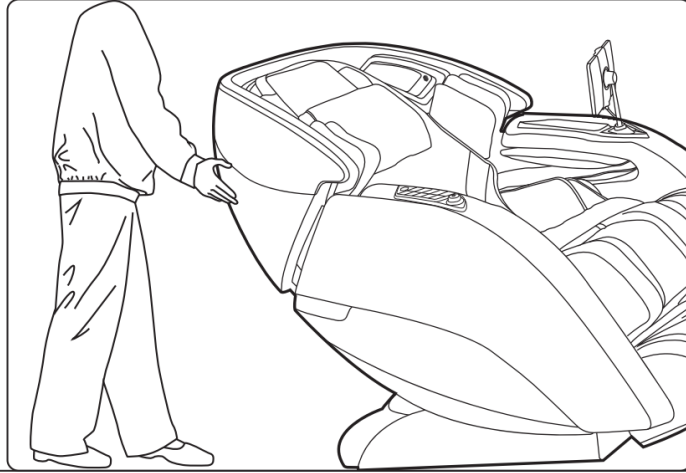

CAUTION

- ▶ Do not move the chair when there is user inside.
- ▶ To carry this product, do not lift by the footrest or armrest, hold the chassis and steady the backrest (have 4 or more people to carry the product).

CONNECTING TO POWER

- ▶ Connect this appliance to a 3-wire properly grounded outlet.
- ▶ Turn on the main power switch by the right hand side of the massage chair.

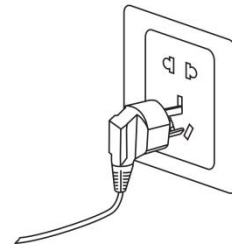

CAUTION

- ▶ Please verify that there is no damage to the supply cord before switching on the massage chair.
- ▶ Please verify that the main power switch is turned off before connecting to power.

PRELIMINARY CHECKS

POSITION & PLACEMENT FOR INSTALLATION

CLEARANCE SPACE FOR THE MASSAGE CHAIR:

- ▶ Ensure there is an adequate clearance for the installation: It needs 10cm clearance for the reclining of the backrest; It needs 60cm clearance space for the extension of footrest and sliding forward of the chair.
- ▶ Keep it 1 meter away from the TV, radio or other audio/video appliance to avoid signal interference.

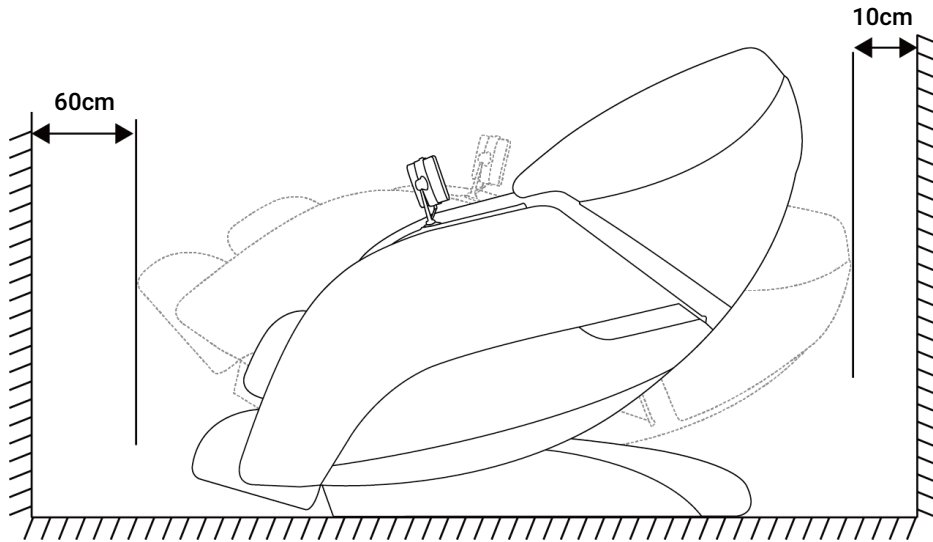

- ▶ Keep the distance between the power socket and power switch within 1.5 meter.

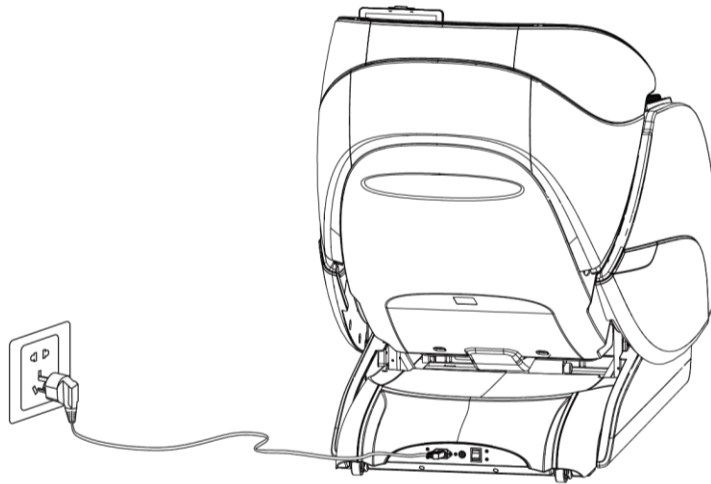

CAUTION

- ▶ Keep the distance between the power socket and power switch within 1.5 meter to avoid damage of power cord while massage chair sliding forward.
- ▶ Straighten the power cord while in use to avoid tangle or damage.
- ▶ When the massage chair sliding forwards or back, please check to make sure there are no children, pets or other obstacles around to avoid accident.

PRELIMINARY CHECKS

FLOOR PROTECTION

► We recommend to place a piece of carpet or soft mat underneath it to avoid damaging the floor.

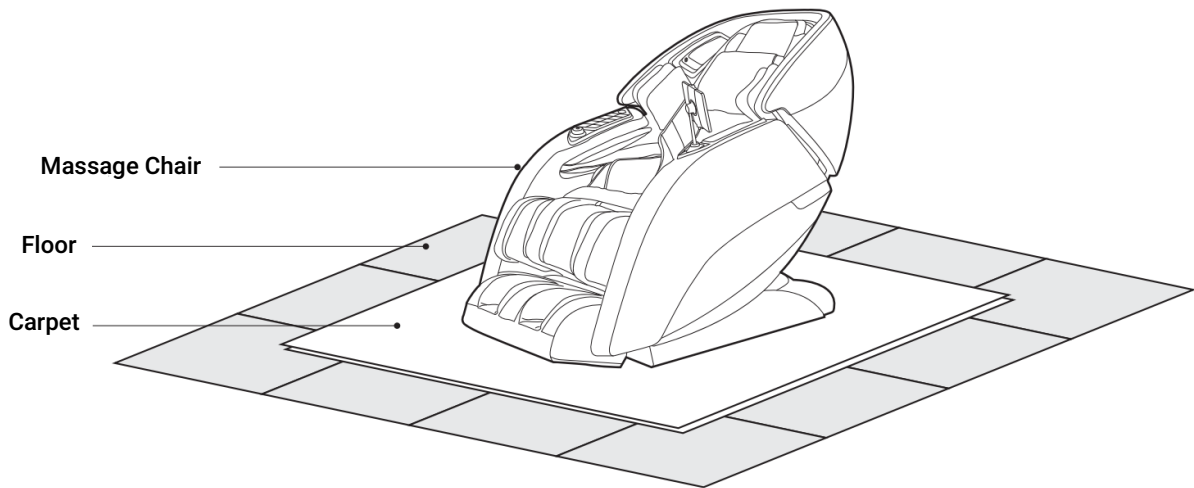

SURROUNDING ENVIRONMENT



Do not use the massage chair in high moisture environment such as near swimming pool or bathroom to prevent electric shock accident.



Please keep the massage chair away from heated surfaces to prevent fire hazard or damage to the product.

GROUNDING



This product must be grounded, the plug must be plugged into an appropriate 3-wire grounded outlet that is properly installed and grounded in accordance with all local codes and ordinances to reduce risk of electrical shock.

PRELIMINARY CHECKS

COMMISSIONING

- ▶ Use the controller to recline the backrest to its lowest position, raise and extend the footrest to its top position, make sure there is enough clearance before commissioning.
- ▶ Return the backrest and footrest back to its default position after commissioning and turn off the power switch.
- ▶ To choose the massage program, please check the Instructions of Controller and Instructions of Touch screen Controller for reference.

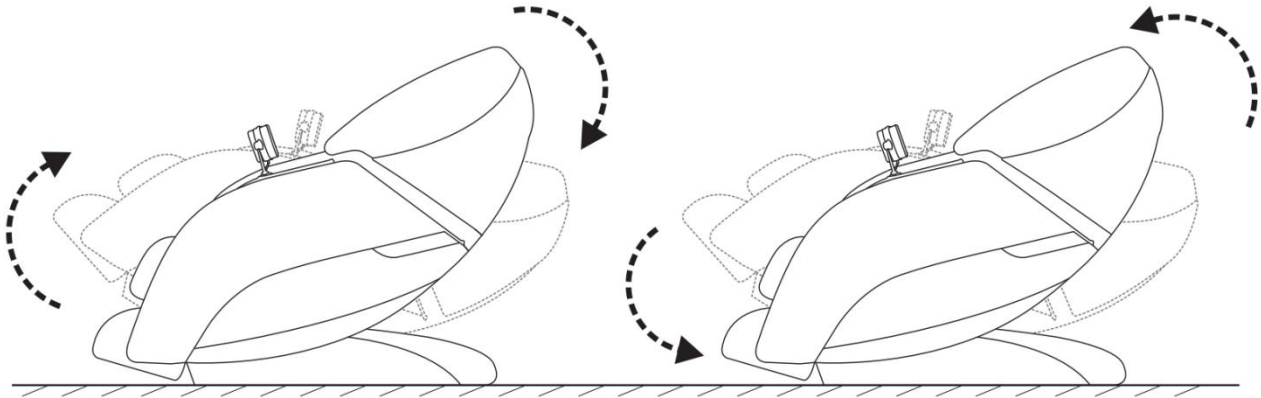

BEFORE SITTING IN THE CHAIR

- ▶ Ensure the footrest is well assembled before sitting on the massage chair.
- ▶ Ensure the massage chair is returned to its original position before sitting on it.
- ▶ If there is any part not in default position, please turn off the massage chair to allow it to restore.





CAUTION

- ▶ Do not take seat while the leg rest is lifted.
- ▶ Do not put excessive load on the leg rest to avoid damage.

PRELIMINARY CHECKS

FEET EXTENSION

▶ Press and hold “” or “” button to extend (make sure there is enough clearance) or retract the footrest to the length you desire for better massage experience, release the button to fix the position.

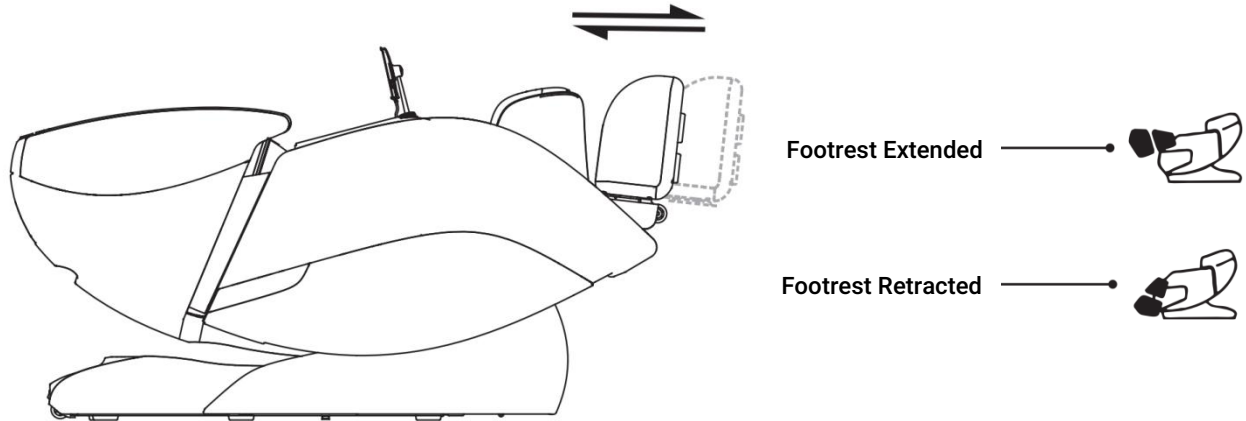

▶ A footrest sensor is set at the bottom of footrest, the footrest will adjust the length automatically once the chair started.



WARNING

- ▶ Do not play on the massage chair or operate it improperly.
- ▶ Ensure there is no obstruction when raising or reclining the backrest and footrest.
- ▶ Do not put foot, fingers or any other objects in the openings of the chair when it is in the reclining, raising or restoring motion.
- ▶ Ensure that massage chair is restored back to its original position before getting off the massage chair.

AFTER USE

- ▶ Always unplug the massage chair from the electrical outlet immediately after use.
- ▶ Put the Touch screen Controller onto the holder.
- ▶ Turn off the power switch and unplug the massage chair from the electrical outlet while not in use to avoid children power on the massage chair accidentally.
- ▶ When not in use for a long period of time, we recommend that the chair be covered, the power cord be coiled and that the unit be placed in an environment free of dust and moisture.

CARE INSTRUCTIONS

- ▶ To treat stains on back panel, armrest, footrest, plastic parts or air hose, spot clean with mild detergent foam, then wipe it with a dry cleaning cloth.
- ▶ To treat stains on controller, power box, spot clean with a dry cleaning cloth.
- ▶ To treat stains on back cushion or pillows, use a water-based upholstery cleaner only, wipe it with moist cloth, then air dry.
- ▶ To clean the foot/calf unit covers, remove it from the chair, hand wash with a mild detergent, then line dry.

 **WARNING**

- ▶ Children shall not play with the appliance. Cleaning and user maintenance shall not be made by children without supervision.
- ▶ Pull out the power cord from the power strips before care and maintenance.
- ▶ To avoid electrical shock or injury, do not touch the power cord with wet hands.
- ▶ Make sure no detergent enter into the power box while cleaning.
- ▶ Do not use benzene, thinner or other solvents on your product, it may cause fading or damage to the product.
- ▶ Do not iron the upholstery.

STORAGE METHODS

- ▶ Cover the product with a dust-free cloth to prevent collection of dust if not in use of a long period of time.

 **CAUTION**

- ▶ Do not leave this product exposed to direct sunlight for long periods of time.
- ▶ This may cause fading or damage.

WARM TIPS

During daily use, please check for the following symptoms:

- ▶ Burnt smell.
- ▶ Power flickers on and off when touching the charging cable.
- ▶ The power cord is hot.
- ▶ Other abnormal symptoms.

 **CAUTION**

- ▶ Please stop using the product to avoid breakdowns or accidents if any above symptom exists.
- ▶ Switch off the power button and disconnect the plug , contact the local distributors or supplier for repair.
- ▶ All other servicing except above care and maintenance should be serviced by an authorized dealer or service center.

 **WARNING**

- ▶ Pull out the power cord from the power strips before care and maintenance.
- ▶ To avoid electrical shock or injury,do not touch the power cord with wet hands.
- ▶ Do not try to dismantle or repair the product yourself,please send your massage chair to the authorized service center.

**TROUBLESHOOTING**

NO.	SYMPTOMS	POSSIBLE CAUSES	POSSIBLE SOLUTIONS
1	Noise is heard while in use	This sound is normal and comes from the air pump motor or other mechanical parts rubbing against the cloth cover	No need to take any measures
2	Appliance does not start	The power cord is not secured into the socket	Insert the power plug properly into the power socket
		Power switch is off	Turn on the switch
		The fuse is blown	Replace only with a fuse of same type and rating
3	No music comes from the speaker	The volume is turned to the lowest	Adjust the speaker volume from the mobile devices
		Bluetooth is off	Switch on Bluetooth
		Bluetooth connected with other device	Reconnect Bluetooth
4	Backrest or footrest cannot raise or recline	Excessive load has been pressed on the backrest or leg rest	Reduce the load and try again

If problem remains, please contact the dealer for maintenance.

Important: Do not attempt to repair this product yourself, our company shall not be liable for the injury or damage caused by any servicing without authorization.



TECHNICAL SPECIFICATIONS

NAME: DELUXE MULTI-FUNCTION MASSAGE CHAIR

MODEL: GLS541

RATED VOLTAGE: 110V~

RATED FREQUENCY:50-60HZ

RATED POWER: 180W

SAFETY DESIGN: CLASS I

WARRANTY INFOEMATION:

Please refer to our website for detailed warranty conditions and coverage.
For the most up-to-date and comprehensive warranty information, visit www.tmgindustrial.com