

PORTABLE SINGLE POST LIFT

Lifting Capacity: 6000lbs, Max. Lifting Height: 72"

MODEL: TMG-ALSP60

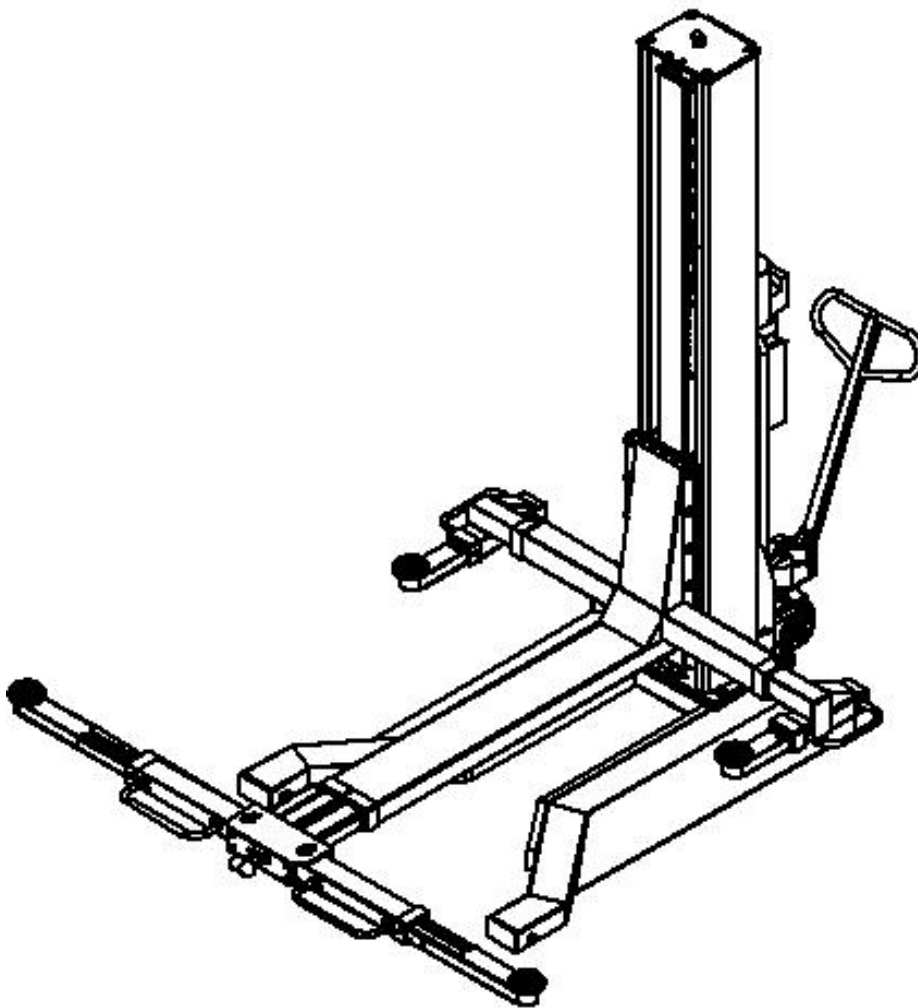

- Please read the product manual completely before assembly
- Check against the parts list to make sure all parts are received
- Wear proper safety goggles or other protective gears while in assembly

Missing parts or questions on assembly?

Please call: 1-877-761-2819 or email: cs@tmgindustrial.com

Do not return the product to dealer, they are not equipped to handle your requests

Content

1 Safety.....	3
1.1 Introduction.....	3
1.2 Intended Use.....	3
1.3 Safety Instructions for Commissioning.....	3
1.4 Safety Instructions for Operation.....	3
1.5 Safety Instructions for Servicing.....	3
1.6 Safety Features.....	4
1.7 Warning Labels.....	4
1.8 Disposal of Used Oil.....	6
1.9 Machine Demolition.....	6
2. Structure Drawing:.....	6
3. Main Technical Mechanism Parameters Table.....	8
3.1 Products Specifications	8
3.2 Parts Identification and Features.....	8
4. Packing, transport and storage.....	9
4.1 Packing.....	9
4.2 Lifting and handling.....	9
4.3 Storage and stacking of packages.....	9
4.4 Delivery and check of packages.....	9
5 Installation.....	10
5.1 Working Site.....	10
5.2 Installation.....	10
6. Operation instruction.....	15
6.1 Operation Rules for mechanism System.....	14
6.2 Operating Steps for Electrical Control System.....	14
6.3 Operation Flow:.....	14
6.4 Use lifting arm.....	16
7 Maintenance and Troubleshooting.....	18
8 Troubleshooting.....	17
9 Parts Breakdown	19
1 Exploded Drawing.....	18
2 Parts List.....	20
3 Hydraulic Diagram.....	20

1. Safety

1.1 Introduction

Thoroughly read this manual before operating the lift and comply with the instructions. Always display the manual in a conspicuous location.

Personal injury and property damage incurred due to non-compliance with these safety instructions are not covered by the product liability regulations.

1.2 Intended Use

This single column vehicle lift is classified as movable model. Movable single column vehicle lift is specially useful for indoor. It is the special equipments for lifting vehicles, such as cars, which park on ground, to a certain height for maintenance. It is forbidding to park vehicles. Observe the rated load capacity and load distribution of the lift.

1.3 Safety Instructions for Commissioning

- The lift may be installed and commissioned by authorized service personnel only.
- The standard lift version may not be installed and commissioned in the vicinity of explosives or flammable liquids, outdoors or in moist rooms (e.g. car wash).

1.4 Safety Instructions for Operation

- Read the operating manual.
- Lift operation by authorized personnel over 18 years only.
- Always keep the lift and lift area clean and free of tools, parts, debris etc.
- Once the disk adapters contact the lift points, check arm restraints for engagement.
- After raising the vehicle briefly, stop and check the disk adapters for secure contact.
- Always lift the vehicle using all four adapters.
- Make sure the vehicle doors are closed during raising and lowering cycles.
- Closely watch the vehicle and the lift during raising and lowering cycles.
- Do not allow anyone to stay in lift area during raising and lowering cycles.
- Do not allow anyone on lift or inside raised vehicle.
- Only use the lift for its intended purpose.
- Comply with the applicable accident prevention regulations.
- Do not overload the lift. The rated load capacity is indicated on the lift nameplate.
- Only use the vehicle manufacturer's recommended lift points.
- After positioning the vehicle apply the parking brake.
- Use caution when removing or installing heavy components (center-of-gravity displacement).
- The main switch serves as emergency switch. In case of emergency turn to OFF position.
- Protect all parts of the electrical equipment from humidity and moisture.
- Protect the lift against unauthorized usage by padlocking the main switch.

1.5 Safety Instructions for Servicing

- Maintenance or repair work by authorized service personnel only.
- Turn off and padlock the main switch before doing any maintenance, or repair work.
- Work on pulse generators or proximity switches by authorized service personnel only.
- Work on the electrical equipment by certified electricians only.
- Ensure that ecologically harmful substances are disposed of only in accordance with the appropriate regulations.
- Do not use high pressure/steam jet cleaners or caustic cleaning agents. **Risk of damage!**
- Do not replace or override the safety devices.

1.6 Safety Features

1.6.1 Hold-to-run Type Control

The operator is required to hold the controls in the engaged position to raise or lower the lift.

1.6.2 Equalizing System

The lift is provided with distributing and connecting flow valve to ensure level movement of both carriages.

1.6.3 Pipe Break Valve

The hydraulic cylinders are equipped with pipe break valves. They respond in case of rapid pressure drop (line break) to prevent sudden lowering movements.







1.6.4 Pressure Relief Valve

A pressure relief valve is used to limit the hydraulic working pressure to a maximum of 200bar.

1.7 Warning labels

CAUTION	CAUTION
	
Lift to be used by trained operator only	Authorized personnel only in lift area
CAUTION	CAUTION
	
Use vehicle manufacturer's lift points	Always use safety stands when removing or installing heavy components
CAUTION	CAUTION
	
Use height extenders when necessary to ensure good contact	Auxiliary adapters may reduce load capacity
<small>TMG-AUTO-1006</small>	
The messages and pictographs shown are generic in nature and are meant to generally represent hazards common to all automotive lifts regardless of specific style.	

A

CAUTION	CAUTION
	
Clear area if vehicle is in danger of falling	Position vehicle with center of gravity midway between adapters
CAUTION	CAUTION
	
Remain clear of the lift when raising or lowering vehicle	Avoid excessive rocking of vehicle while on lift
CAUTION	CAUTION
	
Do not override self-closing lift controls	Keep feet clear of lift while lowering
<small>TMG-AUTO-1007</small>	
The messages and pictographs shown are generic in nature and are meant to generally represent hazards common to all automotive lifts regardless of specific style.	

B

ATTENTION
6000lb 2722kg
MAXIMUM LIFTING CAPACITY
⚠ DANGER ⚠
Exceeding the weight capacity of this lift can damage lift and/or property and may cause personal harm, injury or death to operators and/or bystanders. All vehicles MUST be positioned on the lift with CENTER OF GRAVITY midway between adapters and/or centered on runways. Damage to lift due to overloading or misuse IS NOT covered under warranty.
<small>TMG-AUTO-1003</small>

C

CAUTION	CAUTION
 Read operating and safety manuals before using lift	 Proper maintenance and inspection is necessary for safe operation
CAUTION	The messages and pictographs shown are generic in nature and are meant to generally represent hazards common to all automotive lifts regardless of specific style.
 Do not operate a damaged lift	

WARNING

VEHICLE'S CENTER OF GRAVITY MUST BE CLOSE TO THE COLUMN

TMG-AUTO-1009

E

TMG™ INDUSTRIAL

6000lb PORTABLE SINGLE POST AUTO LIFT

MODEL **TMG-ALSP60**

www.tmgindustrial.com Headquarters in Richmond BC, Canada

CUSTOMER SERVICE & PARTS 1-877-761-2819 cs@tmgindustrial.com

F

D

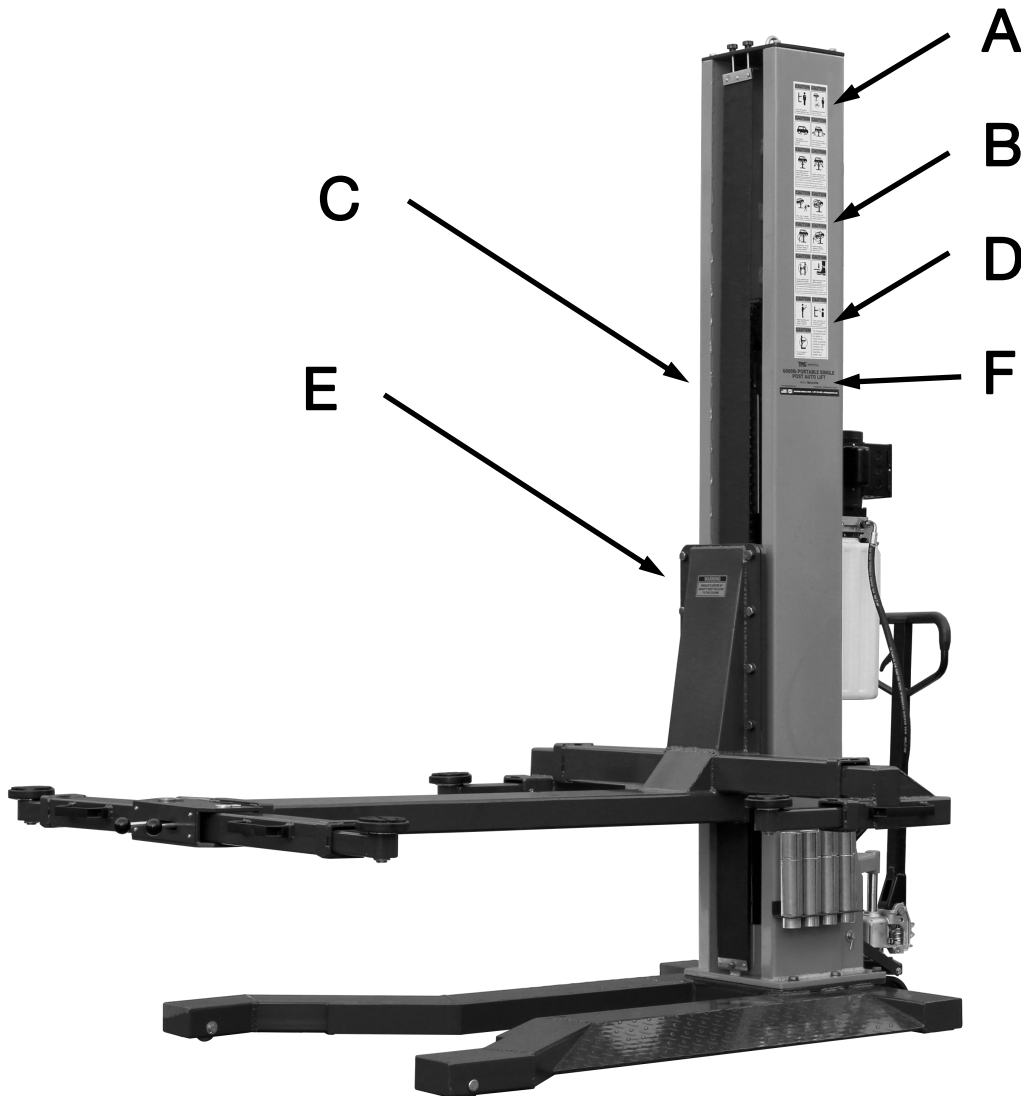

1.8 Disposal of used oil

Used oil, which is removed from the power unit and the plant during an oil change, must be treated as a polluting product, in accordance with the legal prescriptions of the country in which the lift is installed.

1.9 Machine demolition

The machine must be demolished by authorized technicians, just like for assembling. The metallic parts can be scrapped as iron. In any case, all the materials deriving from the demolition must be disposed of in accordance with the current standards of the country in which the rack is installed. Finally, it should be recalled that for tax purposes, demolition must be documented; submitting claims and documents according to the current laws in the country in which the rack is installed at the time the machine is demolished.

2. Structure Drawing:

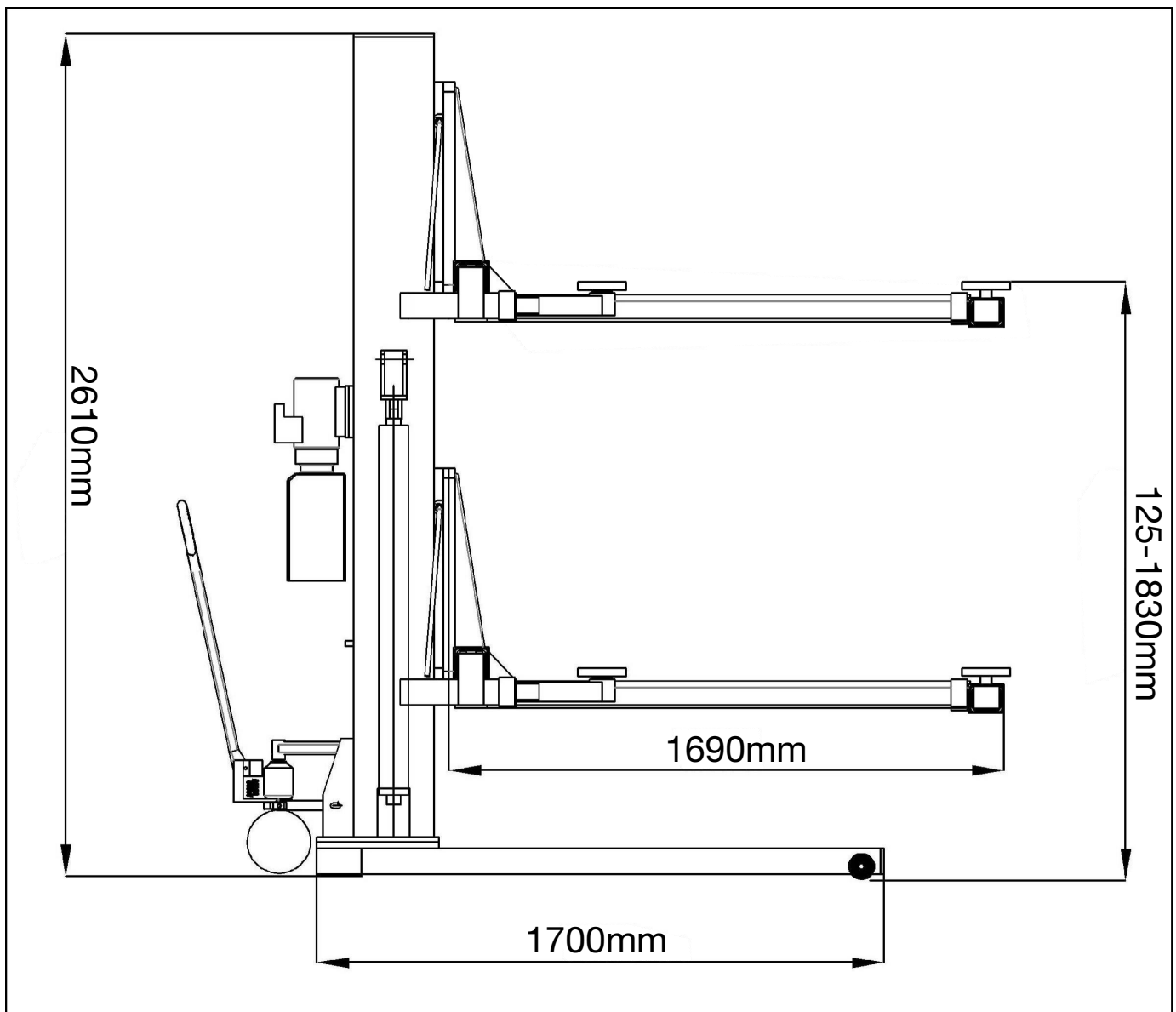

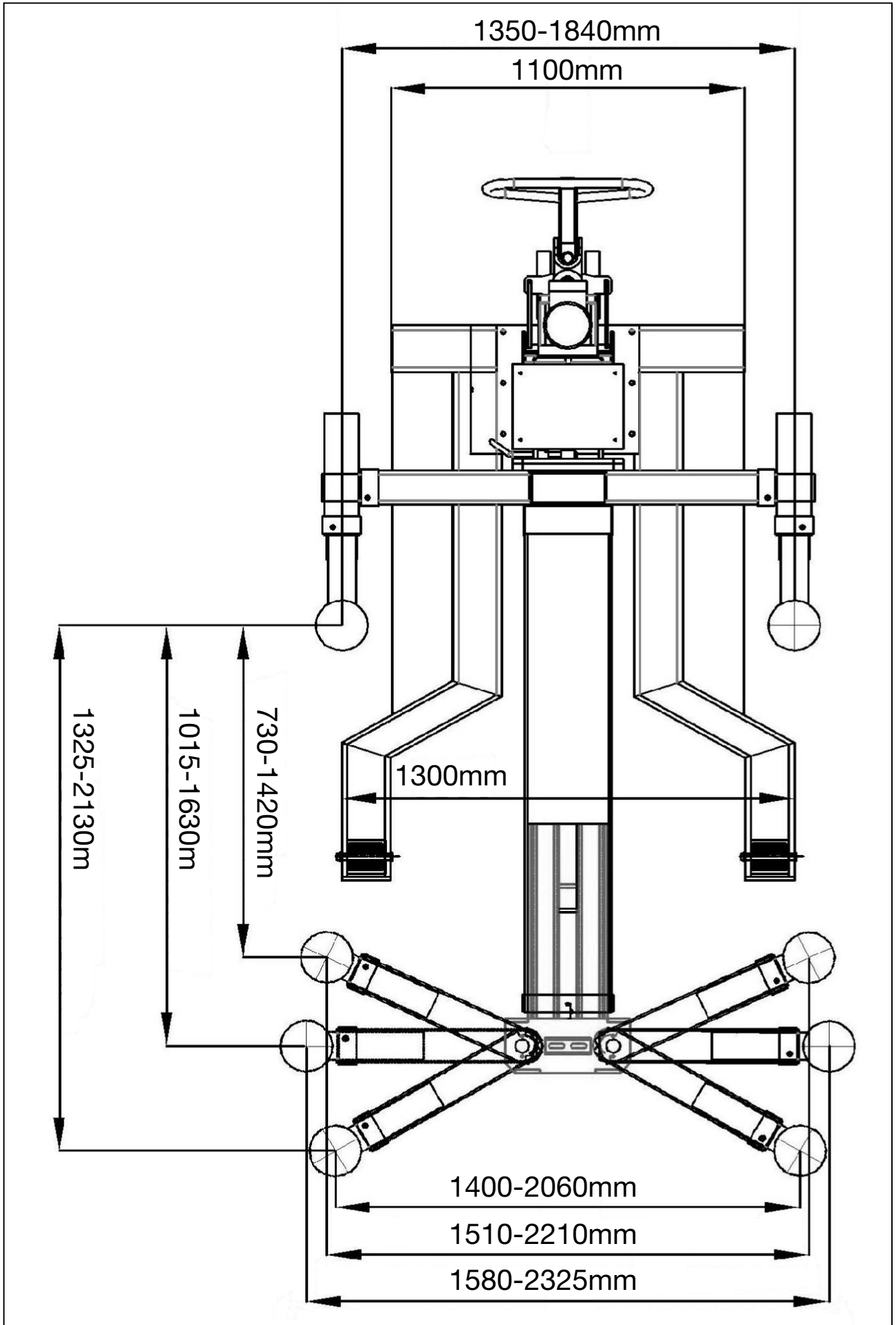

3. Main Technical Mechanism Parameters Table

3.1 Products Specifications

	TMG-ALSP60
Lifting capacity:	6000lbs(2700kg)
Max. lifting height	72”(1830 mm)
Width of vehicle lifted	≤1800 mm
Lifting speed	50mm/s
Working voltage	AC110V/60Hz, Single Phase
Power	3HP(2.2kw)
Safety catch	Manual
Noise	<70 dB
Working environment	Indoors
Working environment	-5 °C/+40°C
Overall dimension (length*wide*high)	2830x1950x2610mm
Weight	855kg

3.2 Parts Identification and Features

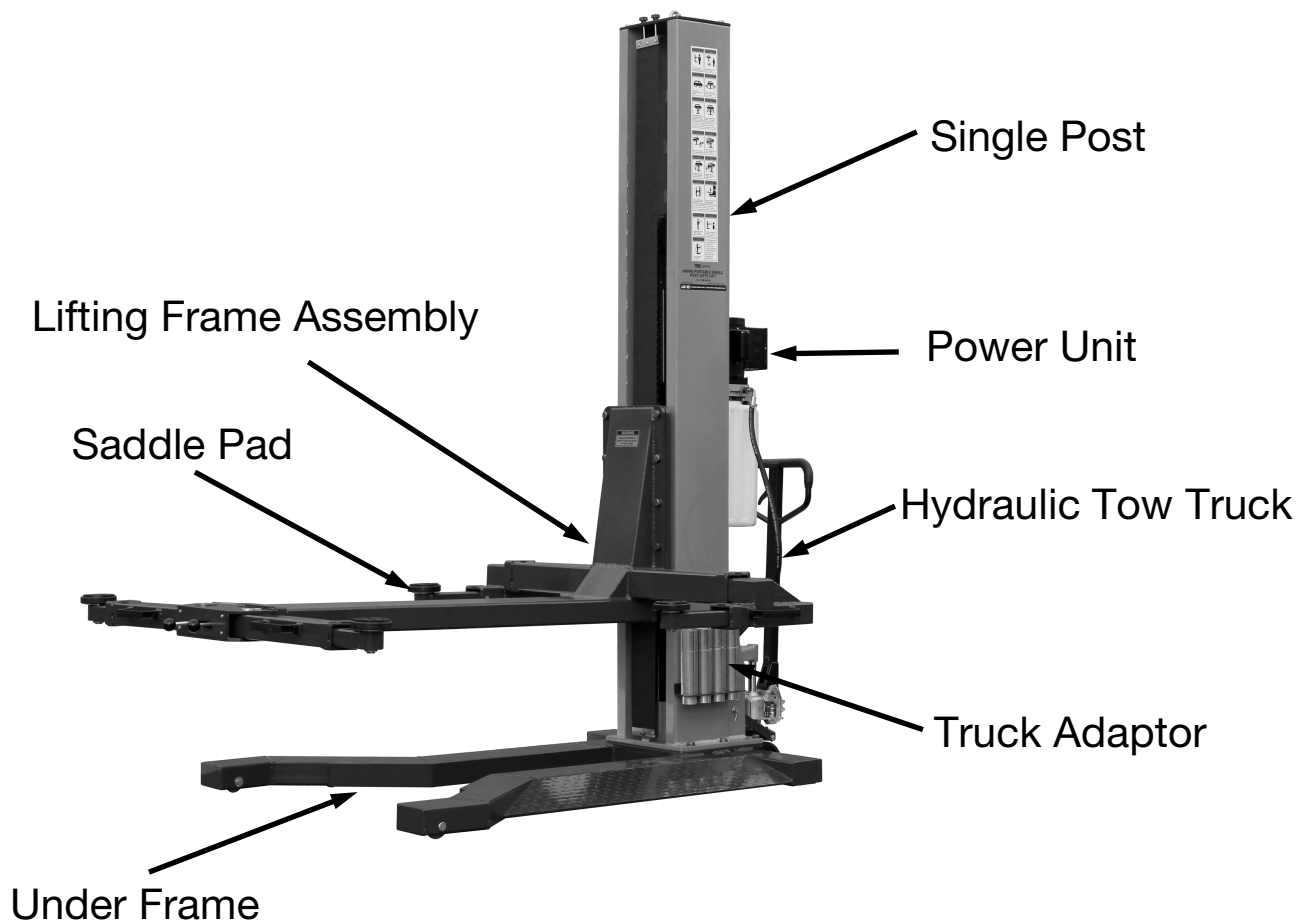

4. Packing, transport and storage



Only skilled personnel who are familiar with the lift and this manual shall be allowed to carry out packing, lifting, handling, transport and unpacking operations.

4.1 Packing

90% components were pre-assembled before shipment, and packed with blister packing in wood carton. Arms, adapters and rubber pads were put in the lift. Power unit was packed in carton box separately, power unit stand was packed and fixed on above the lifts.

4.2 Lifting and handling

When loading/unloading or transporting the equipment to the site, be sure to use suitable loading (e.g. cranes, trucks) and hoisting means. Be sure also to hoist and transport the components securely so that they cannot drop, taking into consideration the package's size, weight and centre of gravity and its fragile parts.

4.3 Storage and stacking of packages

Packages must be stored in a covered place, out of direct sunlight and in low humidity, at a temperature between -10°C and +40°C.

4.4 Delivery and check of packages

When the lift is delivered, check for possible damages due to transport and storage; verify that what is specified in the manufacturer's confirmation of order is included. In case of damage in transit, the customer must immediately inform the carrier of the problem.

Packages must be opened paying attention not to cause damage to people (keep a safe distance when opening straps) and parts of the lift (be careful the objects do not drop from the package when opening).

5. Installation

5.1 Working Site

The user should prepare the working site for the lift before its arrival

5.1.1 Power Source

The working site must be equipped with certain power. Install safety distribution box with a 4-hole socket around the operation position.

5.1.2 Ground

The lift must be placed on flat and hard ground, which is made of cement or bricks, with the load at the position of vertical post of 3t/m².

5.1.3 Working Area

There should be >about 1,000mm space around the vehicle lifted, and the net height indoor is about 3600mm.

5.2 Installation

Because of the limitation of transportation, lift shall be disassembled to pack. The users should assemble the lift according to the following figure:



WARNING- READ AND FOLLOW ALL INSTRUCTIONS

- Failure to follow all instructions in this manual may result in severe personal injury or death. Keep this manual and refer to it for Safety Instructions, Operating Procedures, and Warranty.



Overall assembly as follows:

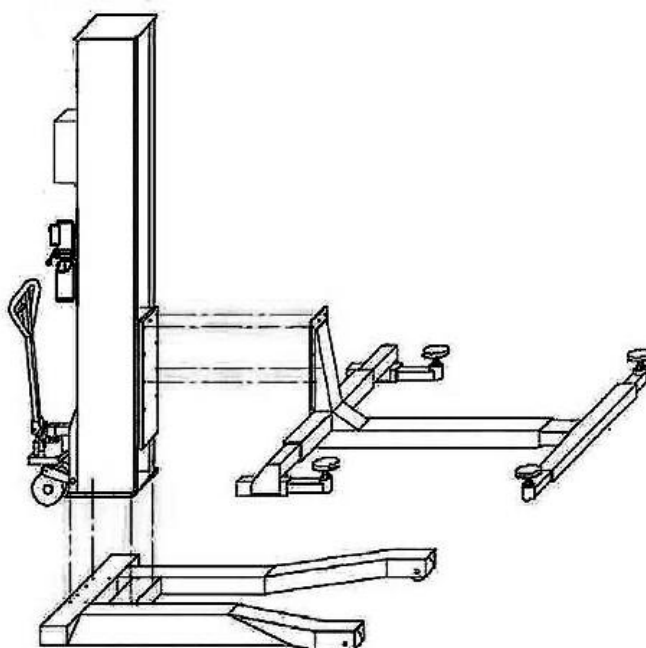

5.2.1 After unpacking, check the following components

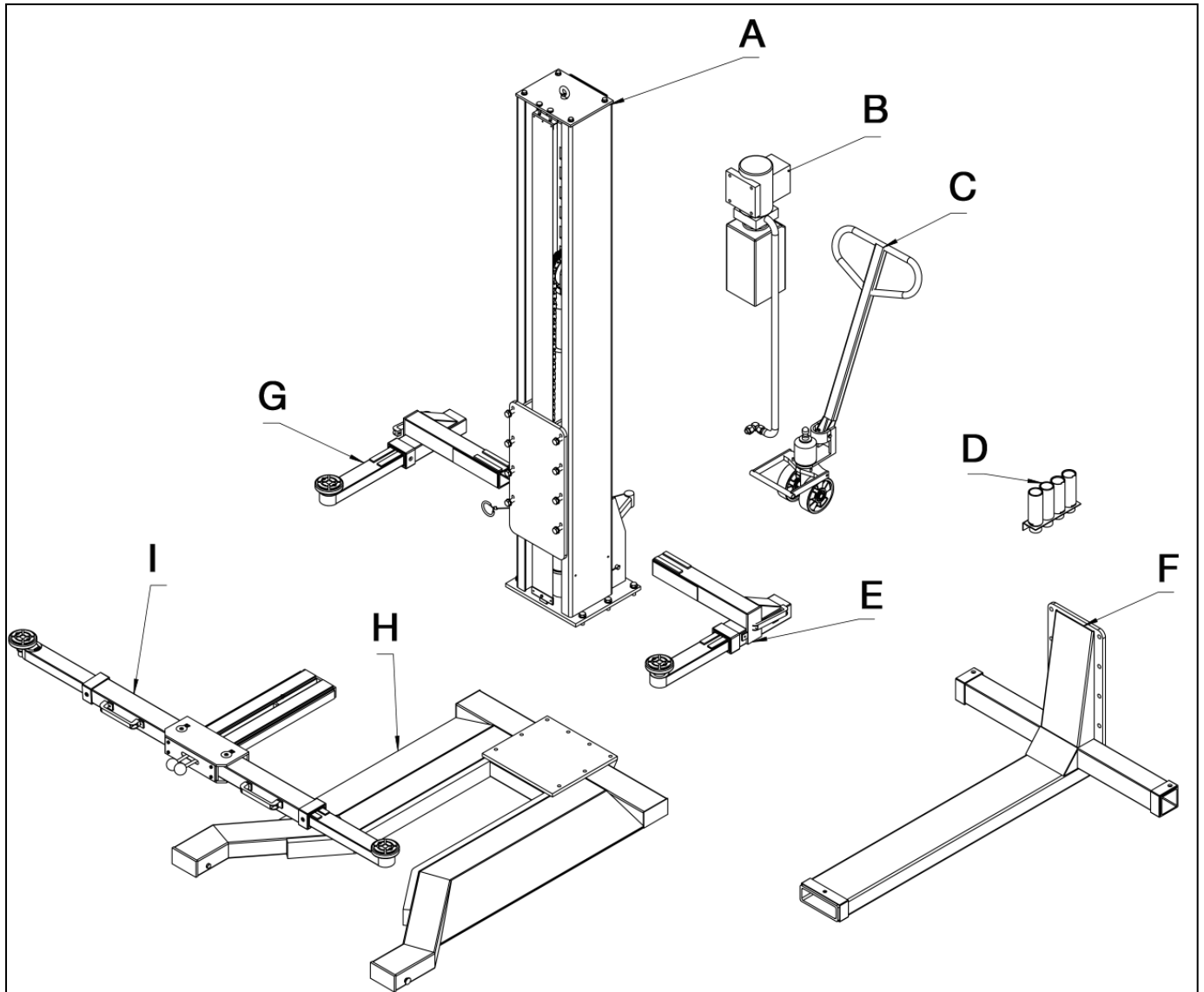

No	Description	Quantity	No	Description	Quantity
A	Stand column assembly	1	F	Lifting frame assembly	1
B	Power unit assembly	1	G	Back arm assembly	1
C	Tow truck assembly	1	H	Under frame assembly	1
D	Extension support	1	I	Front arm assembly	1
E	Back arm assembly	1			

5.2.2 Installation Lifting Frame Assembly

1. Choose a flat and empty site, open the package, find the under frame and lifting frame.

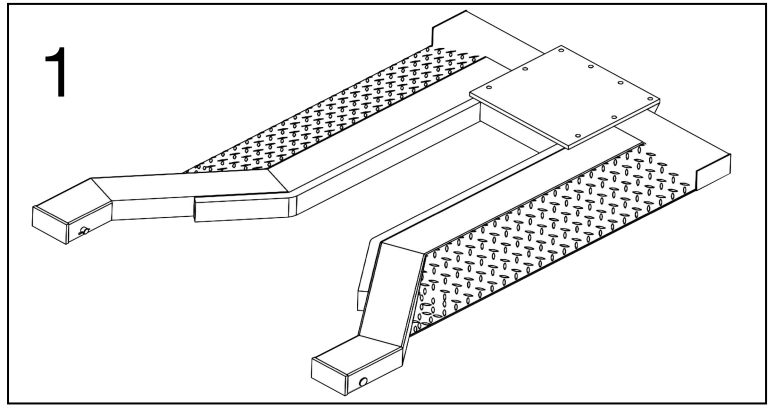
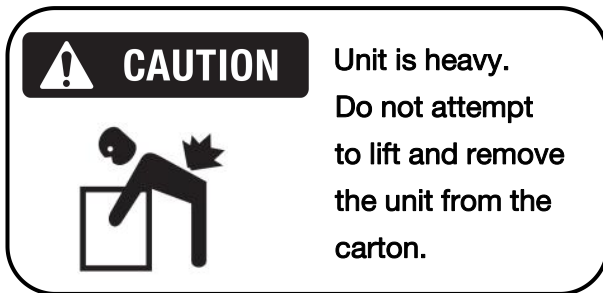

2. Place the under frame(1) and lifting frame(12) on the ground

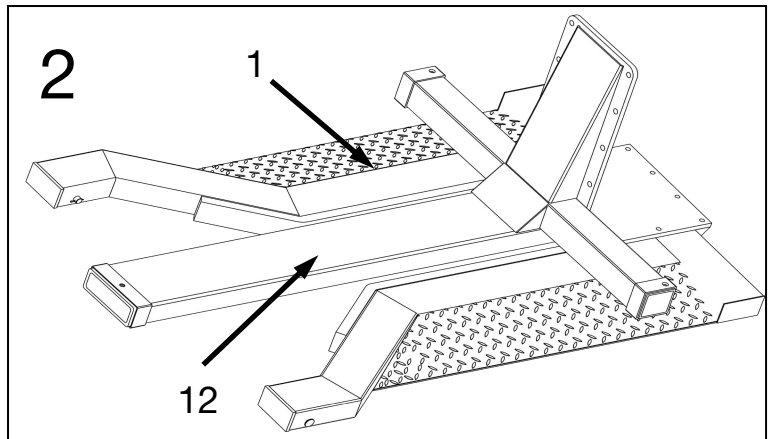

3. Install longer arm(15), whirling arm(22) and front telescopic boom(25)

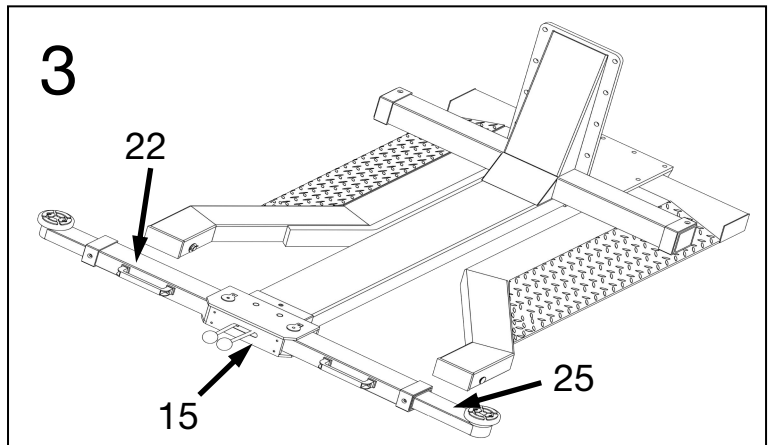

4. Install back telescopic boom(horizontal) (13), and back telescopic boom(14)

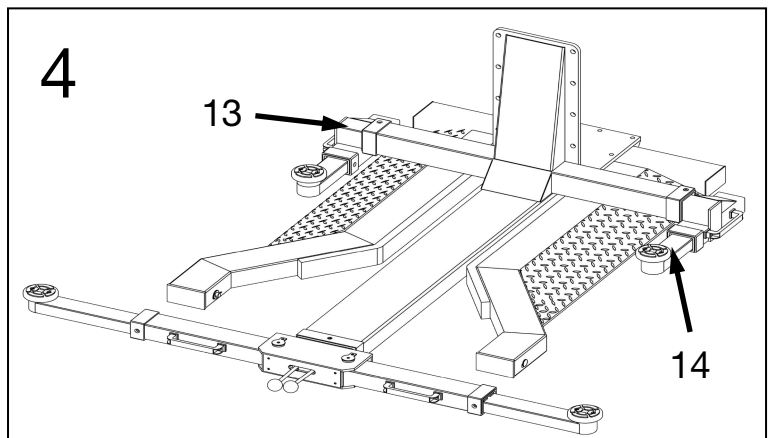

5. Install the post(2) on the under frame(1), and tighten all bolts with under frame and lifting frame.

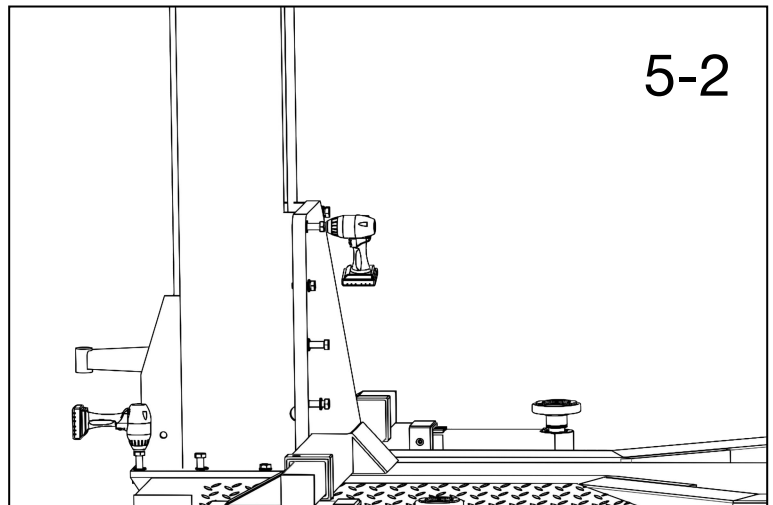
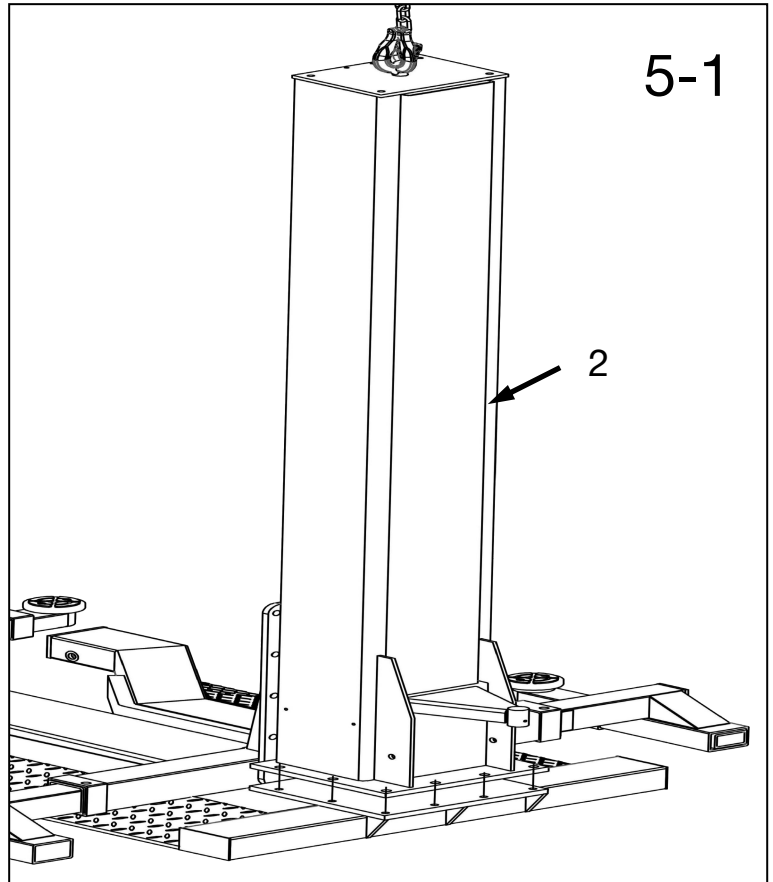

6. Install the hydraulic tow truck(43)



WARNING

- To avoid serious bodily injury or death, and/or property damage. Do not exceed the rated load capacity.
- When not in use, do not allow heavy loads to remain on the under frame an extended period of time, Always lower the hydraulic pump completely when not in use.

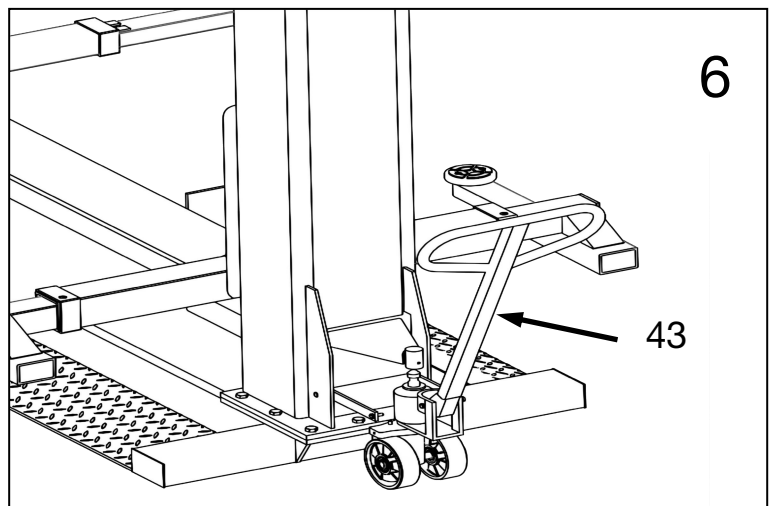

7. Install the power unit(49),
connect the hydraulic hose (50)
from the power unit to cylinder(30)



WARNING

RISK OF EXPLOSION!

This equipment has internal arcing or parts that may spark and should not be exposed to flammable vapors. Motor should not be located in a recessed area or below floor level. NEVER expose motor to rain or other damp environments. DAMAGE TO MOTOR CAUSED BY WATER IS NOT COVERED UNDER WARRANTY.



DANGER

ALL WIRING MUST BE PERFORMED BY A LICENSED ELECTRICIAN.



DANGER

DO NOT PERFORM ANY MAINTENANCE OR INSTALLATION OF ANY COMPONENTS WITH OUT FIRST ENSURING THAT ELECTRICAL POWER HAS BEEN DISCONNECTED AT THE SOURCE OR PANEL AND CANNOT BE RE-ENERGIZED UNTIL ALL MAINTENANCE AND/OR INSTALLATION PROCEDURES ARE COMPLETED.

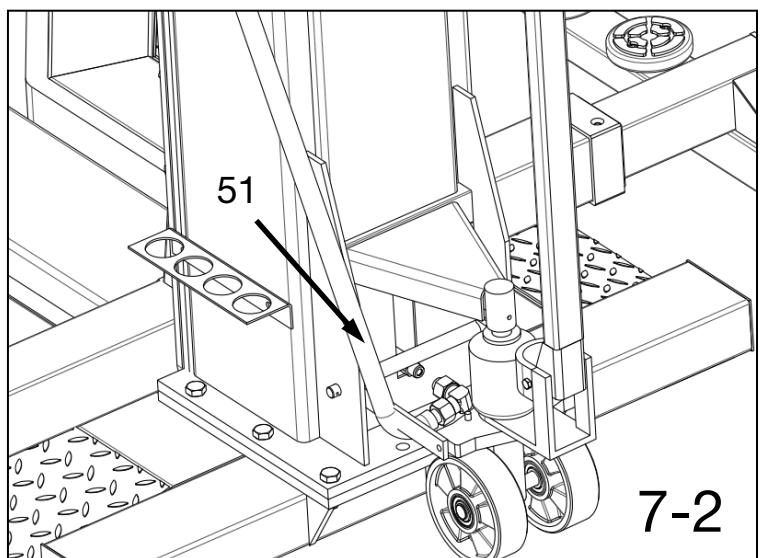
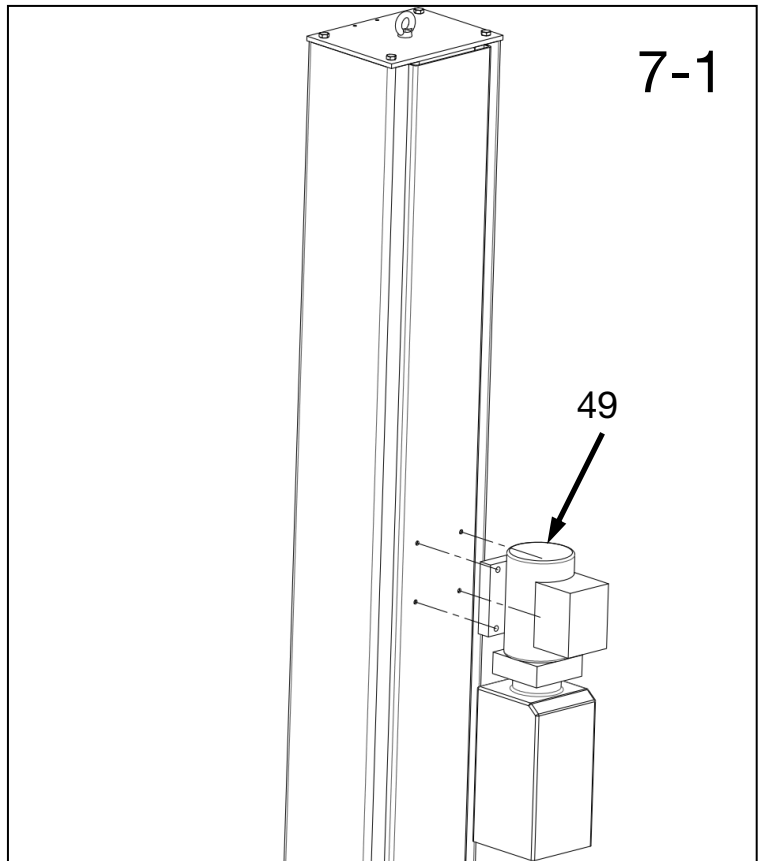

WARNING

- DO NOT run power unit with no oil. Damage to pump can occur.
- The power unit must be kept dry. Damage to power unit caused by water or other liquids such as detergents, acid etc., is not covered under warranty.
- Operate lift only between temperatures of 41 °- 104° F.
- Improper electrical hook-up can damage motor and will not be covered under warranty.
- Motor can not run on 50HZ without a physical change in motor.
- Use a separate breaker for each power unit.
- Protect each circuit with time delay fuse or circuit breaker.
- For 110-120 volt, single phase, use a 25 amp fuse.

6. Operation instruction

6.1 Operation Rules for mechanism System

6.1.1 The movable single column lift is provided with separate traveling mechanism. Shake the hauling handle of the steering rear wheel forwards and backwards to make the vertical column off the ground, then you can push or pull the lift. On arriving the working site, press the valve handle to retract the wheel, then the vertical column lands on the ground steadily.

6.1.2 The lift must only be pushed into the vehicle if in line with it. Insert the pallet under the vehicle beam and the pallet must be in line with the beam.

6.1.3 Retract the rear wheel of vertical post to land the vertical post steadily before the lift lifts load, and make sure there is no foreign article such as hand tools, bolts, screw caps, small stones. No lifting during moving!

6.2 Operating Steps for Electrical Control System

New machine is operated for commissioning without load before its first use. which should be turned off after the machine use finished.

6.3 Operation Flow:

- 1) Vehicle stops in the service position with engine off
- 2) Turn the handle for hydraulic movable wheel to lift the vertical post base a bit

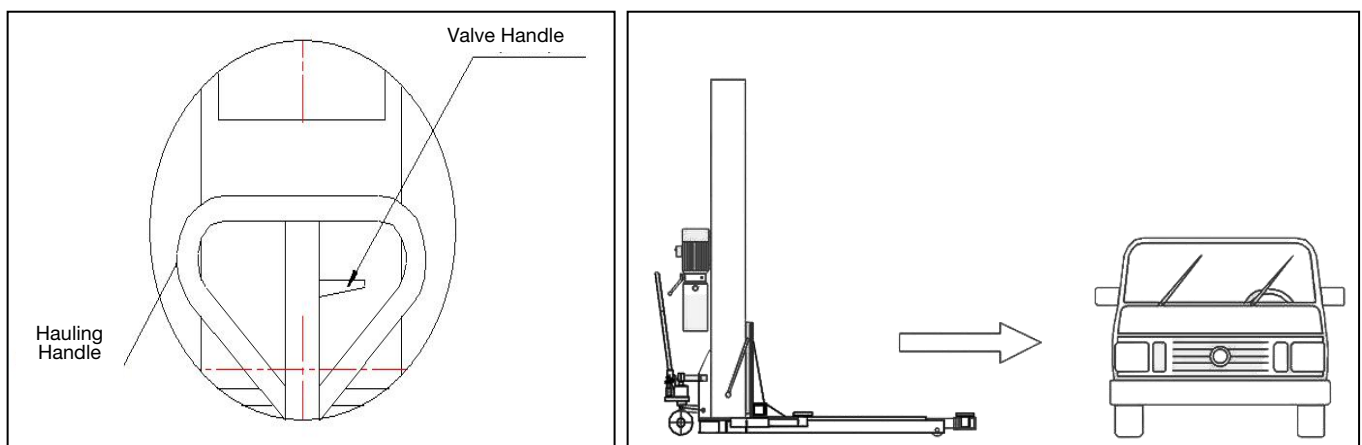

- 3) Push the lift into the underside of vehicle
- 4) Make sure there is no foreign articles under the base and the ground is level
- 5) Grasp the valve handle to make the base lowered to ground
- 6) Align 4 pallets on the lifting arm respectively to the supported positions on the vehicle underside
- 7) Press the button to raise the vehicle by 10~15 centimeters
- 8) Stop the vehicle raising and check for safe and secure four high points of the pallet.
- 9) Check if the main lifting arm touches the vehicle bottom plate, which should not occur during normal lifting.

- 10) Pull the safety unlock handle to make the flitting platform unlocked.
- 11) To adjust lifting pad, turn it anticlockwise to make it rise (adjustment distance of 100mm)
- 12) Press the button again and pay attention to lifting arm and the vehicle lifted until lifting is safe and reliable.
- 13) Raise the lift to the required height, then lower it to the lock position
- 14) After the repair of vehicle is finished, raise the lift about 2-3cm, pull the release cable on the column, then push the lowering handle on power unit to lower the lift.
- 15) Turn the handle of hydraulic pump and the lift is off the ground, pull out the lift.
- 16) Drive the vehicle away.

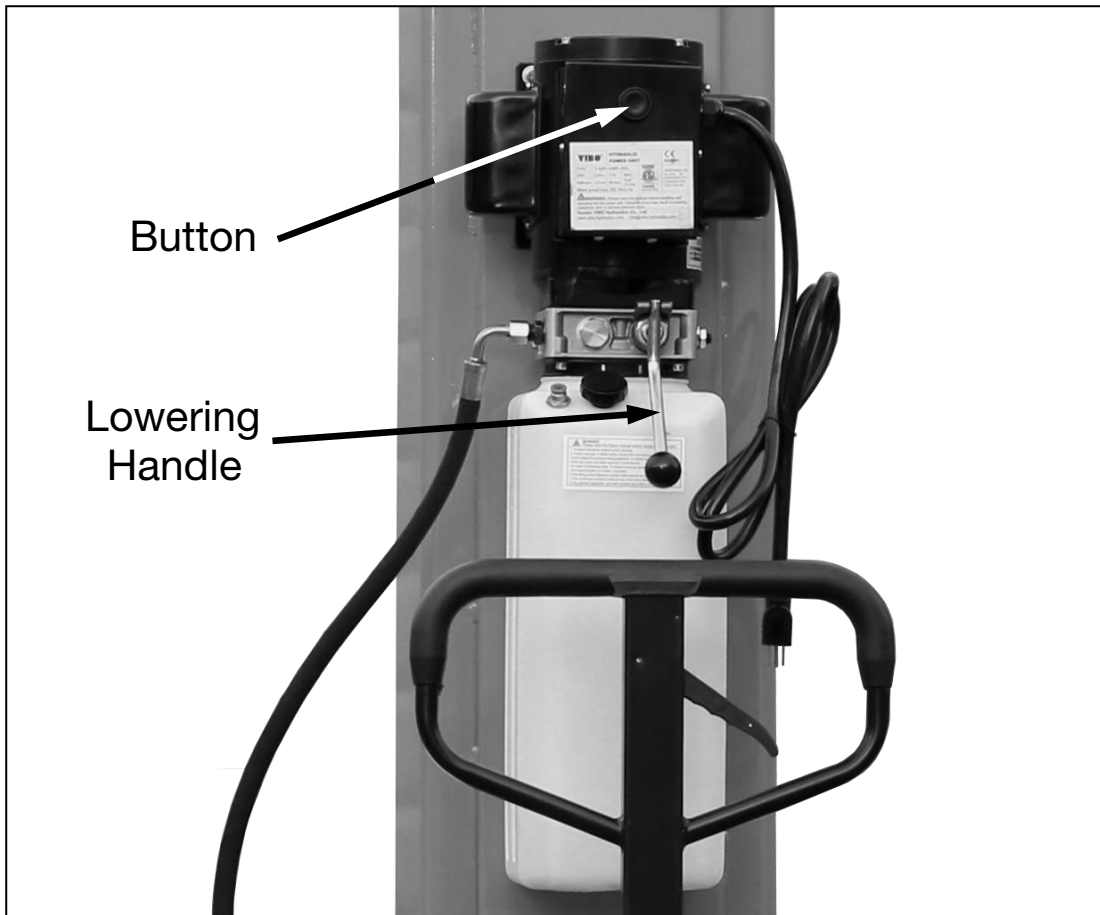

6.4 Use lifting arm

6.4.1 Movable Lift

- a. According to the position under the vehicle chassis where the lifting arm is located, the supporting arm on the lifting arm (close to the vertical post) may be pushed and pulled up and down or to left and right, as the following figure:

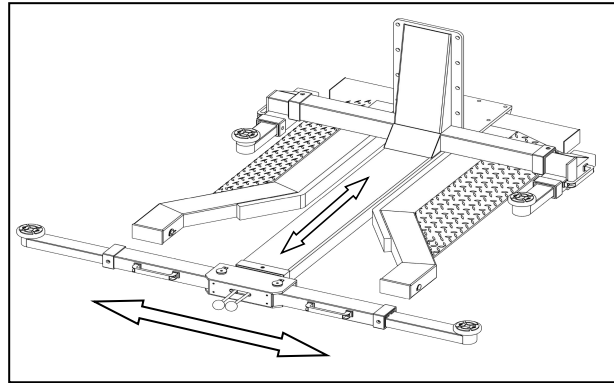
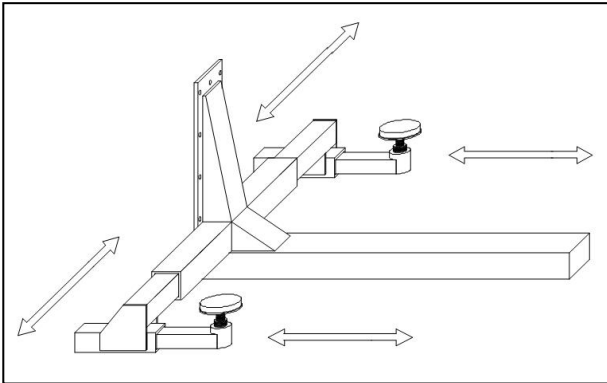

- b. According to the car type, the supporting arm in the outer of lifting arm may be pushed or pulled inward or outward, or to left and right.
- c. The height of pallet can be adjusted by turning it clockwise or anticlockwise.

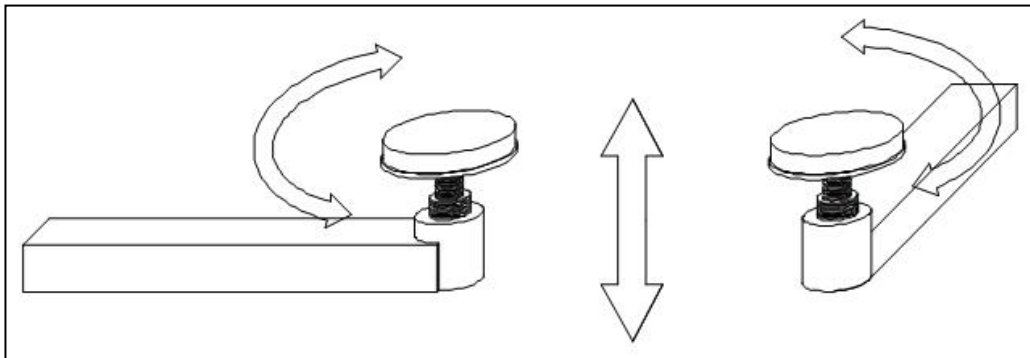

7. Maintenance

7.1.1 For daily maintenance and service of the lift, see operation steps, use and cautions described in the previous page.

7.1.2 The working environment and the surface of this machine should be cleaned usually.

7.1.3 During the use of this machine, if any oil leaking is found, check the leakage source. Check whether the screw of the hydraulic oil hose is tighten, if it is loosen, it should be tighten. After this step, if the leaking problem still occurs, check whether the seal kit of the cylinder is damaged, if it is damaged, it must be replaced.

8. Troubleshooting

If lifting is impossible:

Check the power, the power unit use AC 110~120V/60Hz single phase

If lifting is possible but impossible to load 2.7T

Adjust the fluid valve. It is possible to press the button while turn the screw clockwise) slowly, until the lifting arm rises.

If lifting is still impossible after above actions have been taken

Remove fluid valve and put it into diesel oil to wash. After that, install it again and operate according to above action once more.

If there is any abnormal noise from hydraulic system during lifting

The hydraulic system may inhale air or the power voltage is too low. Check the oil level and add oil if necessary. Move the cylinder up and down for several times to expel the air.

9. Parts Breakdown

1. Exploded Drawing

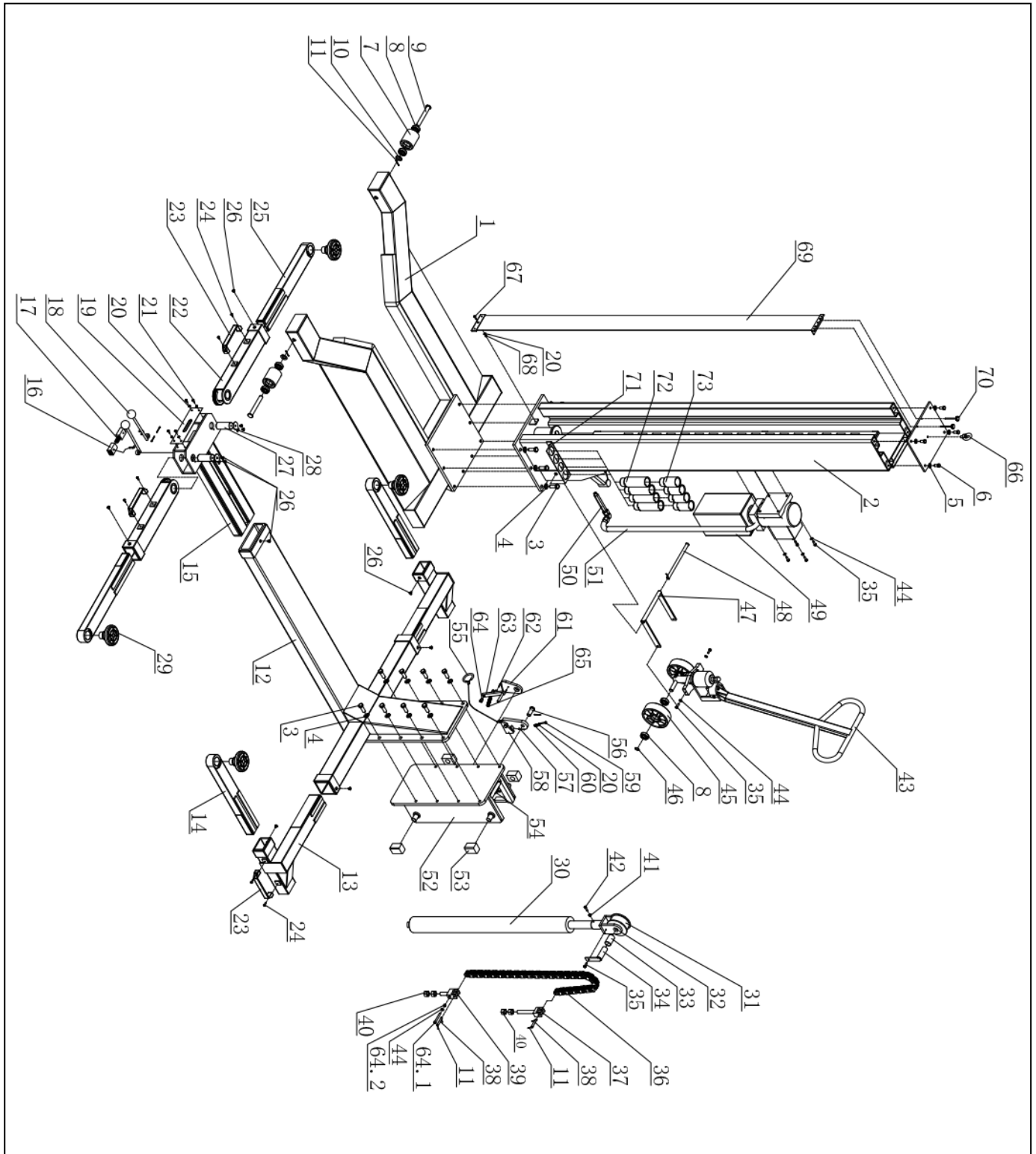

2. Parts List

Ref#	Description	Qty	Ref#	Description	Qty
1	Under frame	1	38	Fixed pin	2
2	Stand column	1	39	Lower fixed seat	1
3	Outer hexagon screw	16	40	Nut M20	4
4	Washer Φ 16	16	41	Nut M8	1
5	Washer Φ 12	4	42	Inner hexagon screw M8x25	1
6	Outer hexagon screw	4	43	Draw-bar	1
7	Loading roller	2	44	Washer \O 8	6
8	Bearing 62042RS	8	45	Loading wheel \O 160x50	2
9	Shaft for front wheel	2	46	Jump ring Φ 20	2
10	Washer \O 20	2	47	Joining beam	1
11	Snap pin 3.2x35	9	48	Axis pin	1
12	Lifting frame	1	49	Power unit	1
13	Back telescopic boom (horizontal)	2	50	Oil pipe connection	1
14	Back telescopic boom	2	51	High-pressure oil pipe	1
15	Longer arm	1	52	Elevating scaffold	1
16	Gear rack	2	53	Sliding block	4
17	Spring \O 18x2x70	1	54	Tension spring \O 13.2x \O 1.2X98	1
18	Ball handle	2	55	Unlocking handle	1
19	Flapper	1	56	Axis pin	1
20	Washer Φ 6	14	57	Locking plate	1
21	Button-headed screw M6x10	4	58	Shaking plate	1
22	Whirling arm	2	59	Inner hexagon screw M6x40	1
23	Plastic handle	4	60	Spring \O 10x1.2x30	1
24	Sunk screw M6x10	8	61	Insurance rod	1
25	Front telescopic boom	2	62	Insurance stop	1
26	Sunk screw M8x10	11	63	Insurance mat tube	1
27	Pin shaft	2	64-1	Inner hexagon screw M8x70	1
28	Pin shaft cover	2	64-2	Locking nut M8	1
29	Pallet	4	65	Spring	1
30	Hydraulic cylinder	1	66	O ring screw M12	1
31	Chain wheel	1	67	Screw M6x20	1
32	Chain fixed seat	1	68	Nut M6	1
33	Bush	1	69	Dust cover	1
34	Sheave pin	1	70	Hanger M6x60	2
35	Outer hexagon screw M8x25	7	71	Extension kit mounting seat	1
36	Plate type chain	1	72	Extension support long	4
37	Upper fixed seat	1	73	Extension support short	4

3. Hydraulic Diagram

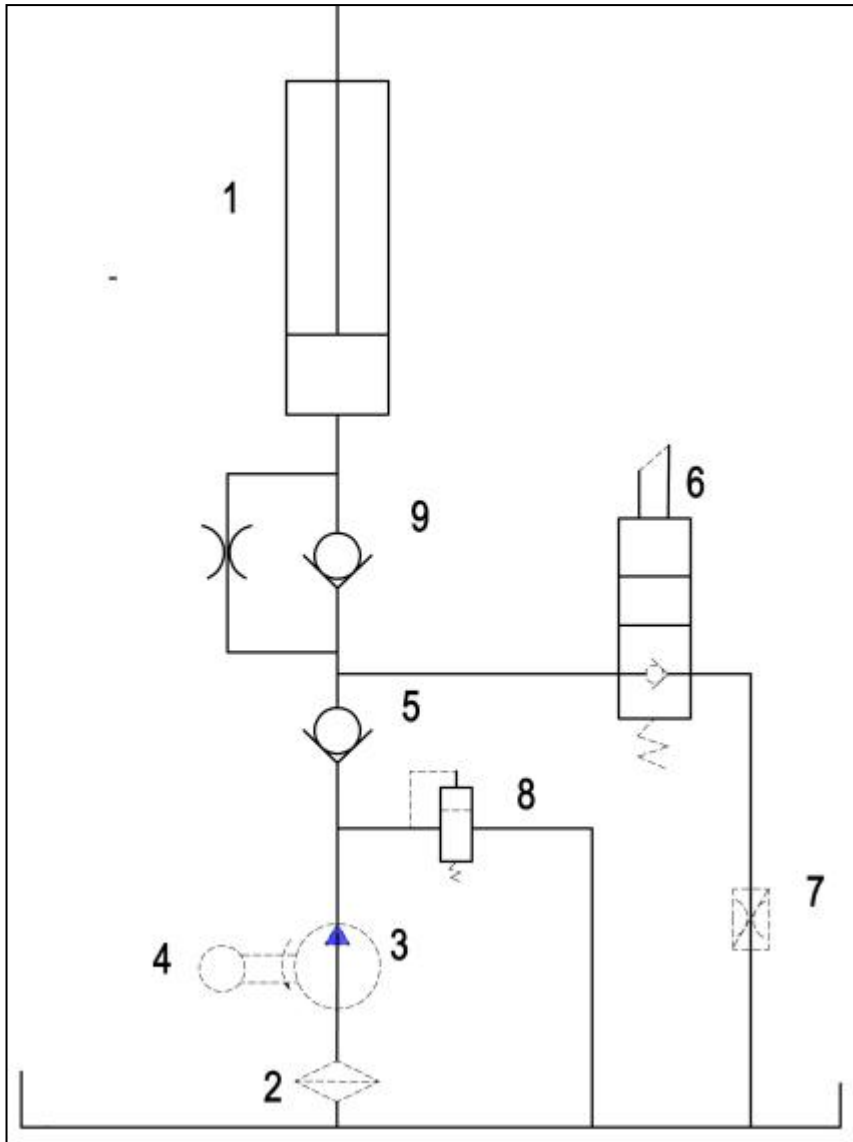

1. Cylinder	2. Filter	3. Oil pump	4. Motor
5. One-way valve	6. Manual release valve	7. Throttle valve	8. Relief valve
9. Anti-leakage valve			