

1500-LB MOTORCYCLE/ ATV JACK LIFT

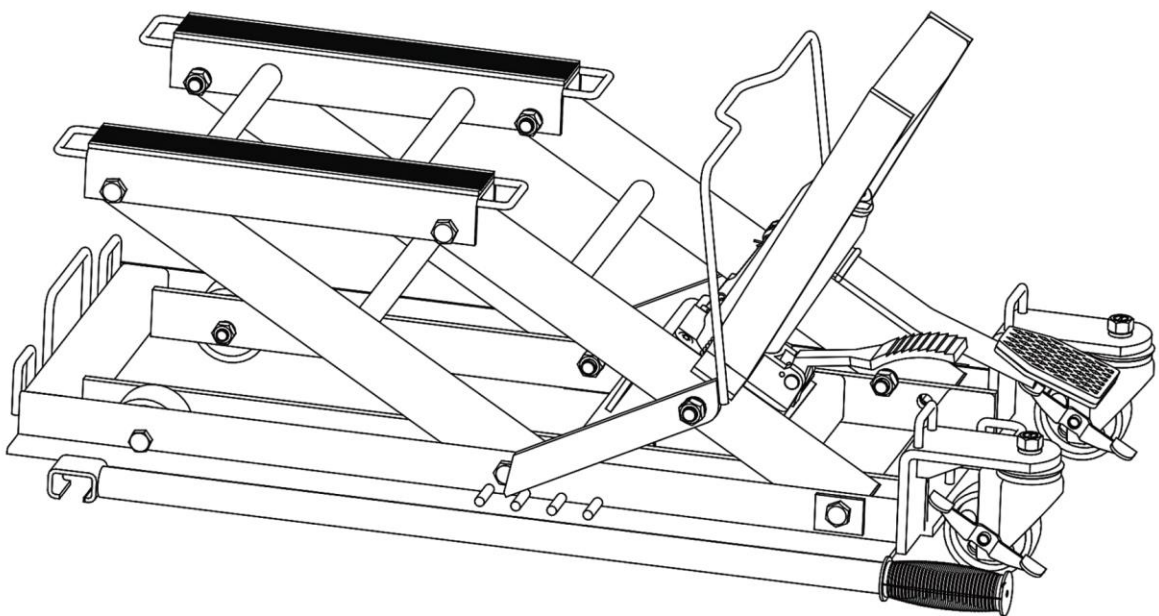

⚠ WARNING



- Please read and understand the product manual completely before assembly
- Check against the parts list to make sure all parts are received
- Wear proper safety goggles or other protective gears while in assembly
- Do not return the product to dealer. They are not equipped to handle your requests.

Missing parts or have questions on assembly?

Please call: 1-877-761-2819 or email: cs@tmgindustrial.com

WARNING

This Hydraulic Jack is designed for use by professional auto mechanics.

It is designed for lifting and lowering a vehicle load.

The bottle Jack should not be used as a stand to hold load for any prolonged period. Use the safety arm to support weight.

Failure to heed this warning may result in loss of load, damage to jack and/or jack failure resulting in personal injury or property damage.

SAFETY INSTRUCTIONS

- Please make sure to read and understand these instructions before operating motorcycle jack
- Do not exceed the 600kg load limit.
- Keep hands clear of all moving parts when operating jack.
- Release relief valve slowly when lowering motorcycle.
- Do not place body or body parts under the raised motorcycle.
- Do not use jack on inclined surfaces, use on a smooth, level and stable surface.
- Secure motorcycle with tight strap hooked to the jack frame before lifting.
- Do not start the motorcycle while it is loaded on the jack.
- Lift motorcycle to the minimum required height for working on motorcycle.
- Replace jack with vehicle stands if supporting motorcycle for prolonged periods.

SPECIFICATIONS

Working load limit 1500LB-

Height lowered: 140mm

Height raised: 450mm

Dimensions: 920x440x155mm

360° locking swivel castors

4 locking positions

ASSEMBLY

1. Insert the hydraulic ram head into the lifting frame then secure ram base to the lift base with M8*20 screws.
2. Secure safety bar with M8 nuts.

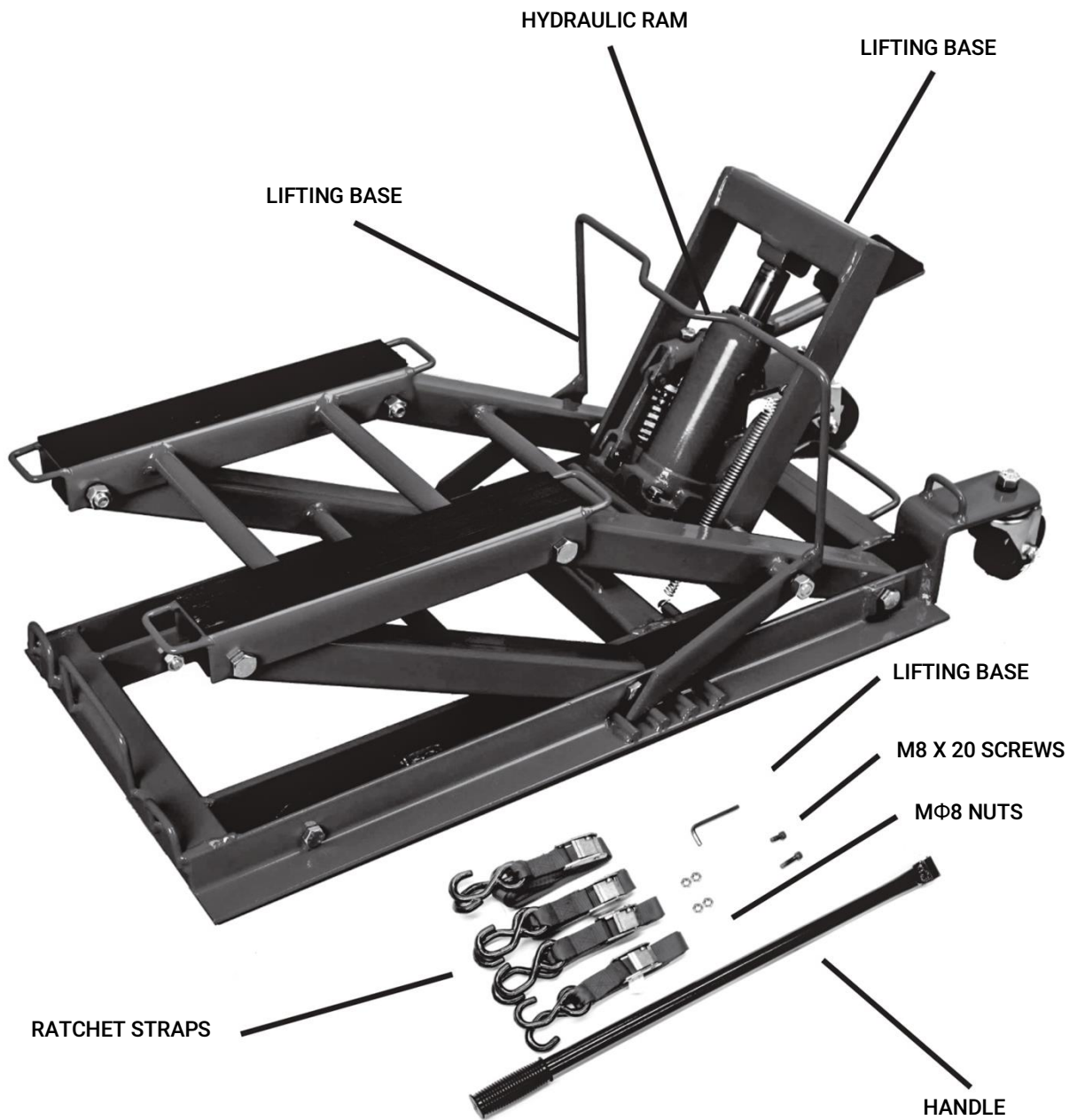

PARTS BREAKDOWN AND LIST

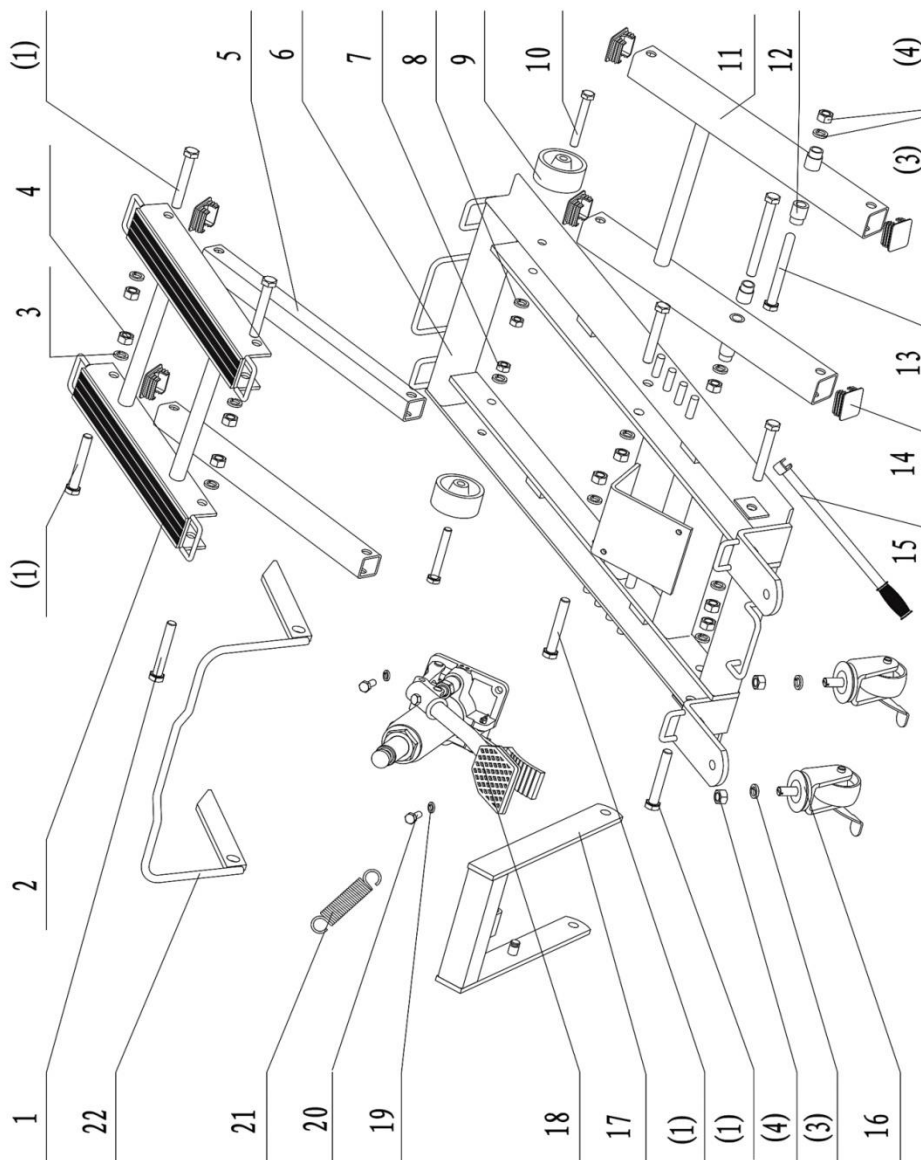

PARTS NO.	PARTS DESCRIPTION	QTY
1	Bolt M12x80	8
2	Saddle	1
3	lock washer 12	10
4	nut M12	10
5	front lifting arm	1
6	base	1
7	nut M10	2
8	lock washer 10	2
9	front wheel	2
10	BOLT M10x70	2
11	rear lifting arm	1

PARTS NO.	PARTS DESCRIPTION	QTY
12	outer thimble	2
13	BOLT M12x110	2
14	block	6
15	handle	1
16	caster assembly	2
17	lifting frame	1
18	hydraulic parts	1
19	BOLT M8x25	2
20	lock washer 8	2
21	tension spring	1
22	safety link rod	1

USE AND OPERATION

1. To raise jack, centre it directly below vehicle to be lifted. Lock release valve by turning fully clockwise. Pump the foot pedal repeatedly until the saddle fully takes up the weight and the tyres just leave the floor. Adjust position if required ensuring vehicle is centred, balanced and in no danger of slipping or tipping once fully raised.
2. Secure the load to the jack tightly with straps using the steel loops located on the frame.
3. Continue to raise jack slowly by pumping the foot pedal until desired height is achieved,
4. The jack is not designed to continuously support a load. You must engage the safety arm to support the weight. Lower the safety arm into one of the four welding strips located on the frame. Lower the vehicle slowly by pressing the release pedal until the frame is supporting the weight.
5. To lower jack repeat step 1 and raise jack slightly to disengage the safety arm,
6. Gently press the release pedal to lower the jack. Unfasten straps & remove jack.

SYSTEM AIR PURGE

1. Press the release pedal to lower the jack.
2. Pump foot pedal eight full strokes.
3. Press the release pedal to lower the jack
4. Pump foot pedal until the ram reaches maximum height and continue to pump several times to remove trapped air in the ram.
5. Carefully and slowly pinch oil fill plug to release trapped air
6. Gently press the release pedal to lower the jack.
7. Turn release valve clockwise to closed position and check for proper pump action. It may be necessary to perform the above more than once to ensure the ram is free of air.

CHECK OIL LEVEL

1. With saddle lowered completely, remove oil plug located in hydraulic ram.
2. Drain fluid into appropriate container. Always dispose of oil in accordance with local regulations.
3. Use VG32 SAE 10 hydraulic jack oil. Fill until oil is level with inner cylinder as seen from the opening of the filler hole. Reinsert oil plug.

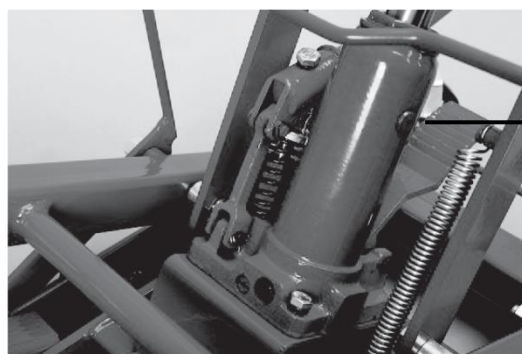

Oil plug.

MAINTENANCE

1. Lubricate the moving parts on the jack regularly with SAE 30W oil.
2. Moving parts include saddle, linkage on foot pedal, front & rear lifting arm joints. Always store jack in the fully lowered position.

MAINTENANCE

SYMPTOM	CAUSE	CORRECTIVE ACTION
Foot pump does not work	Air in the hydraulic system	Purge the air as per page 4
	Release valve not tightened	Tighten the release valve
	Overloaded	Remove partial overload
	Contaminated Hydraulic system	Replace Hydraulic Oil
Jack will not rise fully	Oil level too low	Add hydraulic oil