

# 1

## DELUXE SCANDINAVIAN - INSTALLATION

# PROLOK™

Installation instructions for fitting a Deluxe smart lock to a Scandinavian style mortice latch with Oval cylinder.

Common latch types include Assa Abloy 565, 765, 510 and Dorma 919. These have 105mm centres.

The lock will fit doors between 35mm and 50mm in thickness. The existing keyed cylinder needs to protrude at least 22mm from the surface of the door. .

If it does not then you will need cylinder extension pieces. These are not included but are available in various sizes



Please also refer to the additional installation instructions included in the box.



### OVERVIEW

The Deluxe Scandinavian smart lock uses 4 screws that fit through the existing holes in the mortice.

**IMPORTANT: Before drilling any holes in the door, make sure that your mortice is compatible.**



### STEP 1

Remove the existing handle and spindle. Offer up the smart lock and make sure that there is enough space between the lock body and door stop.

The Deluxe is 60mm in width including the rubber gasket. .



### STEP 2

Remove the existing keyed cylinder and keep for later.

In the box you will find the thumbturn extender.



### STEP 3

On the inside of the door, insert the thumbturn extender. From the door face, it must extend at least 15mm but not more than 30mm. If it is too long cut down accordingly, then remove. For thicker doors, you can buy a longer extender.



### STEP 4

On the outside of the door, insert the keyed cylinder and check the distance it projects from the door. Ideally it should extend at least 22mm from the door, if it is too short then use extension pieces to obtain the correct length. (not included) Then remove the cylinder.

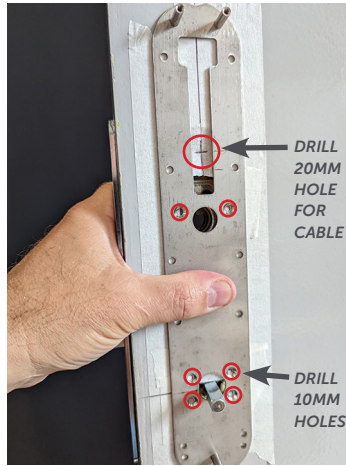

### STEP 5

Apply masking tape to both sides of the door. Insert the spindle back through the latch. Draw a line at the spindle centre and extend horizontally and vertically both sides of the door. Remove the backplate from the inside lock body and align on the door like this. Mark the position of the 6 x 10mm holes & 1 x 20mm hole. Repeat on the other side of the door.



### STEP 6

Remove the plate and then remove the mortice from the door. Drill the 7 holes from both sides of the door, then remove the masking tape. Refit the mortice, making sure the holes in the door align with the mortice. The door should look like this.



### STEP 7

On the outside, fit the keyed cylinder into the mortice. Take the thumbturn follower and using the existing screws, fix through the mortice into the cylinder and tighten. There are a few different types of oval keyed cylinder so this step may differ slightly.



### STEP 8

Check that the handles are facing the correct direction. If not insert a Phillips screwdriver, loosen the screw fully, turn the handle 180 degrees and then tighten the screw. **IMPORTANT: Even if the handles do not need reversed, insert a screwdriver and fully tighten the screws.**

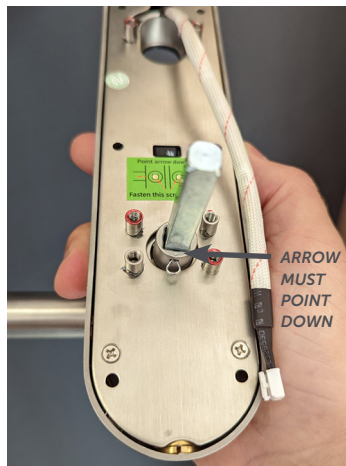

### STEP 9

Take the outside lock body and insert the correct length spindle for your door and secure with the split pin. Where the spindle inserts, there is an arrow, this MUST point to the floor.



### STEP 10

Fit the rubber gasket to the rear of the front lock body.



# DELUXE SCANDINAVIAN - INSTALLATION

**PROLOK™**



**STEP 11**

Offer up the external lock body, aligning the spindle through the mortice.

Carefully feed the cable through the 20mm hole in the door.



**STEP 12**

Make sure that the lock body sits flush on the door.



**STEP 13**

Fit the other rubber gasket to the backplate and place on the inside of the door. Fix securely with the 4 included screws.

There are 3 different lengths of screw to choose from.



**STEP 14**

OPTIONAL: We recommend fitting two additional screws to hold the backplate flat to the door like this.



**STEP 15**

Offer up the internal handle and connect the cable to the battery pack via the white plug.



**STEP 16**

Carefully push the excess cable back into the hole. Align both the spindle and the thumbturn as you fit the lock body over the backplate.

Make sure that the cable does not get trapped.



**STEP 17**

Using the 3 short screws, secure the lock body to the backplate. Make sure that the body fits within the rubber gasket.



**STEP 18**

Insert 4 x AAA batteries (not incl) and fit the cover plate. Turn the thumbturn to check that it activates the deadbolt. Also make sure that the main handle retracts the latch.



**STEP 19**

On the outside, pull the handle down, it should move freely but not engage with the latch. Insert the backup key on the underside of the lock and turn 90 degrees, now pull the handle, the latch should retract.



**STEP 20**

The original keyed cylinder is no longer used when using the smart lock.

From the inside the deadbolt can be used via the thumbturn.



**STEP 21**

To wake the lock, sweep your hand across the face of the keypad. The numbers will illuminate.

Now follow the separate instructions on how to add the lock to the TLock app.

The Deluxe lock is self locking.

When you pull the door closed, it will be locked on the spring latch.

A key is no longer required to lock the door.

From the inside, turn the thumbturn to deadlock the door.

Please keep the backup keys in a safe place, not in the property.