

GETTING STARTED

WITH LUXBLOX™

There are a few things to know about Lux Blox before getting started.



The Egg Goes in the Nest

When connecting Lux Blox, push the connectors together so that each egg-shaped part goes into each U-shaped “nest” and the Lux Blox will snap into place. Once they snap, the blox become a strong hinge with 240 degrees of rotation.

Dimples

The dimples are the rectangle-shaped cavities in the egg-shaped connector. One thing to keep in mind when building with Lux Blox is to be consistent with the direction the dimples are facing – either all inward or all outward – so that they will all connect to each other. If one portion of your model is all dimples “in” and another all dimples “out”, they will not connect properly together.

Squares

Squares are the primary part used in Lux Blox models. They connect with the “egg going into the nest” as illustrated above. Squares can form prisms, sheets which bend and fold to explore tensile construction, and many other shapes. Squares work as a hub in the large multi-wheel/gears.

Trigons

Trigons compliment the square Lux Blox. Rather than 4 sides with pinless hinged connectors, trigons have 3 sides. They have dimples like the squares which must face the same direction to connect properly to squares and other trigons. Trigons can make sheets which also fold and are used as the hub in the small multi-wheel gears.

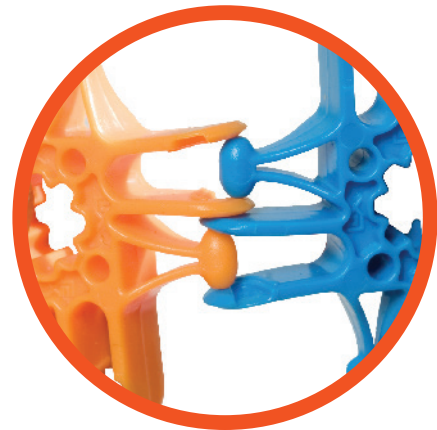

EGG AND NEST CLOSE-UP. DIMPLES IN ACTION

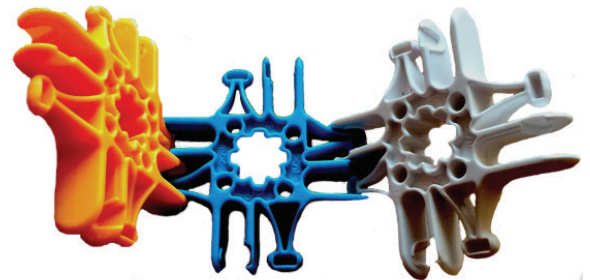

THREE INTERLOCKED LUX SQUARES

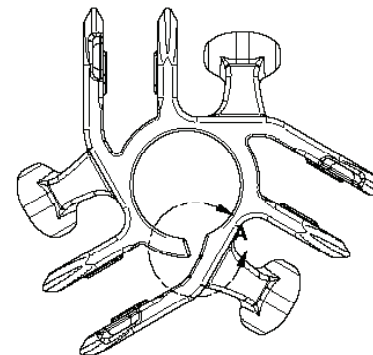

LUX TRIGON

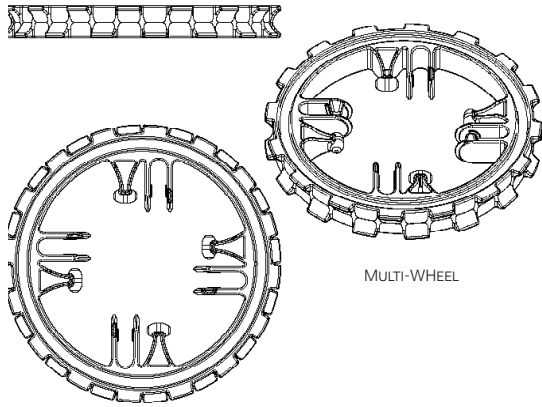

Multi-wheels

There are two sizes of multi-wheels which can be used as wheels but also as gears and pulleys. They use either the square or trigon as a hub.

Axles

There are three lengths of axles to use with Lux Blox. All axles have a raised ridge at different points on the axle so that when inserted into the hole in the middle of a square they can maintain stationary. However, when a block is positioned past this ridge and to the open space on the axles, they allow the blox to rotate, as on a car.

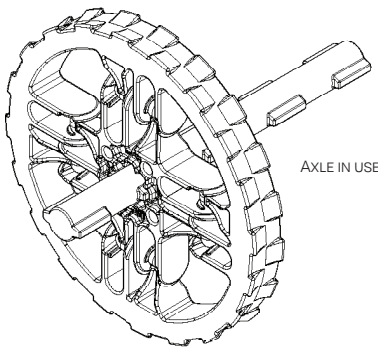

What is the Hole in the Middle for?

Lux Blox was made to inspire creativity and invention. The star-shaped hole was designed to fit craft sticks so that you can expand your Lux creations or use them as a tool to leverage one part while attaching it to another portion of a model. The hole will also fit a pencil or a 1/4 inch wooden dowel rod. The four small holes can be used with toothpicks or wires.

Unsticking Your Cube

A Lux Blox cube is not easy to take apart. Insert a pencil, dowel rod, or craft stick into the hole of a Lux Blox to gain leverage to pry open the cube.

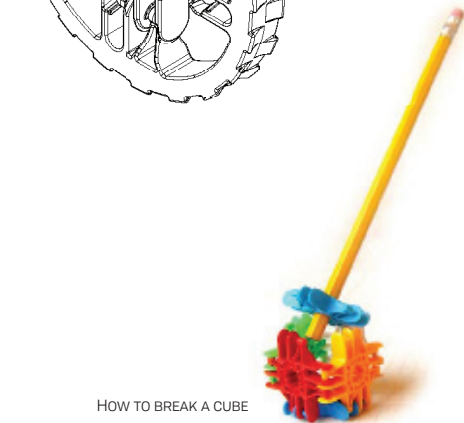

Why So Few Types of Parts with Lux Blox?

Lux Blox utilizes a “minimum inventory/maximum diversity” system, as coined by scientist Peter Pearce in his book, *Structure in Nature Is a Strategy for Design* (MIT Press, 1978). In good design, we always want to do more with less. The square and trigon are two of the most basic polygons and can be used to build a universe of complex shapes and structures that model the natural world. This is the miracle of natural design – from very few parts arises a world of possibilities.