

EASY ENVELOPE PUPPETS

from San Diego's **Balboa Park Puppet Guild**
www.balboaparkpuppets.com

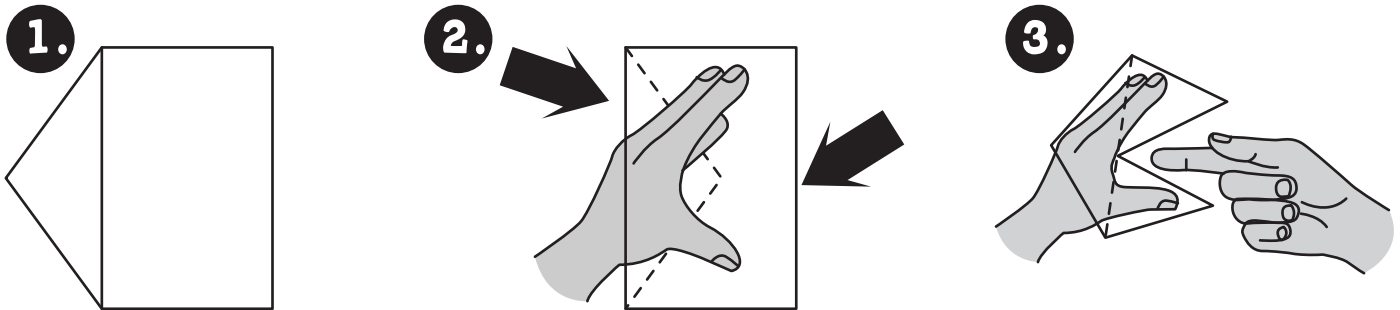

Materials

6 1/2" x 3 1/2" envelope, construction paper, scissors and glue.

Procedure

Tuck flap in envelope.

Place hand inside envelope as shown.

Gently "bite" finger of the other hand to form mouth.

Straighten out mouth if wrinkled.

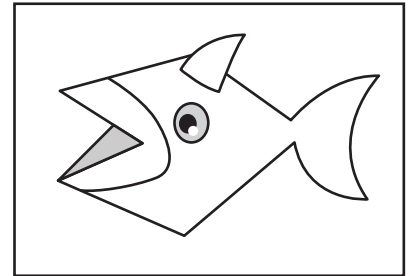

Note: Avoid envelopes with overly large "V" cut-outs in back. If this is the case, seal the envelope before folding flap and cut away one long edge of the envelope. Then follow the instructions above.

Now you have a head. Make it into a bird, fish or another animal or person. You can add ears, a nose, eyes, hair, feathers, scales or whatever with crayons, markers, yarn, etc. You can make a body, if you want, by cutting one out of paper or stuff a small paper bag and add limbs.

Be sure to ask permission before using scissors and glue.

