

1.- ADAPTATION INSTRUCTIONS

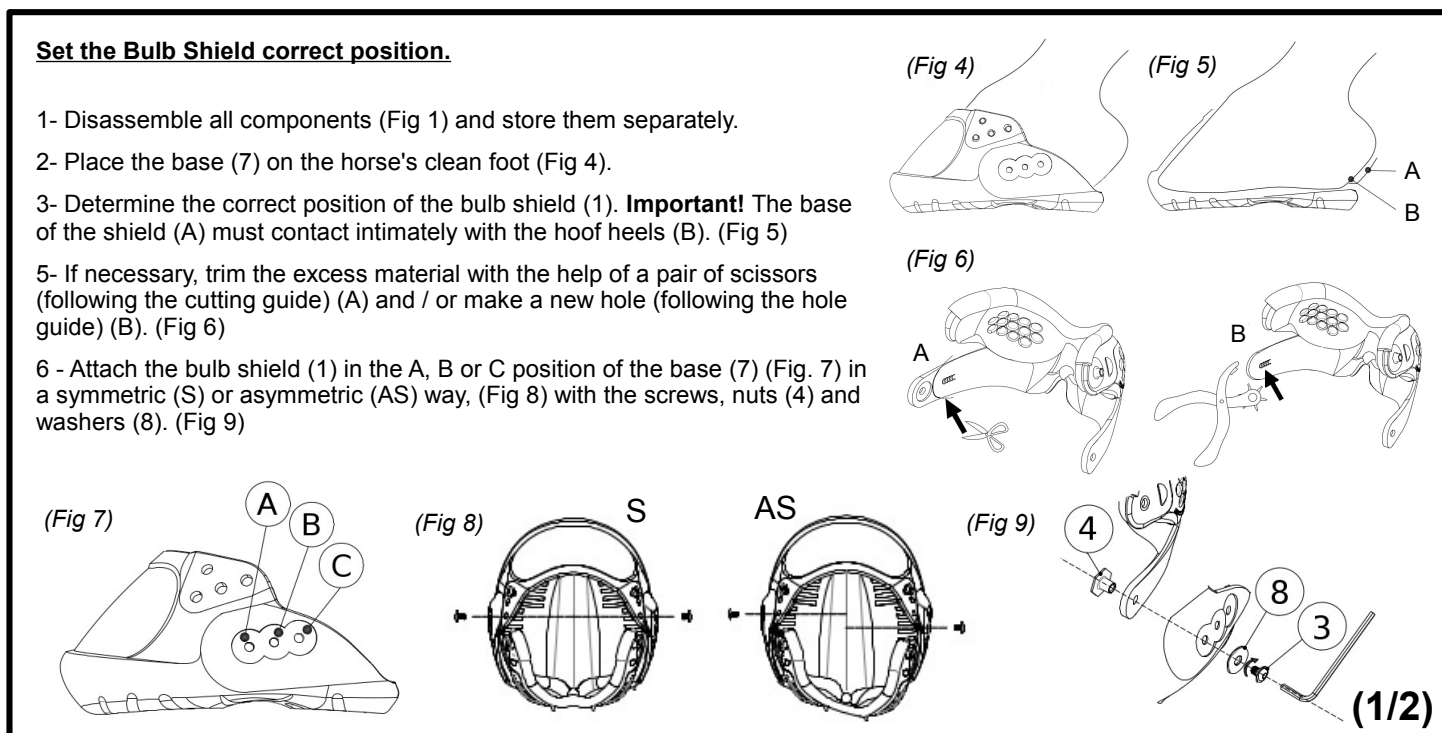
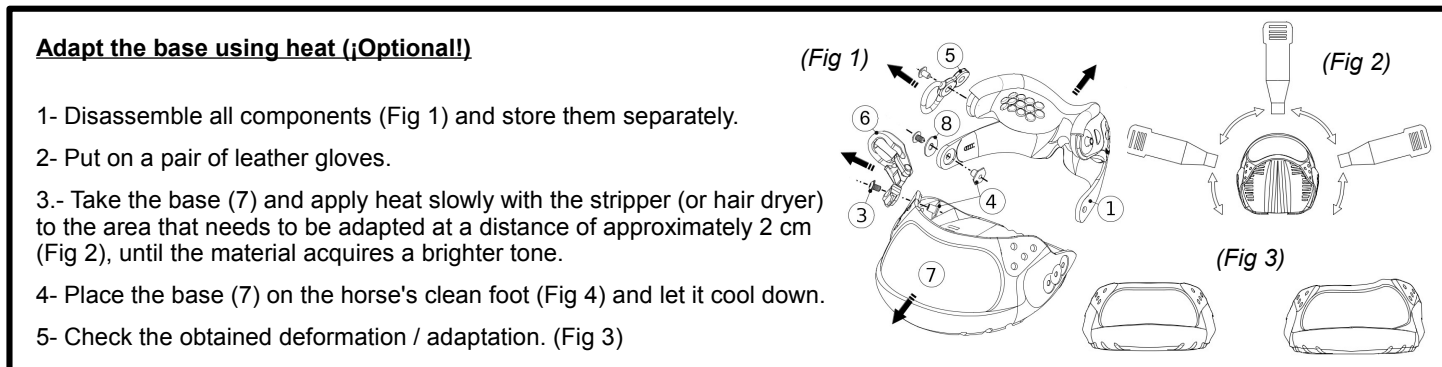

Set the DIRECT Elasto-stop lock position

- 1- Screw the direct elasto-stop (5a) in the 2nd or 3rd hole, to the Shield Nut (2) as shown in the drawing. (Fig 10)
- 2- Place the base (7) on the horse's clean foot. (Fig 4)
- 3- Set the Pivot (10, 9, 3) (Fig 12) to position D, E, F or G (Fig 11) to obtain the correct closing angle. **Important!** In the correct position, the bulb shield (2) must follow more or less the orientation of the coronary band. (Fig 13)
- 5- Close the system and check the elasto-stop tension (5). **Important!** You should be able to easily run a finger between the elasto-stop (5) and the horse's skin. The system works with very little tension!
- 6- If you do not get the proper tension, unscrew and re-screw the elasto-stop (5) in the correct position. (Fig 10)
- 7- Cut the excess material with the help of scissors. (Fig 14)

(Fig 10)

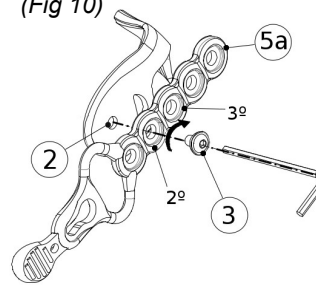

(Fig 11)

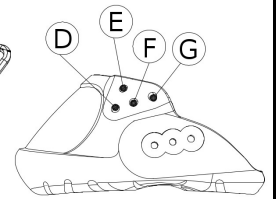

(Fig 12)

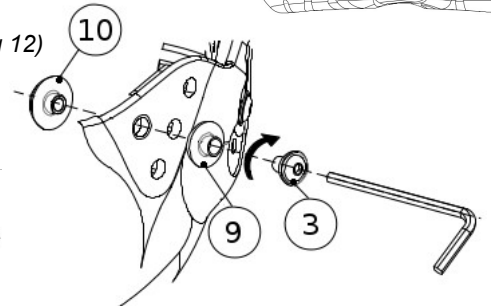

(Fig 13)

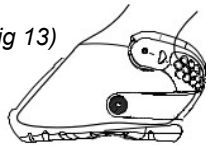

(Fig 14)

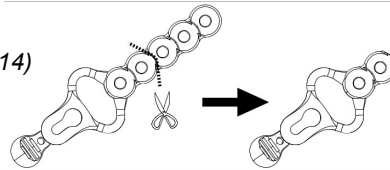

(Fig 15)

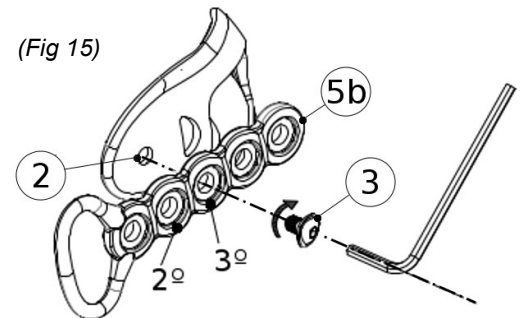

(Fig 16)

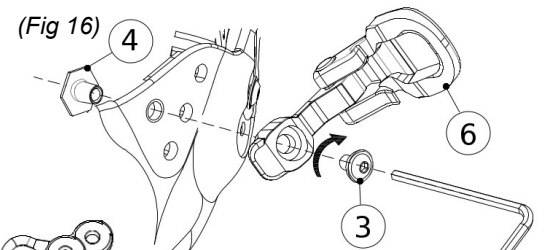

Set the INDIRECT Elasto-stop lock position (Smart-Lock)

- 1- Screw the indirect elasto-stop (5b) in the 2nd or 3rd hole, to the Shield Nut (2) as shown in the drawing. (Fig 14)
- 2- Place the base (7) on the horse's clean foot. (Fig 4)
- 3- Set the Smart-Lock (6) (Fig 16) to position D, E, F or G (Fig 11) to obtain the correct closing angle. **Important!** In the correct position the bulb shield (2) must follow more or less the orientation of the coronary band. (Fig 13)
- 4- Close the system and check the elasto-stop tension (5). **Important!** You should be able to easily run a finger between the elasto-stop (5) and the horse's skin. The system works with very little tension!
- 5- If you do not get the proper tension, unscrew and re-screw the elasto-stop (5) in the correct position. (Fig 10)
- 6- Cut the excess material with the help of scissors. (Fig 14)

(Fig 17)

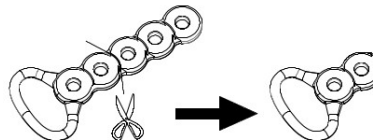

How to replace damaged parts

Any part of this boot that has been damaged by accident or by the simple use, can easily be replaced by purchasing the appropriate repair kit and following the procedures described above.

2.- FITTING INSTRUCTIONS

1

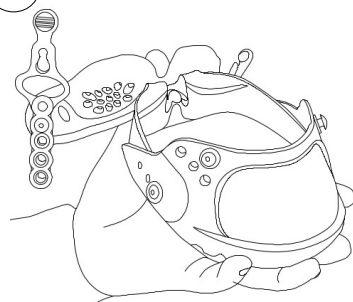

2



3

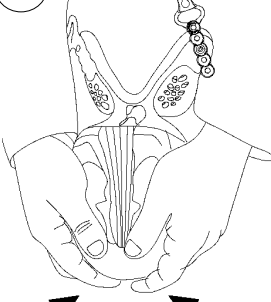

4

