

RODEO

Grill

Assembly instructions



Recommendations for the user



It is common for the first use of the grill to give off a smell of burnt paint. This is normal and part of the curing process, it will not occur in the future.



Remember not to touch any metallic surfaces while the grill is in use; it could cause severe burns.



The use of excessive embers on your grill can deteriorate it over time. This happens due to a by-product of the combustion process that deteriorates the metal sheet.



Be sure to store your grill in a dry place to prevent rusting.

Congratulations!

Your grill has just arrived

Safety warnings

- Do not use your grill indoors, it should only be used outdoors. Otherwise, it may cause serious poisoning by smoke inhalation, fire or deterioration.
- Do not leave infants, children, or pets unattended nearby a lit grill.
- Do not add lighter fluid or any type of inflammable fuel
- Proceed with care when using your grill, it will maintain high temperatures.
- Do not remove the ashes until the charcoal is completely blown out and the grill is cold
- The use of abrasive cleaners on the grill or on the accessories may damage the surfaces.
- The grill should be cleaned regularly to remove ash to prevent deterioration of the surfaces.

General Dimensions

Dimensions in mm / inches

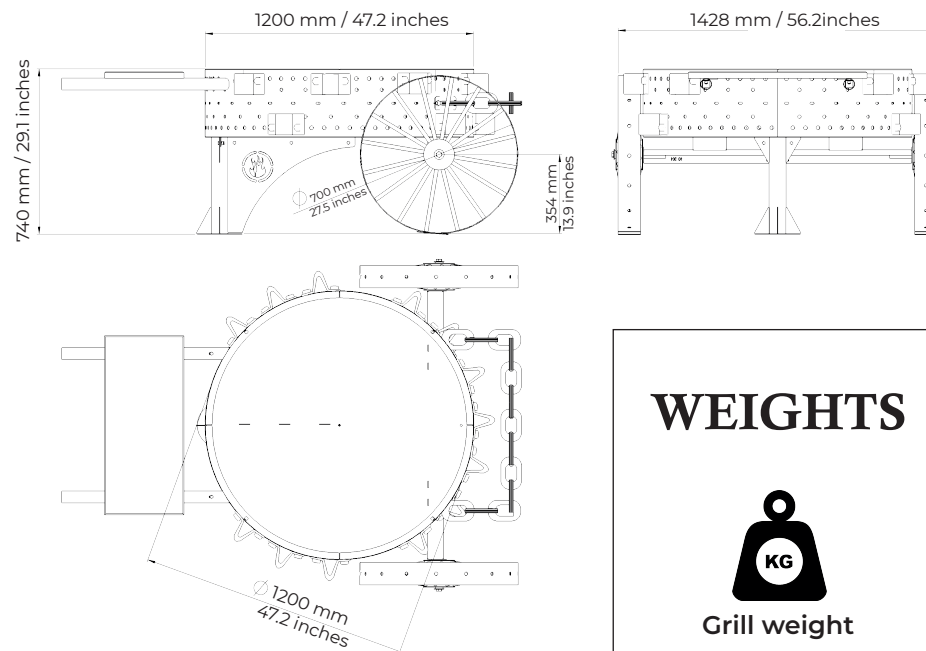

Packaging dimensions

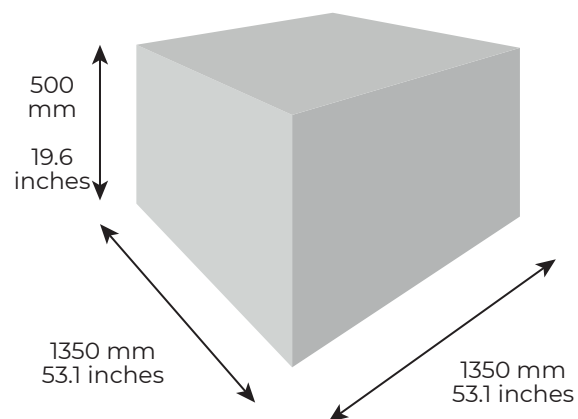

WEIGHTS



Grill weight

200 kg

440 pounds



Weight with packaging

240 kg

529 pounds



Component parts

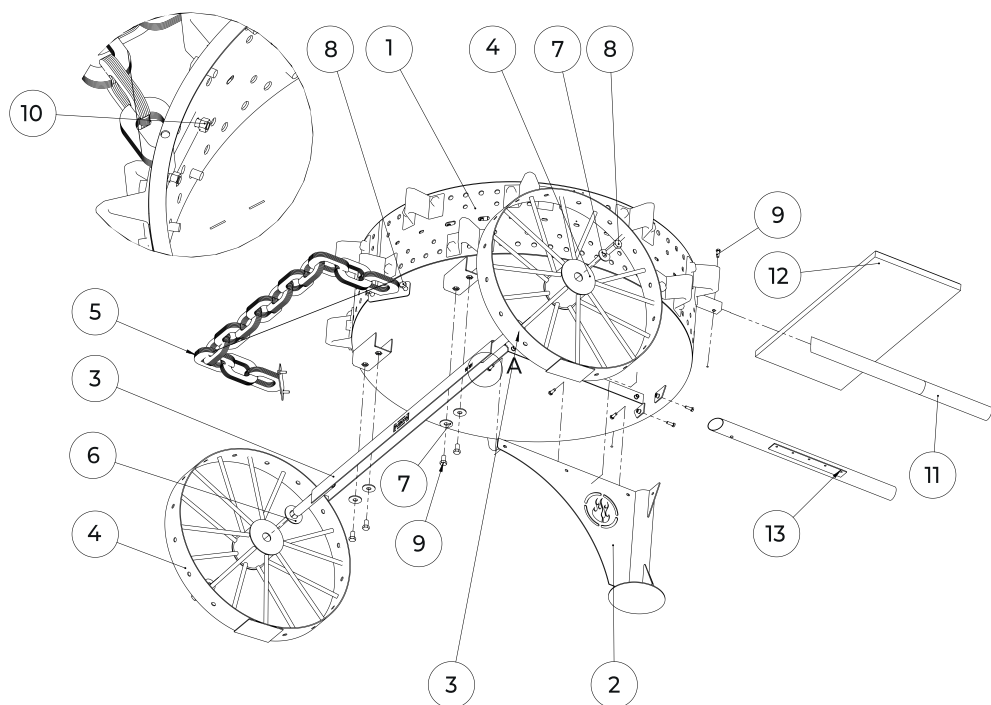

Part	Name	Qty
1	Main Body	1
2	Support bracket	1
3	Wheel axle	1
4	Wheel	2
5	Front trim	1
6	Flat washer wheel axle	2
7	Flat washer wheel stop	2
8	Bolt M14 x 25mm	2
9	Bolt M8 x 25mm	6
10	Hex nut M14	8
11	Handle	4
12	Wooden Surface	1
13	Wood screw	10

Accessories included

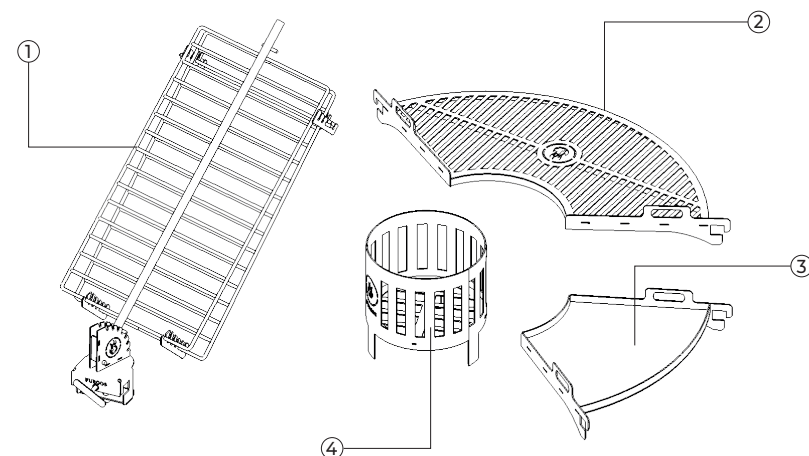

Part	Name	Qty
1	Clamp Rack Grill	1
2	Grill	1
3	Griddle	1
4	Brazier	1

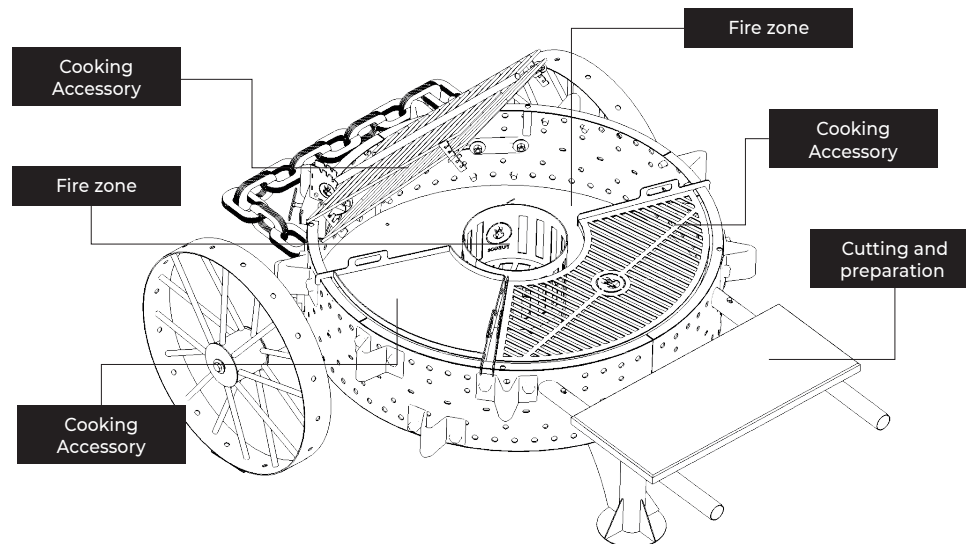

Assembly instructions

Step 1: Before starting the assembly of your grill, rotate the main body leaving the floor facing upwards, as shown in the picture.

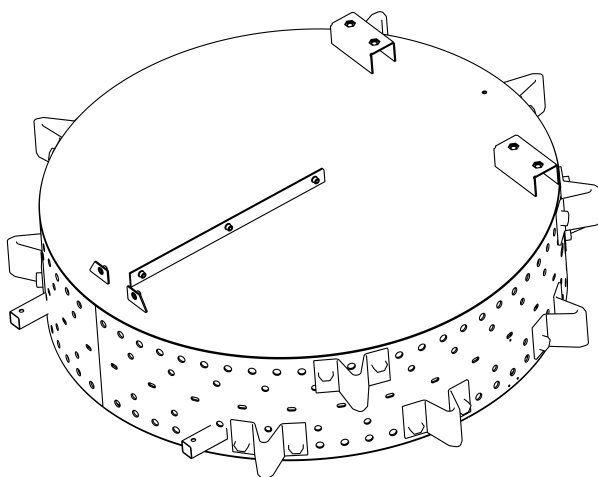

Step 2: Place the support bracket by fixing it with the M8 x 25 bolts (provided).

Necessary tools:
Wrench N° 13 or similar

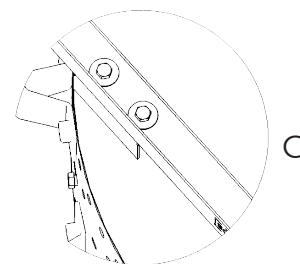
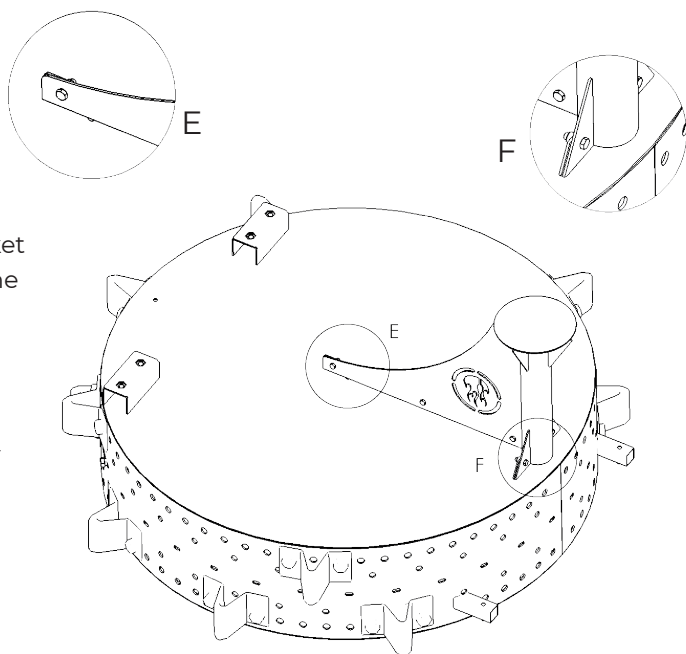

Step 3: Attach the wheel axle by fixing it with the M14 washers and M14 x 25 bolts (provided).

Necessary tools:
Wrench N° 22 or similar

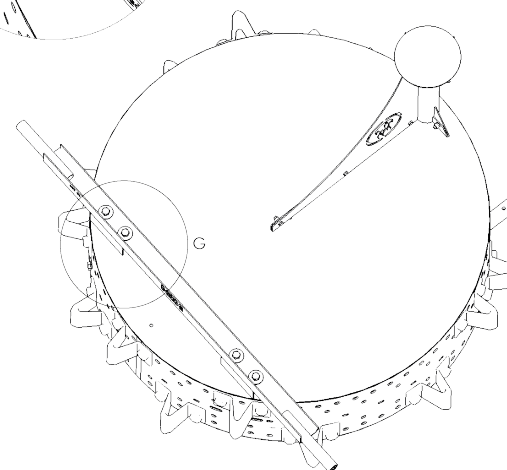

Step 4: Before attaching the wheel, put the washer on the axle, then attach the wheels.

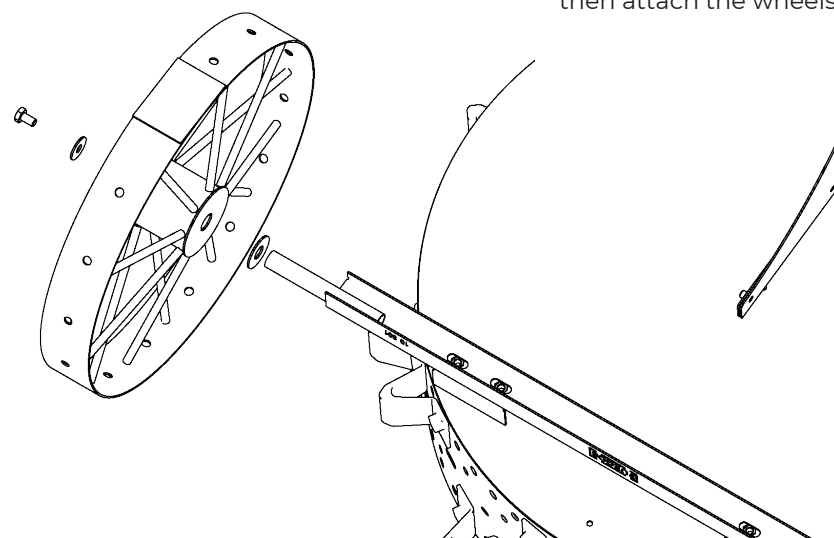

Step 5: Once the wheel is in position, place the M14 washer and fix the M14 x 25mm bolt (included).

Necessary tools:
Wrench N° 22 or similar

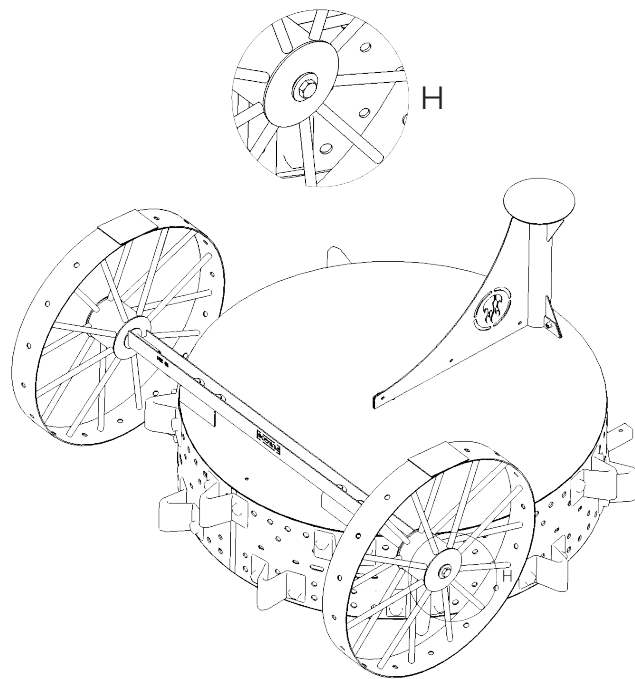

Step 6: Place the trim in position and fix the bolt M14 x 25mm with the M14 nut (included).

Necessary tools:
Wrench N° 22 or similar

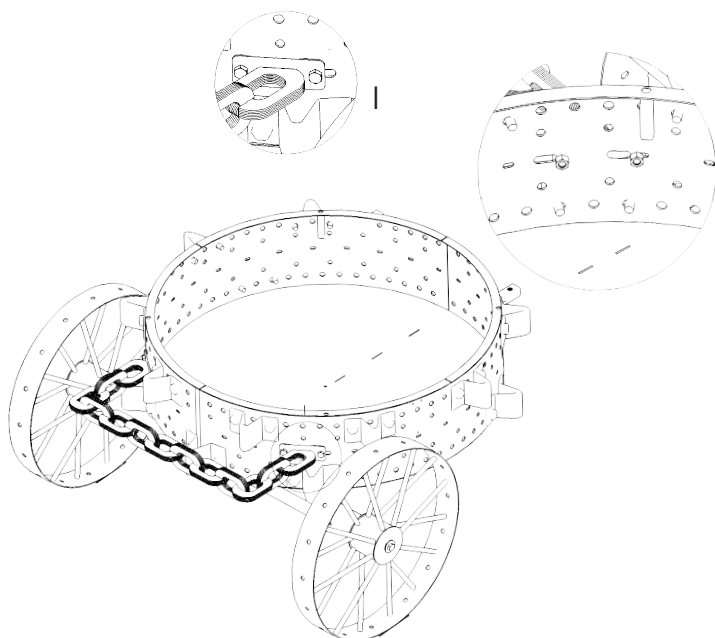

Step 7: Insert the handle into the main body pipes and fix with the bolt M8x25mm (included). Then, attach the wooden surface to the handles with the screws (included).

Necessary tools:
Wrench N° 13 or similar
Screwdriver

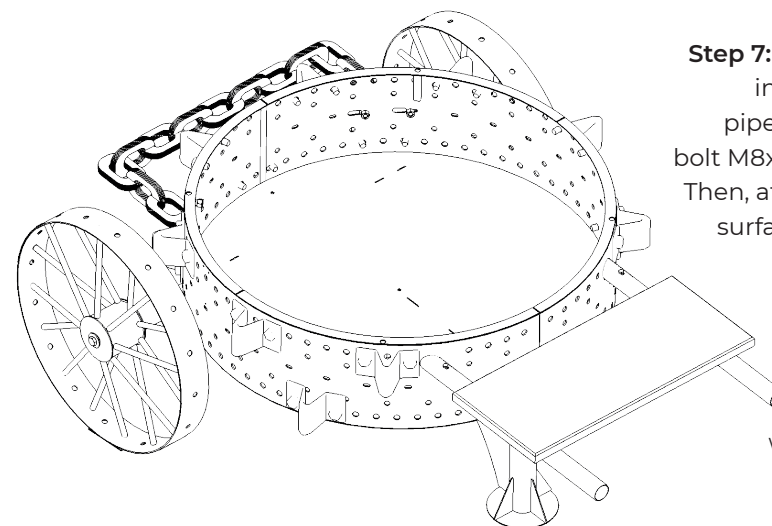

Assembly of Accesories Clamp Rack Grill

Step 8: To fix the clamp rack grill attachment turn the threaded handle until it stops with the metal sheet.

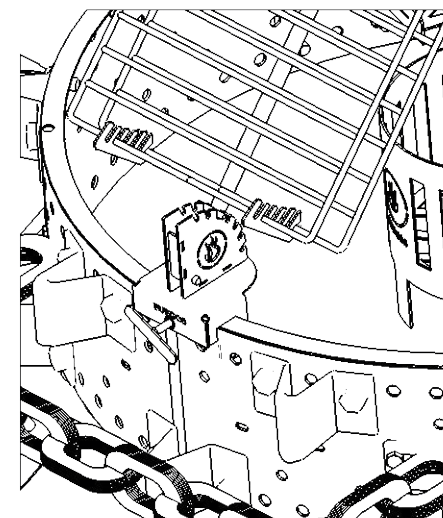
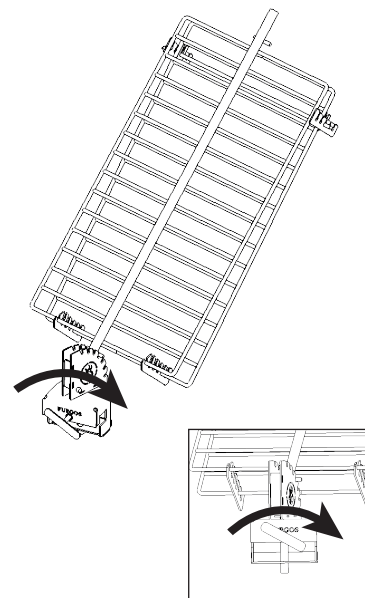

To cook with the clamp rack grill, remove the sword and lift the movable gratings. Then place the meat between the gratings, press and reposition the sword.

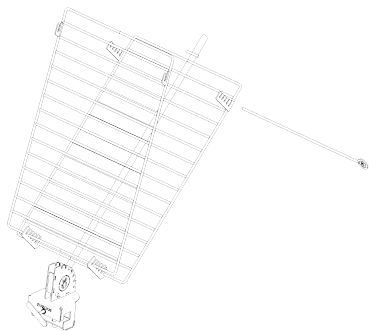

To adjust the position of the clamp rack grill, move the grating up slightly to unlock it, move it to the desired position and lock it again.

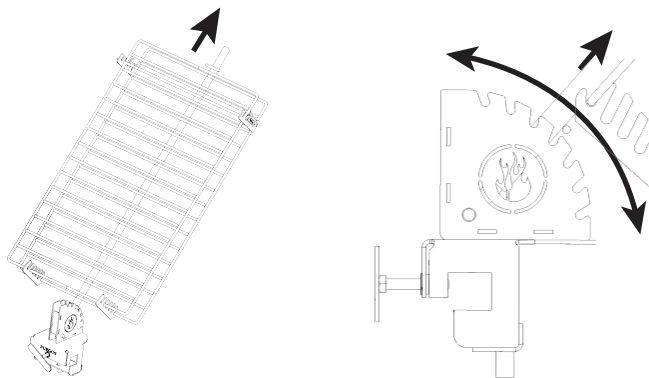

You can adjust the position of the clamp rack grill to achieve faster or slower cooking of the meat. In this way, you will be able to obtain different cooking points.

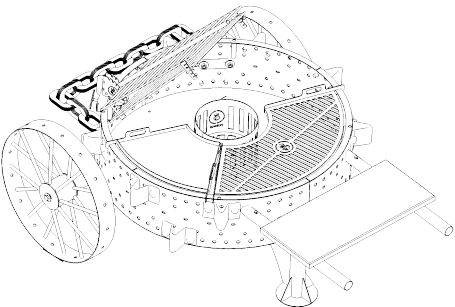
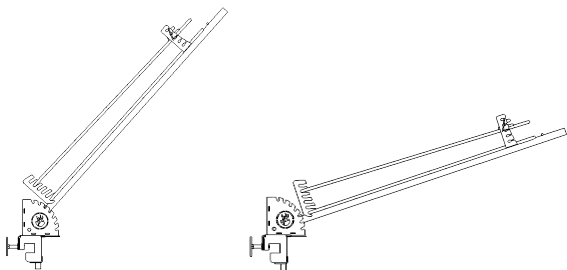

RODEO

Check list

Part	Name	Qty
1	Main Body	1
2	Support bracket	1
3	Wheel axle	1
4	Wheel	2
5	Front trim	1
6	Flat washer wheel axle	2
7	Flat washer wheel stop	2
8	Bolt M14 x 25mm	2
9	Bolt M8 x 25mm	6
10	Hex nut M14	8
11	Handle	4
12	Wooden Surface	1
13	Wood screw	10

Part	Name	Qty
1	Clamp Rack Grill	1
2	Grill	1
3	Griddle	1
4	Brazier	1

Part	Name	Qty
1	Assembly manual	1