

VENN 1.0 phase-cut dim

03-Apr.-2019

1.0

LED 38W | 220-240VAC | 50-60Hz | PCB3-step | phase-cut dim

CE IP20 60°C 10.3m P

White texture	149184W_
Black texture	149184B_
Bronze	149184Q_

LIGHT COLOUR

2700K >80CRI 2100lm	2
3000K >80CRI 2250lm	4

①

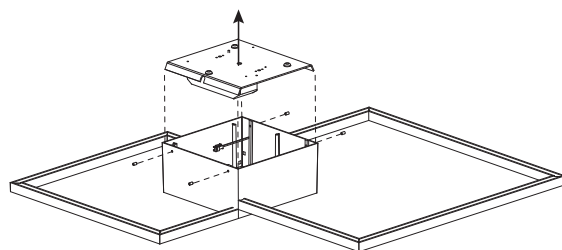

④

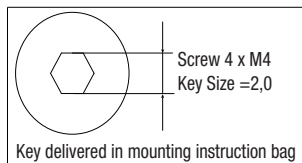
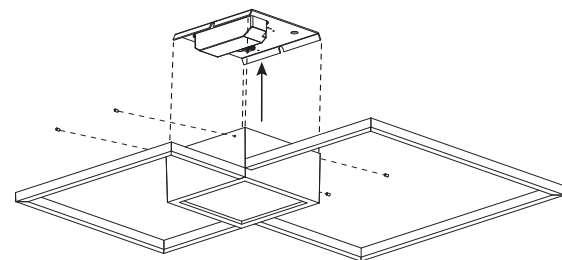

②

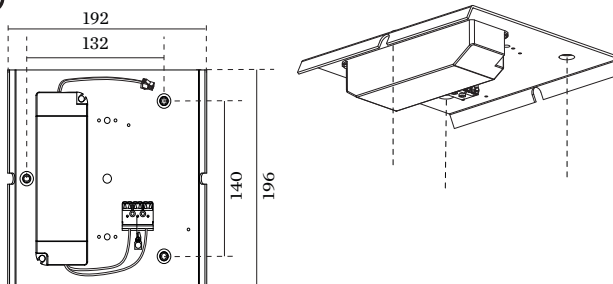

⑤

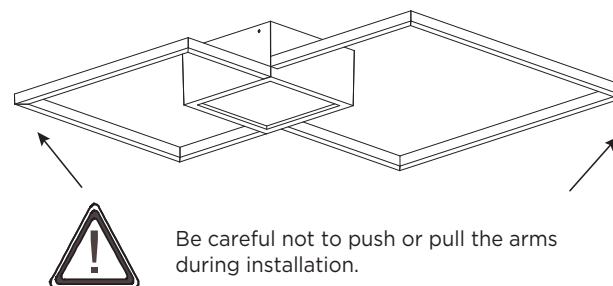

DIMENSIONS

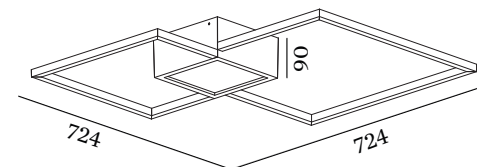

MOUNTING PLATE FIXATION

- ① Remove the mounting plate.
- ② Fixate the mounting plate to the wall/ceiling with screws.

POWER CONNECTION

- ③ Connect the terminal block.

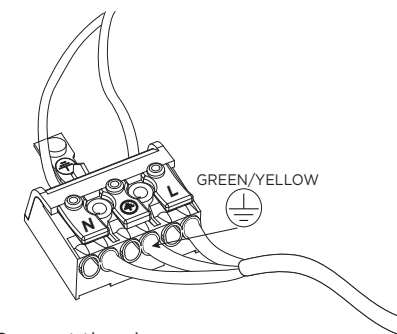

Connect the plugs.

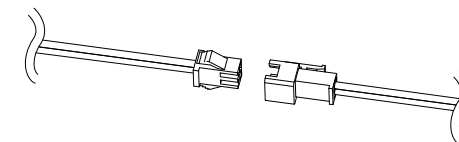

- ④ Fixate the lamp base back to the mounting plate.
- ⑤ Complete



WEVER & DUCRÉ
LIGHTING

www.weverducre.com

Wever & Ducre bvba Spinnerijstraat 99/21 8500 Kortrijk

INSTALLATION
INSTRUCTIONS

PAGE 1/2

VENN 1.0

DETAILED MOUNTING INSTRUCTION

03-Apr.-2019

DETAILED DIMENSIONS VENN:

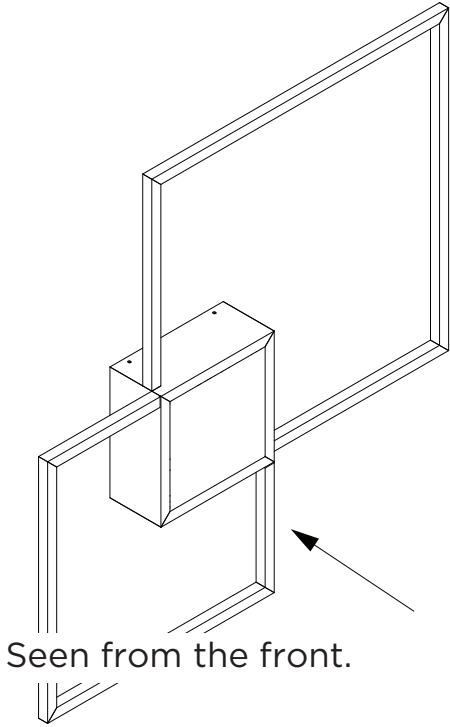
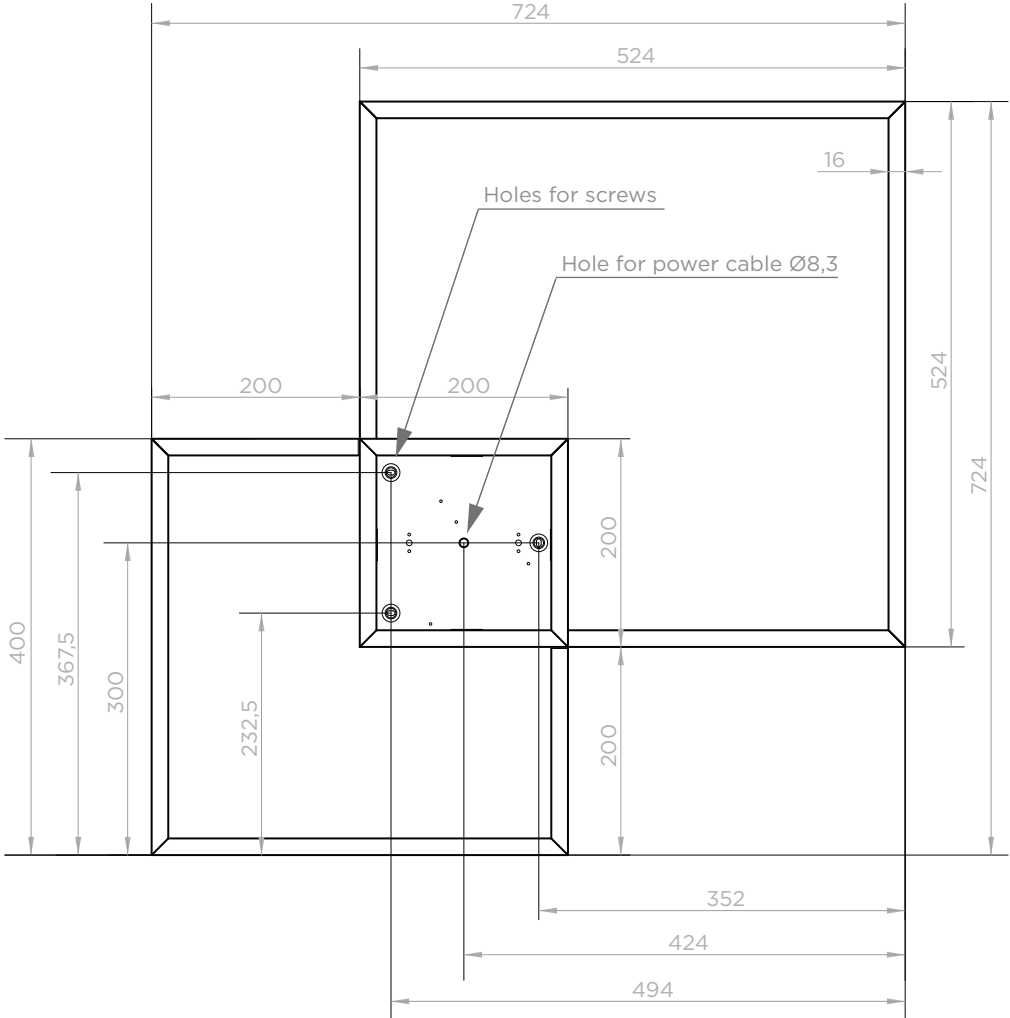

Seen from the front.

