

SARA ON BASE

13-Nov-2017

1.0 PAR16

PAR16 max. 35W | GU10 | 100-240VAC | 50-60Hz
CE IP20 0.9m

white texture	157220W0
black texture	157220B0
gold	157220G0

OPTIONAL
for PAR16 lamps see our catalogue

base plate dimensions

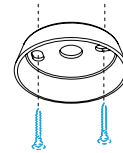
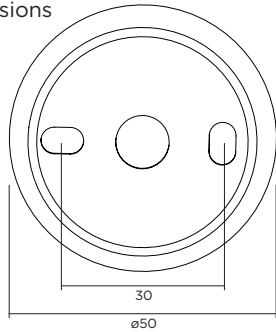

① ↑

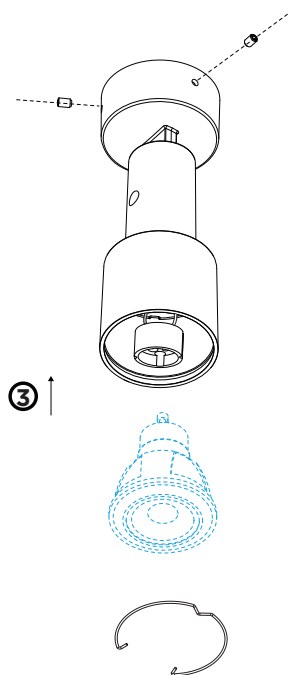

③ ↑

DIMENSIONS

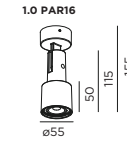

MOUNTING INSTRUCTION

- ① Remove the screws, put the cables through the opening and mount the base on the ceiling.

POWER CONNECTION

- ② Interior: connection: STANDARD version

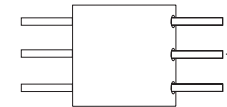

Mount the fixture again with the screws on the base.

- ③ For PAR16: mount the lamp.



WEVER & DUCRÉ
LIGHTING

www.weverducre.com

Wever & Ducré bvba Kwadestraat 153 bus 2.1 8800 Roeselare

INSTALLATION
INSTRUCTIONS