

DEEP ADJUST

04-Jun-2018

1.0 LED

LED 7/10W | 350-500mA | COB 3-step | excl. power supply
 CE P20 960°C 0,3m 38° 35°/35° 355°

white texture (wired springs)	112361W_
silver / grey (wired springs)	112361S_
gold (wired springs)	112361G_
black texture (wired springs)	112361B_
white texture (blade springs)	112361W_C
black texture (blade springs)	112361B_C

LIGHT COLOUR

2700K >90CRI 420-590lm 18Vf	3
3000K >90CRI 470-640lm 18Vf	5
4000K >90CRI 490-660lm 18Vf	6
1800-2850K >95CRI 320-440lm 18Vf	9

ALWAYS USE

for power supplies see our catalogue

1.0 MR16

QR-CBC51 max.35W | GU5.3 | 12V | excl. transformer
 CE P20 960°C 0,9m 35°/35° 355° DO NOT COVER WITH INSULATION

white texture (wired springs)	112310W0
silver / grey (wired springs)	112310S0
gold (wired springs)	112310G0
black texture (wired springs)	112310B0
white texture (blade springs)	112310W0C
black texture (blade springs)	112310B0C

ALWAYS USE

for transformers see our catalogue

1.0 PAR16

PAR16 max. 35W | GU10 | 100-240VAC | 50-60Hz
 CE P20 960°C 0,9m 35°/35° 355° DO NOT COVER WITH INSULATION

white texture (wired springs)	112320W0
silver / grey (wired springs)	112320S0
gold (wired springs)	112320G0
black texture (wired springs)	112320B0
white texture (blade springs)	112320W0C
black texture (blade springs)	112320B0C

OPTIONAL

for PAR16 lamps see our catalogue

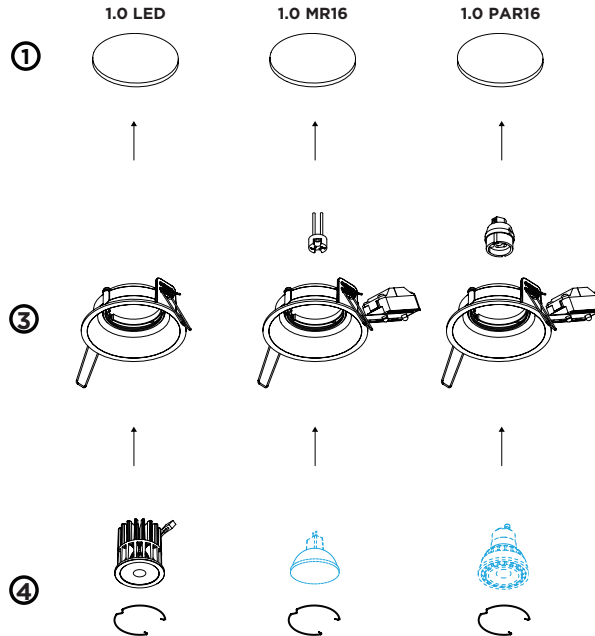

DIMENSIONS

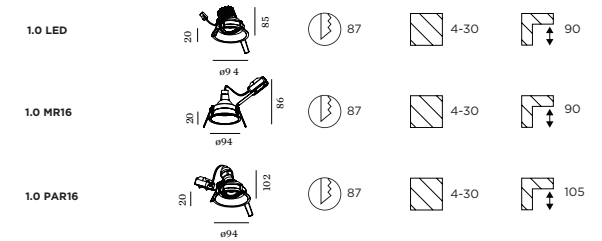

MOUNTING INSTRUCTION

- 1 Make a hole in the ceiling according to the prescribed dimensions.

POWER CONNECTION

- 2 Connect the power supply.

Interior: STANDARD version
 serial connection for LED

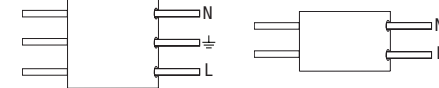

- 3 Insert the fixture in the hole
- 4 For MR16 | PAR16
 Place the lamp and fix with inner part of DEEP

SAFETY DISTANCE FOR HALOGEN LAMPS

