

KLEVA®

MEALiO™

The Hot and Cold Nutritional Blender

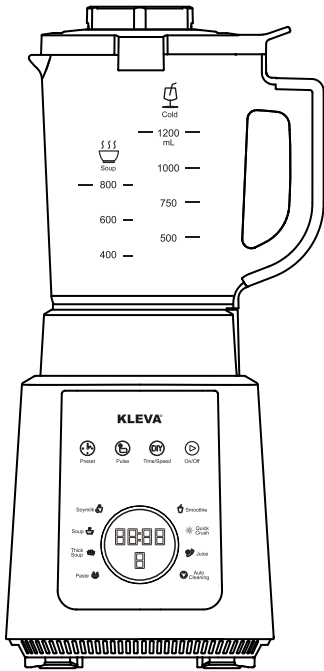

FOR A VARIETY OF

• **RECIPES** •

SUITED FOR

MEALiO™

The Hot and Cold Nutritional Blender

Please visit our website at

 www.klevarange.com.au

SCAN ME

For helpful tips and recipes



USER MANUAL

Please read the **Instructions Guide** carefully before use
& Keep **User Manual** for future guidance

WARNINGS



READ THIS IMPORTANT INFORMATION CAREFULLY BEFORE YOU USE THE APPLIANCE AND SAVE IT FOR FUTURE REFERENCE

- Do not misuse the appliance to avoid potential injury.
- This appliance is intended to be used in household only.
- Do not touch the sharp blades when the appliance is plugged in.
If the blades get stuck, unplug the appliance before you remove the ingredients.
Be careful when handling the sharp cutting blades, emptying the bowl and during cleaning.
- Switch off and unplug the appliance from the power supply before :
 - *Removing it from the stand, changing accessories or approaching parts that move in use.
 - *Assembling, disassembling or cleaning it.
 - *It is left unattended.
- Do not immerse the appliance in water or any other liquid.
- Check if the voltage indicated on the appliance corresponds to the local mains voltage before you connect the appliance.
- Do not use the appliance if the plug, the power cord, lid, or blender jar are damaged or has visible cracks. If the power cord is damaged, you must have it replaced by Kleva Range®, a service centre authorised by Kleva Range® or similarly qualified persons in order to avoid a hazard.
- Make sure the lid is properly assembled to the Blender Jar before you use the appliance.
- This appliance shall not be used by children. Keep the appliance and its cord out of reach of children.
- Appliances can be used by persons with reduced physical, sensory or mental capabilities or lack of experience and knowledge if they have been given supervision or instruction concerning use of the appliance in a safe way and if they understand the hazards involved.
- Children should be supervised to ensure that they do not play with the appliance.
- In order to avoid a hazard due to inadvertent resetting of the thermal cut-out, this appliance must not be supplied through an external switching device, such as a timer, or connected to a circuit that is regularly switched on and off by the utility.
- Be careful if hot liquid is poured into the Blender Jar as it can be ejected out of the appliance due to a sudden steaming.
- Never assemble or disassemble the Blender Jar to the motor base while the power is on.
- Read the 'User Manual' before use.
- Be careful that the heating element surface is subject to residual heat after use.

WARNINGS

- Never use any accessories or parts from other manufacturers or that Kleva Range® does not specifically recommend. If you use such accessories or parts, your guarantee becomes invalid.
- Only connect the appliance to an earthed wall socket.
- Do not exceed the maximum indication on the Blender Jar.
- Do not exceed the maximum quantities and processing times indicated in the relevant table.
- If food sticks to the wall of the Blender Jar, switch off the appliance and unplug it. Then use a spatula to remove the food from the wall.
- Never fill the Blender Jar with ingredients hotter than ambient temperature. Avoid to pour cold water into the blade unit and Blender Jar immediately after use. Wait until it has been fully cooled.
- The appliance can only be switched on if the Blender Jar is assembled on the motor base correctly.
- Do not touch the heating element and blade after use.
Let it cool down for approx 30 minutes before cleaning or disassembly.
- Do not use the Blender for more than 6 minutes at a time. Stop using for 1 minute after blending, only blend 3 times in 6 minute intervals then unplug the appliance and let cool for 15 minutes before using again.
- Do not cook with the appliance for more than 50 minutes. If the Blender powers off during cooking, unplug it and change the ingredients before starting again.

FOR A VARIETY OF

• **RECIPES** •

SUITED FOR

MEALiO

The Hot and Cold Nutritional Blender

Please visit our website at

 www.klevarange.com.au

SCAN ME

For helpful tips and recipes



HOW TO ASSEMBLE

1. Removable Centre Cap
2. Blender Lid
3. Blender Jar
4. Driving Shaft Head
5. Motor Base
6. Control Panel
7. Selector Wheel
8. Stir stick
9. Handy cleaning Brush

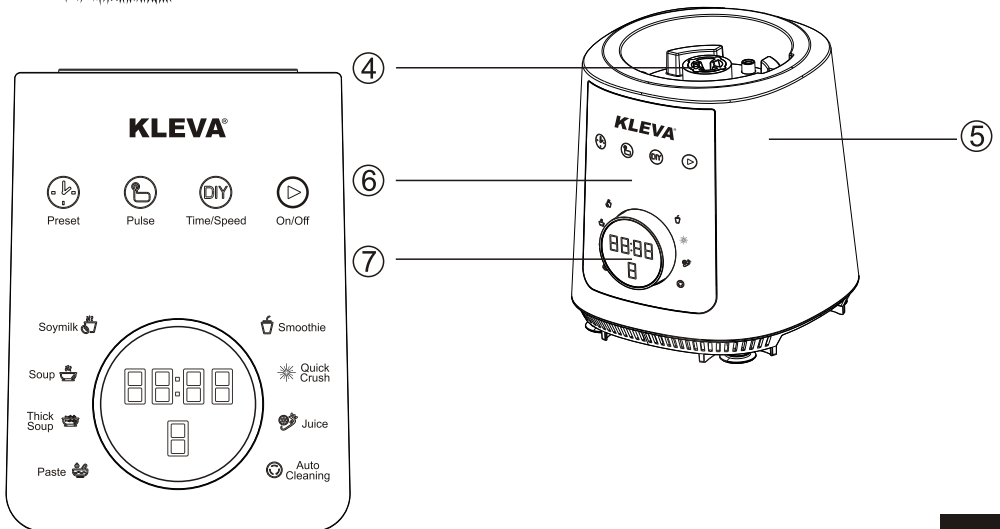
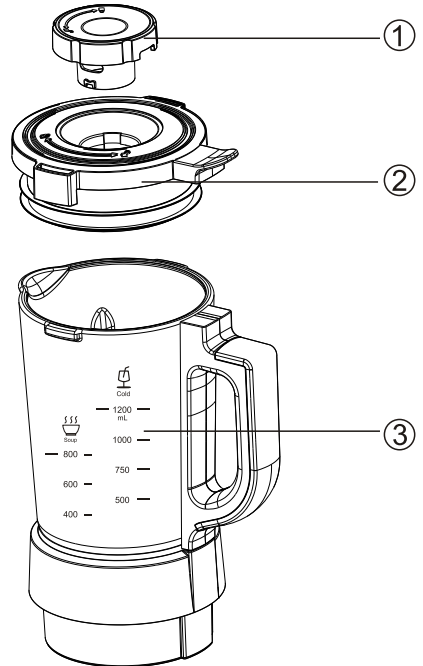
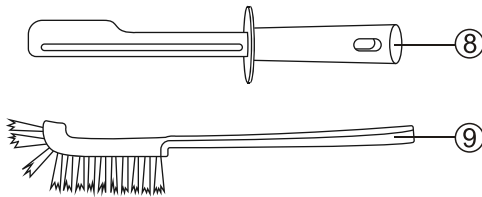

HOW TO USE

IMPORTANT: REVIEW ALL WARNINGS ON PAGES 1-2 BEFORE PROCEEDING

Assembling the Appliance

1. Plug in Motor Base and place on a clean, dry level surface such as a countertop or table.
2. Lower the Blender Jar onto the motor base.

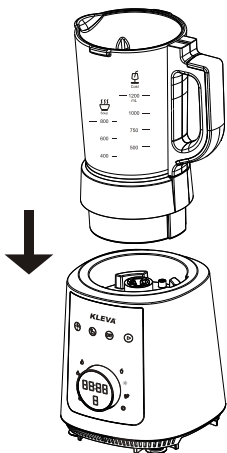

3. Add ingredients, making sure to not exceed the max fill lines on side of Blender Jar. In COOK mode, DO NOT exceed the level labelled "SOUP" in BLEND mode, DO NOT exceed the level labeled "COLD".

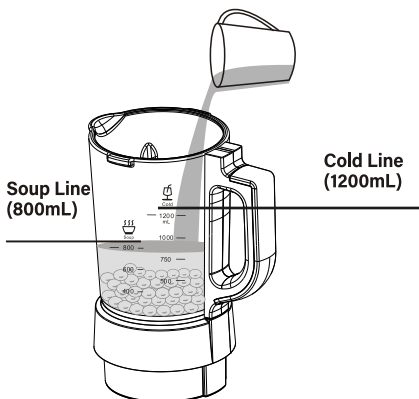

4. To install the lid on the Blender Jar, place the Blender Lid tab to the right of the handle. Press the Lid down until it is secure. Rotate Lid clockwise so the Lid tab and the handle tab are aligned.

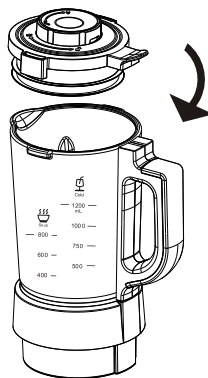

5. Secure the Centre Cap by placing it down in to the Lid and twisting clockwise until it clicks in to place.

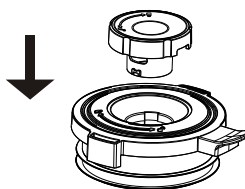

6. To remove the Lid from the Blender Jar, rotate Lid counter clockwise out of the lock potions and lift up.

NOTE: After heated programs, steam may release as the Lid is removed. Keep hands on the outer tabs and lift directly up.

PROGRAMS

TOP CONTROL PANEL INSTRUCTIONS



Pre-set

The Pre-Set time function is only available for the 4 hot blending and cooking programs which include Soy Milk, Soup, Thick Soup and Paste Function. (View our Kleva Range® website to see more Hot Recipes)

INGREDIENTS WARNING: Please ensure that all wet ingredients such as the liquids (cream and water) is to go in first, then is to be followed by any other dry ingredients at the top such as (beans, potato's and legumes). Any spices, stock cubes and powdery substances is to be added into the Mealio™ last to avoid any of these products sticking to the base of the Mealio™ Jar. Please make sure that the produce and liquid is cold/raw to prevent the Mealio™ from overheating (RAW MEAT IS NOT TO BE ADDED INTO THE MEALIO™). If you are adding pre-cooked ingredients please make sure it has completely cooled down before going in.

Step 1 - Following your chosen recipe add the ingredients into the Jug and lock and secure the lid into place. The ON/OFF button will now start to flash and the selector wheel will appear to have no numbers and show as (-- --). (E01 will appear if the lid is not properly secured or aligned with handle. The lid not being locked in will cause the Mealio™ to not function which is a safety feature).

Step 2 - Select/touch the ON/OFF button and you will see that the flashing has disappeared and the 8 Pre Set Programs and the touch control panel will light up. The Selector Wheel Screen will now appear to have the numbers 00:00 in the first row and 0 on the second row.

Step 3 - Select the function you would like to use by turning the selector wheel clock wise or anti-clock wise. Once the function is selected you will now see that the chosen function Icon has begun to flash along with the Pre Set Button.

Step 4 - Now select/touch the Pre-Set Button and the flashing will now stop and you are now ready to choose how long you would like it to start cooking from your present time. To adjust the time you are to turn the selector wheel in a clock wise direction to increase the time by 10min and anti-clock to reduce the time by 10 min. The pre-set time ranges from 10min to 12 hours and you can only increase or decrease the time by 10 min.

Step 5 - Once you have selected your pre-set time you are to now to select/touch the ON/OFF start button and this will start a countdown display process. When the countdown is completed and it has now reached your chosen Pre-Set time it will start to heat up and cook the ingredients/meal.

Note: Press the ON/OFF button to directly stop the appliance during countdown or operation.

Note: If E01, E03, E04 or E05 appears to be displayed you on your selector wheel screen during your cooking process at any time please DO NOT panic and go to **PAGE 16** for more information on what these safety errors mean.

PROGRAMS



Pulse Setting

The Pulse Function can only be used for Cold Blending and NOT for Hot/Heated blending. The Pulse function will automatically be set on the Fastest/ Highest blending setting which is 9 and can run for a maximum of 1 minute blending at a time. The Pulse function is great feature which allows you to control what you are mixing/cooking with, giving you that perfect consistency and texture that you are looking for and can also be used to breakdown ingredients before selecting another pre-set program.

INGREDIENTS WARNING: Please ensure that all wet ingredients such as the liquids (cream and water) is to go in first, then is to be followed by any other dry ingredients at the top such as (beans, potato's and legumes). Any spices, stock cubes and powdery substances is to be added into the Mealio™ last to avoid any of these products sticking to the base of the Mealio™ Jar. Please make sure that the produce and liquid is cold/raw to prevent the Mealio™ from overheating (RAW MEAT IS NOT TO BE ADDED INTO THE MEALIO™). If you are adding pre-cooked ingredients please make sure it has completely cooled down before going in.

Step 1 - Once your contents are in the Jug you are to lock and secure the lid into place. The ON/OFF button will now start to flash and the selector wheel will appear to have no numbers and show as (-- --). (E01 will appear if the lid is not properly secured or aligned with handle. The lid not being locked in will cause the Mealio™ to not function which is a safety feature).

Step 2 - Select/Touch the ON/OFF button and you will see that the flashing has disappeared and the 8 Pre Set Programs and the touch control panel will light up. The Selector Wheel Screen will now appear to have the numbers 00:00 in the first row and 0 on the second row.

Step 3 - For the Mealio™ to start Pulsing you are to touch and hold your finger on the Pulse button and you will start to see that the ingredients in the jar blend. Removing your finger away from the Pulse button will stop the Mealio™ from pulsing. Please keep in mind that the touch control panel is touched base.

Step 4 - Once you select the Pulse Function it will automatically start pulsing and the selector wheel screen will have the number numbers counting down from 60 seconds in the first row and the second row will the number 9 which is the level of speed.

Note: If E01, E03, E04 or E05 appears to be displayed you on your selector wheel screen during your cooking process at any time please DO NOT panic and go to **PAGE 16** for more information on what these safety errors mean.

PROGRAMS



DIY Time/Speed Program

The DIY function manually allows you to set a chosen blending time and speed for Cold Blending only and can NOT be used for hot and heated blending. The Blending time you can choose from ranges from 5 seconds to 3 minutes and you can choose a speed setting from 1 being the lowest to 9 being the fastest. The lowest speed function 1 is great for blending things such as soft ingredients and the fastest speed function 9 would be recommend for blending things such hard raw vegetables and frozen food product.

INGREDIENTS WARNING: Please ensure that all wet ingredients such as the liquids (cream and water) is to go in first, then is to be followed by any other dry ingredients at the top such as (beans, potato's and legumes). Any spices, stock cubes and powdery substances is to be added into the Mealio™ last to avoid any of these products sticking to the base of the Mealio™ Jar. Please make sure that the produce and liquid is cold/raw to prevent the Mealio™ from overheating (RAW MEAT IS NOT TO BE ADDED INTO THE MEALIO™). If you are adding pre-cooked ingredients please make sure it has completely cooled down before going in.

Step 1 - Once your contents are in the Jug you are to lock and secure the lid into place. The ON/OFF button will now start to flash and the selector wheel will appear to have no numbers and show as (-- --). (E01 will appear if the lid is not properly secured or aligned with handle. The lid not being locked in will cause the Mealio™ to not function which is a safety feature).

Step 2 - Select/Touch the ON/OFF button and you will see that the flashing has disappeared and the 8 Pre Set Programs and the touch control panel will light up. The Selector Wheel Screen will now appear to have the numbers 00:00 in the first row and 0 on the second row.

Step 3 - Select/Touch the DIY button once. You will now see the Selector Wheel Screen appear to have numbers in two rows (00:30 in the first row and 1 on the second row). The First Row of numbers shown is the time and this will be flashing the number 00:30 and the DIY setting Icon will also be flashing. You are now to choose the time, turn the Selector Wheel in a clockwise direction to increase the time to anything to up to 3 minutes and anti-clockwise to decrease the time to the lowest being 5 seconds. Once chosen time is selected stop turning the wheel and select/touch the DIY Function Icon once and the second row will start to flash.

Step 4 - The second row of numbers on the Selector Wheel Screen will appear to flash along with the DIY Icon. The second row with the flashing singular number allows you to control the speed. Turn the wheel clockwise to increase to the speed and anti-clockwise to decrease the speed. You can choose from any speed levels between 1 to 9, 1 is the lowest blending speed and 9 is the highest blending speed.

Step 5 - The speed has now been selected so you are to now select/touch the ON/OFF start button and once you select the on button the Mealio™ will start blending with your chosen speed and blending time. The Selector Wheel Screen will also show a countdown of your selected blending time.

Note: If E01, E03, E04 or E05 appears to be displayed you on your selector wheel screen during your cooking process at any time please DO NOT panic and go to **PAGE 16** for more information on what these safety errors mean.

PROGRAMS



On/Off

ON/OFF Button Turn on Appliance. Start and Stop Programs. Awaken from Sleep Mode

When the appliance has been connected to power the 'ON/OFF' Button will light up, press the button to turn on. When the lid is on the Blender, it will enter Standby Mode and the entire control panel will light up. Use the 'ON/OFF' button to start a selected program or immediately stop the Blender during operation. If the appliance is connected to power with no setting selected within 5 minutes, it will enter Sleeping Mode. Use the 'ON/OFF' button to awaken the Blender and use.

HOW TO ATTACH LID

E01 is a safety feature that is designed to notify you that the lid is not securely attached. The Mealio™ will not function if the Lid is not secure. The Mealio™ has a magnetic sensor design which requires the blender sensor on the lid to be locked into place and be in alignment with the Mealio™ jar handle sensor.

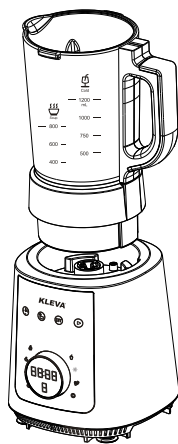

Step 1 - Once the Mealio™ motor base is plugged in, you are to place the Mealio™ Jug on top. Once the jug is in the motor base an Error sign will appear on the selector wheel screen which is E01.

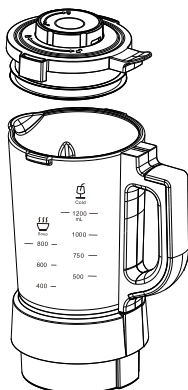

Step 2 - Push the Mealio™ lid into the Mealio™ Jar

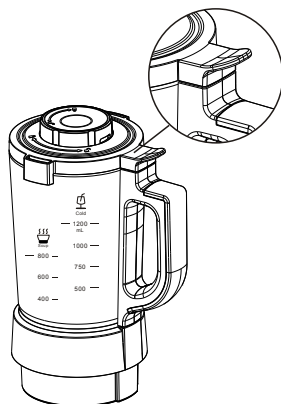

Step 3 - Turn the lid clockwise until it cannot turn anymore. Making sure to line up the lip of the lid with the jar

HOT BLENDING

ATTENTION

- Do Not fill the Blender past the Soup Maximum Capacity line (800ml).
- Do not use the Blender to boil milk, pre made soy milk or rice paste to avoid charring the heating plate.
- Do not add sugar to the Blender during the heating programs to avoid charring and damage to the heating plate.
- Do not add ingredients over 80°C in the Blender.
- For Hot Blending Programs, it is recommended to add ingredients at room temperature in the blender for best results.
- If you hear a "Tak" sound when running a heating program, do not be alarmed this is the normal working sound of the relay.
- When initially using the hot blending and cooking programs the blade may blend a bit, do not be alarmed as this is normal.
- If at any point you need to stop the appliance, press the 'ON/OFF' button. The Blender will then immediately stop running and enter Standby Mode.



Soy Milk - Hot Blending, 20 Minute Pre-set

The Soy Milk programmed is designed for making Soy Milk and other types of Soy beverages. The Soy Milk program is pre-set to be made in 20 minutes. Please see our website www.klevarange.com.au and go to our Mealio™ page to see one our Soy Milk Recipes.

Step 1 - Once your contents are in the Jug you are to lock and secure the lid into place. The ON/OFF button will now start to flash and the selector wheel will appear to have no numbers. (E01 will appear if the lid is not properly secured or aligned with handle. The lid not being locked in will cause the Mealio™ to not function which is a safety feature).

Step 2 - Select/Touch the ON/OFF button and you will see that the flashing has disappeared and the 8 Pre Set Programs and the touch control panel will light up. The Selector Wheel Screen will now appear to have the numbers 00:00 in the first row and 0 on the second row.

Step 3 - Turn the Selector Wheel in an anti-clockwise direction to select the Soy Milk function, then Select/Touch the ON/OFF button and this will start the Soy Milk blending process. You will begin to have the liquid in the jug boil to 100 degrees C, during this time you will also see some blending action occur through the boiling process. Once it has hit 100 degrees C the 20 min pre-set time for this program will begin.

Step 4 - When the Pre-Set timer of 20 minutes for the Soy Milk program finishes, the Mealio™ will sound an alarm allowing you to know that this has now been completed and it will stop heating, cooking and blending. After the program has finished it will resume to being on standby mode and you may let it sit to rest.

Note: If E01, E03, E04 or E05 appears to be displayed on your selector wheel screen during your cooking process at any time please DO NOT panic and go to **PAGE 16** for more information on what these safety errors mean.

HOT BLENDING



Soup - Hot Blending, 30 Minute Pre-set

The Soup Program is designed to blend and break down your ingredients to create fast smooth soups such as pumpkin, tomato, mushroom and carrot and coriander. Please see our website www.klevarange.com.au and go to our Mealio™ page to see our yummy recommended soup recipes for more ideas. The Soup Program has a longer blender time which has the consistency of the soups be more of a lighter consistency.

INGREDIENTS WARNING: Please ensure that all wet ingredients such as the liquids (cream and water) is to go in first, then is to be followed by any other dry ingredients at the top such as (beans, potato's and legumes). Any spices, stock cubes and powdery substances is to be added into the Mealio™ last to avoid any of these products sticking to the base of the Mealio™ Jar. Please make sure that the produce and liquid is raw to prevent the Mealio™ from overheating (RAW MEAT IS NOT TO BE ADDED INTO THE MEALIO™). If you are adding pre-cooked ingredients please make sure it has completely cooled down before going in.

Step 1 - For the soup program we say you could have a higher ratio of liquid compared to your ingredients/produce. Please make sure that the produce and liquid is raw (RAW MEAT IS NOT TO BE ADDED INTO THE MEALIO™) to prevent the Mealio™ from overheating.

Step 2 - Once your contents are in the Jug you are to lock and secure the lid into place. The ON/OFF button will now start to flash and the selector wheel will appear to have no numbers. (E01 will appear if the lid is not properly secured or aligned with handle. The lid not being locked in will cause the Mealio™ to not function which is a safety feature).

Step 3 - Select/Touch the ON/OFF button and you will see that the flashing has disappeared and the 8 Pre Set Programs and the touch control panel will light up. The Selector Wheel Screen will now appear to have the numbers 00:00 in the first row and 0 on the second row.

Step 4 - Turn the Selector Wheel in an anti-clockwise direction to select the Soup Program, then Select/Touch the ON/OFF button and this will start the process of cooking your soup. The appliance will boil the liquid to 100 degrees C, and then begin the 30 minute pre-set cooking and blending process for your perfect soup.

Step 5 - When the Pre-Set timer of 30 minutes for the Soup program finishes, the Mealio™ will sound an alarm allowing you to know that this has now been completed and it will stop heating, cooking and blending. After the program has finished it will resume to being on standby mode and you may let it sit to rest.

Note: If E01, E03, E04 or E05 appears to be displayed you on your selector wheel screen during your cooking process at any time please DO NOT panic and go to **PAGE 16** for more information on what these safety errors mean.

HOT BLENDING



Thick Soup - Hot Blending, 30 Minute Pre-set

The Thick Soup Program is designed to blend and break down your ingredients well, but still have the of having a thicker consistency. The thick Soup Program is designed to help create hearty soups such as creamy mushroom and creamy leek. Please see our website www.klevarange.com.au and go to our Mealio™ page to see other unique Thick Soup Recipes.

INGREDIENTS WARNING: Please ensure that all wet ingredients such as the liquids (cream and water) is to go in first, then is to be followed by any other dry ingredients at the top such as (beans, potato's and legumes). Any spices, stock cubes and powdery substances is to be added into the Mealio™ last to avoid any of these products sticking to the base of the Mealio Jar. Please make sure that the produce and liquid is raw to prevent the Mealio™ from overheating (RAW MEAT IS NOT TO BE ADDED INTO THE MEALIO™). If you are adding pre-cooked ingredients please make sure it has completely cooled down before going in.

Step 1 - For the thick soup program we recommend having a lower ratio of liquid in comparison to your produce. Please make sure that the produce and liquid is raw (RAW MEAT IS NOT TO BE ADDED INTO THE MEALIO) to prevent the Mealio™ from overheating.

Step 2 - Once your contents are in the Jug you are to lock and secure the lid into place. The ON/OFF button will now start to flash and the selector wheel will appear to have no numbers. (E01 will appear if the lid is not properly secured or aligned with handle. The lid not being locked in will cause the Mealio™ to not function which is a safety feature).

Step 3 - Select/Touch the ON/OFF button and you will see that the flashing has disappeared and the 8 Pre Set Programs and the touch control panel will light up. The Selector Wheel Screen will now appear to have the numbers 00:00 in the first row and 0 on the second row.

Step 4 - Turn the Selector Wheel in an anti-clockwise direction to select the Thicker Soup function, then Select/Touch the ON/OFF button and this will start the Thick Soup blending process. The appliance will boil the liquid to 100 degrees C, during this time you will also see some blending action occur through the boiling process. Once it has hit 100 degrees C the 30 minute pre-set time for this program will begin.

Step 5 - When the Pre-Set timer of 30 minutes for the Thick Soup program finishes, the Mealio™ will sound an alarm allowing you to know that this has now been completed and it will stop heating, cooking and blending. After the program has finished it will resume to being on standby mode and you may let it sit to rest.

Note: If E01, E03, E04 or E05 appears to be displayed you on your selector wheel screen during your cooking process at any time please DO NOT panic and go to **PAGE 16** for more information on what these safety errors mean.

HOT BLENDING



Paste - Hot Blending, 17 Minute Pre-set

The Paste Program is designed to create different pastes and sauces such as a pesto paste, an alfredo sauce, a tomato pasta sauce and a tomato paste. Please see our website www.klevarange.com.au and go to our Mealio™ page to see other fun recipes. This pre-set paste program does require for the recipe to have some liquid to start it off. We recommend you to use the PULSE function on ingredients before starting the PASTE program.

INGREDIENTS WARNING: Please ensure that all wet ingredients such as the liquids (cream and water) is to go in first, then is to be followed by any other dry ingredients at the top such as (beans, potato's and legumes). Any spices, stock cubes and powdery substances is to be added into the Mealio™ last to avoid any of these products sticking to the base of the Mealio™ Jar. Please make sure that the produce and liquid is raw to prevent the Mealio™ from overheating (RAW MEAT IS NOT TO BE ADDED INTO THE MEALIO™). If you are adding pre-cooked ingredients please make sure it has completely cooled down before going in.

Step 1 - Once your contents are in the Jug you are to lock and secure the lid into place. The ON/OFF button will now start to flash and the selector wheel will appear to have no numbers. (E01 will appear if the lid is not properly secured or aligned with handle. The lid not being locked in will cause the Mealio™ to not function which is a safety feature).

Step 2 - Select/Touch the ON/OFF button and you will see that the flashing has disappeared and the 8 Pre Set Programs and the touch control panel will light up. The Selector Wheel Screen will now appear to have the numbers 00:00 in the first row and 0 on the second row.

Step 3 - Turn the Selector Wheel in an anti-clockwise direction to select the Paste function, then Select/Touch the ON/OFF button and this will start the Paste blending process. You will begin to have the liquid in the jug boil to 100 degrees C, during this time you will also see some blending action occur through the boiling process. Once it has hit 100 degrees C the 17 minute pre-set time for this program will begin.

Step 4 - When the Pre-Set timer of 17 minutes for the paste program finishes, the Mealio™ will sound an alarm allowing you to know that this has now been completed and it will stop heating, cooking and blending. After the program has finished it will resume to being on standby mode and you may let it sit to rest.

Note: If E01, E03, E04 or E05 appears to be displayed you on your selector wheel screen during your cooking process at any time please DO NOT panic and go to **PAGE 16** for more information on what these safety errors mean.

COLD BLENDING

ATTENTION

Do not fill the Blender Jar past the Maximum Indication line (1200ml) to avoid overflow



Smoothie - Cold Blending, 50 Seconds Pre-set

This program can make smoothies, milkshakes and similar beverages. The pre-set time for this function is 50 seconds and the appliance will automatically adjust the blending speed. To avoid ice jamming and damage to the blades, add fruit, ice and other ingredients in several intervals. The recommended guide for liquid to fruit is 4:6, but as you progress with your smoothie making you can adjust the ratio to your preference.



Quick Crush - Cold Blending, 50 Seconds Pre-set

This program is to be used primarily to crush ice for frozen drinks. The pre-set time for this function is 50 seconds and the appliance will automatically adjust the blending speed. It is recommended to not fill the Blender Jar above the Halfway Line (600ml) to allow the ice to continuously move. Also adding a small amount of water can assist with the quick crush function.



Juice - Cold Blending, 2 Minutes Pre-set

The pre-set time for this function is 2 minutes and the appliance will automatically adjust the blending speed. When the program timer has finished, the blender will sound an alarm and stop heating and blending, it will then resume to Standby Mode.

FOR A VARIETY OF

• **RECIPES** •

SUITED FOR

MEALiO

The Hot and Cold Nutritional Blender

Please visit our website at

 www.klevarange.com.au

SCAN ME

For helpful tips and recipes



CLEANING

1. Pour a small drop of washing liquid and warm water into the Blender Jar and fill up to half of the Maximum Capacity.
2. Securely attach the Centre Cap and Lid to the Blender.
3. Press the 'Auto Cleaning' button and the appliance will heat up to 70°C and then blend for 2 minutes.
4. Unplug the appliance, pour out the soapy water and rinse the Blender Jar under a tap.
5. Use a dry cloth to carefully clean the Driving Shaft Head and Blender Jar.



Note

- Do not soak the Blender in water or any other liquid to avoid damages.
- Do not use metal wool, brushes, rough scrubbers or sharp-edged tools on the Blender to avoid scratching.
- Do not use metal wool or brush to wash the blade unit to avoid scratching.
- Use only soft cloth when cleaning the motor unit and blade unit.
- Do not put the Blender Jar into the dishwasher.
- Do not rinse the Motor Base or the bottom of Blender Jar.

Tips

- To ensure consistent and optimum performance clean the heating plate with a soft cloth after using.
- Do not use sharp-edged tools to clean any burnt ingredients off of the Blender. Instead fill the Blender Jar with warm water and let it sit for 2 hours. Then using a soft cleaning brush carefully remove any residue.
- For the best results, soak beans or rice for a few hours prior to using.

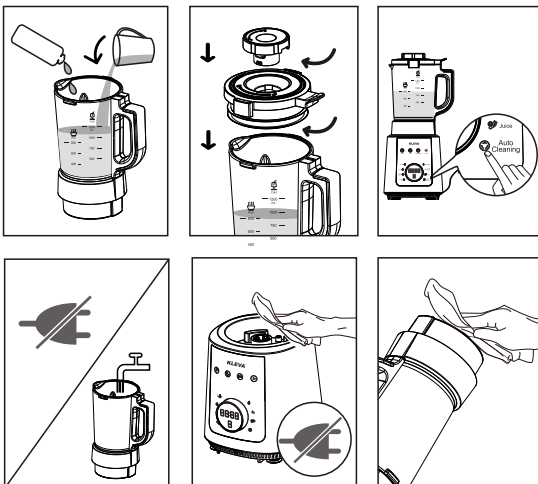

	WARM TAP WASH	DISH WASHER	WIPE CLEAN WITH WET CLOTH
	✓	✗	✓
	✓	✗	✓
	✗	✗	✓
	✗	✗	✓

HINTS & TIPS

QUICK FAQ'S AND HINTS FOR THE MEALIO™

PLEASE READ THE FULL INSTRUCTIONS TO ENSURE PROPER USE OF THE MEALIO™



Q. An error is showing up on the Mealio™ when I plug it in and turn it on.

A. When you first plug in the Mealio™ you might see the message **E01** on the screen, this is normal and appears when the Blender Jug Sensor is not aligned with the Lid Sensor.

To fix this error, place the lid securely on the blender jar and turn clockwise until it cannot turn anymore. The touch panel can only be used when the jug and lid are on the base.



Q. How do I prevent my Mealio™ from overheating?

A. Not allowing the Mealio™ to cool down between uses can cause overheating and error message **E04** to appear. If this happens simply turn off the power on the Mealio™ and allow it to rest for 30 – 45 minutes before using again.

For more tips, please refer to Page 16 of the instruction manual.



Q. Can I clean my Mealio™ in the dishwasher?

A. Do Not submerge the Glass Jar or Lid under water, or wash them in a dishwasher. This will damage the electronic elements inside the Mealio™ Jug and Lid.

To properly clean the Mealio™ please refer to **Page 14** of the instruction Manual.



Q. My food keeps sticking to the base of the Mealio™.

A. Always make sure there is enough liquid in the Mealio™ Glass Jug to ensure that food does not stick to the base. For best practice add liquids into the jug first.







Q. Do I need to pre-cook my vegetables

A. You do not need to pre cook any Ingredients, simply add the raw vegetables into the Blender Jar and allow the Mealio™ to cook and blend for you.

Please refer to **The Next Page** of the instruction Manual for more **HINTS & TIPS**.

HINTS & TIPS

What To Do If Appliance Does Not Work :

PROBLEMS	CAUSES	SOLUTIONS
Appliance does not work.	Blender sensor position does not match the handle sensor position.	Place the lid securely on the Blender Jar and turn clockwise until it cannot turn anymore. Check that the Blender sensor and Handle sensor positions match.
Odd smell at the beginning of first	Oil protection on motor, this is normal.	Smell will disappear after a few uses.
Appliance suddenly stopped during use.	The motor has over heated and the Overheat Protection has activated and stopped the appliance.	Unplug the Blender from the power socket and wait 30 -45 minutes for the motor to cool down before trying to use again.
Ingredients overflowing.	Lid or Lid Cap has not locked securely.	Check the Lid and Lid Cap and lock them firmly.
Blade jammed.	Ingredients are too large to blend.	Turn off and unplug the Blender from the power socket. Carefully clean out the ingredients that have jammed on the blades.
 Display E01	Blender sensor position does not match the Handle sensor position.	Place the lid securely on the Blender Jar and turn clockwise until it cannot turn anymore. Check that the Blender sensor and Handle sensor positions match.
 Display E03	Jug sensor is not aligned with motor base sensor or thermistor does not work.	Make small adjustments to the positioning of the jug to re assure the alignment with the motor base. Lifting up the jar and re inserting it into the base may also help. If the display error still persists please contact the Kleva Range® customer service.
 Display E04	Appliance is Overheating.	Lift up the jar and add some more liquid, then return the jar to the base. If the display error persists turn off and unplug the Blender from the power socket and remove the jug from the base. Leave for a minimum of 30-45 minutes to cool down before trying to use again. If the display error still persists please empty the contents of the jar and wash the base with water and the included cleaning brush, then try again.
 Display E05	Device Protection activated	This appliance features a unique safety system to prevent damage to the blender by temporarily disabling the motor if it begins to overheat. Lift up the jar and add some more liquid, then return the jar to the base. If the display error persists turn off and unplug the Blender from the power socket and leave for 30-45 minutes to cool down before trying to use again. Emptying the contents of the jar and washing the base may also help. If the display error still persists please contact the Kleva Range® customer service.

KLEVA®

MEALiO™

The Hot and Cold Nutritional Blender

FOR A VARIETY OF

• RECIPES •

SUITED FOR

MEALiO

The Hot and Cold Nutritional Blender

Please visit our website at



www.klevarange.com.au

SCAN ME

For helpful tips and recipes



SPECIFICATION:

Model: KHCSB002

Power: 600W(Motor) / 800W(Heater)

Voltage: 220-240V~

Frequency: 50-60Hz

Capacity: 800ml for hot / 1200ml for cold



**HANDLE WITH CARE. BLENDER CONTAINS SHARP COMPONENTS.
KEEP AWAY FROM CHILDREN. INCORRECT USE CAN LEAD TO INJURY AND
DAMAGE. HANDLE WITH CAUTION WHEN USING BLENDER WITH HOT LIQUID.
BLENDER SURFACE BECOMES HOT WHEN IN USE.
INCORRECT USE CAN RESULT IN GLASS BLENDER BEING DAMAGED.
DO NOT USE IF BLENDER JAR IS CRACKED OR CHIPPED**

KLEVA RANGE®

🌐 www.klevarange.com.au

☎ 02 9387 4100

✉ enquiries@klevarange.com.au

📍 Suite 301 / 209 Oxford St

Bondi Junction NSW 2022 Australia

**GENUINE
KLEVA
QUALITY** 

KleVA® is a registered trademark
of Take Two Marketing and Events Pty Ltd.