

NOTE: If your car was originally equipped with a factory bench seat, you will need to purchase and install inner seat pads to your floor. Reproduction pads can be found online. If you need help finding the right ones, send us a message and we'll be glad to help. If your car came with factory buckets or 60/40 split bench, your car already has the inner floor pads and you are ready to proceed.

Instructions:

1. Loosely assemble aluminum uppers to steel lowers using the supplied hardware. Don't tighten, yet. Leave loose enough to reposition as needed in the steps ahead. See Figure 1 and Figure 2 below for proper assembly orientation.
2. Bolt your new JTR brackets to factory floor mounts in your car using the factory nuts.
3. Set your Kirkey seat in the car positioning it between your new JTR seat brackets. Sit in the seat and move it around until you are in your most comfortable driving position. If you need to, you can temporarily stack wood or a similar material under the seat to set a more comfortable height. Reposition your JTR brackets as needed to find the best fit for your seat position.
4. Once you're certain you are in the perfect seated position, scribe the sides of your Kirkey seat using holes in the upper JTR seat brackets as a guide. This step is much easier if you have a friend to help make the scribes while you remain holding the seat in position. Make sure to use two bolts per side, one forward and one to the rear on each side.
5. Drill $\frac{5}{16}$ " holes in your Kirkey seat at your scribe marks.
6. You should now be able to final assemble your JTR seat brackets and Kirkey seat with the supplied hardware and install in the car.

Figure 1

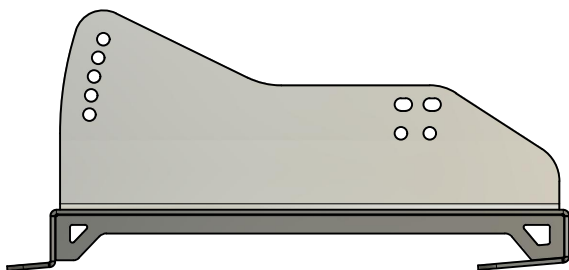

Side View
 <--- Front of Car

Figure 2

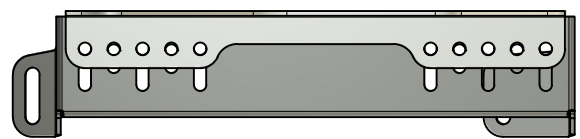

Top View
 <--- Front of Car



PROPRIETARY AND CONFIDENTIAL:
 THE INFORMATION CONTAINED IN
 THIS DRAWING IS THE SOLE
 PROPERTY OF JT RACESHOP, LLC.
 ANY REPRODUCTION IN PART OR
 AS A WHOLE WITHOUT THE
 WRITTEN PERMISSION OF
 JT RACESHOP, LLC IS PROHIBITED.

JT RACESHOP

12153 Oak Park Blvd NE, Blaine, MN 55434

612-655-3055
 sales@jtraceshop.com

www.jtraceshop.com

PART NO.
 30900

TITLE:
 Bolt-in Kirkey Seat Brackets

PLATFORM:
 1978-1988 GM G-body

SHEET
 1/1